

**APPLICATION FOR EXEMPTION FROM SITE PLAN REVIEW**

First Baptist Church

10/20/99

Applicant

Application Date

360 Canco Rd

Fill, Grade + Seed

Applicant's Mailing Address

Project Name/Description

Guy Melcher 854-4783

360 Canco Rd.

Consultant/Agent/Phone Number

Address of Proposed Site

Church Property Commission

161 B 043

Description of Proposed Development:

We want to fill, grade and seed the identified area so it will blend with the original landscaped site. It is presently unattractive and visible to the public.

Please Attach Sketch/Plan of Proposal/Development

Criteria for Exemptions:

See Section 14-523 (4)

a) Within Existing Structures; No New Buildings, Demolitions or Additions

N/A.

✓

b) Footprint Increase Less Than 500 Sq. Ft.

N/A

✓

c) No New Curb Cuts, Driveways, Parking Areas

No

✓

d) Curbs and Sidewalks in Sound Condition/ Comply with ADA

yes

✓

e) No Additional Parking / No Traffic Increase

No

✓

f) No Stormwater Problems

No

✓

g) Sufficient Property Screening

N/A

✓

h) Adequate Utilities

yes

✓

Planning Office Use Only:

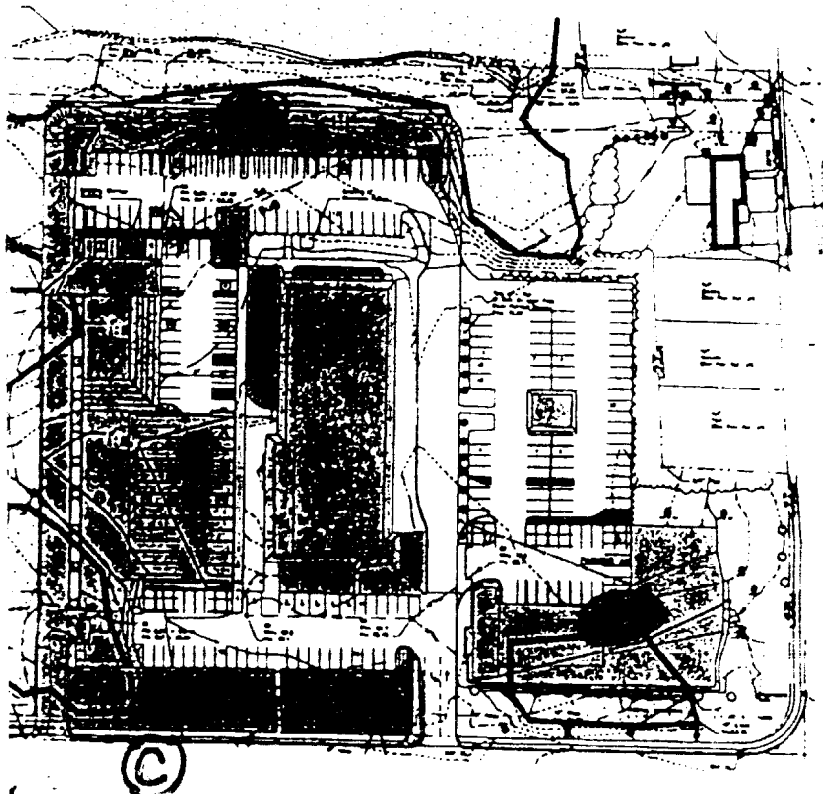
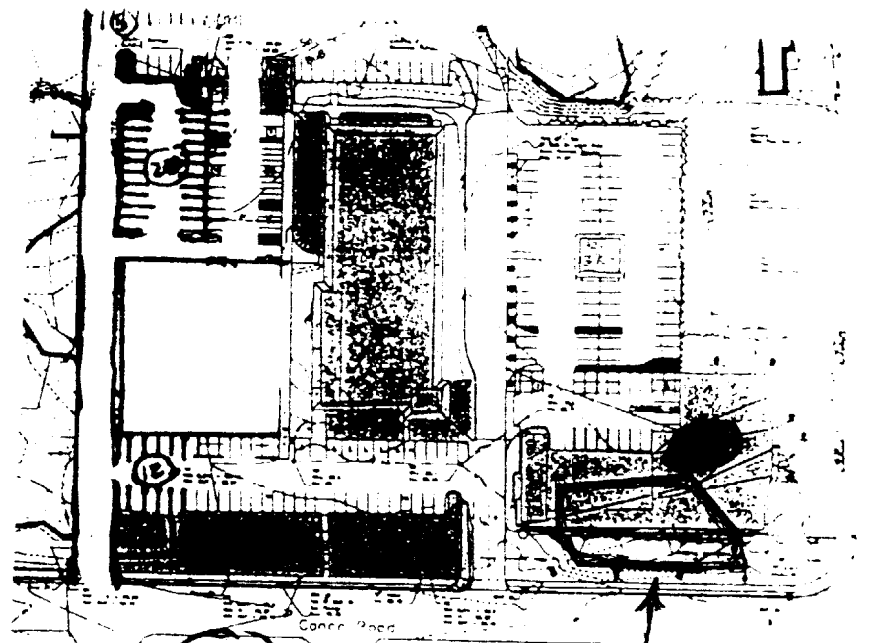
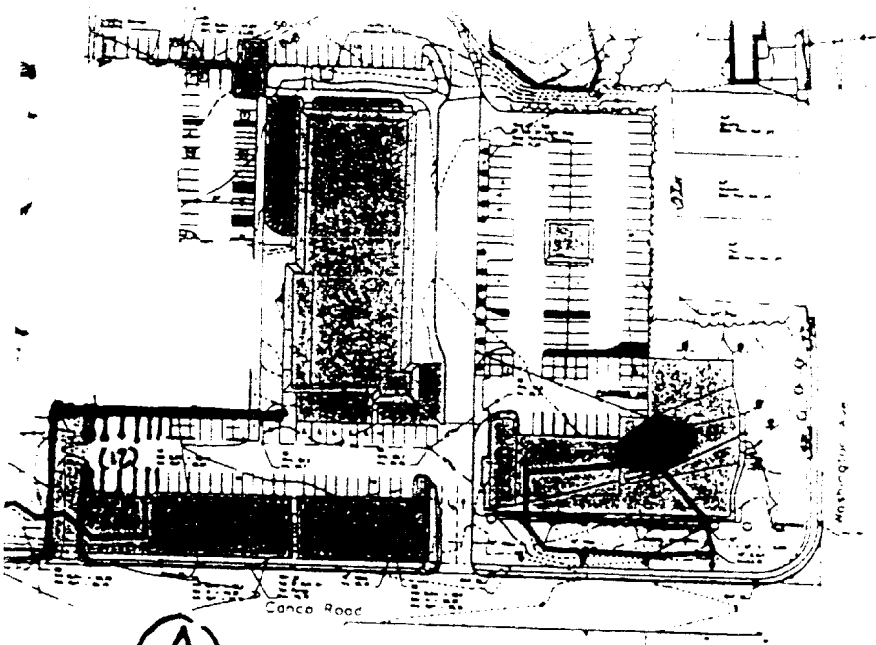

- (A) - Conco 2nd Exit + 12 spaces
- (B) Conco 2nd Exit to Rear + Either 12 or 12 + 20 spaces
- (C) As give to Deacons as our Recommendation  
Conco 2nd Exit + 158 spaces  
COST 283,000 (at 1791 per space)

CANCO RD/WORTH AVE CORNER	50 spaces	80,000
Rear of FCC Double Bay	64 spaces	80,000

FFE 715

MATERIALS USED TO BE DETERMINED

35'

8' SIDEWALK CRACKFILL 2 1/2" CAL.

OE

8" R.C.P. DRAIN INV. 66.01

CB3 RIM 70.4 INV. 66.47

Fluorescent Curb

SAVE EXISTING VEGETATION REMOVE UNDESIRABLE VEGETATION

WOOD CHIPS BETWEEN PARKING AND SIDEWALKS

INSTALL NEW SPEED BUMP

BARRELS WILL BE PLACED AROUND DRIPLINE OF PRESERVED TREES

Remove Existing Pavement

Loom & seed

12" R.C.P.

Rim 69.0 Inv. 65.2

VIOLATION OF LAW STERILE 10' L x 2-3' TALL SCREEN

4 GREEN PIPE UNITS 2 1/2" CAL

Install drain pipe connecting the two existing pipes

TRAP

Exist 12" Inv. 63.34

Raise M.H. Rim to Sidewalk Elev.

RIM 65.64 INV 65.88

SUBSTITUTE EXISTING PVC IN LIEU OF RCP. EXTEND TO MEET GRADING AND INVERT REQUIREMENTS

Raise M.H. Rim to Sidewalk Elev.

RIM 68.93

Proposed Granite Curb

CANCO ROAD

First Baptist Church 360 Cancro Road

NOTES:

Not to Scale  
Rough area sketch

FIRST BAPTIST CHURCH PLANTING

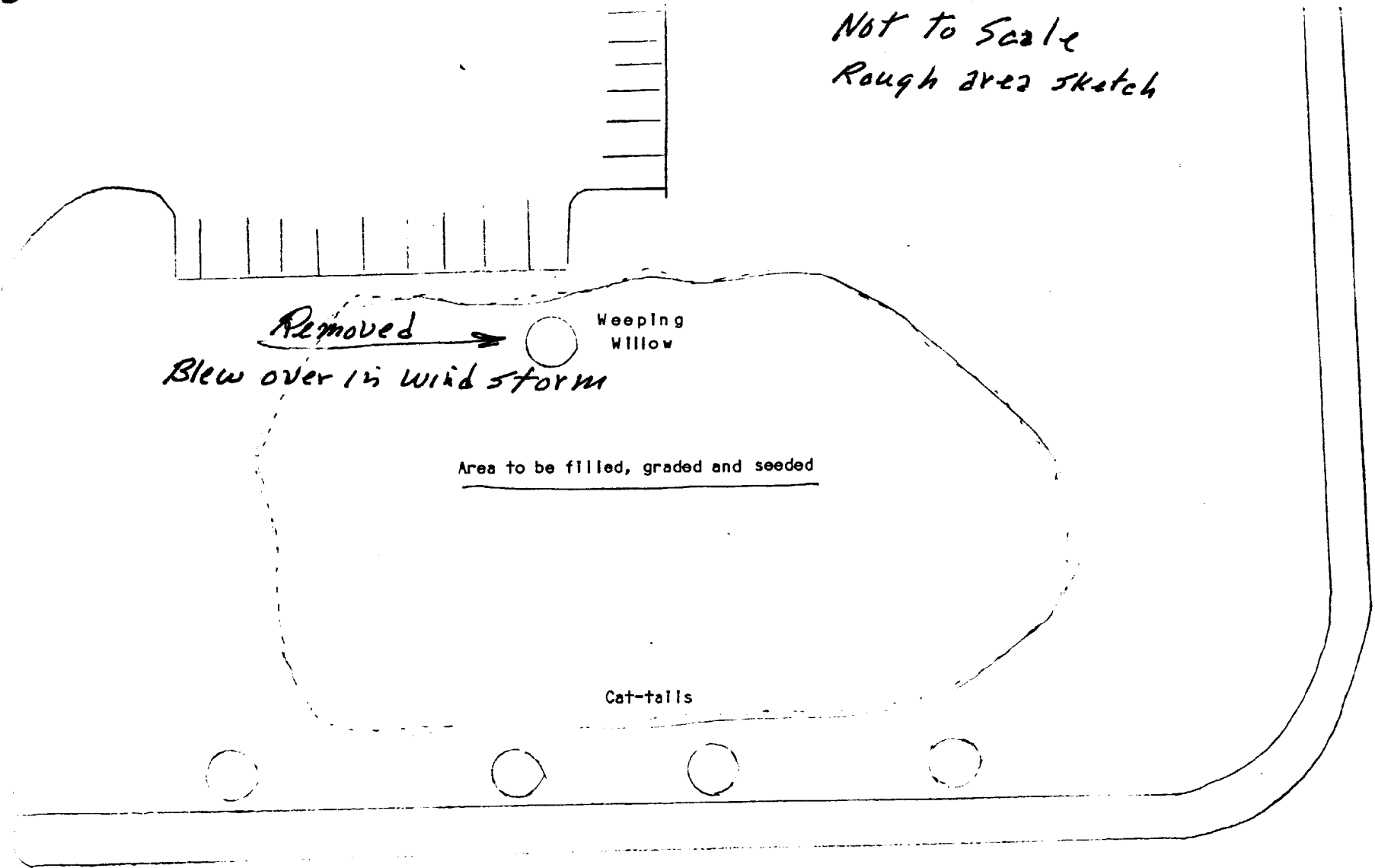

WASHINGTON AVENUE

CANCO ROAD

First Baptist Church

