

KIRBY STREET 169-3-13

207



First cut # 9204 - Hair cut # 9202R - Third cut # 9203R - Fifth cut # 9205R

CITY OF PORTLAND, MAINE
Application for Permit to Install Wires

Permit No. 55835
 Issued 3/30/70
 Portland, Maine March 30, 1970

To the City Electrician, Portland, Maine:

The undersigned hereby applies for a permit to install wires for the purpose of conducting electric current, in accordance with the laws of Maine, the Electrical Ordinance of the City of Portland, and the following specifications:

(This form must be completely filled out - Minimum Fee \$1.00)

Owner's Name and Address Mr. Albert Leighton Tel. _____
 Contractor's Name and Address Marino's Elec Tel. 7743129
 Location 29 Kinco St. Use of Building _____
 Number of Families _____ Apartments _____ Stores _____ Number of Stories _____
 Description of Wiring: New Work _____ Additions _____ Alterations _____
 Pipe _____ Cable _____ Metal Molding _____ BX Cable _____ Plug Molding (No. of feet) _____
 No. Light Outlets _____ Plugs _____ Light Circuits _____ Plug Circuits _____
 FIXTURES: No. _____ Fluor. or Strip Lighting (No. feet) _____
 SERVICE: Pipe _____ Cable Underground _____ No. of Wires 3 Size 2-3-15
 METERS: Relocated _____ Added _____ Total No. Meters _____
 MOTORS: Number _____ Phase _____ H. P. _____ Amps _____ Volts _____ Starter _____
 HEATING UNITS: Domestic (Oil) _____ No. Motors _____ Phase _____ H.P. _____
 Commercial (Oil) _____ No. Motors _____ Phase _____ H.P. _____
 Electric Heat (No. of Rooms) _____
 APPLIANCES: No. Ranges _____ Watts _____ Brand Feeds (Size and No.) _____
 Elec. Heaters _____ Watts _____
 Miscellaneous None Watts _____ Extra Cabinets or Panels _____
 Transformers _____ Air Conditioners (No. Units) _____ Signs (No. Units) _____
 Will commence _____ 19__ Ready to cover in _____ 19__ Inspection? will call 1970
 Amount of Fee \$ 3.50 Signed A J Marino

DO NOT WRITE BELOW THIS LINE

SERVICE <input checked="" type="checkbox"/>	METER _____	GROUND <input checked="" type="checkbox"/>
VISITS: 1 _____ 2 _____ 3 _____ 4 _____ 5 _____ 6 _____		
7 _____ 8 _____ 9 _____ 10 _____ 11 _____ 12 _____		

REMARKS: _____
 INSPECTED BY F W Hart (OVER)

LOCATION *Kiueo ST 29*
 INSPECTION DATE *4/2/70*
 WORK COMPLETED *4/2/70*
 TOTAL NO. INSPECTIONS
 REMARKS:

FEES FOR WIRING PERMITS EFFECTIVE JULY 31, 1963

WIRING	
1 to 30 Outlets	\$ 2.00
31 to 60 Outlets	3.00
Over 60 Outlets, each Outlet	.05
(Each twelve feet or fraction thereof of fluorescent lighting or any type of plug molding will be classed as one outlet).	
SERVICES	
Single Phase	2.00
Three Phase	4.00
MOTORS	
Not exceeding 50 H.P.	3.00
Over 50 H.P.	4.00
HEATING UNITS	
Domestic (Oil)	2.00
Commercial (Oil)	4.00
Electric Heat (Each Room)	.75
APPLIANCES	
Ranges, Cooking Tops, Ovens, Water Heaters, Disposals, Built-in Dishwashers, Dryers, and any permanent built-in appliance — each unit	1.50
MISCELLANEOUS	
Temporary Service, Single Phase	1.00
Temporary Service, Three Phase	2.00
Circuses, Carnivals, Fairs, etc.	10.00
Meters, relocate	1.00
Distribution Cabinet or Panel, per unit	1.00

CITY OF PORTLAND, MAINE
Application for Permit to Install Wires

Permit No. 57269
 Issued 10/16/68
 Portland, Maine 10-16- , 1968

To the City, Electrician, Portland, Maine:

The undersigned hereby applies for a permit to install wires for the purpose of conducting electric current, in accordance with the laws of Maine, the Electrical Ordinance of the City of Portland, and the following specifications:

(This form must be completely filled out - Minimum Fee, \$1.00)

Owner's Name and Address Albert J. Leighton Tel. 772-1357
 Contractor's Name and Address Diagon Bros Inc Tel. 532-5311
 Location 29 Kennebec St Use of Building Dwelling
 Number of Families 1 Apartments _____ Stories _____ Number of Stories _____
 Description of Wiring: New Work X Additions _____ Alterations _____

Pipe _____ Cable _____ Metal Molding _____ BX Cable _____ Plug Molding (No. of feet) _____
 No. Light Outlets _____ Plugs _____ Light Circuits _____ Plug Circuits _____
 FIXTURES: No. _____ Fluor. or Strip Lighting (No. feet) _____
 SERVICE: Pipe _____ Cable _____ Underground _____ No. of Wires _____ Size _____
 METERS: Relocated _____ Added _____ Total No. Meters _____
 MOTORS: Number 1 Phase 1/2 H. P. 1/2 Amps 15 Volts 115 Starter _____
 HEATING UNITS: Domestic (Oil) X No. Motors 1 Phase 1/2 H.P. 1/2
 Commercial (Oil) _____ No. Motors _____ Phase _____ H.P. _____
 Electric Heat (No. of Rooms) _____
 APPLIANCES: No. Ranges _____ Watts _____ Brand Feeds (Size and No.) _____
 Elec. Heaters _____ Watts _____
 Miscellaneous _____ Watts _____ Extra Cabinets or Panels _____
 Transformers _____ Air Conditioners (No. Units) _____ Signs (No. Units) _____
 Will commence _____ 19. . . Ready to cover in _____ 19. . . Inspection _____ 19. . .
 Amount of Fee \$ 2.00

Signed Diagon Bros Inc
R.V.R. O'Rourke

DO NOT WRITE BELOW THIS LINE

SERVICE _____ METER _____ GROUND _____
 VISITS: 1 _____ 2 _____ 3 _____ 4 _____ 5 _____ 6 _____
 _____ 7 _____ 8 _____ 9 _____ 10 _____ 11 _____ 12 _____
 REMARKS:

INSPECTED BY J.W. Healey
 (OVER)

LOCATION *Kineo ST 29*
 INSPECTION DATE *10/28/68*
 WORK COMPLETED *10/28/68*
 TOTAL NO. INSPECTIONS *1*
 REMARKS:

FEEES FOR WIRING PERMITS EFFECTIVE JULY 31, 1968

WIRING	
1 to 30 Outlets	
31 to 60 Outlets	\$ 2.00
Over 60 Outlets, each Outlet	3.00
(Each twelve feet or fraction thereof of fluorescent lighting or any type of plug molding will be classed as one outlet).	.05
SERVICES	
Single Phase	
Three Phase	2.00
MOTORS	
Not exceeding 50 H.P.	4.00
Over 50 H.P.	3.00
HEATING UNITS	
Domestic (Oil)	4.00
Commercial (Oil)	2.00
Electric Heat (Each Room)	4.00
APPLIANCES	
Ranges, Cooking Tops, Ovens, Water Heaters, Disposals, Built-in Dishwashers, Dryers, and any permanent built-in appliance — each unit75
MISCELLANEOUS	
Temporary Service, Single Phase	1.50
Temporary Service, Three Phase	1.00
Circuses, Carnivals, Fairs, etc.	2.00
Meters, relocate	2.00



FILL IN AND SIGN WITH INK

APPLICATION FOR PERMIT FOR HEATING, COOKING OR POWER EQUIPMENT

Portland, Maine, October 16, 1968

PERMIT ISSUED 1096 OCT 16 1968 CITY OF PORTLAND

To the INSPECTOR OF BUILDINGS, PORTLAND, ME.

The undersigned hereby applies for a permit to install the following heating, cooking or power equipment in accordance with the Laws of Maine, the Building Code of the City of Portland, and the following specifications:

Location Use of Building No. Stories New Building Existing Name and address of owner of appliance Installer's name and address Telephone

General Description of Work

To install Oil-fired forced hot air heating system in place of coal-fired hot air heat.

IF HEATER, OR POWER BOILER

Location of appliance Any burnable material in floor surface or beneath? If so, how protected? Kind of fuel? Minimum distance to burnable material, from top of appliance or casing top of furnace From top of smoke pipe From front of appliance From sides or back of appliance Size of chimney flue Other connections to same flue If gas fired, how vented? Rated maximum demand per hour Will sufficient fresh air be supplied to the appliance to insure proper and safe combustion?

IF OIL BURNER

Name and type of burner Labelled by underwriters' laboratories? Will operator be always in attendance? Does oil supply line feed from top or bottom of tank? Type of floor beneath burner Size of vent pipe Location of oil storage Number and capacity of tanks Low water shut off Make No. Will all tanks be more than five feet from any flame? How many tanks enclosed? Total capacity of any existing storage tanks for furnace burners

IF COOKING APPLIANCE

Location of appliance Any burnable material in floor surface or beneath? If so, how protected? Height of Legs, if any Skirting at bottom of appliance? Distance to combustible material from top of appliance? From front of appliance From sides and back From top of smokepipe Size of chimney flue Other connections to same flue Is hood to be provided? If so, how vented? Forced or gravity? If gas fired, how vented? Rated maximum demand per hour

MISCELLANEOUS EQUIPMENT OR SPECIAL INFORMATION

Blank lines for miscellaneous information

Amount of fee enclosed? (\$2.00 for one heater, etc., \$1.00 additional for each additional heater, etc., in same building at same time.)

APPROVED:

O.K. E.B. 10/16/68

Will there be in charge of the above work a person competent to see that the State and City requirements pertaining thereto are observed? Yes

Dixon Bros.

CS 300

INSPECTION COPY

Signature of Installer by: Dixon Bros. B.R. Atkinson

Handwritten initials

Permit No. 6811090
 Location 39 Acres St.
 Owner Edmund J. Heston
 Date of permit 10/16/68
 Approved Oct 27 '68 ERNOLD R. GOODWIN

NOTES

1	Fill Pipe	
2	Valve	
3	Kind of Material	
4	Location of Job & Property	
5	Reason for Job	
6	Size of Project	
7	By what method	
8	Reason for Job	
9	Part of Road or other	
10	Volume of Soil to be	
11	Working in Sheds	
12	Is Job on No. 8 Station	
13		
14		
15		
16		
17		
18		
19		
20		
21		
22		
23		
24		
25		
26		
27		
28		
29		
30		

OCT 17 '68 *not started*



(RC) RESIDENCE ZONE - C

APPLICATION FOR PERMIT

Class of Building or Type of Structure Third Class

Portland, Maine, September 11, 1951

PERMIT NUMBER
01731
SEP 12 1951

To the INSPECTOR OF BUILDINGS, PORTLAND, MAINE

The undersigned hereby applies for a permit to erect ~~on property located at~~ the following building structure ~~XXXX~~ equipment in accordance with the Laws of the State of Maine, the Building Code and Zoning Ordinance of the City of Portland, plans and specifications, if any, submitted herewith and the following specifications:

Location 29 Kineo Street Within Fire Limits? no Dist. No. _____

Owner's name and address Edith A. Leighton, 29 Kineo St. Telephone _____

Lessee's name and address _____ Telephone _____

Contractor's name and address Albert J. Leighton, 29 Kineo St. Telephone _____

Architect _____ Specifications _____ Plans yes No. of sheets 1

Proposed use of building 1 car garage No. families _____

Last use _____ No. families _____

Material _____ No. stories _____ Heat _____ Style of roof _____ Roofing _____

Other buildings on same lot dwelling Fee \$ 2.00

Estimated cost \$ 500.

General Description of New Work

To construct 1 car frame garage 12'x20'

CERTIFICATE OF OCCUPANCY REQUIREMENT IS WAIVED

It is understood that this permit does not include installation of heating apparatus which is to be taken out separately by and in the name of the heating contractor. **PERMIT TO BE ISSUED TO owner**

Details of New Work

Is any plumbing involved in this work? _____ Is any electrical work involved in this work? _____

Height average grade to top of plate 8' Height average grade to highest point of roof 11'

Size, front 12' depth 20' No. stories 1 solid or filled land? solid earth or rock? earth

Material of foundation hard pine posts at least 4' below grade Thickness, top _____ bottom _____ cellar _____

Material of underpinning creosote Height _____ Thickness _____

Kind of roof pitch-gable Rise per foot 6" Roof covering asphalt roofing Class C Und. Lab.

No. of chimneys _____ Material of chimneys _____ of lining _____ Kind of heat _____ fuel _____

Framing lumber—Kind hemlock Dressed or full size? dressed

Corner posts 4x4 Sills 4x6 Girt or ledger board? _____ Size _____

Girders _____ Size _____ Columns under girders _____ Size _____ Max. on centers _____

Studs (outside walls and carrying partitions) 2x4-16" O. C. Bridging in every floor and flat roof span over 8 feet.

Joists and rafters: 1st floor asphalt, 2nd _____, 3rd _____, roof 2x4

On centers: 1st floor _____, 2nd _____, 3rd _____, roof 18"

Maximum span: 1st floor _____, 2nd _____, 3rd _____, roof 6'

If one story building with masonry walls, thickness of walls? _____ height? _____

If a Garage

No. cars now accommodated on same lot none to be accommodated 1 number commercial cars to be accommodated none

Will automobile repairing be done other than minor repairs to cars habitually stored in the proposed building? no

Miscellaneous

Will work require disturbing of any tree on a public street? no

Will there be in charge of the above work a person competent to see that the State and City requirements pertaining thereto are observed? yes

APPROVED:

O.K. 9/11/51 - A.J.L.

Signature of owner

Edith A. Leighton

INSPECTION COPY

30
10
10
10

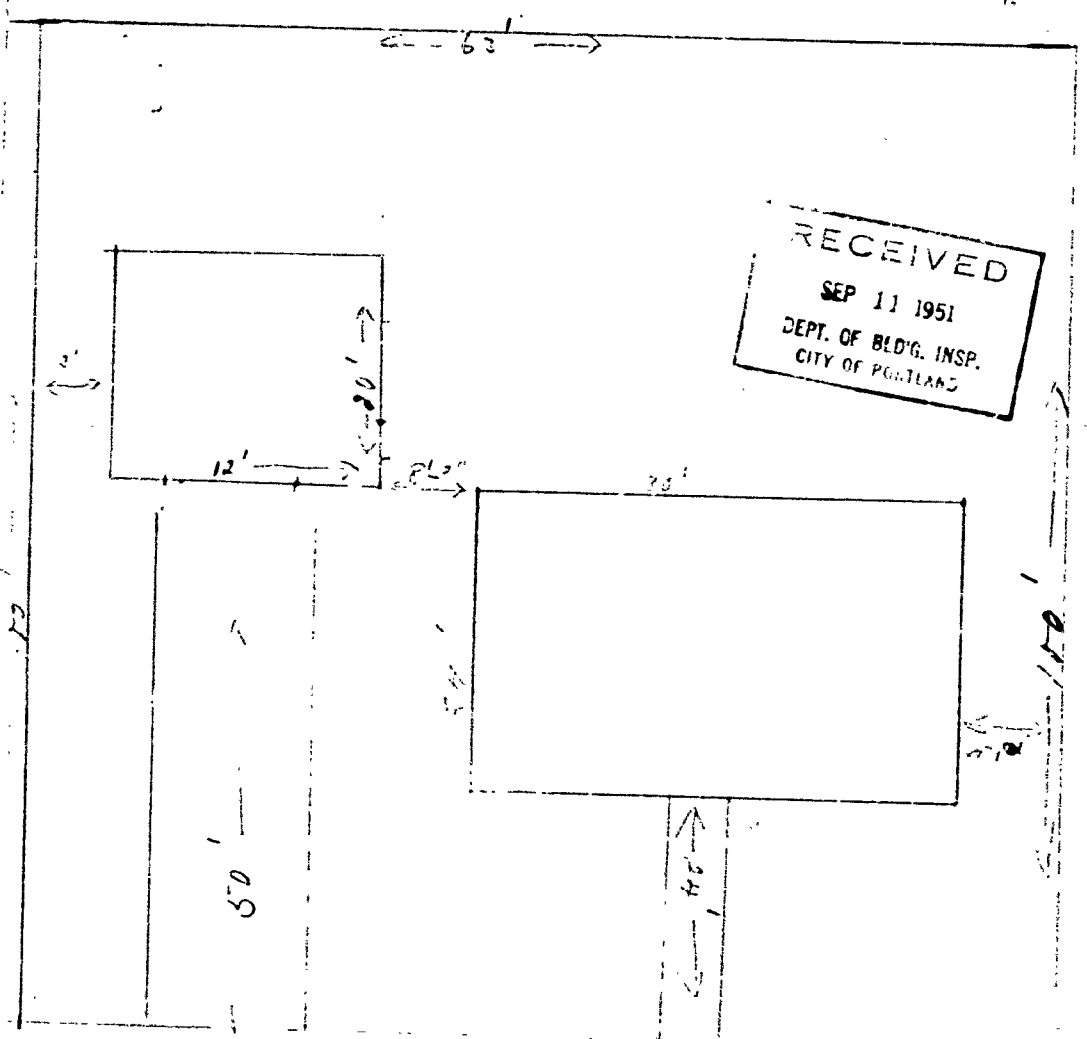

RECEIVED
SEP 11 1951
DEPT. OF BLDG. INSP.
CITY OF PORTLAND

KINED ST

STATEMENT ACCOMPANYING APPLICATION FOR BUILDING PERMIT

for 1 car garage
at 29 Kineo Street Date 9/11/51

1. In whose name is the title of the property now recorded? Edith A. Leighton
2. Are the boundaries of the property in the vicinity of the proposed work shown clearly on the ground, and how? stakes and ~~x~~ fence
3. Is the outline of the proposed work now staked out upon the ground? yes
If not, will you notify the Inspection Office when the work is staked out and before any of the work is commenced? _____
4. What is to be maximum projection or overhang of eaves or drip? 6"
5. Do you assume full responsibility for the correctness of the location plan or statement of location filed with this application, and does it show the complete outline of the proposed work on the ground, including bay windows, porches and other projections? yes
6. Do you assume full responsibility for the correctness of all statements in the application concerning the size, design and use of the proposed building? yes
7. Do you understand that in case changes are proposed in the location of the work or in any of the details specified in the application that a revised plan and application must be submitted to this office before the changes are made? yes

Albert J. Leighton

(R) RESIDENCE ZONE - C

APPLICATION FOR PERMIT

PERMIT ISSUED
11695
SEP 15 1950



Class of Building or Type of Structure Third Class
Portland, Maine, September 12, 1950

To the INSPECTOR OF BUILDINGS, PORTLAND, MAINE

The undersigned hereby applies for a permit to ~~alter, add to or erect~~ erect the following building ~~structure~~ structure in accordance with the Laws of the State of Maine, the Building Code and Zoning Ordinance of the City of Portland, plans and specifications, if any, submitted herewith and the following specifications:

Location 29 Kineo Street Within Fire Limits? _____ Dist. No. _____
Owner's name and address Albert Leighton, 29 Kineo Street Telephone _____
Lessee's name and address _____ Telephone _____
Contractor's name and address Gordan Evans, 27 Hastings Street Telephone 3-7117
Architect _____ Specifications _____ Plans no No. of sheets _____
Proposed use of building dwelling house No. families 1
Last use _____ " " _____ No. families 1
Material wood No. stories 1 1/2 Heat _____ Style of roof _____ Roofing _____
Other buildings on same lot _____ Fee \$ 5.00
Estimated cost \$ 1500.

General Description of New Work

To provide 30' long dormer on rear of dwelling. (flat roof)
To provide 2-4' wide dormers on front of dwelling. (gable roofs)
To finish off entire second floor and partition off three rooms on second floor. 2x4 studs, 16" on centers, covered on both side with sheetrock.

CITY REQUIREMENT OF OCCUPANCY
REQUIREMENT IS WAIVED

It is understood that this permit does not include installation of heating apparatus which is to be taken out separately by and in the name of the heating contractor. PERMIT TO BE ISSUED TO Gordan Evans

Details of New Work

Is any plumbing involved in this work? _____ Is any electrical work involved in this work? _____
Height average grade to top of plate _____ Height average grade to highest point of roof _____
Size, front _____ depth _____ No. stories _____ solid or filled land? _____ earth or rock? _____
Material of foundation _____ Thickness, top _____ bottom _____ cellar _____
Material of underpinnings _____ Height _____ Thickness _____
Kind of roof _____ Rise per foot 3" Roof covering Asphalt Class C Und Lab
No. of chimneys _____ Material of chimneys _____ of lining _____ Kind of heat _____ fuel _____
Framing lumber Kind hemlock Dressed or full size? _____ dressed _____
Corner posts 4x6 on back dormer _____ Girt or ledger board? _____ Size _____
Girders 2-2x4 on sills _____ Columns under girders _____ Size _____ Max. on ce _____
Studs (outside walls and carrying partitions) 2x4-16" O. C. Bridging in every floor and flat roof spar _____
Joists and rafters: 1st floor _____, 2nd _____, 3rd _____, roof 16" 16"
On centers: 1st floor _____, 2nd _____, 3rd _____, roof 12' 2'
Maximum span: 1st floor _____, 2nd _____, 3rd _____, roof _____ height? _____
If one story building with masonry walls, thickness of walls? _____ height? _____

If a Garage

No. cars now accommodated on same lot _____, to be accommodated _____ number commercial cars to be accommodated _____
Will automobile repairing be done other than minor repairs to cars habitually stored in the proposed building? _____

Miscellaneous

Will work require disturbing of any tree on a public street? no
Will there be in charge of the above work a person competent to see that the State and City requirements pertaining thereto are observed? yes
Albert Leighton

APPROVED:

Signature of owner by: Gordan Evans

INSPECTION COPY

NOTES

10/10/50 - Firestop seal attached

Firestop chimney, Firestop
between rafters / long h. beam
also new wood beams in connection

10/10/50 - Info G.T. to check
in with the above notes above
one mentioning 25 mil openings
missing in the it is inspected
& approved. P. 28

11/24/50 - Joint Mrs Evans on the
street side ago + the welcome
the above deficiencies were taken
care of. E. L.

Permit No.	50/1695
Location	29 James St.
Owner	Albert Deakston
Date of permit	9/15/50
Notif. closing-in	10/10/50 (by) DIT
Inspn. closing-in	10/11/50
Final Notif.	
Final Inspn.	
Cert. of Occupancy issued	

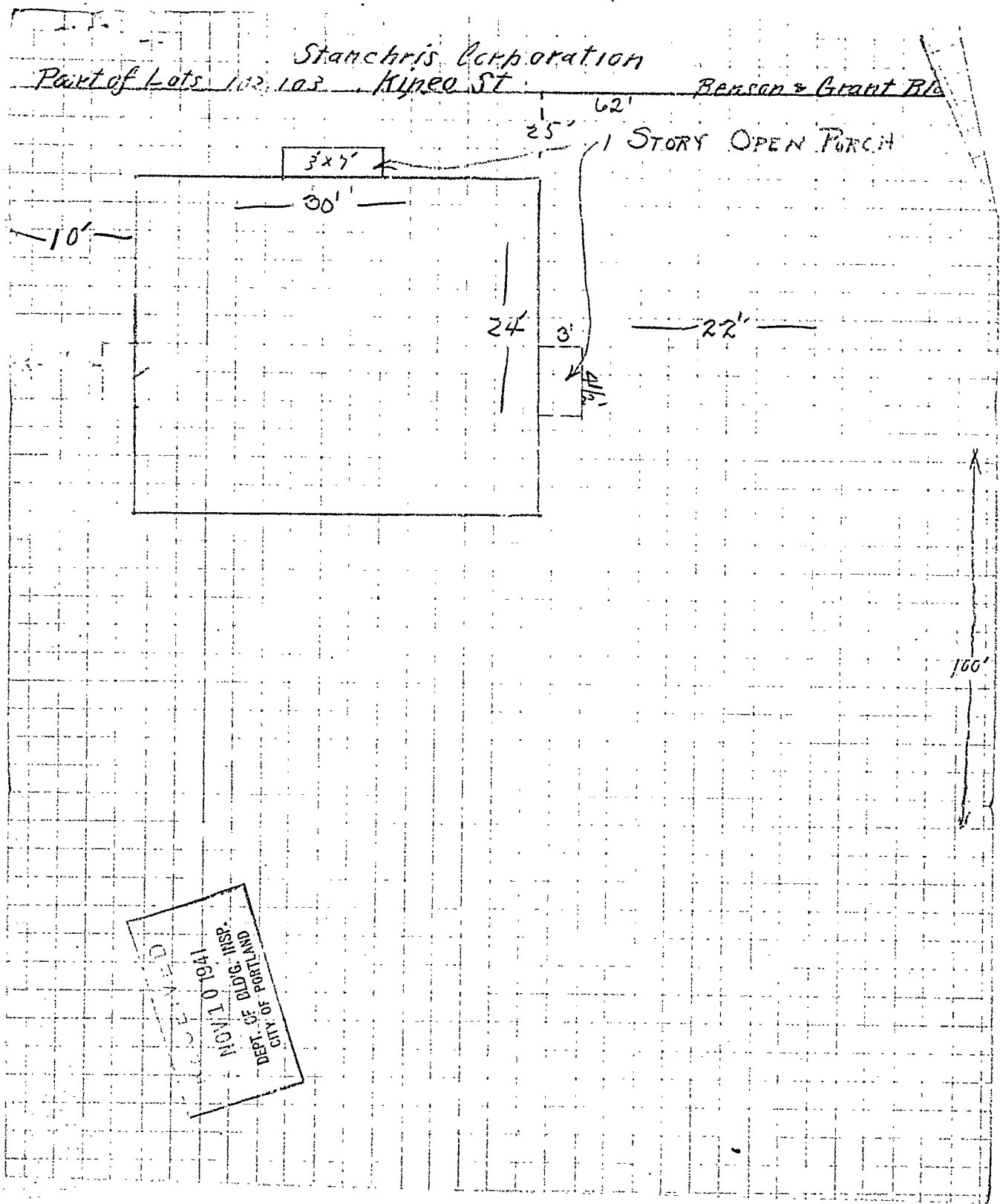

Stanchris Corporation
Part of Lots 102, 103, Kinco St Benson & Grant Bldg

1 STORY OPEN PORCH

10'

3x7'

30'

24'

3'

22'

25'

62'

100'

RECEIVED
NOV 10 1941
DEPT. OF BLDG. INSP.
DIVISION OF PERMITS
CITY OF ALBANY, N.Y.

STATEMENT ACCOMPANYING APPLICATION FOR BUILDING PERMIT

for one family dwelling house
at lots 102-103 Kineo Street Date 11/10/41

1. In whose name is the title of the property now recorded? Manetris Corp
2. Are the boundaries of the property in the vicinity of the proposed work shown clearly on the ground, and how? Sketches
3. Is the outline of the proposed work now staked out upon the ground? Will be
If not, will you notify the Inspection Office when the work is staked out and before any of the work is commenced? Yes
4. What is to be maximum projection or overhang of eaves or drip? 6"
5. Do you assume full responsibility for the correctness of the location plan or statement of location filed with this application, and does it show the complete outline of the proposed work on the ground, including bay windows, porches and other projections? Yes
6. Do you assume full responsibility for the correctness of all statements in the application concerning the sizes, design and use of the proposed building? Yes
7. Do you understand that in case changes are proposed in the location of the work or in any of the details specified in the application that a revised plan and application must be submitted to this office before the changes are made? Yes

Manetris Corporation
By Benjamin W. Benson
by Clinton W. Benson



APPLICATION FOR PERMIT

Permit No. 17 1941

Class of Building or Type of Structure Third Class

Portland, Maine, November 10, 1941

To the INSPECTOR OF BUILDINGS, PORTLAND, ME.

The undersigned hereby applies for a permit to erect alter and/or the following building structure equipment in accordance with the Laws of the State of Maine, the Building Code of the City of Portland, plans and specifications, if any, submitted herewith and the following specifications:

Location Lots 102-103 Kineo Street (29) Within Fire Limits? no Dist. No.

Owner's or Lessee's name and address Stanohris Corporation 199 Middle St. Telephone 3-9552

Contractor's name and address Benson & Grant Cumb Str. #1 Telephone 4-6002

Architect Standard Plan A Plans filed yes No. of sheets 1

Proposed use of building dwelling house No. families 1

Other buildings on same lot Fee \$ 3.00

Estimated cost \$ 3600.

Description of Present Building to be Altered

Material No. stories Heat Style of roof Roofing No. families

Last use

General Description of New Work INSPECTION NOT COMPLETED

To erect one family frame dwelling house

It is understood that this permit does not include installation of heating apparatus which is to be taken out separately by and in the name of the heating contractor.

Details of New Work

Is any plumbing work involved in this work? yes

Is any electrical work involved in this work? yes Height average grade to top of plate 9'

Size, front 22'30' depth 34' No. stories 1 Height average grade to highest point of roof 17'19'

To be erected on solid or filled land? solid earth or rock? earth

Material of foundation concrete Thickness top 10" bottom 12" cellar yes

Material of underpinning Height Thickness

Kind of roof pitch Rise per foot 10" Roof covering Asphalt roofing Class C Und. Lab.

No. of chimneys 2 Material of chimneys brick of lining tile

Kind of heat hot air Type of fuel coal Is gas fitting involved? yes

Framing lumber-Kind hemlock Dressed or full size? dressed

Corner posts 4x6 Sills 4x6 Girt or ledger board? none Size

Material columns under girders iron columns Size 4" Max. on centers 2'

Studs (outside walls and carrying partitions) 2x4-16" O. C. Girders 6x8 or larger. Bridging in every floor and flat roof span over 8 feet. Sills and corner posts all one piece in cross section no stairway

Joists and rafters: 1st floor 2x8 2nd 2x8 unf 3rd roof 2x8

On centers: 1st floor 12" 2nd 16" 12" 3rd roof 16"

Maximum span: 1st floor 12' 2nd 12' 3rd roof

If one story building with masonry walls, thickness of walls? height?

If a Garage

No. cars now accommodated on same lot to be accommodated

Total number commercial cars to be accommodated

Will automobile repairing be done other than minor repairs to cars habitually stored in the proposed building?

Miscellaneous

Will above work require removal or disturbing of any shade tree on a public street? no

Will there be in charge of the above work a person competent to see that the State and City requirements pertaining thereto are observed? yes

Signature of owner Stanohris Corporation By Benson & Grant

INSPECTION COPY



FILL IN AND SIGN WITH INK

APPLICATION FOR PERMIT FOR HEATING, COOKING OR POWER EQUIPMENT

Portland, Maine, August 18, 1947

PERMIT ISSUED
020518
AUG 18 1947

To the INSPECTOR OF BUILDINGS, PORTLAND, MAINE

The undersigned hereby applies for a permit to install the following heating, cooking or power equipment in accordance with the Laws of Maine, the Building Code of the City of Portland, and the following specifications:

Location 29 Kineo Street Use of Building Dwelling house No. Stories 1 1/2 Building Existing
Name and address of owner of appliance Albert J. Leighton, 29 Kineo Street
Installer's name and address Portland Sebago Ice Co., 302 Commercial St. Telephone 3-2911

General Description of Work

To install oil burning equipment in connection with existing forced warm air heating system

IF HEATER, OR POWER BOILER

Location of appliance or source of heat Type of floor beneath appliance
If wood, how protected? Kind of fuel
Minimum distance to wood or combustible material, from top of appliance or casing top of furnace
From top of smoke pipe. From front of appliance From sides or back of appliance
Size of chimney flue Other connections to same flue
If gas fired, how vented? Rated maximum demand per hour

IF OIL BURNER

Name and type of burner Delco Labelled by underwriter's laboratories? yes
Will operator be always in attendance? Does oil supply line feed from top or bottom of tank? bottom
Type of floor beneath burner concrete
Location of oil storage cellar Number and capacity of tanks 1-275 gal.
If two 275-gallon tanks, will three-way valve be provided?
Will all tanks be more than five feet from any flame? yes How many tanks fire proofed?
Total capacity of any existing storage tanks for furnace burners none

IF COOKING APPLIANCE

Location of appliance Kind of fuel Type of floor beneath appliance
If wood, how protected?
Minimum distance to wood or combustible material from top of appliance
From front of appliance From sides and back From top of smokepipe
Size of chimney flue Other connections to same flue
Is hood to be provided? If so, how vented?
If gas fired, how vented? Rated maximum demand per hour

MISCELLANEOUS EQUIPMENT OR SPECIAL INFORMATION

[Empty space for miscellaneous information]

Amount of fee enclosed? 1.00 (\$1.00 for one heater, etc., 50 cents additional for each additional heater, etc., in same building at same time.)

APPROVED: [Signature]

Will there be in charge of the above work a person competent to see that the State and City requirements pertaining thereto are observed? yes

Portland Sebago Ice Co.

Signature of Installer

by:

[Signature]

INSPECTION COPY

Permit No. 47/2058
Location 29 Hines St.
Owner Albert Leghton
Date of permit 8/18/47
Approved 5-12-48 [Signature]

NOTES

- 1. Fill Pipe
- 2. Vent Pipe
- 3. Kind of Heat Hot Water
- 4. Burner Rating & Supports
- 5. Name & Label
- 6. Stack Control
- 7. High Limit Control
- 8. Remote Control
- 9. Pipe Size, Spacing & Installation
- 10. Valves in Supply Line
- 11. Capacity of Tank
- 12. Tank Rating & Supports
- 13. Tank Distance
- 14. Oil Gauge
- 15. Instruction Card
- 16.



FILL IN COMPLETELY AND SIGN WITH INK

PERMIT ISSUED

Permit No. 0346
APR 2 1942

APPLICATION FOR PERMIT FOR HEATING, COOKING OR POWER EQUIPMENT

To the INSPECTOR OF BUILDINGS, PORTLAND, ME.

Portland, Maine, April 2, 1942

The undersigned hereby applies for a permit to install the following heating, cooking or power equipment in accordance with the Laws of Maine, the Building Code of the City of Portland, and the following specifications:

(29)
Location pt lots 102-103 Pineo St. Use of Building Dwelling No. Stories 1 New Building
Name and address of owner of appliance Stanchris Corp. 195 Middle St. Existing
Installer's name and address Frank L. Simonds, 1 Fountain Ave. Old Orchard Telephone 295

General Description of Work

To install hot air furnace

INSPECTION NOT COMPLETED

IF HEATER, POWER BOILER OR COOKING DEVICE

Is appliance or source of heat to be in cellar? yes If not, which story _____ Kind of Fuel coal
Material of supports of appliance (concrete floor or what kind) concrete
Minimum distance to wood or combustible material, from top of appliance or casing top of furnace, 2'
from top of smoke pipe 4' from front of appliance over 4' from sides or back of appliance over 4'
Size of chimney flue 8x8 Other connections to same flue none

IF OIL BURNER

Name and type of burner _____ Labeled and approved by Underwriters' Laboratories? _____
Will operator be always in attendance? _____ Type of oil feed (gravity or pressure) _____
Location oil storage _____ No. and capacity of tanks _____
Will all tanks be more than seven feet from any flame? _____ How many tanks fireproofed? _____

Amount of fee enclosed? 3.00 (\$1.00 for one heater, etc., 50 cents additional for each additional heater, etc., in same building at same time.)

INSPECTION COPY

Signature of Installer Frank L. Simonds 3626
4/2/42
OK

Sec 41/1783
 Permit No. 42/346
 Location *pt. Wels 102-103 Kings St.*
 Owner *Stanclius Corp*
 Date of Permit *4/2/42.*
 Post Card sent _____
 Notif. for insp. _____
 Approval Tag issued _____
 Oil Burner Check List (date) _____
 1. Kind of heat _____
 2. Label _____
 3. Anti-siphon _____
 4. Oil storage _____
 5. Tank distance _____
 6. Vent Pipe _____
 7. Fill Pipe _____
 8. Gauge _____
 9. Rigidity _____
 10. Feed safety _____
 11. Pipe sizes and material _____
 12. Control valve _____
 13. Ash pit vent _____
 14. Temp. or pressure safety _____
 15. Instruction card _____
 16. _____

NOTES

*8/11/42 - See filler on
 permit 42/346 - OK*

