

NOTE:  
 CONTRACTOR SHALL REMOVE ELECTRICAL OUTLETS, SWITCHES AND LIGHTING IN AREAS OF NEW WORK AND RELOCATE REMAINING ELECTRICAL LIGHTING IN CONFORMANCE WITH MAINE UNIFORM BUILDING AND ENERGY CODE AND NATIONAL ELECTRIC CODE. NEW OUTLETS, LIGHTING AND SWITCHING SHALL BE COORDINATED WITH OWNER. CONTRACTOR SHALL SUBMIT A SEPARATE PERMIT APPLICATION BY OTHERS. (TYPICAL WITHIN AREAS OF NEW WORK)

EXISTING HOT-WATER RADIATORS WITHIN AREA OF NEW WORK SHALL BE REMOVED AND REPLACED WITH NEW FLAT-PANEL RADIATORS. LOCATIONS SHALL BE ADJUSTED TO CONFORM TO NEW ROOM DIMENSIONS. CONTRACTOR SHALL BE COORDINATED IN FIELD WITH OWNER AND ARCHITECT. HEATING/PLUMBING SCOPE SHALL BE SUBMITTED UNDER SEPARATE PERMIT APPLICATION BY OTHERS. (TYPICAL WITHIN AREAS OF NEW WORK)

NEW CARBON MONOXIDE AND SMOKE ALARMS SHALL BE PROVIDED AND INSTALLED WHERE REQUIRED BY ALL APPLICABLE MAINE JURISDICTION OVER THE WORK.

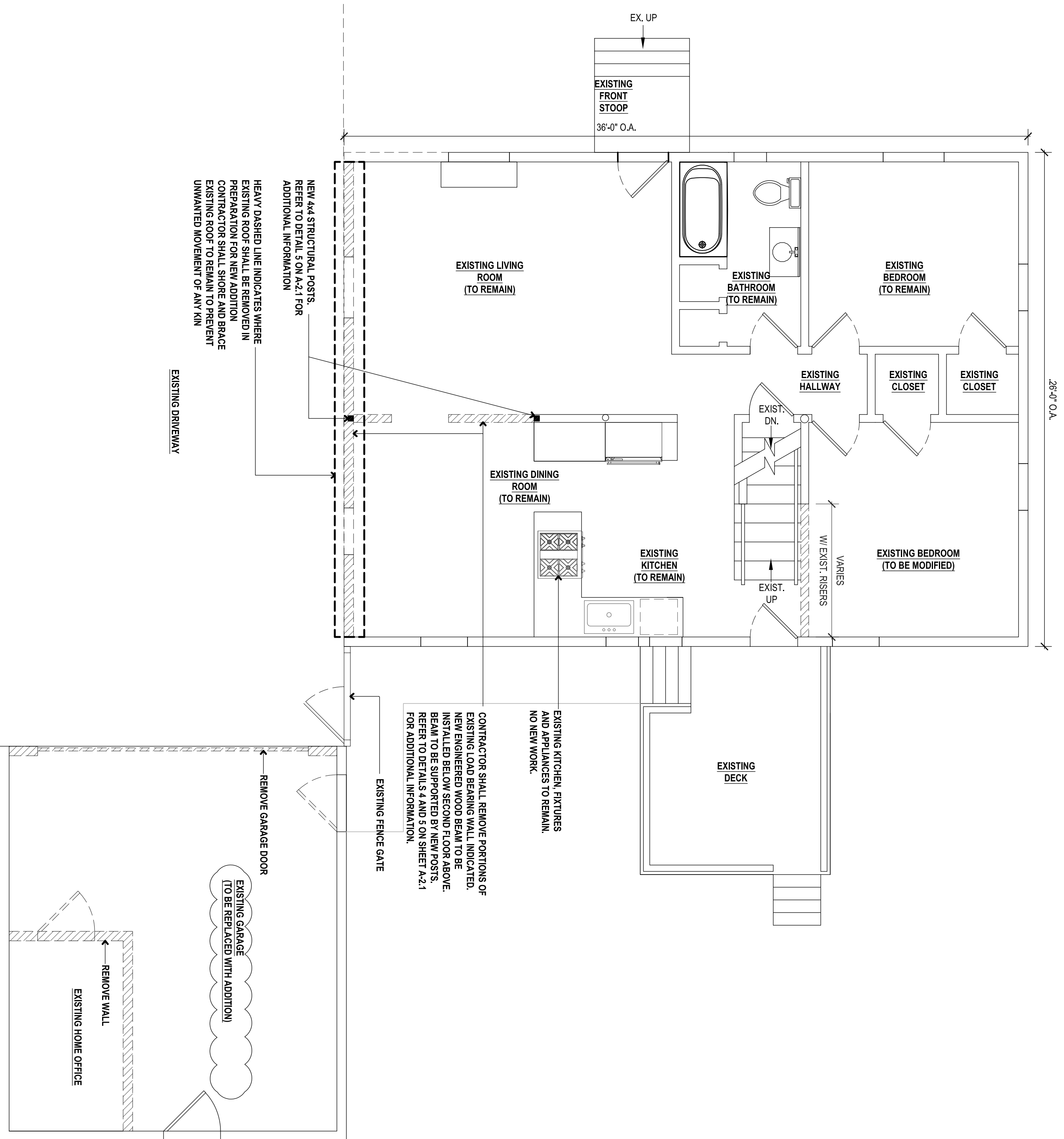

1 DEMOLITION PLAN  
 A1.0 SCALE 1/4" = 1'-0"



2 PROPOSED ADDITION / PLAN  
 A1.0 SCALE 1/4" = 1'-0"

**WELLWOOD RESIDENCE**  
 43 WELLWOOD ROAD  
 PORTLAND, MAINE

No.	Revision	Date
1	REDLINE REVISIONS	1608/14
2	PERMIT AMENDMENT	161027

revisions:  
 date: MAY 18, 2016  
 scale: As Noted  
 drawn: XX  
 checked: XX

Soren denHof Design Studio  
 43 Wellwood Road  
 Portland, ME  
 04103  
 T: 207-400-2450  
 E: soren@sorendenford.com