

DISPLAY THIS CARD ON PRINCIPAL FRONTAGE OF WORK



CITY OF PORTLAND BUILDING PERMIT

This is to certify that ME DOWN SYNDROME SUPPORT Located At 427 OCEAN AVE

Job ID: 2012-09-5008-SE

CBL: 159-G-001-001

has permission to ME Down Syndrome Network event 9/23

provided that the person or persons, firm or corporation accepting this permit shall comply with all of the provisions of the Statues of Maine and of the Ordinances of the City of Portland regulating the construction, maintenance and use of the buildings and structures, and of the application on file in the department.

Notification of inspection and written permission procured before this building or part thereof is lathed or otherwise closed-in. 48 HOUR NOTICE IS REQUIRED.

A final inspection must be completed by owner before this building or part thereof is occupied. If a certificate of occupancy is required, it must be

Fire Prevention Officer

Code Enforcement Officer / Plan Reviewer

**THIS CARD MUST BE POSTED ON THE STREET SIDE OF THE PROPERTY
PENALTY FOR REMOVING THIS CARD**

BUILDING PERMIT INSPECTION PROCEDURES

Please call 874-8703 or 874-8693 (ONLY)

or email: buildinginspections@portlandmaine.gov

With the issuance of this permit, the owner, builder or their designee is required to provide adequate notice to the city of Portland Inspections Services for the following inspections. Appointments must be requested 48 to 72 hours in advance of the required inspection. The inspection date will need to be confirmed by this office.

- **Please read the conditions of approval that is attached to this permit!! Contact this office if you have any questions.**
- **Permits expire in 6 months. If the project is not started or ceases for 6 months.**
- **If the inspection requirements are not followed as stated below additional fees may be incurred due to the issuance of a "Stop Work Order" and subsequent release to continue.**

The project cannot move to the next phase prior to the required inspection and approval to continue, REGARDLESS OF THE NOTICE OF CIRCUMSTANCES.

IF THE PERMIT REQUIRES A CERTIFICATE OF OCCUPANCY, IT MUST BE PAID FOR AND ISSUED TO THE OWNER OR DESIGNEE BEFORE THE SPACE MAY BE OCCUPIED.



PORTLAND MAINE

Strengthening a Remarkable City, Building a Community for Life • www.portlandmaine.gov

Director of Planning and Urban Development
Jeff Levine

Job ID: 2012-09-5008-SE

Located At: 427 OCEAN AVE

CBL: 159- G-001-001

Conditions of Approval:

Building

This permit DOES NOT authorize any construction activities. The tent(s)/ stage must be removed at the end of the event.

A separate permit is required for any temporary electrical work.

Application approval based upon information provided by applicant. Any deviation from approved plans requires separate review and approval prior to work.

City of Portland, Maine - Building or Use Permit Application

389 Congress Street, 04101 Tel: (207) 874-8703, FAX: (207) 8716

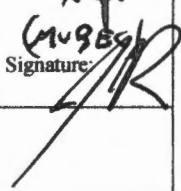
Job No: 2012-09-5008-SE	Date Applied: 9/20/2012	CBL: 159- G-001-001	
Location of Construction: 427 OCEAN AVE - Payson Park	Owner Name: CITY OF PORTLAND	Owner Address: 389 CONGRESS ST PORTLAND, ME 04101	Phone:
Business Name: Down Syndrome Support event	Contractor Name:	Contractor Address:	Phone:
Lessee/Buyer's Name: Jen Greslick	Phone: 233-8238	Permit Type: TENTS	Zone: ROS
Past Use: City Park	Proposed Use: Same: City Park - to setup on 9/23/2012 on 30' x 60' tent with stage for Down Syndrome support event - break down on 9/23/2012	Cost of Work:	CEO District:
		Fire Dept: <input type="checkbox"/> Approved <input type="checkbox"/> Denied <input type="checkbox"/> N/A Signature:	Inspection: Use Group: Type: Temp. Signature: 
Proposed Project Description: Event on 9/23		Pedestrian Activities District (P.A.D.)	

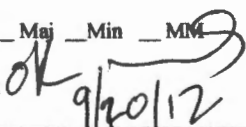
Permit Taken By: Brad	Zoning Approval		
<p>1. This permit application does not preclude the Applicant(s) from meeting applicable State and Federal Rules.</p> <p>2. Building Permits do not include plumbing, septic or electrical work.</p> <p>3. Building permits are void if work is not started within six (6) months of the date of issuance. False informatin may invalidate a building permit and stop all work.</p>	Special Zone or Reviews <input type="checkbox"/> Shoreland <input type="checkbox"/> Wetlands <input type="checkbox"/> Flood Zone <input type="checkbox"/> Subdivision <input type="checkbox"/> Site Plan <input type="checkbox"/> Maj <input type="checkbox"/> Min <input type="checkbox"/> MM Date:  9/20/12	Zoning Appeal <input type="checkbox"/> Variance <input type="checkbox"/> Miscellaneous <input type="checkbox"/> Conditional Use <input type="checkbox"/> Interpretation <input type="checkbox"/> Approved <input type="checkbox"/> Denied Date:	Historic Preservation <input type="checkbox"/> Not in Dist or Landmark <input type="checkbox"/> Does not Require Review <input type="checkbox"/> Requires Review <input type="checkbox"/> Approved <input type="checkbox"/> Approved w/Conditions <input type="checkbox"/> Denied Date:

CERTIFICATION

I hereby certify that I am the owner of record of the named property, or that the proposed work is authorized by the owner of record and that I have been authorized by the owner to make this application as his authorized agent and I agree to conform to all applicable laws of this jurisdiction. In addition, if a permit for work described in the appication is issued, I certify that the code official's authorized representative shall have the authority to enter all areas covered by such permit at any reasonable hour to enforce the provision of the code(s) applicable to such permit.

SIGNATURE OF APPLICANT	ADDRESS	DATE	PHONE
RESPONSIBLE PERSON IN CHARGE OF WORK, TITLE		DATE	PHONE



jen@dsmaine.org

Tent/Canopy or Temporary Event

Staging Permit Application

2012-09-5008-5E

Entend 9/20/12

13

If you or the property owner owes real estate or personal property taxes or user charges on any property within the City, payment arrangements must be made before permits of any kind are accepted.

Location/Address/Park of Installation: 427 Ocean Payson Park		
Date of Set up/Event: 9/23/12	Date of Breakdown/ End of Event: 9/23/12	
Tax Assessor's Chart, Block & Lot Chart# Block# Lot# 159 6001	Property Owner: City of Portland	Telephone:
Lessee/Buyer's Name (If Applicable)	Applicant name, address & telephone:	Fee: \$30.00

The permit fee and the following items must be completed and submitted along with this application in order to receive a permit.

RECEIVED
SEP 20 2012

30' x 60' tent
with stage

- Certificate of Flammability
- Letter of approval from property owner.
If the City is owner, attach a completed copy of Application to Use City Parks & Public Space from Parks & Recreation (756-8275).
- Company name of installer (contact info).
- Plot Plan showing the following:
Tent/Canopy or temporary event staging locations, including dimensions, exits and entrances of proposed and existing, parking and existing building locations. If this is temporary staging, you will need to include product information. (Applicant may call Parks & Recreation for maps of Portland's Parks @ 756-8275).
- If the City is the property owner, Certificate of Insurance listing the City as additional insured. Minimum amount of coverage is \$400,000.00 * EMAIL

Dept. of Building Inspections
City of Portland Maine

Who should we contact when permit is ready: Jen Greslick
Address: 15 Mallards Way, Windham 04092 Telephone: (207) 233-8238

Please submit all of the information outlined in the Tent/Canopy and Event Staging Permit Application as one package. Failure to do so will result in the automatic denial of your permit.

In order to be sure the City fully understands the full scope of the project, the Planning and Development Department may request additional information prior to the issuance of a permit. For further information visit us on-line at www.portlandmaine.gov, stop by the Building Inspections office, room 315 City Hall or call 874-8703.

I hereby certify that I am the Owner of record of the named property, or that the owner of record authorizes the proposed work and that I have been authorized by the owner to make this application as his/her authorized agent. I agree to conform to all applicable laws of this jurisdiction. In addition, if a permit for work described in this application is issued, I certify that the Code Official's authorized representative shall have the authority to enter all areas covered by this permit at any reasonable hour to enforce the provisions of the codes applicable to this permit.

Signature of applicant:	Date: 9/18/12
-------------------------	---------------

This is not a permit; you may not commence ANY work until the permit is issued.



PORTLAND MAINE

Strengthening a Remarkable City, Building a Community for Life • www.portlandmaine.gov

Receipts Details:

Tender Information: Check , Check Number: 1113

Tender Amount: 30.00

Receipt Header:

Cashier Id: bsaucier

Receipt Date: 9/20/2012

Receipt Number: 48446

Receipt Details:

Referance ID:	8087	Fee Type:	BP-Tent/Event
Receipt Number:	0	Payment Date:	
Transaction Amount:	30.00	Charge Amount:	30.00
Job ID: Job ID: 2012-09-5008-SE - Event on 9/23			
Additional Comments: 427 Ocean/Payson Pk			

Thank You for your Payment!



**CITY OF PORTLAND, RECREATION and FACILITIES
MANAGEMENT
PUBLIC PARK & SPACE APPLICATION (3 pages)**
134 Congress St. ~ Suite 2 ~Portland ~ ME ~ 04101
207-756-8275 ~ Fax 207-756-8279
tvm@portlandmaine.gov

For uses of city

property, there

are typically: 1. fees charged for use of the area
2. a security deposit required 3. insurance required
(There may be fees due and applications required from other City Departments)

TODAY'S DATE		9/10/12		ORGANIZATION NAME			Maine Down Syndrome Network				
ORGANIZATION ADDRESS			P.O. Box 705			CITY	Windham	STATE	ME	ZIP	04-62
CONTACT NAME(S)		Crystal Cochran/Jen Greslick		TITLE		Buddy Walk Co-ordinator/President					
HOME #	WORK			CELL	749-2799 / 233-8238		FAX	866-571-2223			
EMAIL	crystal@dsmaine.org			EMAIL	jen@dsmaine.org						

PARK AREA OR PUBLIC SPACE REQUESTED		Payson Park, triangle part by the boulevard (1 st entrance closed to traffic) Dyer's Flat for overflow parking BC Pathway for walk									
EVENT DAY & DATE(S)		Sunday, September 23, 2012				RAIN DAY & DATE(S)		none			
EVENT START TIME (i.e. set-up start time)		Setup 9am, reg. 1130, walk1pm		EVENT END TIME (i.e. when event cleanup is complete)		Clean up done by 4		ACTUAL START & END TIME OF EVENT		1-3, on path at 1	

EVENT NAME		EXPECTED ATTENDANCE	
Buddy Walk		300 - 500	
DESCRIPTION OF EVENT: Please be specific regarding area of public space/park and describe Event in detail.			
A fundraiser and family event for children with down syndrome. Walkers walk as much of the path as they wish, return for food, music, and festivities. Canopies and tent (30x60') set up on the grass area. Tables + chairs. Moonbounce (and climbing rock wall ?) set up on grass for kids. Refreshments on site. Music/Band/DJ... small stage on grass. Electricity is needed.			
IS THERE A REGISTRATION FEE?		yes	
IF YES, HOW MUCH?		FEE	
		\$10 adult/\$5 children	

WHAT WILL BE THE ANTICIPATED NEED FOR PARKING AND WHAT IS YOUR PARKING PLAN?
Dyer Flats has worked in the pa st

PLEASE CHECK OFF AND ANSWER:

PLEASE SEE ATTACHED FEE SCHEDULE / DEPT. INFORMATION IF YOU ANSWER YES

	X-YES	X-NO	X-NOT SURE
* Are you setting up a canopy(s) ? (canopy is 10x10 size) How many:	X		
* Do you wish to set up a tent(s) ? (a canopy or tent larger than 10x10 needs to be approved by Recreation and a Tent Permit issued from Inspections Division; please call Inspections for information on their application process / PLEASE give them at least a 2-week notice). Recreation will contact Inspections once the tent location is approved so that the Tent Permit Application may go forward. State size(s): 30 x 60 Exact Location(s) of Tent Placement Requested: Triangle Grass Area In order to drive tent stakes into the ground, DIG SAFE must be contacted: 888-344-7233.	X		
* Will you be setting up tables and/or chairs ? How many tables: 10-12 chairs:	X		

*	Are other items or equipment being placed on City property ? (i.e. Moon Bounce, Dunk Tank, Radio Station Van, Helium Tank, etc.) Please List:	X		
*	Will there be refreshments at the event? Do you wish to sell food ? NO (If so, you will need approval from Recreation) List food and drink: A Temporary Food Service License (from the City Clerk's Office) is needed, even if food is given away (and even if it is pre-packaged). PLEASE give the Clerk's Office at least a 2-week notice.	X (NOT SELLING)		
*	Do you wish to sell non-food items (like T-shirts, crafts, cd's, etc.) ? If so, you will need approval from Recreation, and you will need to apply for a Street Goods Vendor License(s) at the City Clerk's Office. List items you wish to sell: ??????????	X		
*	Are you setting up a PA (sound) system ? Are you planning on having Amplified Music ? YES If so, your event requires a concert license from the City Clerk's Office. (Just voice – i.e. Press Conference, would not require the license because it is not music). For amplified music/speech, there are time restrictions for the Downtown Parks & Squares (music limited to 11:45am – 1:15pm, and 1 hour between 5pm - 8pm).	X		
*	Will your event require electricity ? Electricity is available at some of the parks &	X		
*	Are you planning on bringing a Grill for a Barbecue ? Only Gas Grills are allowed in the parks (NO CHARCOAL). Grilling is subject to weather conditions and possibly Fire Dept. review.		X	
*	Will the event require reserved parking spaces / parking meters ? How many? "No Parking" signs may be purchased at Public Services, 55 Portland Street.		X	
*	Will your event need safety vests, signs, barricades and/or cones ? Please list what you would like to borrow: A few orange vests and cones may usually be borrowed from Recreation. Barricades and signs are borrowed from Public Services, Customer Service.		X	
*	Will your event require street closures ? (Please be specific under "Description of Event")	X PARK ROAD		
*	Will your event require Police assistance? An event such as a road race, march in the		X	
*	Will your event require Fire/EMS assistance? (For a large walk/race, it is recommended.)		X	
*	Will your event require porta-restroom rental(s) or need existing porta-restrooms cleaned? (Some of the parks already have porta-restrooms. Event participants may use these, but a \$25 fee is assessed for events where attendance is 150 or more.)	X		

INSURANCE CERTIFICATE INFORMATION

*	Will your event require liability Insurance? (For an event such as a walkathon, race, festival, press conference, concert, etc., the city requires insurance coverage - general liability. The City of Portland needs to be named as additional insured in regards to the event activities on that date). If your event has been approved for serving food, Product Liability is also required, in addition to General Liability.	X		
If you answered yes, please have "City of Portland, Maine" listed as an additional insured on the certificate, in this way: certificate must say either: A) "the policy actually is endorsed to name the City of Portland as an Additional Insured" and a copy of the endorsement must come to the City of Portland with the certificate, or B) "the policy already includes an endorsement, such as the General Liability Expansion Endorsement, by which the City of Portland is, in fact, automatically made an additional insured." A Certificate which merely has a box checked under 'Addl Insr,' or which merely states The City of Portland is named as an Additional Insured, will not be acceptable. The amount of coverage must be shown on the certificate, and the minimum coverage amount is \$400,000. Please have your insurance company fax a copy to Portland Recreation: 207-756-8279 or email to tvm@portlandmaine.gov .				

RECREATION POLICIES

ELECTRICITY

All cords in the public way must be covered by rugs, mats or orange cones to avoid public hazard. If weather is inclement (drizzle, rain, snow, etc.) we require that you **not use** electricity, unless all connections and equipment are covered and protected from the elements.

BARBECUES - GAS GRILLS ONLY

Only GAS GRILLS are allowed in parks/public spaces – i.e. No Charcoal Grills. Barbecuing must first be approved by Recreation and is subject to weather conditions, and possible further review by the Fire Dept. Grills must be set up away from children's activities. You must bring a fire extinguisher with you to the grilling area.

PORTA-RESTROOMS / BATHROOM FACILITIES

Porta-Restrooms are required for large events and events where food is being served. Some of Portland's parks already have portable restrooms (*Preble Street Grass Area at the Preble Street Parking Lot – across from Hannafords, *Entrance to Dyer's Flat – beside Payson Park). If over 150 people are expected to attend the event, a \$25 user fee is required (paid to Recreation). The restrooms are cleaned M, W, & F. If you would like to guarantee that they are cleaned just prior to your event, then you need to call the porta-restroom company (Associated Septic, 799-1980, M-F) to request and pay for a cleaning.

TRASH

All groups must abide by our Carry In/ Carry Out Policy. Please bring extra trash bags and/or trash receptacles and remove all trash. You will need to haul all of your trash out of the park/public space or forfeit the security deposit(s). The area will be checked following your event and if the park is clean and conditions for use adhered to, your security deposit will be returned to you. Thank you in advance!

PARKING ON GRASS AREAS / SIDEWALKS / ILLEGALLY PARKED VEHICLES

Portland Recreation has a strict policy that prohibits vehicles from parking on grass areas/sidewalks/park streets. \$10 will be deducted from your security deposit for each vehicle parked on grass/sidewalk areas or vehicles parked illegally. **Any tire ruts/damage to the grass areas would mean a forfeit of your security deposits.**

TOBACCO FREE ZONES

By city ordinance, smoking is prohibited at and within 20 feet of the following outdoor recreation and event areas: downtown squares and plazas, trails, parks, playgrounds, beaches, and athletic facilities. Please make sure you pass this information along to participants / spectators at the event.

NOTIFICATION

Please keep a copy of this permit on site at all times. City staff may require proof of permit.

REVOCABLE PERMIT

- ◆ The City reserves the unconditional right to control or cancel events to protect and/or prohibit damage to public property.
- ◆ The City reserves the unconditional right to revoke or revise an issued permit.

I HAVE READ AND UNDERSTAND ALL OF THE ABOVE POLICIES	TYPE INITIALS	JG	DATE	9/10/12
---	----------------------	-----------	-------------	----------------

ASSUMPTION OF RISK & LIABILITY

Users of the area agree to accept the grounds in an "as is" condition and shall be responsible for all risk and liability in using the park/public space area for the said event. By returning this form, (should permission be granted to use city property), the above parties agree to indemnify and hold harmless the City of Portland, its employees and agents, from and against all claims arising out of activities during said event.

I have read the Assumption of Risk & Liability Agreement	TYPE INITIALS	JG	DATE	9/10/12
---	----------------------	-----------	-------------	----------------

CREDIT CARD INFORMATION

Visa or MasterCard Number		Exp Date (Mon/Yr)	
CREDIT CARD WILL ONLY BE CHARGED FOR SECURITY DEPOSIT(S) AS NEEDED			

PLEASE MAKE CHECKS PAYABLE TO "CITY OF PORTLAND"

- ◆ Please make out security deposit checks separate from permit fees.

TOTAL AMOUNT(S) DUE TO RECREATION (Please make all security deposit checks out separately)

Permit Fee for use of area: \$40 first hr. plus \$35 each additional hr. (i.e. a 3 hour event totals \$110) If your event is rained out / cancelled, the bulk of the fee is returned (however \$40 is non-refundable) Number of Hours of Use:	\$ 250 due	Vest, Barricade, Cone Deposit: \$10 per/item	\$?
Electricity: \$5per/hr	\$ 15 due	Public Space / Park Security Deposit: \$100	\$ 100 due
Key Deposit: \$50 per key	\$ n/a	Other (Porta-Restroom User Fee, etc.)	\$ 25 due if organizer not renting a unit

FOR OFFICE USE ONLY

DATE REC'D APPLICATION	9-10-2012	DATE REC'D INSURANCE	NEED	PERMIT FEE AMT REC'D	\$ NEED	SECURITY DEPOSIT	\$ NEED
PAYMENT TYPE							
VISA	\$	MC	\$	CK #	CK AMOUNT	\$	CASH AMT \$

Maine Down Syndrome Network
2012 Buddy Walk
Sunday Sept. 23, 2012

Payson Park

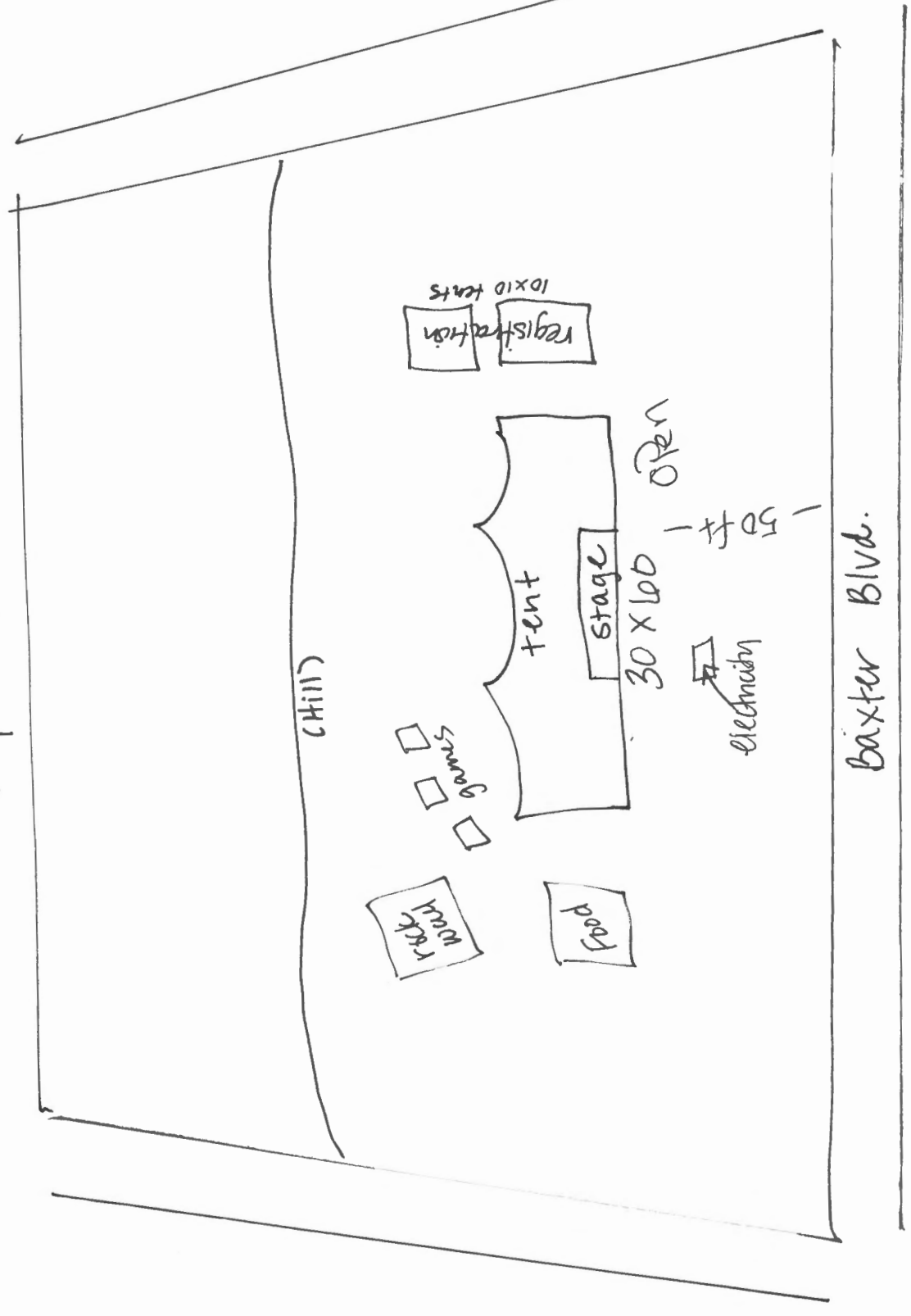

Certificate of Flame Resistance

REGISTERED
FABRIC
NUMBER

F-140.01

ISSUED BY

JOHNSON WORLDWIDE ASSOCIATES, INC.
BINGHAMTON, NEW YORK 13902

*Manufacturers of the Finest
Tent Products Described Herein*

Date of Manufacture

January 1998

This is to certify that the products herein have been manufactured from material inherently flame retardant as here after specified by the material supplier.

NAME: A Plus Party Rental
CITY Scarborough STATE ME

Certification is hereby made that:

The articles described on this certificate have been manufactured with an approved flame retardant chemical in compliance with California State Fire Marshal Code, NFPA-701*, Underwriters Laboratory of Canada, and have been tested in accordance with the Federal Test Method Specifications and meet or exceed the Military Flame Specifications of MIL-C-43006G.

Type, color and weight of material: 15oz Vinyl White Blockout

Description of item certified: New 30x60 2PC Traditional Party Top

**Flame Retardant Process Used Will Not Be Removed By Washing And
Is Effective For The Life Of The Fabric**

Snyder Manufacturing, Inc.

Manufacturer of Flame Retardant Vinyl Laminates

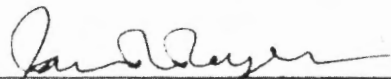
TENT DEPARTMENT, JOHNSON WORLDWIDE ASSOCIATES, INC.

* Large Scale



CERTIFICATE OF LIABILITY INSURANCE

DATE (MM/DD/YYYY)
9/19/2012

THIS CERTIFICATE IS ISSUED AS A MATTER OF INFORMATION ONLY AND CONFERS NO RIGHTS UPON THE CERTIFICATE HOLDER. THIS CERTIFICATE DOES NOT AFFIRMATIVELY OR NEGATIVELY AMEND, EXTEND OR ALTER THE COVERAGE AFFORDED BY THE POLICIES BELOW. THIS CERTIFICATE OF INSURANCE DOES NOT CONSTITUTE A CONTRACT BETWEEN THE ISSUING INSURER(S), AUTHORIZED REPRESENTATIVE OR PRODUCER, AND THE CERTIFICATE HOLDER.

IMPORTANT: If the certificate holder is an ADDITIONAL INSURED, the policy(ies) must be endorsed. If SUBROGATION IS WAIVED, subject to the terms and conditions of the policy, certain policies may require an endorsement. A statement on this certificate does not confer rights to the certificate holder in lieu of such endorsement(s).

PRODUCER Coastal Insurance Group LLC 558 Brighton Avenue Portland ME 04102	CONTACT NAME: Ralph Merrill
	PHONE (A/C No. Ext): (207) 797-4900 FAX (A/C No): (207) 874-4069 E-MAIL ADDRESS: RMM@SevignyGroup.com
INSURED Maine Down Syndrome Network 141 Rabbit Farm Road Warren ME 04864	INSURER(S) AFFORDING COVERAGE NAIC #
	INSURER A: New England Excess Exchange, L
	INSURER B:
	INSURER C:
	INSURER D:
	INSURER E:

COVERAGES **CERTIFICATE NUMBER: CL1291902232** **REVISION NUMBER:**

THIS IS TO CERTIFY THAT THE POLICIES OF INSURANCE LISTED BELOW HAVE BEEN ISSUED TO THE INSURED NAMED ABOVE FOR THE POLICY PERIOD INDICATED. NOTWITHSTANDING ANY REQUIREMENT, TERM OR CONDITION OF ANY CONTRACT OR OTHER DOCUMENT WITH RESPECT TO WHICH THIS CERTIFICATE MAY BE ISSUED OR MAY PERTAIN, THE INSURANCE AFFORDED BY THE POLICIES DESCRIBED HEREIN IS SUBJECT TO ALL THE TERMS, EXCLUSIONS AND CONDITIONS OF SUCH POLICIES. LIMITS SHOWN MAY HAVE BEEN REDUCED BY PAID CLAIMS.

INSR LTR	TYPE OF INSURANCE	ADDL INSR	SUBR WVD	POLICY NUMBER	POLICY EFF (MM/DD/YYYY)	POLICY EXP (MM/DD/YYYY)	LIMITS
A	GENERAL LIABILITY			TBD	9/23/2012	9/24/2012	EACH OCCURRENCE \$ 1,000,000
	<input checked="" type="checkbox"/> COMMERCIAL GENERAL LIABILITY						DAMAGE TO RENTED PREMISES (Ea occurrence) \$ 100,000
	<input type="checkbox"/> CLAIMS-MADE <input checked="" type="checkbox"/> OCCUR						MED EXP (Any one person) \$ 5,000
	GEN'L AGGREGATE LIMIT APPLIES PER:						
	<input checked="" type="checkbox"/> POLICY <input type="checkbox"/> PROJECT <input type="checkbox"/> LOC						GENERAL AGGREGATE \$ 2,000,000
							PRODUCTS - COMP/OP AGG \$ Included
	AUTOMOBILE LIABILITY						COMBINED SINGLE LIMIT (Ea accident) \$
	<input type="checkbox"/> ANY AUTO						BODILY INJURY (Per person) \$
	<input type="checkbox"/> ALL OWNED AUTOS						BODILY INJURY (Per accident) \$
	<input type="checkbox"/> HIRED AUTOS						PROPERTY DAMAGE (Per accident) \$
	<input type="checkbox"/> SCHEDULED AUTOS						\$
	<input type="checkbox"/> NON-OWNED AUTOS						\$
	UMBRELLA LIAB						EACH OCCURRENCE \$
	<input type="checkbox"/> OCCUR						AGGREGATE \$
	EXCESS LIAB						\$
	<input type="checkbox"/> CLAIMS-MADE						\$
	DED						RETENTION \$
	WORKERS COMPENSATION AND EMPLOYERS' LIABILITY						WC STATUTORY LIMITS
	ANY PROPRIETOR/PARTNER/EXECUTIVE OFFICER/MEMBER EXCLUDED? (Mandatory in NH)						OTH-ER
	If yes, describe under DESCRIPTION OF OPERATIONS below						E.L. EACH ACCIDENT \$
							E.L. DISEASE - EA EMPLOYEE \$
							E.L. DISEASE - POLICY LIMIT \$

DESCRIPTION OF OPERATIONS / LOCATIONS / VEHICLES (Attach ACORD 101, Additional Remarks Schedule, if more space is required)
City of Portland as Additional Insured by endorsement

CERTIFICATE HOLDER City of Portland 134 Congress St Portland, ME 04101	CANCELLATION SHOULD ANY OF THE ABOVE DESCRIBED POLICIES BE CANCELLED BEFORE THE EXPIRATION DATE THEREOF, NOTICE WILL BE DELIVERED IN ACCORDANCE WITH THE POLICY PROVISIONS. AUTHORIZED REPRESENTATIVE Ralph Merrill
---	---