

- NOTE:**
- CONTRACTOR SHALL PROVIDE AND INSTALL BYPASS DURING CONSTRUCTION OF CSO-006 DIVERSION STRUCTURE. BYPASS PIPING SHALL BE CAPABLE OF PASSING 86 CFS (PREDICTED 25-YEAR STORM FLOW).
 - SEE CROSS SECTION FOR ADDITIONAL TRAIL REALIGNMENT CONSTRUCTION INFORMATION.
 - REFER TO DEMOLITION NOTES FOR INFORMATION ON OLD BRIDGE STRUCTURE BETWEEN STATIONS 9+59 AND 10+22.

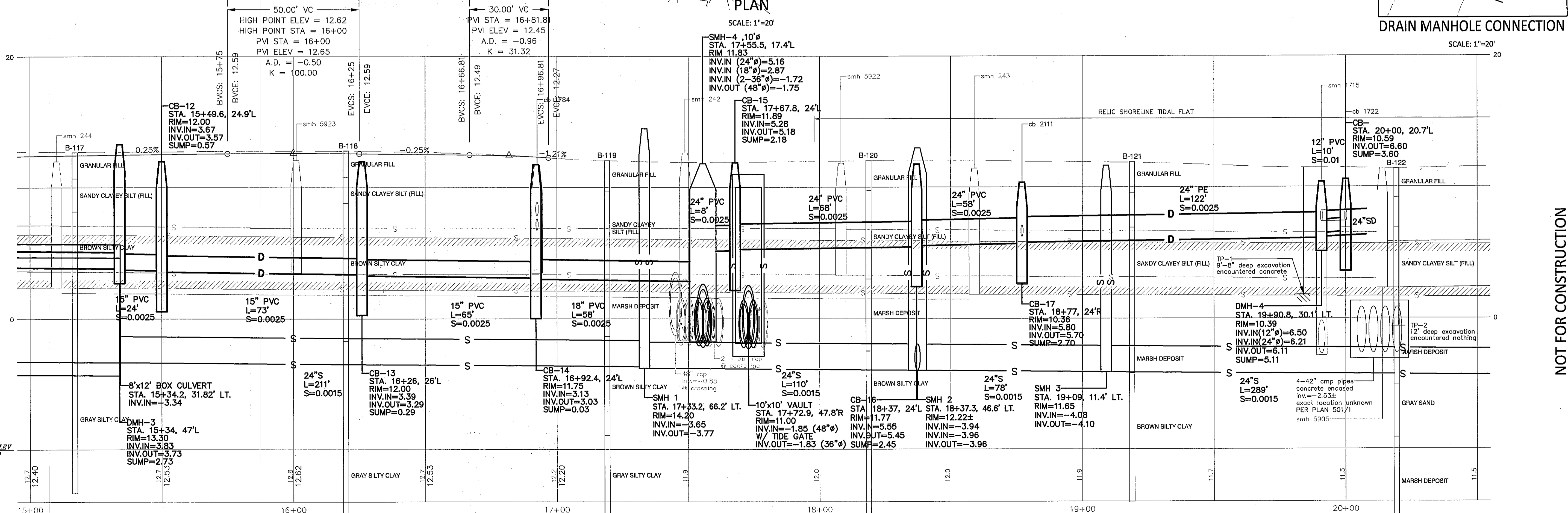

DD PROJECT NAME: BAXTER BOULEVARD NORTH STORAGE CONDUIT

DRAWING NAME: 09006PP

FIELD BOOK USED: N/A

REFERENCES:
 09006ppi.dwg, TAB: BAXTER 15+00-20+50

DESIGNED BY: [Blank]
APP: [Blank]
DRAWN BY: [Blank]
CHECKED BY: [Blank]
SCALE: [Blank]
DATE: 11-09-2011

BAXTER BOULEVARD NORTH STORAGE CONDUIT PLAN & PROFILE
STATIONS 15+00 TO 20+50

NOT FOR CONSTRUCTION

CITY OF PORTLAND, MAINE
PUBLIC WORKS DEPARTMENT
ENGINEERING DIVISION

SHEET # 11 OF #PGS
PLAN NUMBER VPLAN#