

DISPLAY THIS CARD ON PRINCIPAL FRONTAGE OF WORK CITY OF PORTLAND

Please Read
Application And
Notes, If Any,
Attached

BUILDING INSPECTION

PERMIT

Permit Number: 081148

This is to certify that SANTORO JOHN R & BRIGIDA CHARLETTE ITS/ Shed Housens

has permission to Addition of Prebuilt 8'x12' Shed

AT 15 MURRAY ST L 159 D015001

provided that the person or persons who perform or supervise the construction of this permit shall comply with all of the provisions of the Statutes of the State and of the Ordinances of the City of Portland regulating the construction, maintenance and use of buildings and structures, and of the application on file in this department.

Notification of inspection must be given and when permission is procured before this building or part thereof is occupied or closed-in. 24 HOUR NOTICE IS REQUIRED.

A certificate of occupancy must be procured by owner before this building or part thereof is occupied.

Apply to Public Works for street line and grade if nature of work requires such information.

OTHER REQUIRED APPROVALS

Fire Dept. _____

Health Dept. _____

Appeal Board _____

Other _____

CITY OF PORTLAND
Department Name

PERMIT ISSUED

SEP 17 2008

9/17/08 *[Signature]*
Director - Building & Inspection Services

PENALTY FOR REMOVING THIS CARD

City of Portland, Maine - Building or Use Permit Application

389 Congress Street, 04101 Tel: (207) 874-8703, Fax: (207) 874-8716

Permit No: 08-1148	Issue Date: 9/17/08	CBL: 159 D015001
-----------------------	------------------------	---------------------

Location of Construction: 15 MURRAY ST	Owner Name: SANTORO JOHN R & BRENDA C	Owner Address: 15 MURRAY ST	Phone: 207-874-0853
Business Name:	Contractor Name: Shed Happens	Contractor Address: 1042 Chadborne Rd. Standish	Phone: 2078923636
Lessee/Buyer's Name	Phone:	Permit Type: Additions - Dwellings	Zone: R-3

Past Use: Single Family Home	Proposed Use: Single Family Home - Addition of Prebuilt 8'x12' Shed	Permit Fee: <input checked="" type="checkbox"/> \$50.00	Cost of Work: \$2,600.00	CEO District: 4
Proposed Project Description: Addition of Prebuilt 8'x12' Shed		FIRE DEPT: <input type="checkbox"/> Approved <input type="checkbox"/> Denied	INSPECTION: Use Group R-3 Type: JB IRC-2007 Signature: [Signature] 9/17/08	
		PEDESTRIAN ACTIVITIES DISTRICT (P.A.D.) Action: <input type="checkbox"/> Approved <input type="checkbox"/> Approved w/Conditions <input type="checkbox"/> Denied Signature: _____ Date: _____		

Permit Taken By: lmd	Date Applied For: 09/10/2008	Zoning Approval	
-------------------------	---------------------------------	------------------------	--

<p>1. This permit application does not preclude the Applicant(s) from meeting applicable State and Federal Rules.</p> <p>2. Building permits do not include plumbing, septic or electrical work.</p> <p>3. Building permits are void if work is not started within six (6) months of the date of issuance. False information may invalidate a building permit and stop all work..</p>	<p>Special Zone or Reviews</p> <input type="checkbox"/> Shoreland <input type="checkbox"/> Wetland <input type="checkbox"/> Flood Zone <input type="checkbox"/> Subdivision <input type="checkbox"/> Site Plan <p>Maj <input type="checkbox"/> Minor <input type="checkbox"/> MM <input type="checkbox"/></p> <p>OK w/conditions Date: 9/11/08 [Signature]</p>	<p>Zoning Appeal</p> <input type="checkbox"/> Variance <input type="checkbox"/> Miscellaneous <input type="checkbox"/> Conditional Use <input type="checkbox"/> Interpretation <input type="checkbox"/> Approved <input type="checkbox"/> Denied <p>Date: _____</p>	<p>Historic Preservation</p> <input checked="" type="checkbox"/> Not in District or Landmark <input type="checkbox"/> Does Not Require Review <input type="checkbox"/> Requires Review <input type="checkbox"/> Approved <input type="checkbox"/> Approved w/Conditions <input type="checkbox"/> Denied <p>[Signature]</p> <p>Date: _____</p>
---	--	--	--

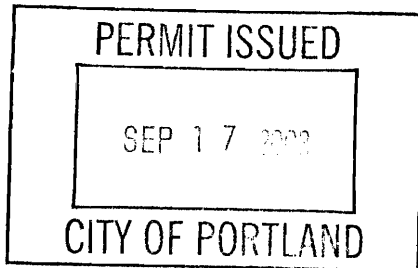

CERTIFICATION

I hereby certify that I am the owner of record of the named property, or that the proposed work is authorized by the owner of record and that I have been authorized by the owner to make this application as his authorized agent and I agree to conform to all applicable laws of this jurisdiction. In addition, if a permit for work described in the application is issued, I certify that the code official's authorized representative shall have the authority to enter all areas covered by such permit at any reasonable hour to enforce the provision of the code(s) applicable to such permit.

SIGNATURE OF APPLICANT	ADDRESS	DATE	PHONE
RESPONSIBLE PERSON IN CHARGE OF WORK, TITLE		DATE	PHONE

City of Portland, Maine - Building or Use Permit

389 Congress Street, 04101 Tel: (207) 874-8703, Fax: (207) 874-8716

Permit No: 08-1148	Date Applied For: 09/10/2008	CBL: 159 D015001
------------------------------	--	----------------------------

Location of Construction: 15 MURRAY ST	Owner Name: SANTORO JOHN R & BRENDA C	Owner Address: 15 MURRAY ST	Phone: 207-874-0853
Business Name:	Contractor Name: Shed Happens	Contractor Address: 1042 Chadborne Rd. Standish	Phone: (207) 892-3636
Lessee/Buyer's Name	Phone:	Permit Type: Additions - Dwellings	

Proposed Use: Single Family Home - Addition of Prebuilt 8'x12' Shed	Proposed Project Description: Addition of Prebuilt 8'x12' Shed
---	--

Dept: Zoning	Status: Approved with Conditions	Reviewer: Ann Machado	Approval Date: 09/11/2008
Note:			Ok to Issue: <input checked="" type="checkbox"/>
1) This property shall remain a single family dwelling. Any change of use shall require a separate permit application for review and approval.			
2) This permit is being approved on the basis of plans submitted. Any deviations shall require a separate approval before starting that work.			
Dept: Building	Status: Approved with Conditions	Reviewer: Chris Hanson	Approval Date: 09/17/2008
Note:			Ok to Issue: <input checked="" type="checkbox"/>
1) This structure is exempt from meeting the City of Portland Building Code based on size.			

- CALL BUREAU 877-8711 -



General Building Permit Application

If you or the property owner owes real estate or personal property taxes or user charges on any property within the City, payment arrangements must be made before permits of any kind are accepted.

Location/Address of Construction: <u>15 Murray St. Portland</u>		
Total Square Footage of Proposed Structure/Area <u>8 x 12' shed</u>	Square Footage of Lot <u>100' x 105'</u>	Number of Stories <u>1 1/2</u>
Tax Assessor's Chart, Block & Lot Chart# Block# Lot# <u>159- D - 15 - 16 - 17</u>	Applicant * must be owner, Lessee or Buyer* Name <u>Brenda and John Santoro</u> Address <u>15 Murray St.</u> City, State & Zip <u>Portland ME 04103</u>	Telephone: <u>(207) 874-0853</u>
Lessee/DBA (If Applicable)	Owner (if different from Applicant) Name <u>Same</u> Address _____ City, State & Zip _____	Cost Of Work: \$ <u>2600.</u> C of O Fee: \$ _____ Total Fee: \$ _____
Current legal use (i.e. single family) <u>SFH</u> Number of Residential Units <u>1</u> If vacant, what was the previous use? _____ Proposed Specific use: _____ Is property part of a subdivision? <u>no</u> If yes, please name _____ Project description: <u>SEP 10 2008</u>		
Contractor's name: <u>Shed Happens (or other - Millstore)</u> Address: _____ City, State & Zip _____ Telephone: _____ Who should we contact when the permit is ready: _____ Telephone: _____ Mailing address: _____		

Please submit all of the information outlined on the applicable Checklist. Failure to do so will result in the automatic denial of your permit.

In order to be sure the City fully understands the full scope of the project, the Planning and Development Department may request additional information prior to the issuance of a permit. For further information or to download copies of this form and other applications visit the Inspections Division on-line at www.portlandmaine.gov, or stop by the Inspections Division office, room 315 City Hall or call 874-8703.

I hereby certify that I am the Owner of record of the named property, or that the owner of record authorizes the proposed work and that I have been authorized by the owner to make this application as his/her authorized agent. I agree to conform to all applicable laws of this jurisdiction. In addition, if a permit for work described in this application is issued, I certify that the Code Official's authorized representative shall have the authority to enter all areas covered by this permit at any reasonable hour to enforce the provisions of the codes applicable to this permit.

Signature: Brenda Santoro Date: 9/10/8

This is not a permit; you may not commence ANY work until the permit is issue

Smart Siding

8' x 8' peak roof, black shingles

Pine

8' x 12' extended peak roof, white/gray shingles
Options: gable vents



SMART SIDING SHED SIZE & PRICE



PINE SHED SIZE & PRICE

SIZE (WALL)	6' wall HEIGHT	7' wall HEIGHT
6' x 6'	\$1,239	\$1,399
6' x 8'	\$1,329	\$1,519
8' x 8'	\$1,459	\$1,659
8' x 10'	\$1,719	\$1,949
8' x 12'	\$1,979	\$2,229
8' x 14'	\$2,339	\$2,669
8' x 16'	\$2,639	\$2,929
10' x 10'	\$2,139	\$2,369
10' x 12'	\$2,479	\$2,819
10' x 14'	\$2,869	\$3,269
10' x 16'	\$3,129	\$3,569
10' x 18'	\$3,469	\$3,909
12' x 12'	\$2,869	\$3,269
12' x 14'	\$3,259	\$3,739
12' x 16'	\$3,489	\$3,999
12' x 18'	\$3,969	\$4,529
12' x 20'	\$4,439	\$5,049

Why Smart Siding?

Our pre-primed engineered wood siding is tough on everything except your wallet. If you're looking for attractive durability at a value price we recommend Smart Siding.

- Pre-primed surface offers exceptional paint adhesion
- Smart Siding is knot free
- Trim and doors are unfinished pine
- All backed by **Sheds USA Lifetime Warranty**

8x12

SIZE (WALL)	6' wall HEIGHT	7' wall HEIGHT
6' x 6'	\$1,359	\$1,539
6' x 8'	\$1,449	\$1,639
8' x 8'	\$1,599	\$1,809
8' x 10'	\$1,839	\$2,029
8' x 12'	\$2,149	\$2,399
8' x 14'	\$2,459	\$2,699
8' x 16'	\$2,699	\$3,049
10' x 10'	\$2,199	\$2,459
10' x 12'	\$2,629	\$2,949
10' x 14'	\$2,939	\$3,279
10' x 16'	\$3,259	\$3,669
10' x 18'	\$3,569	\$4,029
12' x 12'	\$2,989	\$3,399
12' x 14'	\$3,339	\$3,809
12' x 16'	\$3,649	\$4,159
12' x 18'	\$4,089	\$4,639
12' x 20'	\$4,529	\$5,149

Why Pine?

For generations builders have been using pine siding. It's a New England tradition that will answer all your storage needs and flatter your yard for a lifetime.

- New England's most popular wood siding
- Solid tongue and groove construction
- Paint or stain to match your house
- All backed by **Sheds USA Lifetime Warranty**

Quality Construction

✓ Best Shed Warranty ✓ FREE Delivery and Installation



Most sheds are built within 3 hours of arrival.

Call toll-free at 866.616.2687 or visit www.millstores.com

Structurally the Best Shed Available

Our sheds are built on P.T. 4" x 4" Skids
 6' and 8' wide sheds have 2 x 4 floor joist 16" OC
 10' and wider sheds have 2 x 6 floor joist 16" OC
 3/4" CDX Floor Sheathing
 Walls and roof framing 2 x 4, 16" OC
 Industry first metal wall bracing
 7/16" OSB roof sheathing
 Drip edge on rakes and eaves, 25 yr asphalt shingles
 2- 8" x 8" Aluminum Gable Vents
 Shed 8 x 10 and smaller 1 window, larger with 2 windows
 Standard shed 1 door (30" single, 4' or 5' double barn)
 Collar ties on all gambrels and regulars 10' and wider

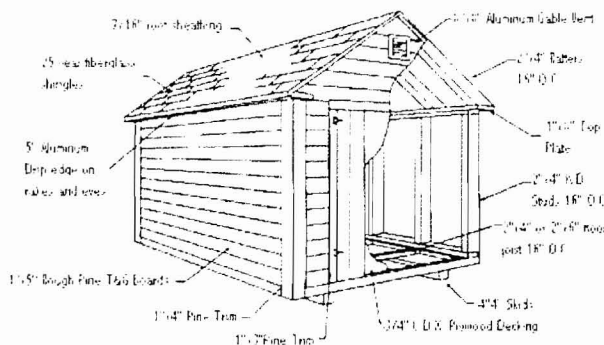

Notes

- Yes, There is a charge to build your shed on site (this charge may vary) Its better if you can to put the shed someplace you can move it if you ever need to
- The average cost to move one of our sheds is \$350.00, to move a shed built by our competition (our competitors do not offer the service of moving their sheds) \$500.00
- moving rocks, trash, or other item to have a clean safe work area will be charged a minimum fee of \$25.00
- All of our structures are ordered to your specifications so we shall charge a 20% restocking fee on any cancelled orders after construction has begun
- 1/3 payment is due upon ordering your shed, the remaining balance is due upon completion of the shed, upon delivery
- Failed or missed delivery appointments shall be charged \$150
- Materials are subject to change without notice at manufacturers discretion



2 x 4 framing 16" O.C.

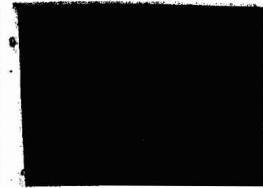

Industry First Metal Wall Bracing

Delivery

- Free delivery within 30 miles, we will deliver anywhere! (each additional mile over 30 will \$2.00 per mile)
- 8 cement blocks included in price (each end and 1 time in the middle up to 16' long, 2 times in the middle on 20' and larger)
- delivery is considered to be driveway only (as long as property owner assumes full non-binding responsibility, we will place your shed where you want within our abilities and reason)
- property owner is fully responsible for all permits to be obtained by their respective town (And are urged to do so) Also property owner is responsible to ensure all set backs from property lines are conformed to
- Site requires a 3' clear perimeter around where shed will be placed, land grade must be less then 12" from highest to lowest points with no protruding stumps or rocks, clear access to site is necessary
- Delivery schedule shall be Monday through Thursday, any shed that requires a Friday or Saturday delivery will be charged an additional \$100.00

Limited Warranty

Shed Happens, Inc. warrants your building to the original owner as long as it remains in its original location against defects in workmanship and materials for 10 years, under normal residential use only. Our structures are not designed for commercial applications, except by written agreement with our customers. Shed Happens, Inc. makes no warranty expressed or implied with respect to customer's designs and specifications, except that products will be free from defects in workmanship and materials as indicated previously. No warranties are made, expressed or implied, with respect to doors and windows which are used in the construction of our buildings.

Screenhouse

We offer High Quality Screen Houses with removable metal screens. Available in all sizes, prices are same as Gambrel Shed Prices.

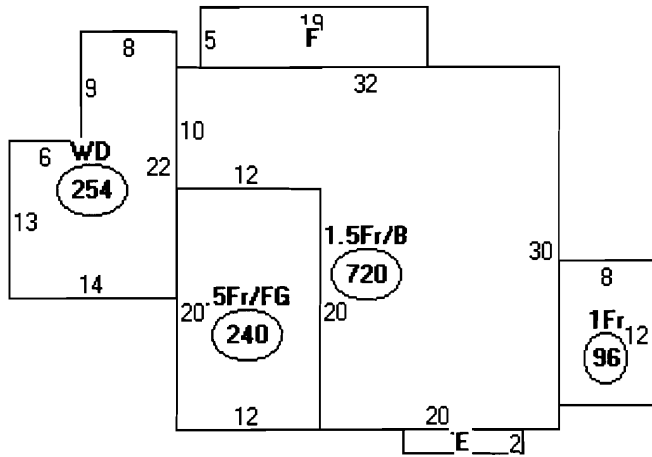

Descriptor/Area

- A: 1.5Fr/B
720 sqft
- B: .5Fr/FG
240 sqft
- C: WD
254 sqft
- D: 1Fr
96 sqft
- E: FBAY
20 sqft
- F: 1Fr
95 sqft

1425

100' ±

chain link fence

Chain link fence

105' ±

wooden post fence

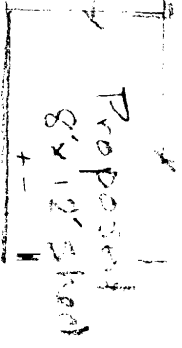

30' ±

10' ±