

**City of Portland, Maine - Building or Use Permit**

389 Congress Street, 04101 Tel: (207) 874-8703, Fax: (207) 874-8716

<b>Permit No:</b> 06-1325	<b>Date Applied For:</b> 09/08/2006	<b>CBL:</b> 159 B028001
------------------------------	--	----------------------------

<b>Location of Construction:</b> 26 ROSEDALE ST	<b>Owner Name:</b> DEL TERGO SARAH	<b>Owner Address:</b> 26 ROSEDALE ST	<b>Phone:</b>
<b>Business Name:</b>	<b>Contractor Name:</b> Bob Swan	<b>Contractor Address:</b> 95 Morton Road Yarmouth	<b>Phone</b> (207) 653-2235
<b>Lessee/Buyer's Name</b>	<b>Phone:</b>	<b>Permit Type:</b> Alterations - Dwellings	

<b>Proposed Use:</b> Single Family replace kitchen window with larger 40" x 56" window and remove kitchen wall	<b>Proposed Project Description:</b> replace kitchen window with larger 40" x 56" window and remove kitchen wall
---	---

**Dept:** Zoning      **Status:** Approved      **Reviewer:** Marge Schmuckal      **Approval Date:** 09/14/2006

**Note:**      **Ok to Issue:**

**Dept:** Building      **Status:** Approved with Conditions      **Reviewer:** Tammy Munson      **Approval Date:** 09/28/2006

**Note:**      **Ok to Issue:**

- 1) The design load spec sheets for any engineered beam(s) must be submitted to this office.
- 2) Permit approved based on the plans submitted and reviewed w/owner/contractor, with additional information as agreed on and as noted on plans.
- 3) Separate permits are required for any electrical, plumbing, or HVAC systems. Separate plans may need to be submitted for approval as a part of this process.



# General Building Permit Application

If you or the property owner owes real estate or personal property taxes or user charges on any property within the City, payment arrangements must be made before permits of any kind are accepted.

Total Square Footage of Proposed Structure <u>MIA</u>		Square Footage of Lot <u>2</u>	
Tax Assessor's Chart, Block & Lot Chart# <u>159</u> Block# <u>B</u> Lot# <u>028</u>		Owner: <u>MICHA DELTERCO</u> <u>SAMMI</u>	Telephone: <u>874-7183</u>
Lessee/Buyer's Name (If Applicable) <u>N/A</u>		Applicant name, address & telephone: <u>MICHA DELTERCO</u> <u>26 ROSDALE ST</u> <u>PORTLAND, ME</u> <u>04103</u>	Cost Of Work: \$ <u>1800</u> Fee: \$ _____ C of O Fee: \$ <u>40.00</u>
Current Specific use: <u>SINGLE FAMILY RESIDENTIAL</u>			
If vacant, what was the previous use? _____			
Proposed Specific use: <u>same</u>			
Project description: <u>REPLACE KITCHEN WINDOW WITH LARGER WINDOW; OPEN UP KITCHEN TO DINING ROOM by removing a wall</u> <u>30" 40" X 36"</u>			
Mailing address: <u>26 ROSDALE ST</u> <u>PTLAND, ME</u> <u>04103</u>		Phone: <u>874-7183</u>	DEPT. OF BUILDING INSPECTIO CITY OF PORTLAND, ME SEP - 7 2006 RECEIVED

Please submit all of the information outlined in the Commercial Application Checklist. Failure to **do** so **will** result in the automatic denial of your permit.

I hereby certify that I am the Owner of record of the named property, or that the owner of record authorizes the proposed work and that I have been authorized by the owner to make this application as his/her authorized agent. I agree to conform to all applicable laws of this jurisdiction. In addition, if a permit for work described in this application is issued, I certify that the Code Official's authorized representative shall have the authority to enter all areas covered by this permit at any reasonable hour to enforce the provisions of the codes applicable to this permit.

Signature of applicant: <u>M. Delterco</u>	Date: <u>9/7/06</u>
--	---------------------

**This is not a permit; you may not commence ANY work until the permit is issued.**

2000 100

9" SECTION OF WALL  
TO REMOVED

KITCHEN

LR

2x4 Beam

TRAIL: 1x2x4x8

~~2x4 STUDS~~

2x4 STUDS

Post to Beam + columns.

REMOVAL OF WALL

9'

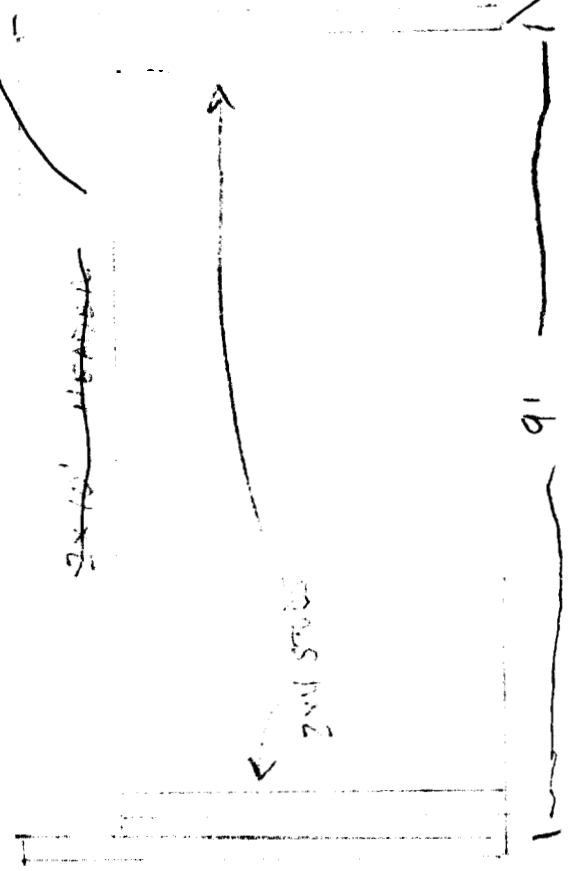
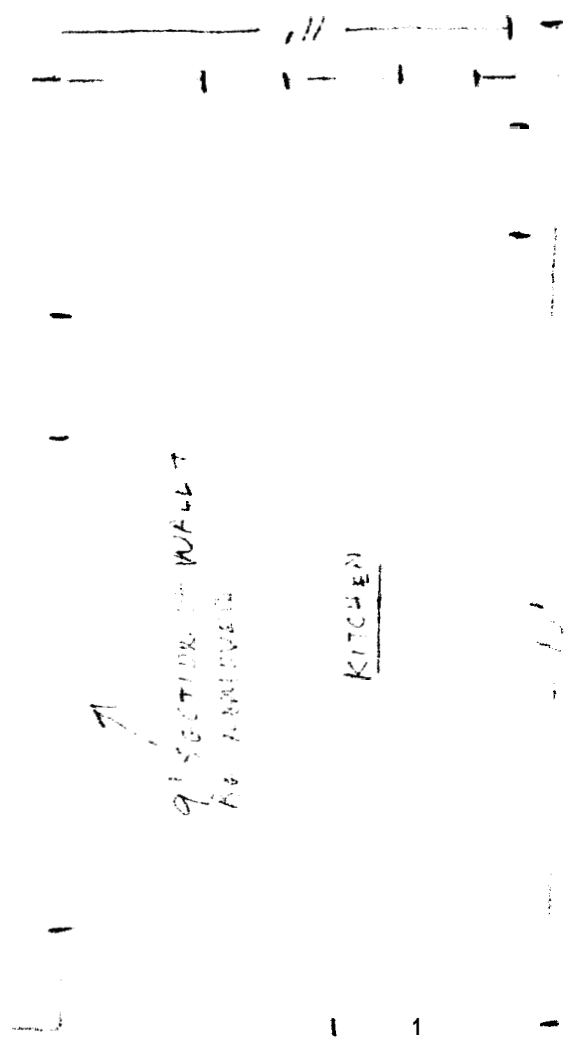

CURRENT KITCHEN W/D/D/W  
30" - 120" SPAN - FT. A. 120"  
TO 120" SPAN (CASE)

NEW KITCHEN W/D/D/W

6' 0" x 11' 0" x 11' 0" x 11' 0"

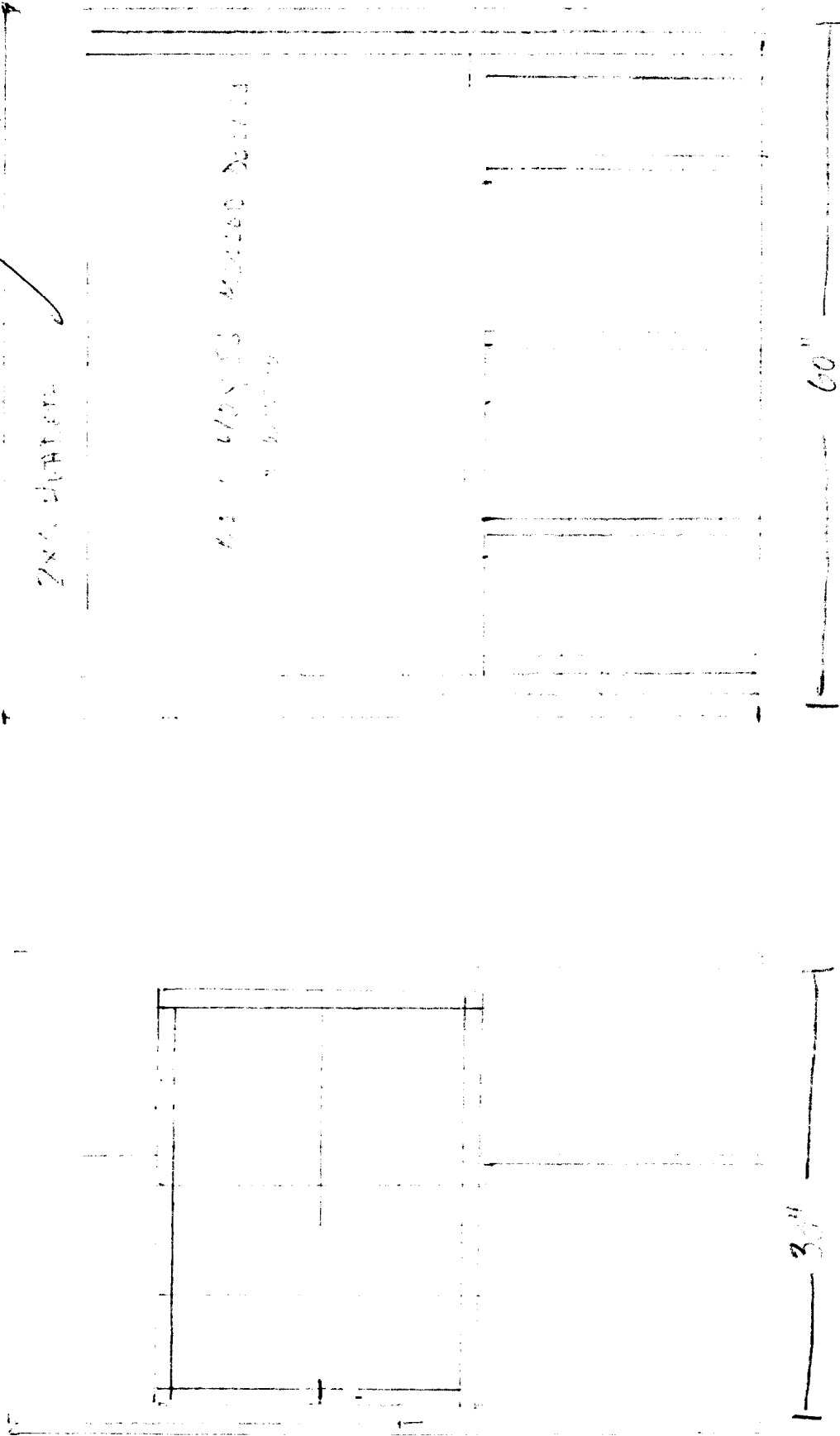

RE  
EXISTING  
W/D/D/W