

* All Dimensions are +/-

Scale 1/16" = 1'-0"

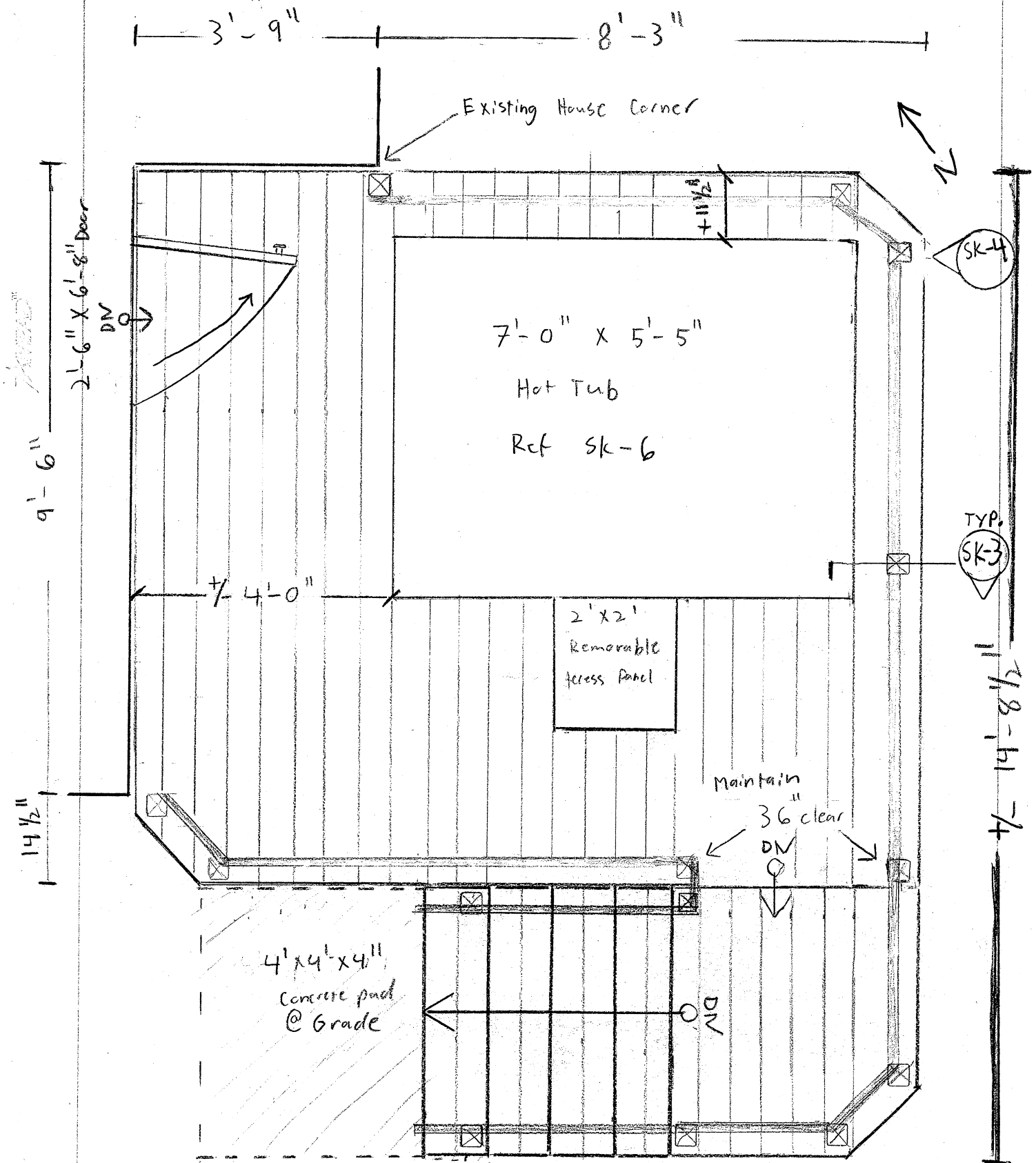

- 1 step down to landing @ 7 3/4" max rise
- 4 steps from landing to conc. pad @ 7 3/4" max rise w/ 11" run
- Rail cap and pickets not shown for clarity

Scale: 1/2" = 1'-0"



Existing House Corner

TYP. 2x8 P.T. Frame 12" O.C.

TYP. 4x4 Posts

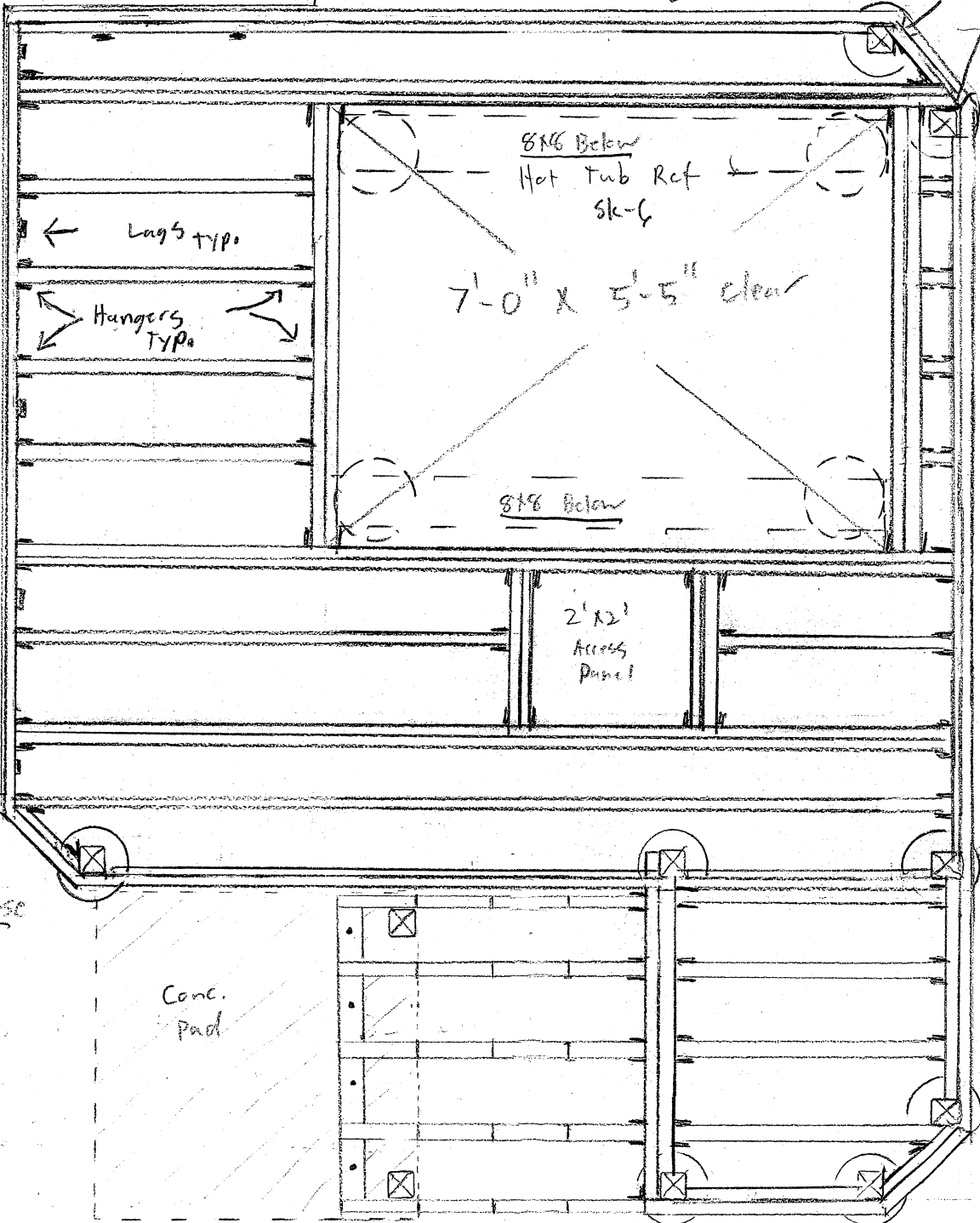

8x6 Below
Hot Tub Ref
SK-6

7'-0" X 5'-5" clear

8x6 Below

2'x2'
Access
Panel

TYP.
10" Sauna
Tubes

Existing House
Corner

Conc.
Pad

SK-5

- Fasten pickets 5" o.c. (4" sphere rule) use (4) S.S. 2 1/2" screws for each

SK-4
Sims

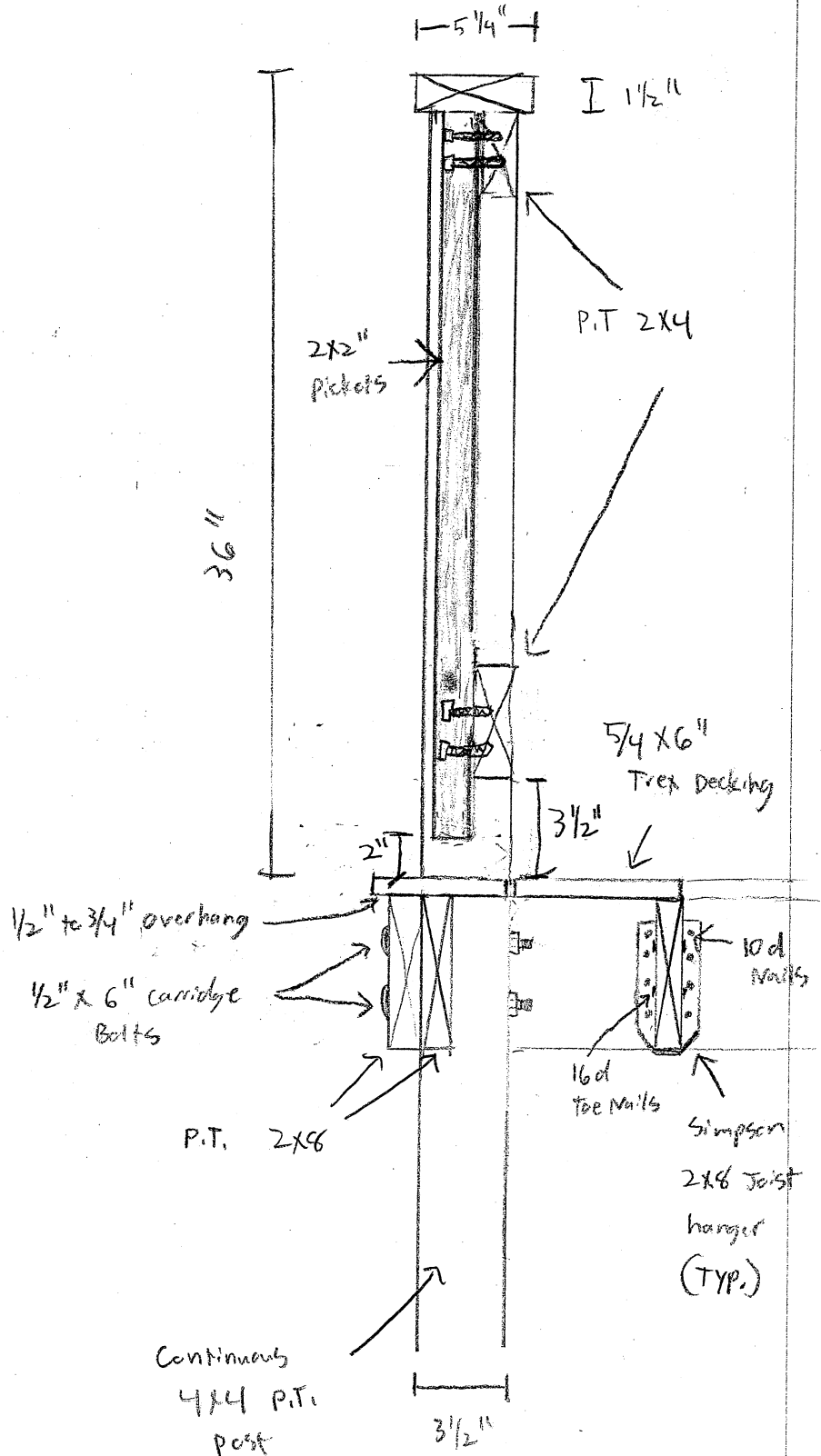

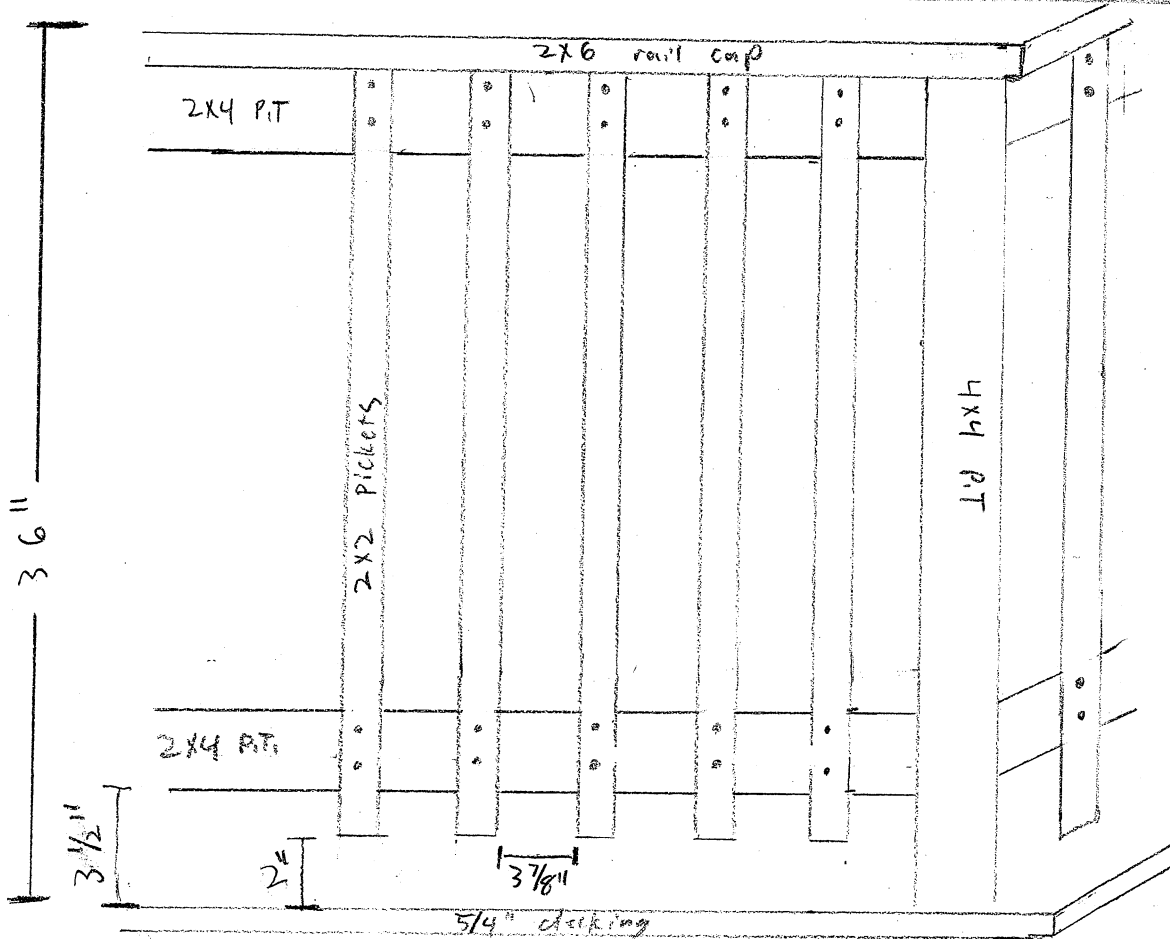

P.T. 2x8

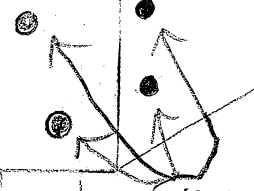

1/2" x 6" carriage bolts (TYP)

Simpson post base fastened w/ 10d nails

10" dia. saunna tube + 4" below grade

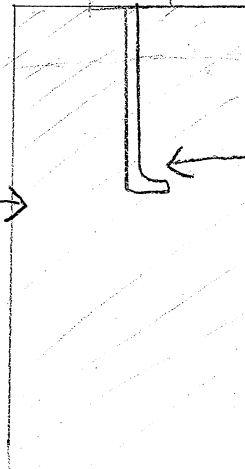

"L" bolt embed into concrete

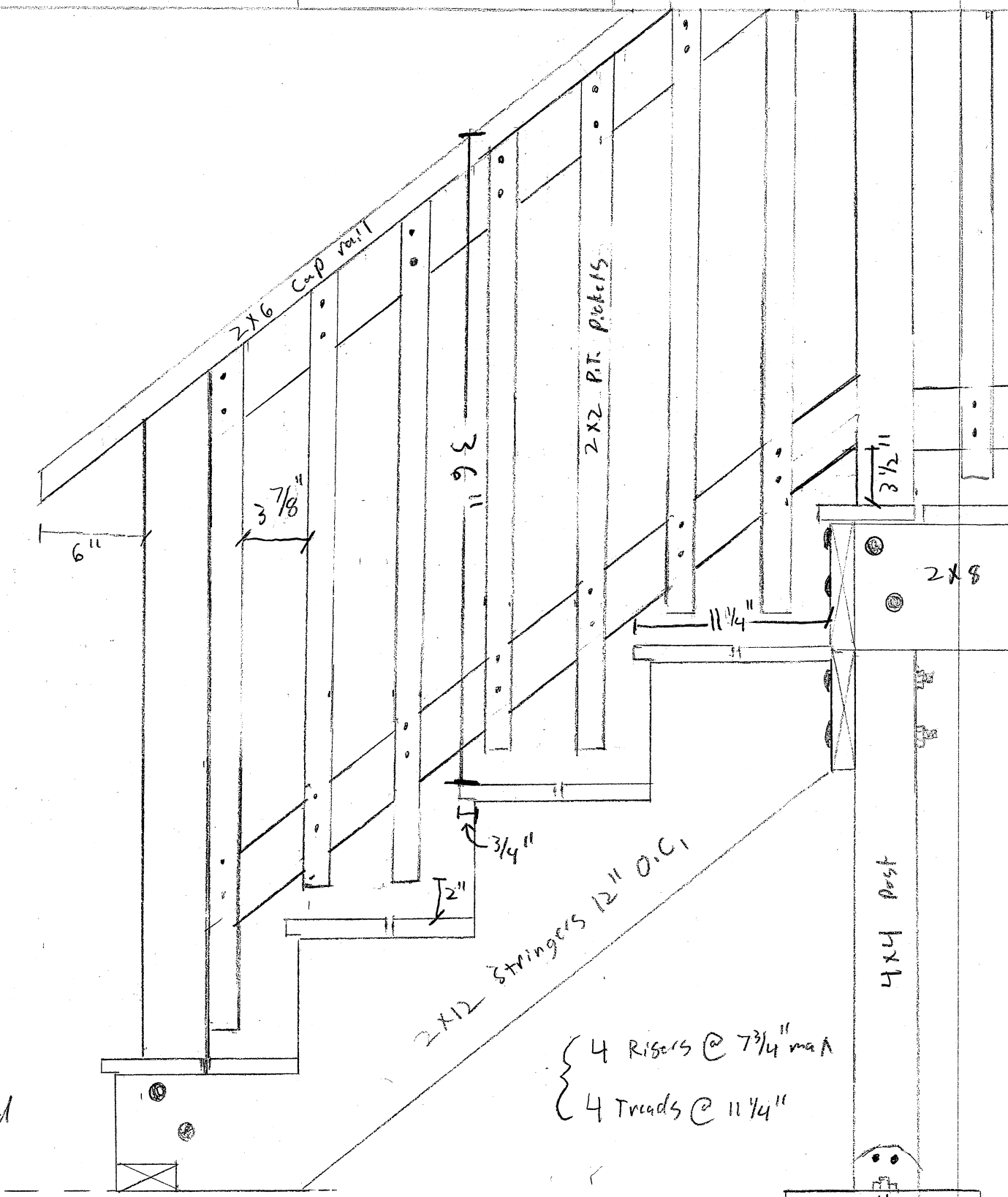

conc. Pad
↓

Grade

10" Sanna Tube
4' below Grade

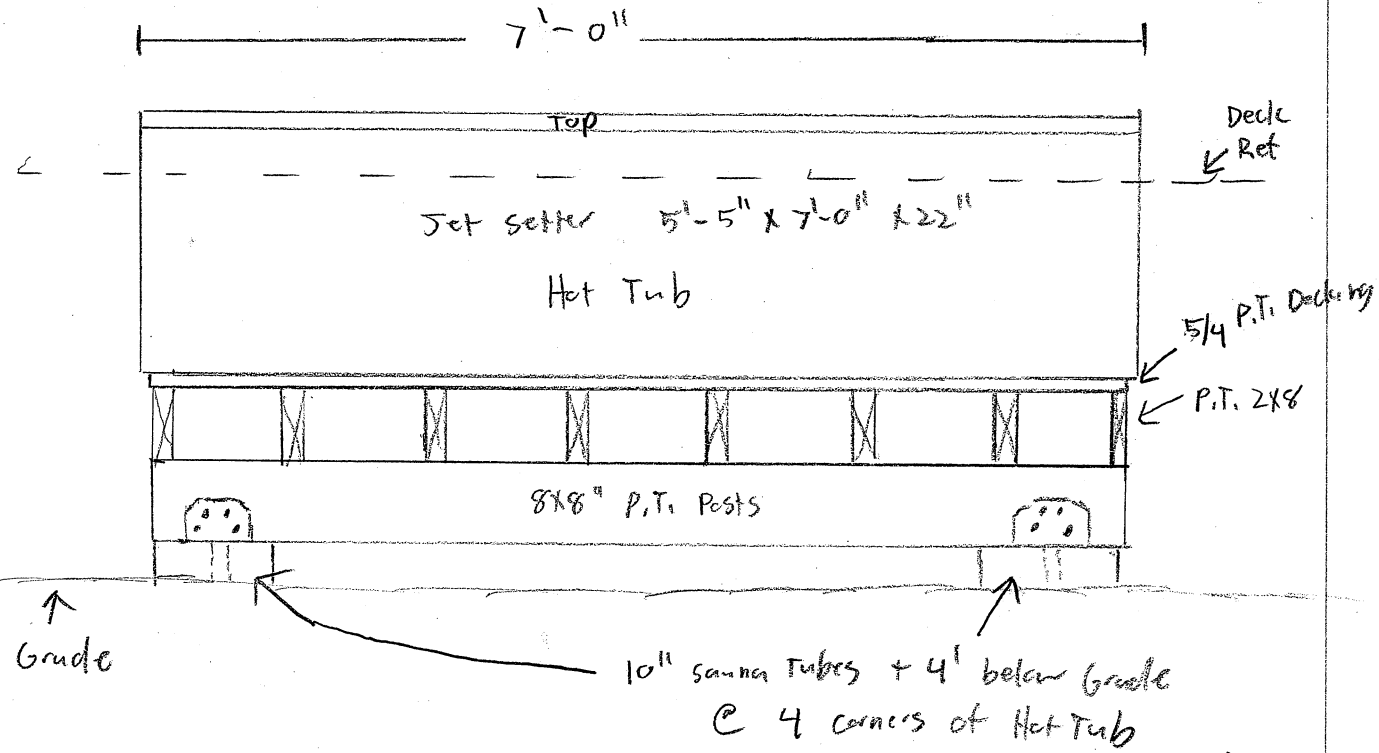

- Hot Tub is carried by independent deck system

- Use $5/8'' \times 4\frac{1}{2}''$ Lags @ $32''$ O.C. for Ledger Board
- 2x8 P.T. Framing = $12''$ O.C.
- 4x4 P.T. posts anchored w/ simpson post bases
- All sunna tubes are $10''$ dia @ min. 4ft below grade
- 16 d galv framing nails used for hanger toe rails, 10d galv hanger nails @ all other hanger locations.
- Simpson 2x8 and 4x8 joist hangers to be used @ perpendicular inter sections from Ledger/Girt to joists.
- All pickets to be fastened w/ (4) $2\frac{1}{4}''$ S.S. screws
- All posts to be carriage bolted w/ (2) staggered $\frac{1}{2}'' \times 5\frac{1}{2}''$ galv. bolts
- All simpson post bases to be bolted to concrete via $\frac{1}{2}'' \times 9''$ L bolts.
- Stair to land on $4' \times 4' \times 4''$ concrete pad.
- New out swing $2' \times 6'' \times 6\frac{1}{8}''$ fiberglass door to be installed for deck access.

BUILDING A DECK???

INFORMATION REQUIRED WITH YOUR APPLICATION

The following is a guideline of information required for the review of a deck application. It is intended to help you supply proper and complete application packages. Please label all of the following items on your plans. Thank you!

1. A complete plot plan showing all structures & proposed structures with distances to all property lines labeled.
2. Type of foundation system
 - a. Diameter of concrete filled tube or pre cast concrete pier size 10"
 - b. depth below grade (minimum 4'-0" below grade) + 4'
 - c. anchorage of column to footing 5/8" x 10" "L" Bolt embedded in conc. Simpson post base
 - d. spacing and location of tubes/piers 10' 6" O.C. max span
3. Framing Members
 - a. Columns – wood size and location (members supporting framing of floor system) 4x4
 - b. Ledger size attached to building 2x8
 - c. Fastener size and spacing attaching ledger 32" O.C. 5/8" x 4 1/2" Lags
 - d. Girder Size and spans carrying floor system 2x8 12' max span
 - e. Joist size, span, and spacing 2x8" 12" O.C. 12' max span
 - f. Joist hangers or ledger Simpson strong tie 2x8 hangers @ ⊥ connections
4. Guardrails & Handrail Details
 - a. Guardrail height 36"
 - b. Baluster spacing 5" O.C. (4" sphere rule)
 - c. Handrail height 36"
5. Stair Details
 - a. Tread depth (measured nosing to nosing) 11"
 - b. Riser height 7 3/4" max
 - c. Nosing on tread 3/4" overhang
 - d. Width of stairs 48" → 36" clear @ rail