

THIS IS NOT A BOUNDARY SURVEY

INSPECTION OF PREMISES

I HEREBY CERTIFY TO FIDELITY TITLE CO, NORWEST MORTGAGE AND ITS TITLE INSURER

The monumentation is in harmony with current deed description.

The building setbacks are in conformity with town zoning requirements.

The land and not the dwelling do not appear to fall within the special flood hazard zone as delineated by the Federal Emergency Management Agency.

29 HALL ST
PORTLAND, ME

Job Number: 171-53
Inspection Date: 4-16-92
Scale: 1" = 30'

BUYER KEVIN & MELODY BURNS
SELLER JAMES FLAWS

R-3 Zone
REAR 25' min - 25' shown
SIDE - 8' min - 15' shown

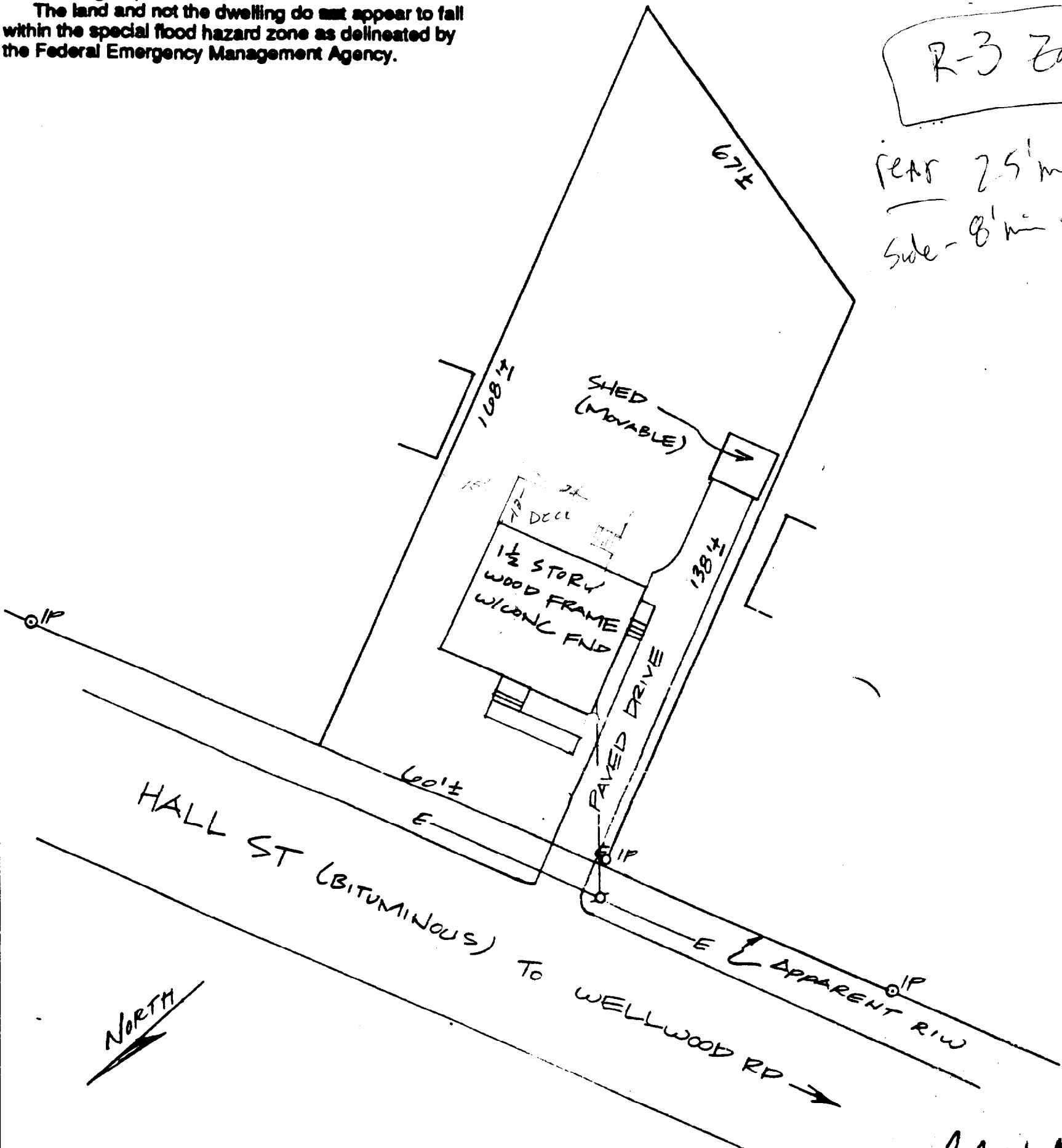

THIS PROPERTY IS SUBJECT TO ALL RIGHTS AND EASEMENTS OF RECORD. THOSE THAT ARE EVIDENT ARE SHOWN. THIS PLAN MIGHT NOT REVEAL CONFLICTS WITHIN ABUTTING DEEDS.

BRUCE R. BOWMAN, INC.
48 Mill Road
Cumberland, Maine 04021
Phone: (207)829-3959

PLAN BOOK 16 PAGE 12 LOTS POSSESSG
DEED BOOK 7791 PAGE 167 COUNTY CUMBERLAND

THIS PLAN IS NOT FOR RECORDING Drawn by: Jb

BUILDING PLANS
ON REVERSE

HOUSE

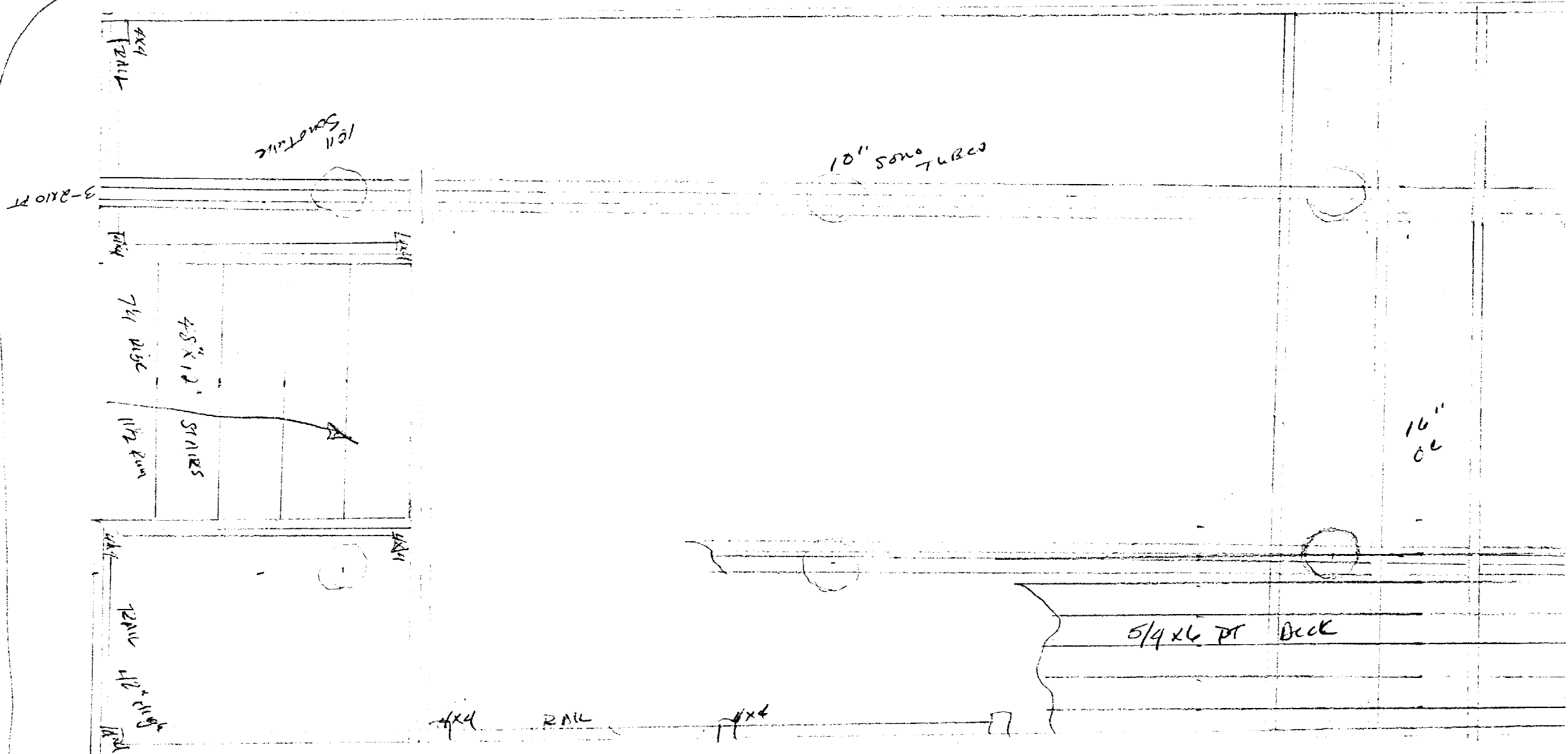

TOP VIEW

EDGE VIEW

10' 0" x 8' 0" PT

5/4 x 6 PT Decking

GRADZ

3'

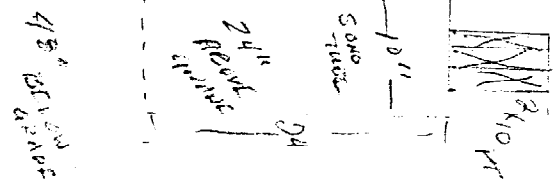

4 5/8\"/>

2 1/4\"/>

5/8\"/>

94

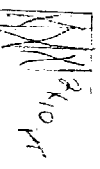

2 1/4\"/>

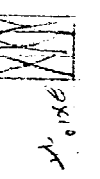

2 1/4\"/>

Framing 2x8 for 16\"/>

16\"/>

10\"/>

10\"/>

4 5/8\"/>

7 1/4\"/>

1 1/2\"/>

5/4 x 6 PT Deck

4x4 RAIL

4x4

4x4 RAIL

4x4

4x4

4x4

4x4 RAIL

3-2x10 PT