

**City of Portland, Maine - Building or Use Permit Application**  
 389 Congress Street, 04101 Tel: (207) 874-8703, Fax: (207) 874-8716

<b>PERMIT ISSUED</b>	
Permit No: 01-0895	Issue Date: <b>JUL 23 2001</b>
CBL: 158 B012001	

Location of Construction: 31 Brookside Ln	Owner Name: Braasch Benjamin B Jr &	Owner Address: 31 Brookside Ln <b>CITY OF PORTLAND</b>	Phone: 791-7026
Business Name:	Contractor Name: no contractor/self	Contractor Address: n/a n/a	Phone:
Lessee/Buyer's Name	Phone:	Permit Type: Sheds	Zone: <b>R-3</b>

Past Use: single family	Proposed Use: single family with 8' x 10' shed	Permit Fee: \$36.00	Cost of Work: \$1,100.00	CEO District: 2
----------------------------	---	------------------------	-----------------------------	--------------------

FIRE DEPT: <input type="checkbox"/> Approved <input type="checkbox"/> Denied <b>N/A</b>	INSPECTION: Use Group: <b>U</b> Type: <b>SB</b> <b>BOCA 1999</b>
Signature:	Signature: <b>T. Munson</b>

Proposed Project Description:  
8' x 10' shed

PEDESTRIAN ACTIVITIES DISTRICT (P.A.D.)  
 Action:  Approved  Approved w/Conditions  Denied  
**N/A**  
 Signature: \_\_\_\_\_ Date: \_\_\_\_\_

Permit Taken By: _dgc	Date Applied For: 07/23/2001	<b>Zoning Approval</b>
--------------------------	---------------------------------	------------------------

1. This permit application does not preclude the Applicant(s) from meeting applicable State and Federal Rules. 2. Building permits do not include plumbing, septic or electrical work. 3. Building permits are void if work is not started within six (6) months of the date of issuance. False information may invalidate a building permit and stop all work..	Special Zone or Reviews <input type="checkbox"/> Shoreland <input type="checkbox"/> Wetland <input type="checkbox"/> Flood Zone <input type="checkbox"/> Subdivision <input type="checkbox"/> Site Plan Maj <input type="checkbox"/> Minor <input type="checkbox"/> MM <input type="checkbox"/> Date: <b>7/23/01</b>	Zoning Appeal <input type="checkbox"/> Variance <input type="checkbox"/> Miscellaneous <input type="checkbox"/> Conditional Use <input type="checkbox"/> Interpretation <input type="checkbox"/> Approved <input type="checkbox"/> Denied Date: <b>7/23/01</b>	Historic Preservation <input checked="" type="checkbox"/> Not in District or Landmark <input type="checkbox"/> Does Not Require Review <input type="checkbox"/> Requires Review <input type="checkbox"/> Approved <input type="checkbox"/> Approved w/Conditions <input type="checkbox"/> Denied Date: <b>7/23/01</b>
	<b>N/A</b>		

**CERTIFICATION**

I hereby certify that I am the owner of record of the named property, or that the proposed work is authorized by the owner of record and that I have been authorized by the owner to make this application as his authorized agent and I agree to conform to all applicable laws of this jurisdiction. In addition, if a permit for work described in the application is issued, I certify that the code official's authorized representative shall have the authority to enter all areas covered by such permit at any reasonable hour to enforce the provision of the code(s) applicable to such permit.

SIGNATURE OF APPLICANT \_\_\_\_\_ ADDRESS \_\_\_\_\_ DATE \_\_\_\_\_ PHONE \_\_\_\_\_

RESPONSIBLE PERSON IN CHARGE OF WORK, TITLE \_\_\_\_\_ DATE \_\_\_\_\_ PHONE \_\_\_\_\_

# All Purpose Building Permit Application

If you or the property owner owes real estate or personal property taxes or user charges on any property within the City, payment arrangements must be made before permits of any kind are accepted.

Location/Address of Construction: 31 Brookside Lane Portland

Total Square Footage of Proposed Structure <u>8'x10'</u>	Square Footage of Lot <u>.85 Acre.</u>
---	---

Tax Assessor's Chart, Block & Lot Chart# <u>158</u> Block# <u>B</u> Lot# <u>012</u>	Owner: <u>Ben Brausch</u>	Telephone: <u>791-7026</u>
--	---------------------------	-------------------------------

Lessee/Buyer's Name (if Applicable)	Applicant name, address & telephone: <u>BEN BRAUSCH</u> <u>31 Brookside Lane</u> <u>791-7026</u>	Cost Of Work: \$ <u>1100<sup>00</sup></u> Fee: \$ <u>36.00</u>
-------------------------------------	---	---

Current use: Vacant S/P

If the location is currently vacant, what was prior use: No use

Approximately how long has it been vacant: 50 years

Proposed use: Storage Shed 8'x10'

Project description: see diagram, attached.  
8x10 shed

Contractor's name, address & telephone: BEN BRAUSCH 791-7026 + call

Who should we contact when the permit is ready: Same

Mailing address:

Phone: Same.

**IF THE REQUIRED INFORMATION IS NOT INCLUDED IN THE SUBMISSIONS THE PERMIT WILL BE AUTOMATICALLY DENIED AT THE DISCRETION OF THE BUILDING/PLANNING DEPARTMENT, WE MAY REQUIRE ADDITIONAL INFORMATION IN ORDER TO APPROVE THIS PERMIT.**

I hereby certify that I am the Owner of record of the named property, or that the owner of record authorizes the proposed work and that I have been authorized by the owner to make this application as his/her authorized agent. I agree to conform to all applicable laws of this jurisdiction. In addition, if a permit for work described in this application is issued, I certify that the Code Official's authorized representative shall have the authority to enter all areas covered by this permit at any reasonable hour to enforce the provisions of the codes applicable to this permit.

Signature of applicant: <u>[Signature]</u>	Date: <u>7-12-01</u>
--	----------------------

**This is not a permit, you may not commence ANY work until the permit is issued**

7/10/01  
Garret

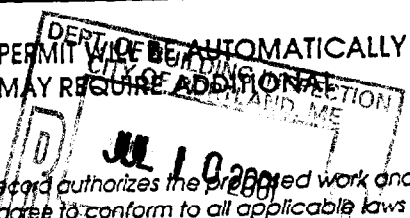

Applicant: Ben Braesch

Date:

Address: 31 Brookside Rd.

C-B-I: 158-B-12

CHECK-LIST AGAINST ZONING ORDINANCE

Date - 7/23/07

Zone Location - R-3

Interior or corner lot - Interior

Proposed Use/Work - 8x10 shed

Sewage Disposal - Public

Lot Street Frontage - 50 Req.

Front Yard - OK - 25 Req.

Rear Yard - 10' shown - 5 Req. - OK

Side Yard - 10' shown - 5 Req. - OK

Projections - OK

Width of Lot - OK

Height - OK

Lot Area - 10,122 - 6500 Req. - OK

Lot Coverage/ Impervious Surface - 25% 2530 - ~~1850~~ - OK

Area per Family - 1456

Off-street Parking -

Loading Bays -

Site Plan -

Shoreland Zoning/ Stream Protection -

Flood Plains -

The "shed" shall be constructed by  
"Outdoor Shelters Inc." of Saco, ME. The  
shed shall be 8' x 10' in dimension and  
shall be constructed of 2" x 4" framing w/ pine  
beard siding, nailed to framing. Common Asphlt roofing  
Shingle (20-30yr-warranty) will be applied to roof.  
The shed will be placed on cinder blocks at  
the location specified on the reverse side  
of this diagram. Approximate cost of shed is  
\$1100<sup>00</sup> assembled by manufacturer on site.

2" x 6" Floors  
2" x 6" Rafter

FENCE of shrub trees

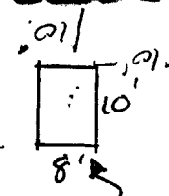

PROPOSED SHED

TREES

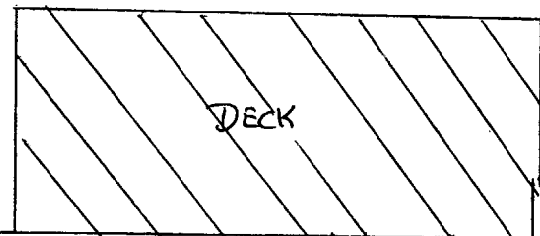

DECK

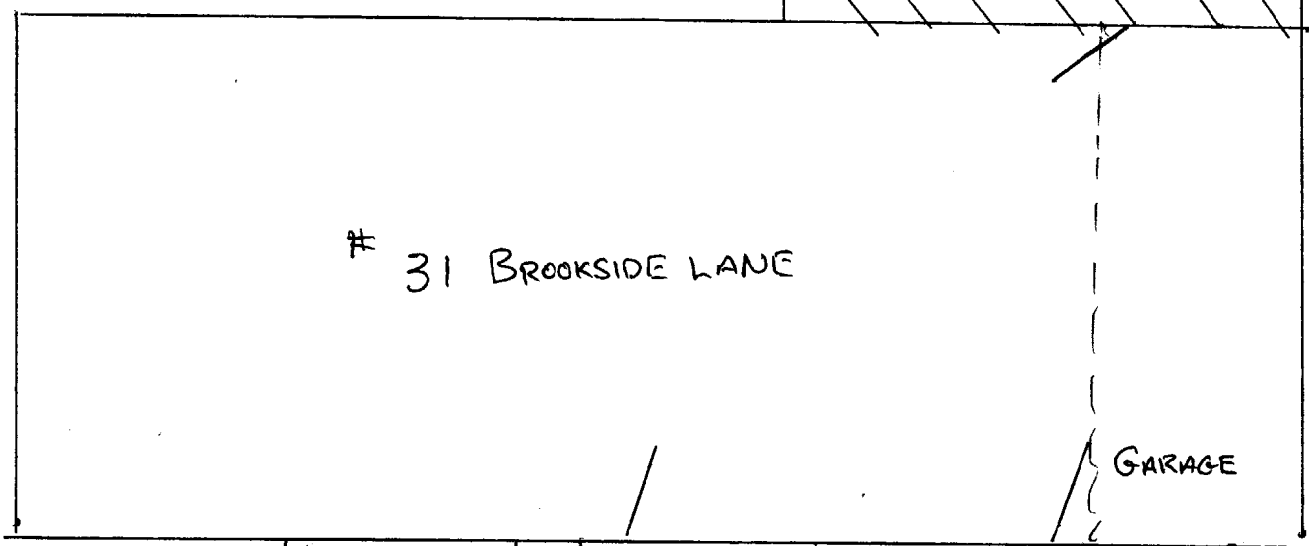

# 31 BROOKSIDE LANE

GARAGE

FENCE

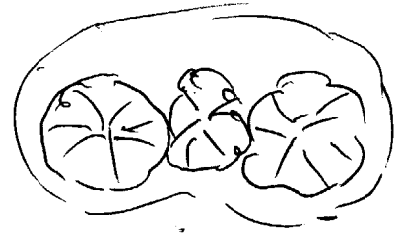

BROOKSIDE LANE



# CITY OF PORTLAND, MAINE

## Department of Building Inspection

July 10 2001

Received from Benjamin B. Brooks Jr. a fee

of Twenty six /100 Dollars \$ 36.00

for permit to  install  
 erect  
 alter  
dated

at 31 Brookside Rd move  
demolish Est. Cost \$ 1,100

Check # 7889

CBL 158302

Inspector of buildings  
Per Ray

# THIS IS NOT A PERMIT

No work is to be started until PERMIT CARD is actually posted upon the premises. Acceptance of fee is no guarantee that permit will be granted. PRESERVE THIS RECEIPT. In case permit cannot be granted the amount of the fee will be refunded upon return of the receipt less \$5.00 or 10% whichever is greater.

WHITE - Applicant's Copy  
YELLOW - Office Copy  
PINK - Auditors Copy