

SIMPSON H2.5 AT EACH RAFTER TAIL AND MIN. (6) 12d NAILS AT RAFTER/TIE CONNECTION

RAFTER TIES MAY BE SPLICED AT CENTER WITH MIN. 24" LAP AND (10) 12d NAILS AND SUPPORTED WITH 2x4 STRONGBACK AND VERTICAL 2x4'S 48" O.C.

THICKENED EDGE SLAB WITH #4 BAR VERTICALLY 48" O.C. AND HORIZONTAL BARS AS SHOWN

1 SECTION 3-3
1/2" = 1'-0"

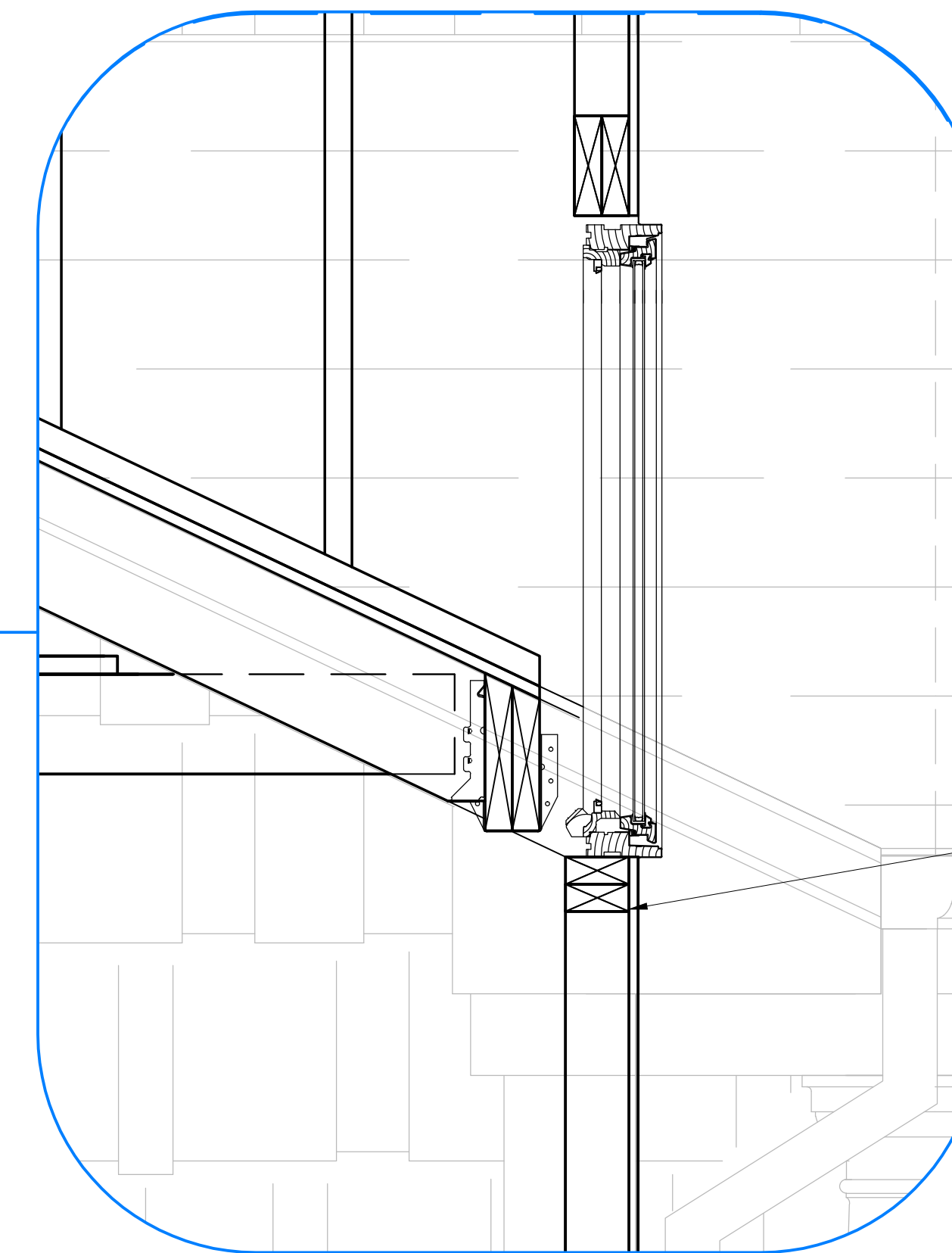
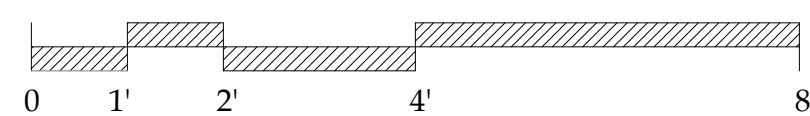

CONVENTIONALLY FRAME GARAGE EXCEPT AT DORMER WINDOWS CUT BACK EXISTING RAFTERS AND HANG NEW AND OLD RAFTERS ON SIMPSON LUS28 HANGERS ON (2) 2x8 BEAM ON SIMPSON HUS28-B HANGERS EACH END AT DOUBLED 2x8 RAFTERS WITH RAFTER TIES AT DOUBLED RAFTERS

2 DETAIL
1 1/2" = 1'-0"