



MERIT POOLS

P.O. BOX 716
SCARBOROUGH, MAINE 04070
TELEPHONE 207-883-5558
1-800-685-5559

Job Estimate

DATE ESTIMATE NO.
7/7/2016 1070

Steve Shaw
45 Brookside Rd
Portland, ME 04103

ANYONE WITH AN AVERAGE INCOME CAN OWN A **Water Source** MERIT POOL PROJECT

DESCRIPTION	TOTAL
10x20 Inground Pool with 6' Stairs	11,099.00
AquaRite Salt system up to 15,000 gallons of water	1,150.00
40 lb Salt	59.95
Sales Tax	676.99

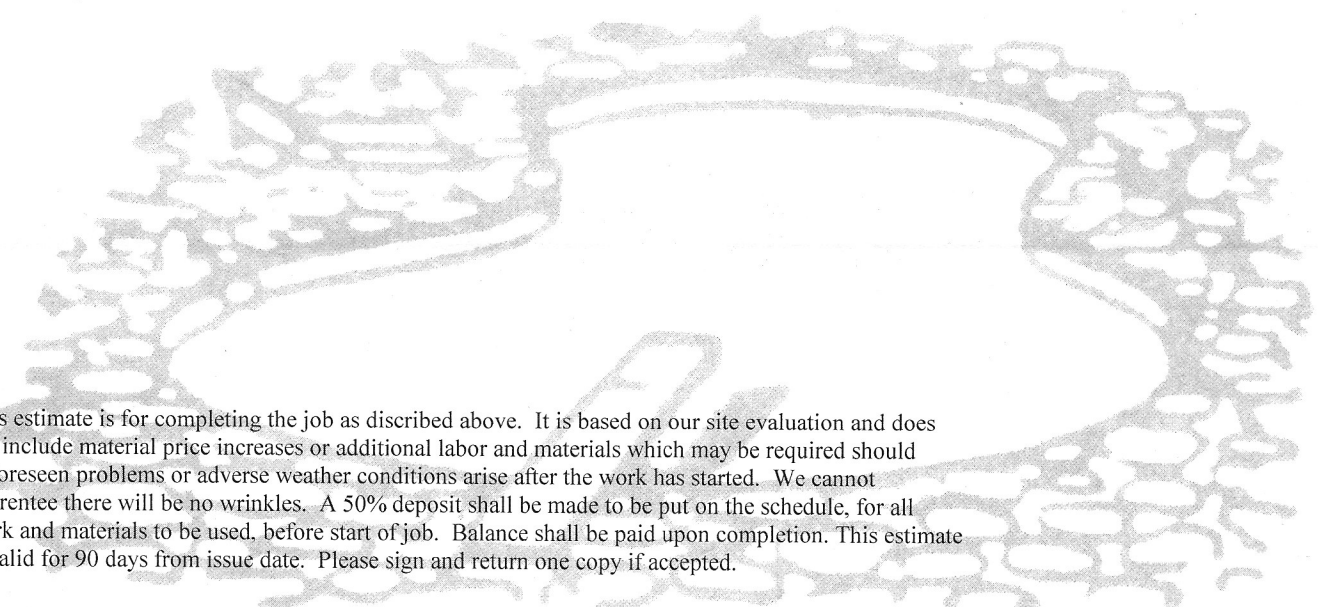

This estimate is for completing the job as discribed above. It is based on our site evaluation and does not include material price increases or additional labor and materials which may be required should unforeseen problems or adverse weather conditions arise after the work has started. We cannot guarentee there will be no wrinkles. A 50% deposit shall be made to be put on the schedule, for all work and materials to be used, before start of job. Balance shall be paid upon completion. This estimate is valid for 90 days from issue date. Please sign and return one copy if accepted.

TOTAL \$12,985.94

Accepted By: _____

Estimated By: *Sonia Demer*

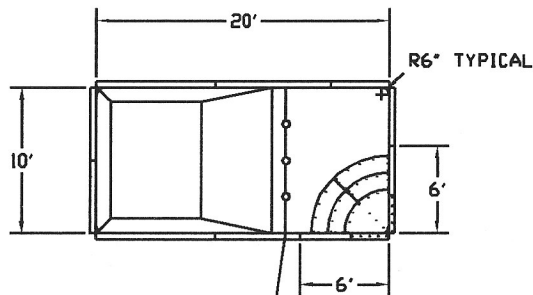

MANDATORY ROPE AND FLOAT 12 INCHES FROM SLOPE CHANGE

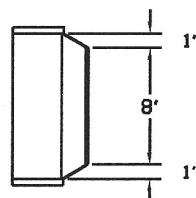
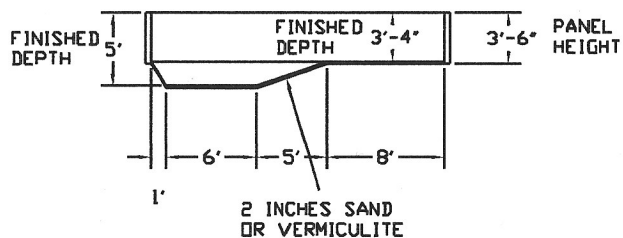

A-FRAME DETAIL DECK SUPPORT DETAIL

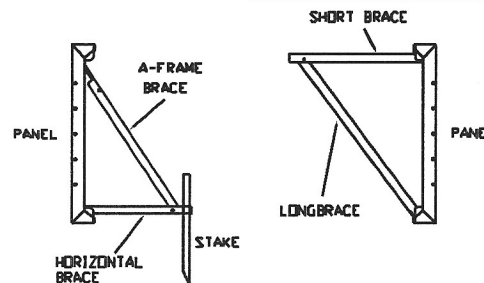

NON-DIVING POOL

NOTE:

- 1) DEPTH AND SHAPE OF POOL MEET MINIMUM STANDARDS OF THE INTERNATIONAL RESIDENTIAL CODE 2009 AG103.1 (ANSI/APSP-5) FOR RESIDENTIAL USE.
- 2) A MEANS OF EGRESS FOR BOTH THE DEEP END AND THE SHALLOW END OF THE POOL MUST BE PROVIDED AS REQUIRED BY ANSI/NSPI-5 SECTION-6.
- 3) BUILDER TO PROVIDE A MEANS OF EQUIPOTENTIAL BONDING IN ACCORDANCE WITH NEC SECTION 680.
- 4) ALL A-FRAME BRACES WILL BE MOUNDED WITH A MINIMUM OF (1) CUBIC FOOT OF CONCRETE, OR A 6" POURED CONTINUOUS CONCRETE PERIMETER COLLAR.
- 5) "NO DIVING" LABELS TO BE INSTALLED AROUND PERIMETER OF THE POOL.
- 6) ENTRAPMENT AVOIDANCE MUST BE INSTALLED IN ACCORDANCE WITH ANSI/APSP-7.

INTERNATIONAL SWIMMING POOLS NOTES SWIMMING POOLS ARE DANGEROUS WHEN USED IMPROPERLY. NEVER DIVE IN THE SHALLOW END OF ANY POOL. CONSULT WITH THE DIVING BOARD AND SLIDE MANUFACTURER(S) AND THE ASSOCIATION OF POOL AND SPA PROFESSIONALS (2111 EISENHOWER AVENUE ALEXANDRIA, VA 22314 (703-838-0083) PRIOR TO INSTALLING DIVING BOARDS AND/OR SLIDES ON THIS POOL TO ENSURE THE POOL MEETS THE EQUIPMENT MANUFACTURERS MINIMUM STANDARDS FOR ALLOWABLE INSTALLATION OF THEIR PRODUCT(S) ON THIS POOL. INTERNATIONAL SWIMMING POOLS IS NOT RESPONSIBLE FOR THE POOL'S INTERIOR DETAIL. RATHER THE LINER MANUFACTURER MUST ENSURE THE INTERIOR MEETS A.P.S.P. AND A.N.S.I. STANDARDS. IT IS THE RESPONSIBILITY OF POOL BUILDERS, TOWN OFFICIALS AND POOL OWNERS TO FOLLOW ALL SAFETY GUIDELINES OF THE A.P.S.P., LOCAL ORDINANCES, AND EQUIPMENT MANUFACTURERS.

POOL PERIMETER: 60'
 POOL AREA: 200 SqFt
 VOLUME: 6,200 APPROX. GAL.

INTERPOOL	
10' X 20' RECTANGLE	
DATE: 06/15/16	SCALE: NONE
DRAWN BY: P.T.	ACADREF: SNRT1020

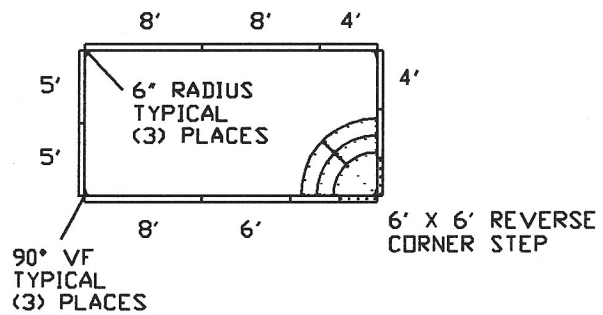

BILL OF MATERIALS

QTY	DESCRIPTION
(2)	4' STRAIGHT PANELS
(2)	5' STRAIGHT PANELS
(1)	6' STRAIGHT PANEL
(3)	8' STRAIGHT PANELS
(3)	6" RADIUS CORNER FILLERS
(3)	90 DEGREE VERTICAL FILLERS
(1)	6' X 6' REVERSE CORNER STEP (REFER TO CVSTPSCP.DWG.)

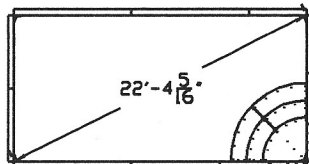

INTERPOOL

10' X 20' RECTANGLE

DATE: 06/15/16

SCALE: NONE

DRAWN BY: P.T.

ACADREF: SNRT1020

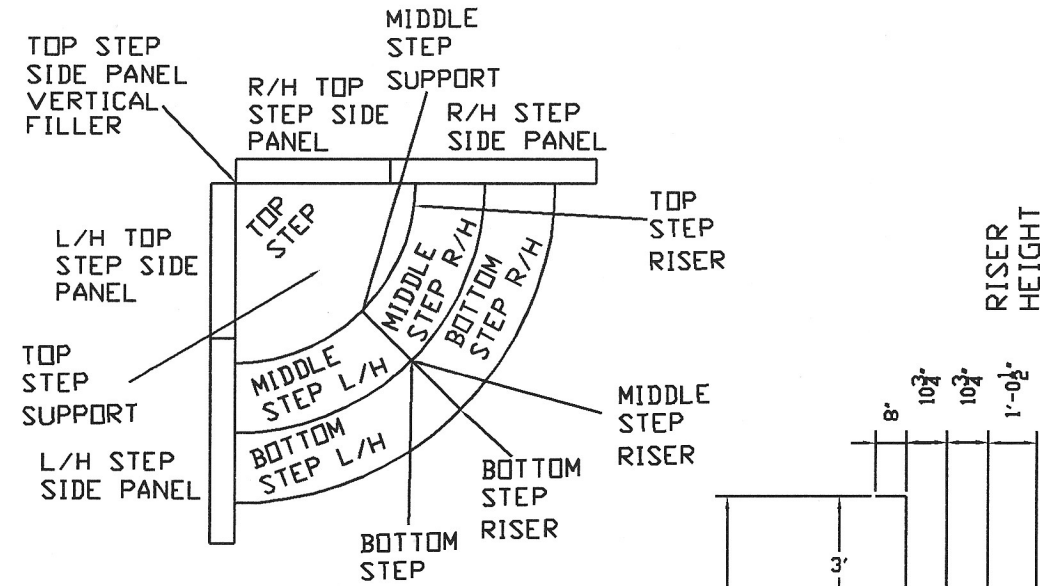

BILL OF MATERIALS

QTY.	DESCRIPTION
1	TOP STEP
1	MIDDLE STEP L/H
1	MIDDLE STEP R/H
1	BOTTOM STEP L/H
1	BOTTOM STEP R/H
1	TOP STEP RISER
1	MIDDLE STEP RISER
1	BOTTOM STEP RISER
1	TOP STEP SUPPORT
1	MIDDLE STEP SUPPORT
1	BOTTOM STEP SUPPORT
1	L/H STEP SIDE PANEL
1	R/H STEP SIDE PANEL
1	L/H TOP STEP SIDE PANEL
1	R/H TOP STEP SIDE PANEL
1	TOP STEP VERTICAL FILLER

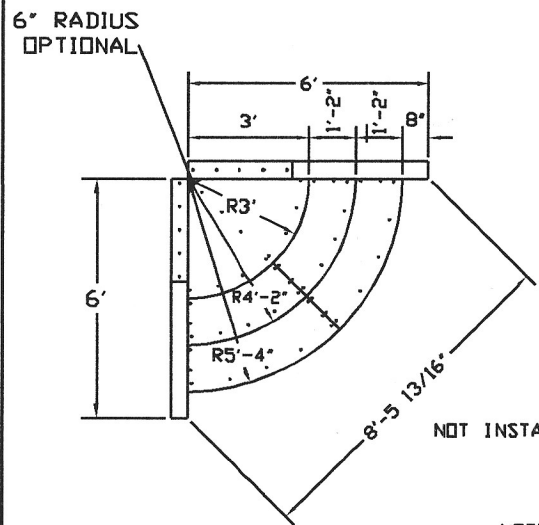
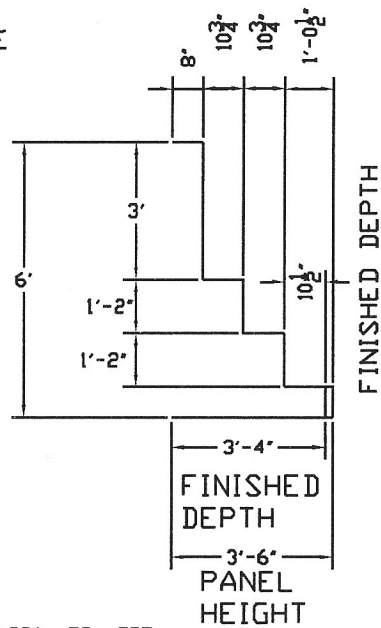

NOTE: IF STEP IS ORDERED WITH OPTIONAL LINER TRACK BEAD RECEIVER, PLEASE NOTE IT IS ONLY INSTALLED IN LOCATIONS HIGHLIGHTED WITH THE DASHED LINES.-----

INTERPOOL
REVERSE STEPS

DATE: 03/17/05 SCALE: N.T.S.

DRAWN BY: T.F. ACADREF: CVSTPSCP