

DISPLAY THIS CARD ON PRINCIPAL FRONTAGE OF WORK CITY OF PORTLAND

BUILDING DEPARTMENT

PERMIT

Permit Number: 081317

Please Read Application And Notes, If Any, Attached

This is to certify that JENKINSON BENJAMIN C & CHRISTIE JENKINSON TRUSTS

has permission to replacement 5' x 6' deck using existing stairs

AT 48 GEORGE ST

CITY OF PORTLAND PERMIT # 157 B00100

PERMIT ISSUED
OCT 16 2008

provided that the person or persons, firm or corporation accepting this permit shall comply with all of the provisions of the Statutes of Maine and of the Ordinances of the City of Portland regulating the construction, maintenance and use of buildings and structures, and of the application on file in this department.

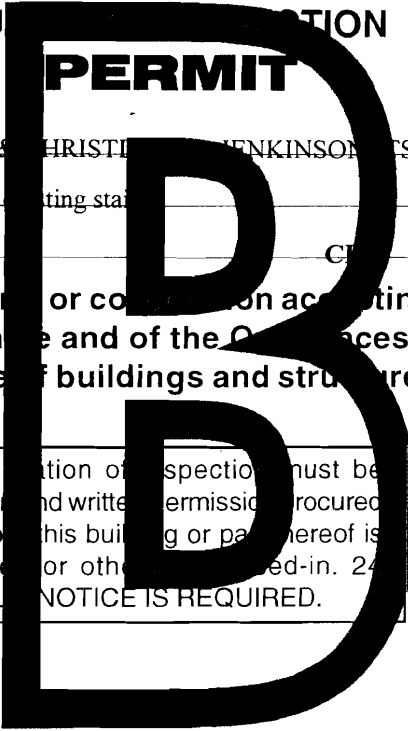

Apply to Public Works for street line and grade if nature of work requires such information.

Notification of inspection must be given and written permission procured before this building or part thereof is lathed or otherwise red-in. 24 HOURS NOTICE IS REQUIRED.

A certificate of occupancy must be procured by owner before this building or part thereof is occupied.

OTHER REQUIRED APPROVALS

Fire Dept. _____

Health Dept. _____

Appeal Board _____

Other _____

Department Name

Thomas M. Marpley 10/16/08
Director - Building & Inspection Services

PENALTY FOR REMOVING THIS CARD

City of Portland, Maine - Building or Use Permit Application

389 Congress Street, 04101 Tel: (207) 874-8703, Fax: (207) 874-8716

Permit No: 08-1317	Issue Date: 10/16/2008	CBL: 157 B001001
-----------------------	---------------------------	---------------------

Location of Construction: 48 GEORGE ST	Owner Name: JENKINSON BENJAMIN C & CH	Owner Address: 48 GEORGE ST	Phone:
Business Name:	Contractor Name: property owner	Contractor Address:	Phone:
Lessee/Buyer's Name	Phone:	Permit Type: Additions - Duplex	Zone: R3

Past Use: Duplex	Proposed Use: duplex - replacement 5' x 6' deck using existing stairs	Permit Fee: \$30.00	Cost of Work: \$1,000.00	CEO District: 4
		FIRE DEPT: <input type="checkbox"/> Approved <input type="checkbox"/> Denied	INSPECTION: Use Group: R3 Type: SB IBC 2003	

Proposed Project Description: replacement 5' x 6' deck using existing stairs	Signature:	Signature: <i>Jm 10/16/08</i>
PEDESTRIAN ACTIVITIES DISTRICT (P.A.D.)		
Action: <input type="checkbox"/> Approved <input type="checkbox"/> Approved w/Conditions <input type="checkbox"/> Denied		
Signature:		Date:

Permit Taken By: Idobson	Date Applied For: 10/16/2008	Zoning Approval	
-----------------------------	---------------------------------	------------------------	--

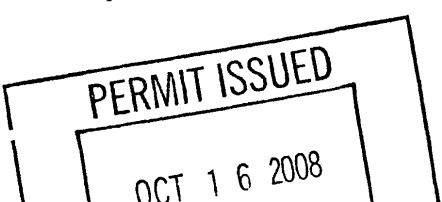
<p>1. This permit application does not preclude the Applicant(s) from meeting applicable State and Federal Rules.</p> <p>2. Building permits do not include plumbing, septic or electrical work.</p> <p>3. Building permits are void if work is not started within six (6) months of the date of issuance. False information may invalidate a building permit and stop all work..</p>	<p>Special Zone or Reviews</p> <input type="checkbox"/> Shoreland <input type="checkbox"/> Wetland <input type="checkbox"/> Flood Zone <input type="checkbox"/> Subdivision <input type="checkbox"/> Site Plan Maj <input type="checkbox"/> Minor <input type="checkbox"/> MM <input type="checkbox"/> Date: <i>Jm 10/16/08</i>	<p>Zoning Appeal</p> <input type="checkbox"/> Variance <input type="checkbox"/> Miscellaneous <input type="checkbox"/> Conditional Use <input type="checkbox"/> Interpretation <input type="checkbox"/> Approved <input type="checkbox"/> Denied Date:	<p>Historic Preservation</p> <input checked="" type="checkbox"/> Not in District or Landmark <input checked="" type="checkbox"/> Does Not Require Review <input type="checkbox"/> Requires Review <input type="checkbox"/> Approved <input type="checkbox"/> Approved w/Conditions <input type="checkbox"/> Denied Date: <i>10/16/08 Jm</i>
			

CERTIFICATION

I hereby certify that I am the owner of record of the named property, or that the proposed work is authorized by the owner of record and that I have been authorized by the owner to make this application as his authorized agent and I agree to conform to all applicable laws of this jurisdiction. In addition, if a permit for work described in the application is issued, I certify that the code official's authorized representative shall have the authority to enter all areas covered by such permit at any reasonable hour to enforce the provision of the code(s) applicable to such permit.

SIGNATURE OF APPLICANT	ADDRESS	DATE	PHONE
RESPONSIBLE PERSON IN CHARGE OF WORK, TITLE		DATE	PHONE

4-14-09

OK - Final on deck + stairs

WJW

City of Portland, Maine - Building or Use Permit

389 Congress Street, 04101 Tel: (207) 874-8703, Fax: (207) 874-8716

Permit No: 08-1317	Date Applied For: 10/16/2008	CBL: 157 B001001
------------------------------	--	----------------------------

Location of Construction: 48 GEORGE ST	Owner Name: JENKINSON BENJAMIN C & CH	Owner Address: 48 GEORGE ST	Phone:
Business Name:	Contractor Name: property owner	Contractor Address:	Phone:
Lessee/Buyer's Name	Phone:	Permit Type: Additions - Duplex	

Proposed Use: duplex - replacement 5' x 6' deck using existing stairs	Proposed Project Description: replacement 5' x 6' deck using existing stairs
---	--

Dept: Zoning	Status: Approved with Conditions	Reviewer: Tom Markley	Approval Date: 10/16/2008
Note:	Ok to Issue: <input checked="" type="checkbox"/>		
1) This is NOT an approval for an additional dwelling unit. You SHALL NOT add any additional kitchen equipment including, but not limited to items such as stoves, microwaves, refrigerators, or kitchen sinks, etc. Without special approvals. 2) This property shall remain a single family dwelling. Any change of use shall require a separate permit application for review and approval.			
Dept: Building	Status: Approved with Conditions	Reviewer: Tom Markley	Approval Date: 10/16/2008
Note:	Ok to Issue: <input checked="" type="checkbox"/>		
1) Existing stairs are being used and may not meet code requirements. 2) Permit approved based on the plans submitted and reviewed w/owner/contractor, with additional information as agreed on and as noted on plans.			



General Building Permit Application

If you or the property owner owes real estate or personal property taxes or user charges on any property within the City, payment arrangements must be made before permits of any kind are accepted.

Location/Address of Construction: <u>48 George St. Portland ME 04103</u>		
Total Square Footage of Proposed Structure/Area	Square Footage of Lot	Number of Stories
Tax Assessor's Chart, Block & Lot Chart# Block# Lot# <u>157 B 001</u>	Applicant "must be owner, Lessee or Buyer" Name: <u>Benjamin Jenkinson</u> Address: <u>48 George St. #2</u> City, State & Zip: <u>Portland ME 04103</u>	Telephone: <u>552-2124</u>
Lessee/DBA (If Applicable)	Owner (if different from Applicant) Name Address City, State & Zip	Cost Of Work: \$ <u>1000.00</u> C of O Fee: \$ _____ Total Fee: \$ _____
Current legal use (i.e. single family) <u>Two Family</u> Number of Residential Units <u>2</u> If vacant, what was the previous use? _____ Proposed Specific use: <u>BACK ENTRANCE STAIRS</u> Is property part of a subdivision? <u>NO</u> If yes, please name _____ Project description: <u>REPLACEMENT 5'x6' DECK USING EXISTING STAIRS.</u>		
Contractor's name: <u>SELF</u> Address: _____ City, State & Zip: _____ Telephone: _____ Who should we contact when the permit is ready: _____ Telephone: _____ Mailing address: _____		

Please submit all of the information outlined on the applicable Checklist. Failure to do so will result in the automatic denial of your permit.

In order to be sure the City fully understands the full scope of the project, the Planning and Development Department may request additional information prior to the issuance of a permit. For further information or to download copies of this form and other applications visit the Inspections Division on-line at www.portlandmaine.gov, or stop by the Inspections Division office, room 315 City Hall or call 874-8703.

I hereby certify that I am the Owner of record of the named property, or that the owner of record authorizes the proposed work and that I have been authorized by the owner to make this application as his/her authorized agent. I agree to conform to all applicable laws of this jurisdiction. In addition, if a permit for work described in this application is issued, I certify that the Code Official's authorized representative shall have the authority to enter all areas covered by this permit at any reasonable hour to enforce the provisions of the codes applicable to this permit.

Signature: Benjamin Jenkinson Date: 10/16/08

This is not a permit; you may not commence ANY work until the permit is issued.



Permitting By Appointment

As part of Portland's city-wide effort to improve customer service and help streamline doing business within the City, the Inspections Division has developed a new permitting system for qualified properties and for specific construction projects. Under this new program, you may be eligible to receive a building permit on the day you have a scheduled appointment with Inspection staff.

This permitting program applies only to existing one and two family homes not located within a historic district or shore land zone.

Eligible Projects

Please submit a complete application with the required plans

- Interior renovations, gut rehabs including structural changes
- Attached and detached garages
- Additions, decks, sheds, pools, dormers (two family addition must be less than 500 s.f.)
- Rebuild of any exterior structure listed above

Inspections are still required per City Code of Ordinance.

In order to be sure the City fully understands the full scope of the project, the Planning and Development Department may request additional information prior to the issuance of a permit. For further information visit us on-line at www.portlandmaine.gov, stop by the Building Inspections office, room 315 City Hall or call 874-8703.

I hereby certify that this project meets the above criteria and that the work performed will not go beyond these parameters.

Signature of applicant: <i>Benjamin Spinkson</i>	Date: <i>10/16/08</i>
--	-----------------------

This is not a permit; you may not commence ANY work until the permit is issued.

04.16

2012

3037



75.0

101 53

038

50 什

84

50

30 10

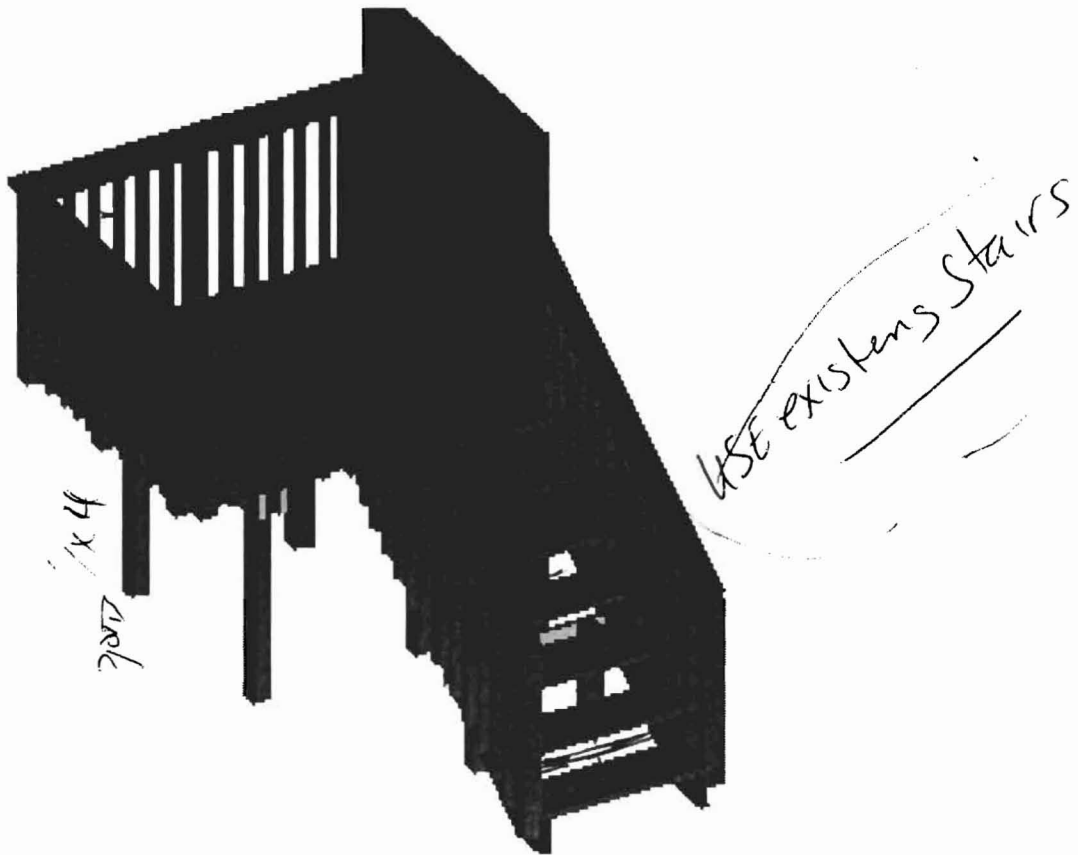

Lowe's Deck Design For

Benjamin

Print this document and take it to your local Lowe's.
One of our associates will help you find the materials you need.

Deck layout diagram



Top view without planks



Bottom view with planks



Top view with planks

Beam Layout Level 1

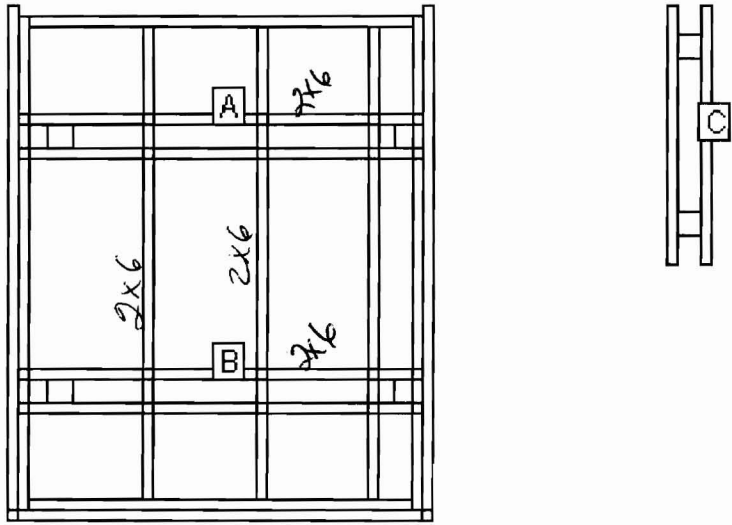

BEAM LABEL	BEAM LENGTH	POST COUNT	POST SPACING
A	4' 9"	2	3' 9 1/2"
B	4' 9"	2	3' 9 1/2"
C	3'	2	2' 1/2"

Materials Cut List: Level 1

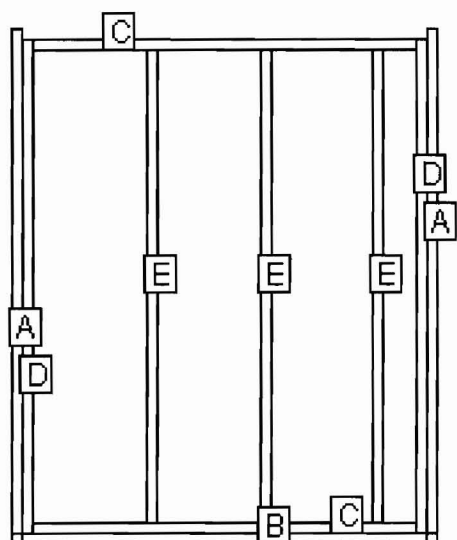

LABEL	NAME	QTY	LENGTH	BEVELS	LABEL	NAME	QTY	LENGTH	BEVELS
A	Fascia	2	6'	F45 S45	D	Outer Joist	2	5' 9"	
B	Fascia	1	5'	F45 S45	E	Joist	3	5' 6"	
C	Header	2	4' 6"						

Cut Angles: L=Left, R=Right, F=Front, S=Side

Permit Page: Level 1

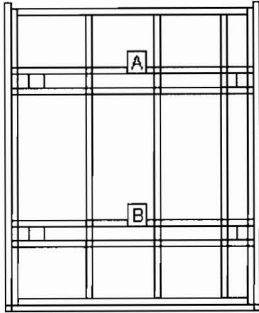

LOAD AND SUPPORT:

Your deck will support a 150 PSF live load.
 Posts have 30" below ground support.

DECK AND POST HEIGHT:

You selected a height of 54" from the top of the decking to the ground level. The top of the deck support posts will therefore be 47.25" above ground level.

Joists:

Set joists on top of beams, 16"; center to center.

Stress Analysis: Level 1

Component	PSF
Joist Deflection	5294
Joist Bending	331
Joist Shear	242
Joist Compression	462
Beam Deflection	189
Beam Bending	189
Beam Shear	159
Bolt Shear	702
Post Stability	1095



CITY OF PORTLAND, MAINE
Department of Building Inspections

Original Receipt

_____ 10.16 2009 _____

Received from Benjamin Jenkins

Location of Work 48 George St

Cost of Construction \$ _____ Building Fee: _____

Permit Fee \$ 30 Site Fee: _____

Certificate of Occupancy Fee: _____

Total: 30

Building (IL) _____ Plumbing (I5) _____ Electrical (I2) _____ Site Plan (U2) _____

Other _____

CBL: 157-B-1

Check #: CC **Total Collected \$** 30

No work is to be started until permit issued.

If permit is Withdrawn or Denied, amount of the Refund is based on \$20.00 or 20% of the fee, (whichever is greater)

In order to receive a refund, you MUST present the Original Receipt.

Taken by: [Signature]

WHITE - Applicant's Copy
YELLOW - Office Copy
PINK - Permit Copy