

23-25 GLECKLER ROAD

CHANG & ZUKER

Full cut # 620A - Half cut # 620B - Third cut # 620C - Fifth cut # 620D

140 E 6.15



FILL IN AND SIGN WITH INK

APPLICATION FOR PERMIT FOR HEATING, COOKING OR POWER EQUIPMENT

Portland, Maine, June 16, 1961

PERMIT ISSUED
JUN 13 1961
CITY OF PORTLAND

To the INSPECTOR OF BUILDINGS, PORTLAND, ME.

The undersigned hereby applies for a permit to install the following heating, cooking or power equipment in accordance with the Laws of Maine, the Building Code of the City of Portland, and the following specifications:

Location 25 Gleckler Rd. Use of Building dwelling No. Stories 1 1/2 - New Building Existing " Existing "

Name and address of owner of appliance Danasa Potter, 25 Gleckler Rd.

Installer's name and address Donald Barton, 119 Gleckler Rd. Telephone 3-0422

General Description of Work

To install oil fired boiler for heating domestic hot water

IF HEATER, OR POWER BOILER

Location of appliance basement Any burnable material in floor surface or beneath? no

If so, how protected? Kind of fuel? oil

Minimum distance to burnable material, from top of appliance or casing top of furnace 2'

From top of smoke pipe 2' From front of appliance over 4' From sides or back of appliance over 4'

Size of chimney flue 6x12 Other connections to same flue - furnace

If gas fired, how vented? Rated maximum demand per hour

Will sufficient fresh air be supplied to the appliance to insure proper and safe combustion?

IF OIL BURNER

Name and type of burner Quiet Heat-Mo. A. 1102 Labelled by underwriters' laboratories? yes

Will operator be always in attendance? Does oil supply line feed from top or bottom of tank? bottom

Type of floor beneath burner basement Size of vent pipe existing

Location of oil storage Number and capacity of tanks existing

Low water shut off Make No.

Will all tanks be more than five feet from any flame? How many tanks enclosed?

Total capacity of any existing storage tanks for furnace burner

IF COOKING RANGE

Location of appliance Any burnable material in floor surface or beneath?

If so, how protected? Height of Legs, if any

Skirting at bottom of appliance? Distance to combustible material from top of appliance?

From front of appliance From sides and back From top of smokepipe

Size of chimney flue Other connections to same flue

Is hood to be provided? If so, how vented? Forced or gravity?

If gas fired, how vented? Rated maximum demand per hour

MISCELLANEOUS EQUIPMENT OR SPECIAL INFORMATION

Amount of fee enclosed? \$2.00 (\$2.00 for one heater, etc., 50 cents additional for each additional heater, etc., in same building at same time.)

APPROVED: *DK 6.16.61*

Will there be in charge of the above work a person competent to see that the State and City requirements pertaining thereto are observed? yes

Donald Barton

Signature of Installer

Donald Barton

CS 130

INSPECTION COPY

2 Dec



FILL IN AND SIGN WITH INK

APPLICATION FOR PERMIT FOR HEATING, COOKING OR POWER EQUIPMENT

Portland, Maine, August 27, 1948

PERMIT ISSUED

(1) 5350

AUG 28 1948

CITY of PORTLAND

To the INSPECTOR OF BUILDINGS, PORTLAND, MAINE

The undersigned hereby applies for a permit to install the following heating, cooking or power equipment in accordance with the Laws of Maine, the Building Code of the City of Portland, and the following specifications:

Location 25 Gleckler Road Use of Building Dwelling No. Stories 1 New Building Existing

Name and address of owner of appliance Mrs Edith Potter, 25 Gleckler Rd.

Installer's name and address The Paine Co., 445 Fore St. Telephone 3-4671

General Description of Work

To install hot air heating system and oil burning equipment in place of gravity hot air heat

IF HEATER, OR POWER BOILER

Location of appliance or source of heat basement Type of floor beneath appliance concrete

If wood, how protected? plenum Kind of fuel oil

Minimum distance to wood or combustible material, from top of appliance or casing top of furnace 8"

From top of smoke pipe 5' From front of appliance Over 4' From sides or back of appliance Over 3'

Size of chimney flue 8x8 Other connections to same flue none

If gas fired, how vented? none Rated maximum demand per hour

IF OIL BURNER

Name and type of burner Quiet Heat - Rayflower Labeled by underwriter's laboratories? yes

Will operator be always in attendance? Does oil supply line feed from top or bottom of tank? bottom

Type of floor beneath burner concrete Number and capacity of tanks 1-250 gal.

Location of oil storage basement

If two 275-gallon tanks, will three-way valve be provided?

Will all tanks be more than five feet from any flame? yes How many tanks fire proofed?

Total capacity of all existing storage tanks for furnace burners none

IF COOKING APPLIANCE

Location of appliance Kind of fuel Type of floor beneath appliance

If wood, how protected?

Minimum distance to wood or combustible material from top of appliance

From front of appliance From sides and back From top of smoke pipe

Size of chimney flue Other connections to same flue

Is hood to be provided? If so, how vented?

If gas fired, how vented? Rated maximum demand per hour

MISCELLANEOUS EQUIPMENT OR SPECIAL INFORMATION

Amount of fee enclosed? 2.00 (\$1.00 for one heater, etc., 50 cents additional for each additional heater, etc., in same building at same time.)

APPROVED

OK 827-48 Paine

Will there be in charge of the above work a person competent to see that the State and City requirements pertaining thereto are observed? yes The Paine Co.

By:

Signature of Installer

INSPECTION COPY

Permit No. 48/1538
 Location 25 Glebe Rd
 Owner Miss Edith Potter
 Date of permit 8/28/48
 Approval STATUS: NOT COMPL

NOTES 6.6.49
1711

- 1. Fill Pipe.....
- 2. Vent Pipe.....
- 3. Kind of Heat.....
- 4. Burner Rigidity & Supports.....
- 5. Name & Label.....
- 6. Safety Control.....
- 7. High Limit Control.....
- 8. Remote Control.....
- 9. Piping Support & Protection.....
- 10. Valves in Supply Lines.....
- 11. Capacity of Tanks.....
- 12. Tank Rigidity & Supports.....
- 13. Tank Distance.....
- 14. Oil Guard.....
- 15. Instruction Card.....
- 16.....

91548 Being installed,
157-49 not at home
1711



GENERAL REFERENCE FORM
APPLICATION FOR PERMIT

PERMIT ISSUED
1944

Class of Building or Type of Structure Three Class NOV 8 1935

Portland, Maine, November 8, 1935

To the INSPECTOR OF BUILDINGS, PORTLAND, ME.

The undersigned hereby applies for a permit to erect alter install the following building structures equipment in accordance with the Laws of the State of Maine the Building Code of the City of Portland, plans and specifications, if any, submitted herewith and the following specifications:

Location 25 Lechele Road Ward B Within fire Limits? no Dist. No. _____
Owner's or Lessee's name and address Edith A. Potter, 25 Lechele Road Telephone 2-2188
Contractor's name and address OSMUR Telephone _____
Architect's name and address _____
Proposed use of building dwelling house No. families 1
Other buildings on same lot garage
Plans filed as part of this application? no No. of sheets _____
Estimated cost \$ 10. Fee \$.25

Description of Present Building to be Altered

Material wood No. stories 1 1/2 Ht. _____ Style of roof _____ Roofing _____
Last use dwelling house No. families 1

General Description of New Work

To rebuilding existing ~~dwelling house~~ 10' x 6', making it 6' x 6'

NOTIFICATION BEFORE LATHING
OR CLOSING IN IS WAIVED
CERTIFICATE OF OCCUPANCY
REQUIRED BY LAW IN THE NAME OF

It is understood that this permit does not include installation of heating apparatus which is to be taken out separately by and to the name of the heating contractor.

Details of New Work

Size, front _____ depth _____ No. stories _____ Height average grade to top of plate _____
To be erected on solid or filled land? _____ earth or rock? _____
Material of foundation concrete Thickness, top _____ bottom _____
Material of concrete Height _____ Thickness _____
Kind of Roof no Rise per foot _____ Roof covering _____
No. of chimneys _____ Material of chimneys _____ of lining _____
Kind of heat _____ Type of fuel _____ Is gas fitting involved? _____
Corner posts _____ Sills 2x6 Girt or ledger board? _____ Size _____
Material columns under girders _____ Size _____ Max. on centers _____
Studs (outside walls and carrying partitions) 2x4-16" O. C. Girders 6x8 or larger. Bridging in every floor and flat roof span over 8 feet. Sills and corner posts all one piece in cross section.
Joists and rafters: 1st floor 2x6, 2nd _____, 3rd _____, roof no
On centers: 1st floor 18", 2nd _____, 3rd _____, roof _____
Maximum span: 1st floor 0', 2nd _____, 3rd _____, roof _____
If one story building with masonry walls, thickness of walls? _____ height? _____

If a Garage

No. cars now accommodated on same lot _____, to be accommodated _____
Total number commercial cars to be accommodated _____
Will automobile repairing be done other than minor repairs to cars habitually stored in the proposed building? _____

Miscellaneous

Will above work require removal or disturbing of any shade tree on a public street? no
Will there be in charge of the above work a person competent to see that the State and City requirements pertaining thereto are observed? yes

Signature of owner Edith A. Potter
Edith A. Potter

INSPECTION COPY

Ward 9 Permit No. 35/1944

Location 259 Lockeley Road

Owner Edith G. Patten

Date of permit 11/8/35

Notif. closing-in

Inspn. closing-in

Final Notif.

Final Inspn. 11/14/35

Cen. of Occupancy issued None

NOTES
11/14/35 - Work done - OK

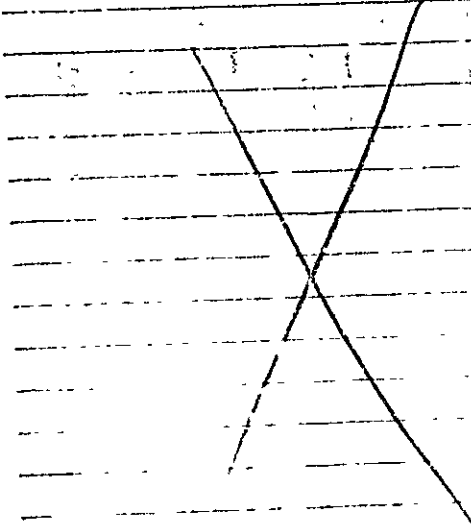

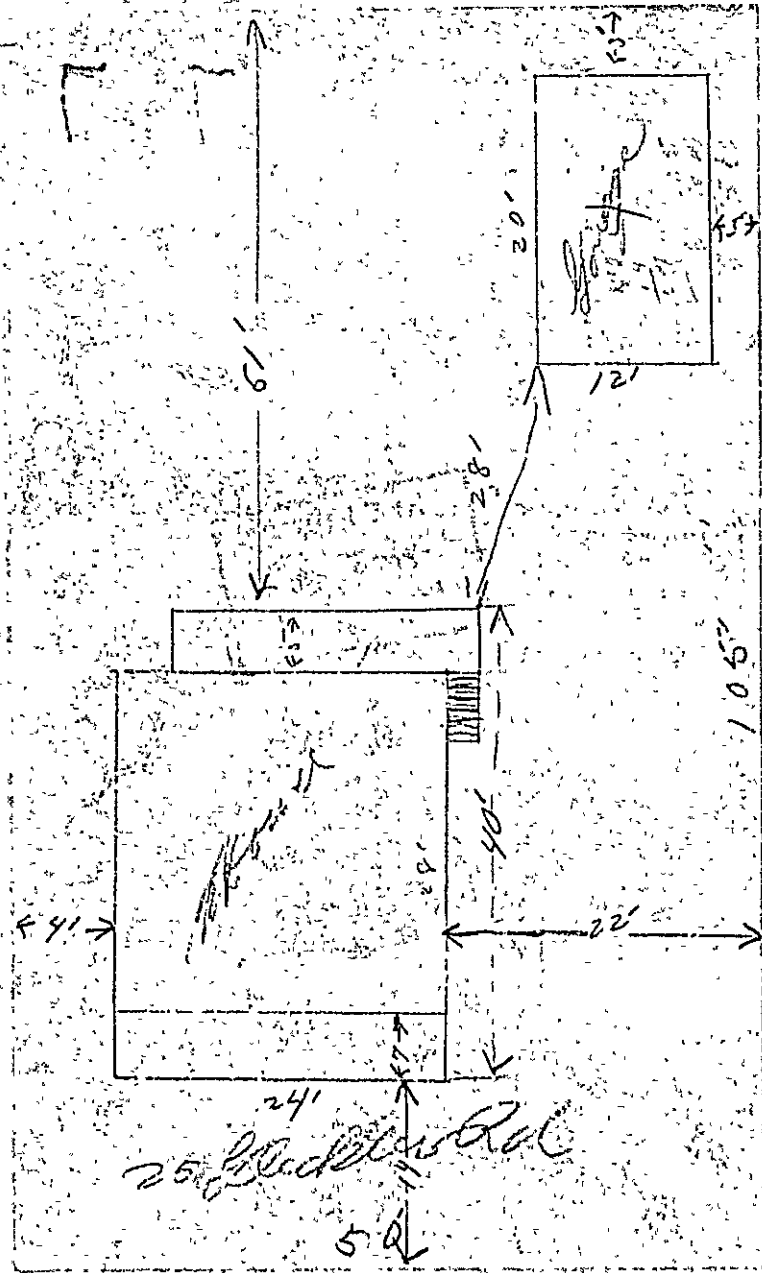

STATEMENT ACCOMPANYING APPLICATION FOR BUILDING PERMIT

for one car garage
at 25 Gleaskler Road

Date 10/23/31

1. In whose name is the title of the proper. now recorded? Edith a. Bitter
2. Are the boundaries of the property in the vicinity of the proposed work shown clearly on the ground, and how?
3. Is the outline of the proposed work now staked out upon the ground? yes If not, will you notify the Inspection Office when the work is staked out and before any of the work is commenced? Monday A.M.
4. What is to be maximum projection or overhang of eaves or drip? 1 ft
5. Do you assume full responsibility for the correctness of the location plan or statement of location filed with this application, and does it show the complete outline of the proposed work on the ground, including bay windows, porches and other projections? yes
6. Do you assume full responsibility for the correctness of all statements in the application concerning the sizes, design and use of the proposed building? yes
7. Do you understand that in case changes are proposed in the location of the work or in any of the details specified in the application that a revised plan and application must be submitted to this office before the changes are made? yes

Jarose A. Bitter



(R) GENERAL RESIDENCE ZONE
APPLICATION FOR PERMIT

Permit No. 2200

Class of Building or Type of

Fire Class

2200
OCT 26 1931

Portland, Maine, October 25, 1931

To the INSPECTOR OF BUILDINGS, PORTLAND, ME.

The undersigned hereby applies for a permit to erect alter-install the following building structure equipment in accordance with the Laws of the State of Maine, the Building Code of the City of Portland, plans and specifications, if any, submitted herewith and the following specifications:

Location 25 Glecklor Road Ward 9 Within Fire Limits? no Dist. No. _____
Owner's or Lessee's name and address E. J. Potter, 25 Glecklor Rd. Telephone 7 6366
Contractor's name and address Genar Telephone _____
Architect's name and address _____
Proposed use of building 1 car garage No. families _____
Other buildings on same lot 1 family dwelling house
Plans filed as part of this application? yes No. of sheets 1
Estimated cost \$ 150. Fee \$.75

Description of Present Building to be Altered

Material _____ No. stories _____ Heat _____ Style of roof _____ Roofing _____
Last use _____ No. families _____

General Description of New Work

To erect one car frame garage 12' x 20'

NOTIFICATION OF PERMITTING
OR CLOSING IS WARRANTED
CERTIFICATE OF OCCUPANCY
REQUIREMENT IS FULFILLED

It is understood that this permit does not include installation of heating apparatus which is to be taken out separately by and in the name of the heating contractor.

Details of New Work

Size, front 12' depth 20' No. stories 1 Height average grade to top of plate 6'
Height average grade to highest point of roof 12'
To be erected on solid or filled land? solid earth or rock? earth
Material of foundation concrete slab Thickness, top _____ bottom _____
Material of underpinning _____ Height _____ Thickness _____
Kind of Roof pitch Rise per foot 7" Roof covering Asphalt roofing, Class C Und. 12 b.
No. of chimneys no Material of chimneys _____ of lining _____
Kind of heat no Type of fuel _____ Is gas fitting involved? _____
Corner posts 4x4 Sills 4x4 Girt or ledger board? _____ Size _____
Material columns under girders _____ Size _____ Max. ot. center _____
Studs (outside walls and carrying partitions) 2x1-16" O.C. Girders 6x8 or larger. Bridging in every floor and flat roof span over 8 feet. Sills and corner posts all one piece in cross section.
Joists and rafters: 1st floor concrete, 2nd _____, 3rd _____, roof 2x4
On centers: 1st floor _____, 2nd _____, 3rd _____, roof 2'
Maximum span: 1st floor _____, 2nd _____, 3rd _____, roof _____
If one story building with masonry walls, thickness of walls? _____ height? _____

If a Garage

No. cars now accommodated on same lot no to be accommodated 1
Total number commercial cars to be accommodated no
Will automobile repairing be done other than minor repairs to cars habitually stored in the proposed building? no

Miscellaneous

Will above work require removal or disturbing of any shade tree on a public street? no
Will there be in charge of the above work a person competent to see that the State and City requirements pertaining thereto are observed? yes

INSPECTOR COPY

Signature of owner Edward J. Potter

Oliver J. [unclear]

6399A

Ward 9 Permit No. 31/2200
Location 25 Gleches Road
Owner T. J. Fitts
Date of permit 10/20/31
Mth. closing-in _____
Inspn. closing-in _____
Final Notif. _____
Final Inspn. 11/14/31 C.B.
Cert. of Occupancy issued None

^{C. J.}
10/26/31 NOTES
Location as attached a.k.
C.B.
11/14/31
Garage not finished, frame
a.k. 4x6 header, done.
C.B.





Location, ownership and detail must be correct, complete and legible. Separate application required for every building. Plans must be filed with this application.

APPLICATION FOR PERMIT TO BUILD

(3D CLASS BUILDING)

Portland, Me., May 7, 1923 19

TO THE
INSPECTOR OF BUILDINGS

The undersigned hereby applies for a permit to build, according to the following Specifications:-

Plans must be submitted in duplicate, one set to be filed with the Department and the duplicate set thereof (bearing approval of the Inspector of Buildings) shall be kept on the work and exhibited on demand.

PERMIT MUST BE RECEIVED BEFORE BEGINNING WORK

Name or owner is? lot 27 Gleckler Rd Frederick A Potter Word 8 Fire Limits? no
 Name of mechanic is? owner Address 49 Morning Street
 Name of architect is? _____ Address _____
 Proposed occupancy of building (purpose)? dwelling
 If a dwelling or tenement house, for how many families? 1
 Are there to be stores in lower story? _____
 Size of lot, No. of feet front? _____; No. of feet rear? _____; No. of feet deep? _____
 Size of building, No. of feet front? 24ft; No. of feet rear? 24ft; No. of feet deep? 28ft
 No. of stories, front _____; rear? _____
 No. of feet in height from the mean grade of street to the highest part of the roof? 24ft
 Distance from lot lines, front? _____ feet; side? _____ feet; side? _____ feet; rear? _____
 Firestop to be used? yes
 Will the building be erected on solid or filled land? _____
 Will the foundation be laid on earth, rock or piles? _____
 If on piles, No. of rows? _____ distance on centres? _____ length of? _____
 Diameter, top of? _____ diameter, bottom of? _____
 Size of posts, 4 x 6 Studding 2 x 4 16 O. C. Sills 4 x 8 Roof Rafters 2 x 6 24 O. C. Girders 6 x 8
 Size of girts 4 x 4
 Size of floor timbers: 1st floor 2x8, 2d _____, 3d _____, 4th _____
 O. C. " " " " 16, 2d _____, 3d _____, 4th _____
 Span " " " not over 16 ft, 2d _____, 3d _____, 4th _____
 Will the building be properly braced? _____
 Building, how framed? _____
 Material of foundation? concrete thickness of? 12in laid with mortar? _____
 Underpinning, material of? concrete height of? 5ft thickness of? 8in
 Will the roof be flat, pitch, mansard or hip? pitch Material of roofing? asphalt
 Will the building be heated by steam, furnaces, stoves or grates? furnace Will the flues be lined? yes
 Will the building conform to the requirements of the law? yes
 Means of egress? _____

If the building is to be occupied as a Tenement House, give the following particulars

What is the height of cellar or basement? _____
 What will be the clear height of first story? _____ second? _____ third? _____
 State what means of egress is to be provided _____
 Scuttle and stepladder to roof? _____

Estimated Cost, \$ 3,000.
 Signature of owner or authorized representative, Frederick A Potter
 Address 49 Morning St.
 Plans submitted? _____ Received by? _____

Lot 37 Gleckler Pk
23-25 1923

No. 6122

APPLICATION FOR
Permit to Build
3rd CLASS BUILDING

LOCATION
No. 23-25 lot 27 Gleckler Rd

WARD 8

Inspector.

CONDITIONS

PERMIT GRANTED
May 7, 1923

102

Permit filled out by _____

Permit number _____

Plan number _____

FINAL REPORT

102

Has the work been completed in accordance
with this application and plans filed and ap-
proved?

Law been violated? _____

Nature of violation? _____

Violation removed when? _____

Estimated cost of building, etc., \$ _____

Building Inspector.

APPROVAL OF PLANS

Supervisor of plans