

Landscape Plan for

Back Cove Estates: Front Entrance

GNÔME LANDSCAPE DESIGN

305 US Route 1 PO Box 66803
 Falmouth, Maine 04105
 phone: 207.781.2955 fax: 207.781.5705
 email: gnome@maine.rr.com

© 2005 Gnome LDM

scale 1" = 16'-00"

revised 11-7-05

approx. 80' of fence
 move rocks forward as
 necessary to allow for
 fence

remove
 rocks

15676

existing
 stonewall

freestanding 5' high
 stone pillar, 4'x4' square

approx. 24' of fence

approx. 100' of fence

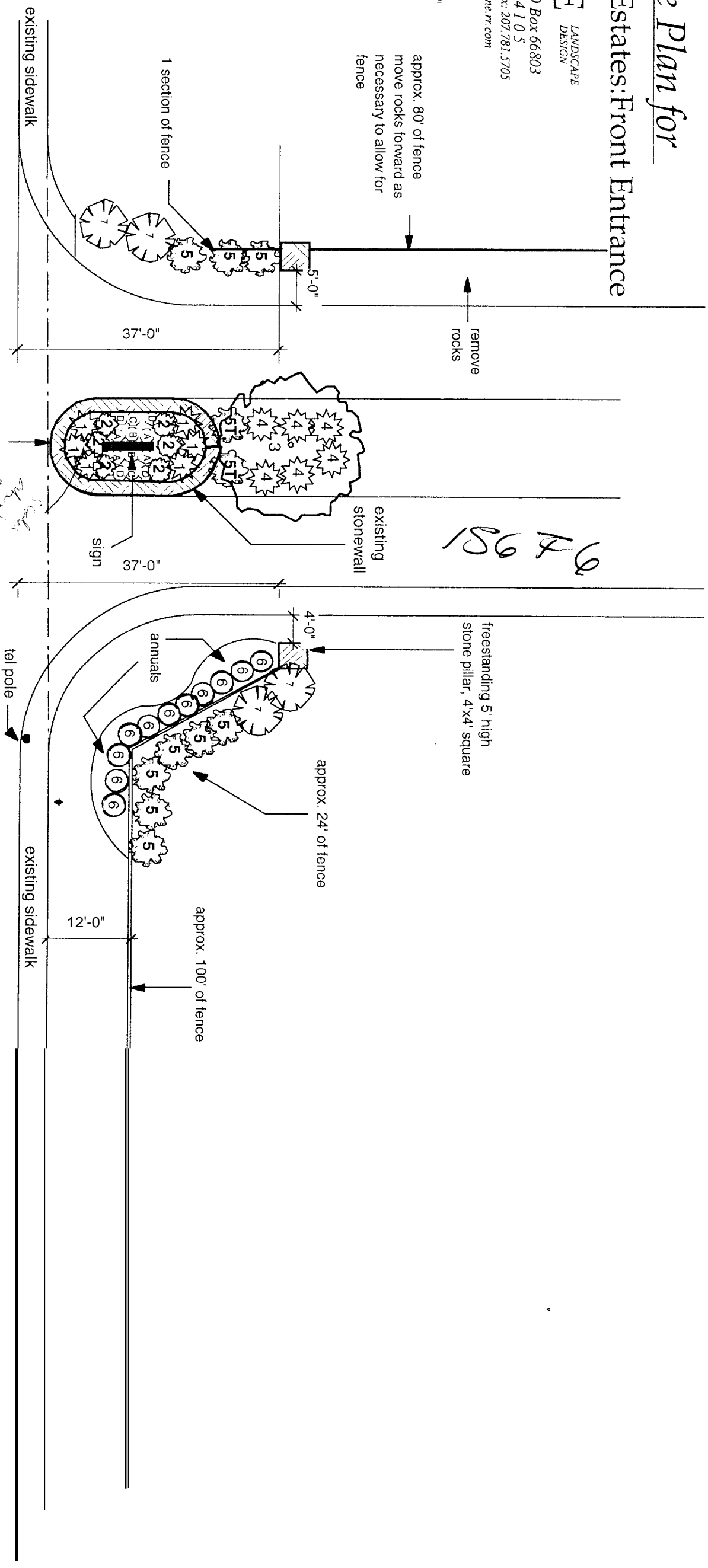

Ocean Ave.

PLANT SCHEDULE

Key	Common Name	Scientific Name	Quantity	Size
1	Blue Rug Juniper	Juniperus horizontalis 'Blue Rug'	6	3 gal.
2	Magic Carpet Spiraea	Spiraea japonica 'Magic Carpet'	6	3 gal.
3	Crabapple var.	Malus var.	1	existing
4	Broadmore Juniper	Juniperus sabina 'Broadmore'	6	2-2.5'
5T	PJM Rhododendron	Rhododendron var. 'PJM'	2	transplant
5	PJM Rhododendron	Rhododendron var. 'PJM'	9	2-2.5'
6	'Knock Out' Rose	Rosa var. 'Knock Out'	12	transplant
7	Mugo Pine	Pinus mugo	4	36-42"
A	'Happy Returns' Daylily	Hemerocallis 'Happy Returns'	4	Container
B	'Pardon Me Day' Lily	Hemerocallis 'Pardon Me'	2	Container
C	'Walker's Low' Catmint	Nepata x faassenii 'Walker's Low'	2	Container
D	'Moonbeam' Tickseed	Coreopsis verticillata 'Moonbeam'	4	Gal.

Landscape Plan for

Back Cove Estates

GNÔME

LANDSCAPE DESIGN

scale 3/4" = 1'-0"

305 US Route 1 PO Box 66803
 Falmouth, Maine 04105
 phone: 207.781.2955 fax: 207.781.5705
 email: gnome@maine.r.com

© 2005 Gnome LDM

Handwritten initials/signature

Back Cove Estates: Sign
 to replace existing wooden sign

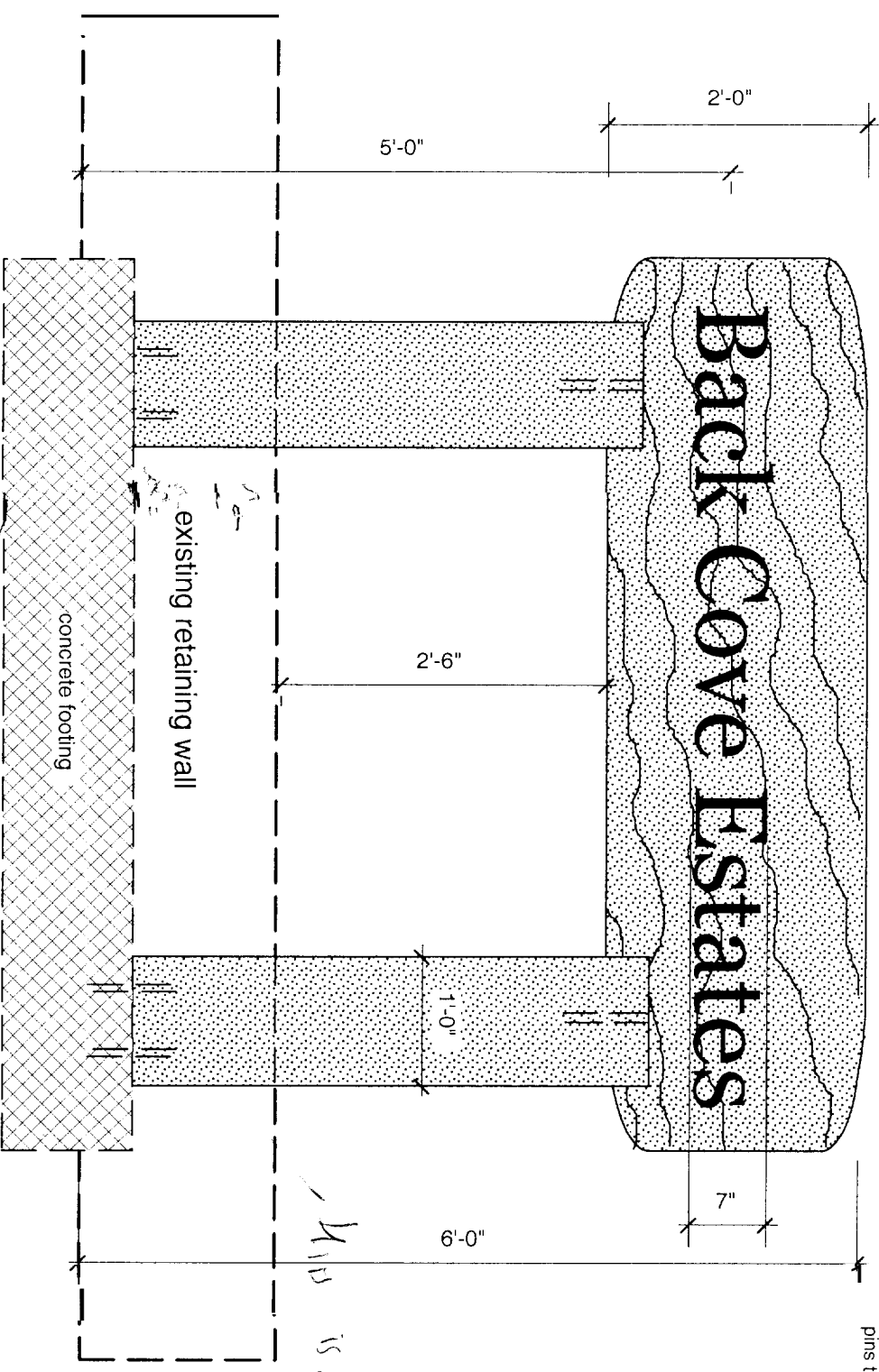
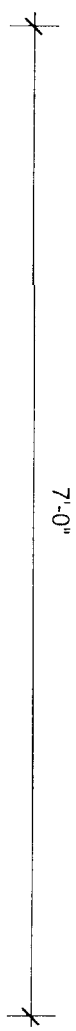

Handwritten note: 4 is good.

sign to be constructed of 'Deer Isle' granite
 lighting to remain as is with lights installed in plant beds
 lights to be wired onto photo-sensors and will be lit only
 when natural light is low
 ease all edges
 corners to be rounded
 lettering to be black
 wave patterns to be cut into stone deeply enough to have
 reveal cast shadow without detracting from lettering
 pins to be installed at all joints

