

GENERAL NOTES

1. ALL WORK SHALL BE IN ACCORDANCE WITH THE LATEST EDITIONS OF THE NATIONAL ELECTRICAL CODE (NEC) AND THE NATIONAL FIRE ALARM CODE (NFPA).
2. RUN ALL SURFACE WIRING AS UNCONCEALED AS POSSIBLE. CONCEAL WIRING IN WALLS AND CEILING WHERE NECESSARY.
3. DEVICES WITH "A" TO "E" DESIGNATION SHALL BE INSTALLED IN ACCORDANCE WITH THE NATIONAL FIRE ALARM CODE (NFPA).
4. DEVICES WITH "A" TO "E" DESIGNATION SHALL BE INSTALLED IN ACCORDANCE WITH THE NATIONAL FIRE ALARM CODE (NFPA).
5. DEVICES WITH "A" TO "E" DESIGNATION SHALL BE INSTALLED IN ACCORDANCE WITH THE NATIONAL FIRE ALARM CODE (NFPA).
6. DEVICES WITH "A" TO "E" DESIGNATION SHALL BE INSTALLED IN ACCORDANCE WITH THE NATIONAL FIRE ALARM CODE (NFPA).
7. INDICATE ALL WORK TO BE DONE BY OTHER TRADES.

NOTED NOTES

1. SEE FIRE ALARM RIBBON DIAGRAM ON DRAWING E30-1 FOR WIRING REQUIREMENTS.
2. SEE FIRE ALARM RIBBON DIAGRAM ON DRAWING E30-1 FOR WIRING REQUIREMENTS.
3. SEE FIRE ALARM RIBBON DIAGRAM ON DRAWING E30-1 FOR WIRING REQUIREMENTS.
4. SEE FIRE ALARM RIBBON DIAGRAM ON DRAWING E30-1 FOR WIRING REQUIREMENTS.
5. SEE FIRE ALARM RIBBON DIAGRAM ON DRAWING E30-1 FOR WIRING REQUIREMENTS.
6. SEE FIRE ALARM RIBBON DIAGRAM ON DRAWING E30-1 FOR WIRING REQUIREMENTS.
7. SEE FIRE ALARM RIBBON DIAGRAM ON DRAWING E30-1 FOR WIRING REQUIREMENTS.
8. SEE FIRE ALARM RIBBON DIAGRAM ON DRAWING E30-1 FOR WIRING REQUIREMENTS.
9. SEE FIRE ALARM RIBBON DIAGRAM ON DRAWING E30-1 FOR WIRING REQUIREMENTS.
10. SEE FIRE ALARM RIBBON DIAGRAM ON DRAWING E30-1 FOR WIRING REQUIREMENTS.
11. SEE FIRE ALARM RIBBON DIAGRAM ON DRAWING E30-1 FOR WIRING REQUIREMENTS.
12. SEE FIRE ALARM RIBBON DIAGRAM ON DRAWING E30-1 FOR WIRING REQUIREMENTS.
13. SEE FIRE ALARM RIBBON DIAGRAM ON DRAWING E30-1 FOR WIRING REQUIREMENTS.
14. SEE FIRE ALARM RIBBON DIAGRAM ON DRAWING E30-1 FOR WIRING REQUIREMENTS.
15. SEE FIRE ALARM RIBBON DIAGRAM ON DRAWING E30-1 FOR WIRING REQUIREMENTS.
16. SEE FIRE ALARM RIBBON DIAGRAM ON DRAWING E30-1 FOR WIRING REQUIREMENTS.
17. SEE FIRE ALARM RIBBON DIAGRAM ON DRAWING E30-1 FOR WIRING REQUIREMENTS.
18. SEE FIRE ALARM RIBBON DIAGRAM ON DRAWING E30-1 FOR WIRING REQUIREMENTS.
19. SEE FIRE ALARM RIBBON DIAGRAM ON DRAWING E30-1 FOR WIRING REQUIREMENTS.
20. SEE FIRE ALARM RIBBON DIAGRAM ON DRAWING E30-1 FOR WIRING REQUIREMENTS.

SEAL

James H. Gifford
 CONSULTING ENGINEER
 161 MAIN STREET WINTHROP, MAINE
 Tel: 207-277-6889 Fax: 207-277-7584
 Lic. Proj. No. 04028

Date	Description
05-28-04	ISSUED FOR BID
05-17-04	OWNER REVIEW
05-17-04	OWNER REVIEW

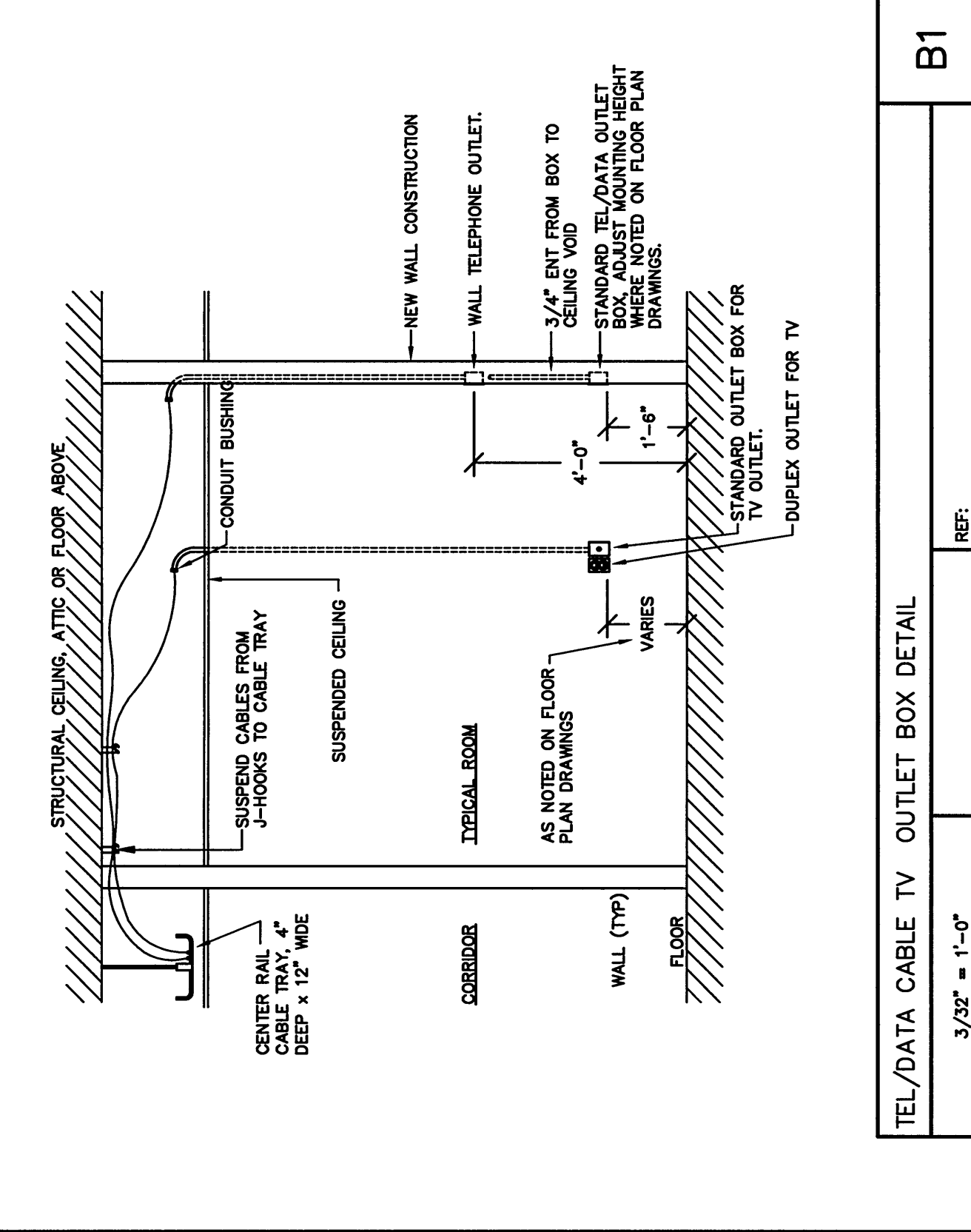

TEL/DATA CABLE TV OUTLET BOX DETAIL
 3x2" - 1'-0"
 B1

FIRE ALARM NOTES

1. CONDUIT LOCATION AS REQUIRED TO SUIT CONDITIONS FOUND IN THE FIELD.
2. SEE FIRE ALARM RIBBON DIAGRAM ON DRAWING E30-1 FOR WIRING REQUIREMENTS.
3. SEE FIRE ALARM RIBBON DIAGRAM ON DRAWING E30-1 FOR WIRING REQUIREMENTS.
4. SEE FIRE ALARM RIBBON DIAGRAM ON DRAWING E30-1 FOR WIRING REQUIREMENTS.
5. SEE FIRE ALARM RIBBON DIAGRAM ON DRAWING E30-1 FOR WIRING REQUIREMENTS.
6. SEE FIRE ALARM RIBBON DIAGRAM ON DRAWING E30-1 FOR WIRING REQUIREMENTS.
7. SEE FIRE ALARM RIBBON DIAGRAM ON DRAWING E30-1 FOR WIRING REQUIREMENTS.
8. SEE FIRE ALARM RIBBON DIAGRAM ON DRAWING E30-1 FOR WIRING REQUIREMENTS.
9. SEE FIRE ALARM RIBBON DIAGRAM ON DRAWING E30-1 FOR WIRING REQUIREMENTS.
10. SEE FIRE ALARM RIBBON DIAGRAM ON DRAWING E30-1 FOR WIRING REQUIREMENTS.
11. SEE FIRE ALARM RIBBON DIAGRAM ON DRAWING E30-1 FOR WIRING REQUIREMENTS.
12. SEE FIRE ALARM RIBBON DIAGRAM ON DRAWING E30-1 FOR WIRING REQUIREMENTS.
13. SEE FIRE ALARM RIBBON DIAGRAM ON DRAWING E30-1 FOR WIRING REQUIREMENTS.
14. SEE FIRE ALARM RIBBON DIAGRAM ON DRAWING E30-1 FOR WIRING REQUIREMENTS.
15. SEE FIRE ALARM RIBBON DIAGRAM ON DRAWING E30-1 FOR WIRING REQUIREMENTS.
16. SEE FIRE ALARM RIBBON DIAGRAM ON DRAWING E30-1 FOR WIRING REQUIREMENTS.
17. SEE FIRE ALARM RIBBON DIAGRAM ON DRAWING E30-1 FOR WIRING REQUIREMENTS.
18. SEE FIRE ALARM RIBBON DIAGRAM ON DRAWING E30-1 FOR WIRING REQUIREMENTS.
19. SEE FIRE ALARM RIBBON DIAGRAM ON DRAWING E30-1 FOR WIRING REQUIREMENTS.
20. SEE FIRE ALARM RIBBON DIAGRAM ON DRAWING E30-1 FOR WIRING REQUIREMENTS.

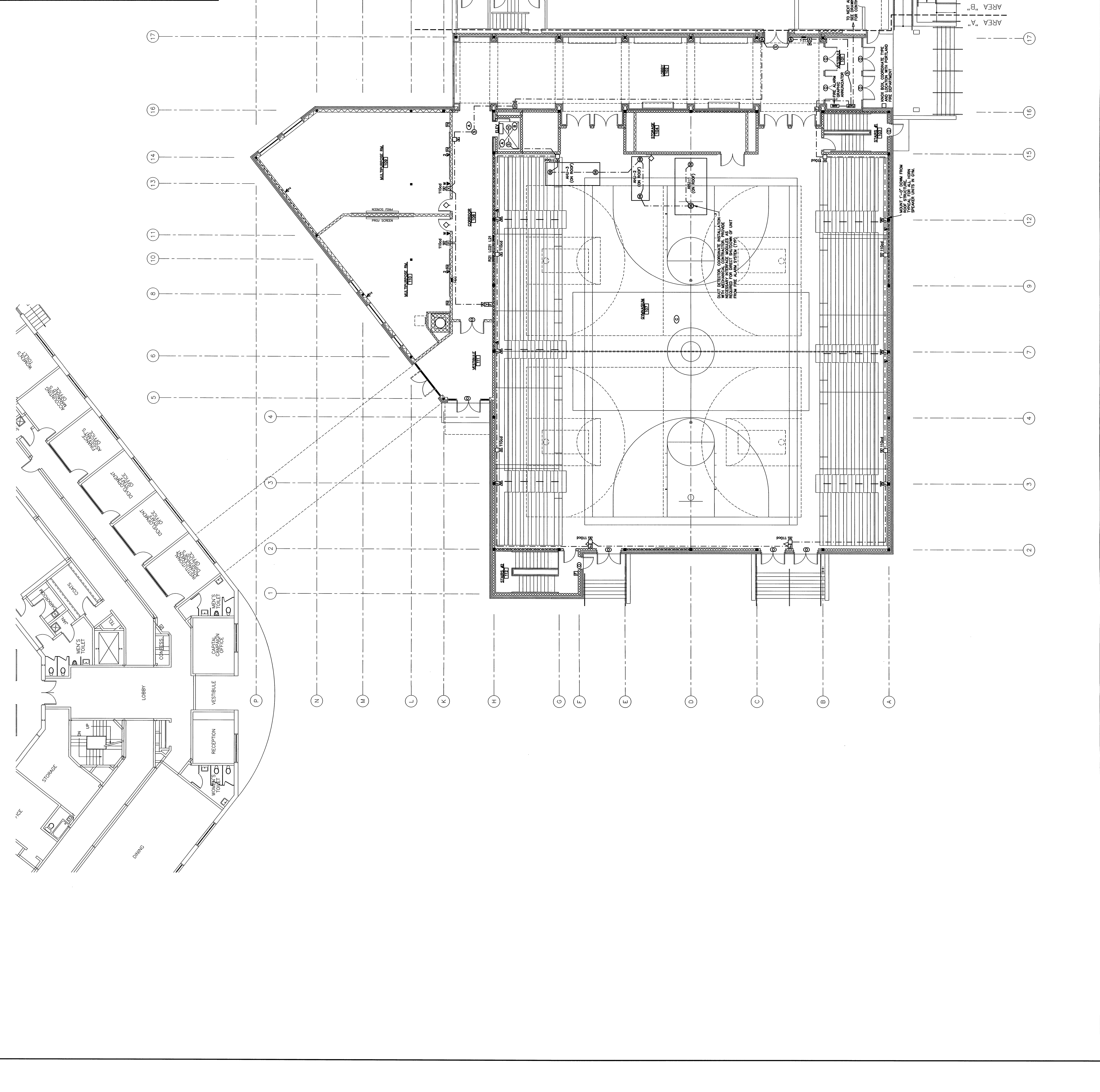

FIRST FLOOR PLAN SYSTEMS - AREA A
 1/8" = 1'-0"
 A1