

DISPLAY THIS CARD ON PRINCIPAL FRONTAGE OF WORK

CITY OF PORTLAND

Please Read
Application And
Notes, If Any,
Attached

BUILDING INSPECTION

PERMIT

Permit Number: 080885

This is to certify that ST IGNATIUS RESIDENCE OF THE SOCIETY OF JESUShas permission to Attach 13 Banner Signs to Existing PoleAT 267 OCEAN AVE

156 F001001

provided that the person or persons who accept this permit shall comply with all of the provisions of the Statutes of Maine and of the Ordinances of the City of Portland regulating the construction, maintenance and use of buildings and structures, and of the application on file in this department.

Apply to Public Works for street line and grade if nature of work requires such information.

Notification of inspection must be given and when permission is procured before this building or part thereof is altered or service is closed-in 24 HOUR NOTICE REQUIRED.

A certificate of occupancy must be procured by owner before this building or part thereof is occupied.

OTHER REQUIRED APPROVALS

Fire Dept. _____

Health Dept. _____

Appeal Board _____

Other _____

Department Name

Director - Building & Inspection Services

PENALTY FOR REMOVING THIS CARD

City of Portland, Maine - Building or Use Permit Application

389 Congress Street, 04101 Tel: (207) 874-8703, Fax: (207) 874-8716

Permit No: 08-0885	Issue Date:	CBL: 156 F001001
-----------------------	-------------	---------------------

Location of Construction: 267 OCEAN AVE	Owner Name: ST IGNATIUS RESIDENCE THE	Owner Address: 271 OCEAN AVE	Phone: 207-774-6238
Business Name:	Contractor Name:	Contractor Address:	Phone:
Lessee/Buyer's Name	Phone:	Permit Type: Signs - Permanent	Zone: R-3

Past Use: Private Secondary School/Cheverus	Proposed Use: Private Secondary School/Cheverus - Attach 12 4 Banner Signs to Existing Poles two	Permit Fee: \$165.00	Cost of Work: \$0.00	CEO District: 4
Proposed Project Description: 2 Attach 12 Banner Signs to Existing Poles		FIRE DEPT: <input type="checkbox"/> Approved <input type="checkbox"/> Denied Signature: <i>[Signature]</i>	INSPECTION: Use Group: <input checked="" type="checkbox"/> Type: <i>sign</i> <i>IBC 2003</i> Signature: <i>[Signature]</i>	
		PEDESTRIAN ACTIVITIES DISTRICT (P.A.D.) Action: <input type="checkbox"/> Approved <input type="checkbox"/> Approved w/Conditions <input type="checkbox"/> Denied Signature: _____ Date: _____		

Permit Taken By: lmd	Date Applied For: 07/22/2008	Zoning Approval		
<ol style="list-style-type: none"> This permit application does not preclude the Applicant(s) from meeting applicable State and Federal Rules. Building permits do not include plumbing, septic or electrical work. Building permits are void if work is not started within six (6) months of the date of issuance. False information may invalidate a building permit and stop all work.. 		Special Zone or Reviews <input type="checkbox"/> Shoreland <input type="checkbox"/> Wetland <input type="checkbox"/> Flood Zone <input type="checkbox"/> Subdivision <input checked="" type="checkbox"/> Site Plan Maj <input type="checkbox"/> Minor <input type="checkbox"/> MM <input type="checkbox"/> Date: <i>12/16/08</i>	Zoning Appeal <input type="checkbox"/> Variance <input type="checkbox"/> Miscellaneous <input type="checkbox"/> Conditional Use <input type="checkbox"/> Interpretation <input type="checkbox"/> Approved <input type="checkbox"/> Denied Date: _____	Historic Preservation <input checked="" type="checkbox"/> Not in District or Landmark <input type="checkbox"/> Does Not Require Review <input type="checkbox"/> Requires Review <input type="checkbox"/> Approved <input type="checkbox"/> Approved w/Conditions <input type="checkbox"/> Denied <i>ABH</i> Date: _____
		<i>- same to Doh under section 14-365.1(6)</i> <i>[Signature]</i>		

CERTIFICATION

I hereby certify that I am the owner of record of the named property, or that the proposed work is authorized by the owner of record and that I have been authorized by the owner to make this application as his authorized agent and I agree to conform to all applicable laws of this jurisdiction. In addition, if a permit for work described in the application is issued, I certify that the code official's authorized representative shall have the authority to enter all areas covered by such permit at any reasonable hour to enforce the provision of the code(s) applicable to such permit.

SIGNATURE OF APPLICANT	ADDRESS	DATE	PHONE
RESPONSIBLE PERSON IN CHARGE OF WORK, TITLE		DATE	PHONE

City of Portland, Maine - Building or Use Permit

389 Congress Street, 04101 Tel: (207) 874-8703, Fax: (207) 874-8716

Permit No: 08-0885		Date Applied For: 07/18/2008	CBL: 156 F001001
Location of Construction: 267 Ocean Ave	Owner Name: ST IGNATIUS RESIDENCE THE	Owner Address: 271 OCEAN AVE	Phone: 207-774-6238
Business Name:	Contractor Name:	Contractor Address:	Phone:
Lessee/Buyer's Name	Phone:	Permit Type: Signs - Permanent	
Proposed Use: Private Secondary School/Cheverus - Attach four Banner Signs to two Existing Poles		Proposed Project Description: Attach 4 Banner Signs to two Existing Poles	
Dept: Zoning Status: Approved Reviewer: Ann Machado Approval Date: 12/16/2008 Note: See letter dated 8/8/08. Ok to Issue: <input checked="" type="checkbox"/> 12/16/08 Deb approved a revised proposal for four banners on two light posts under section 14-368.5(g).			
Dept: Building Status: Approved Reviewer: Tammy Munson Approval Date: 12/24/2008 Note: Ok to Issue: <input checked="" type="checkbox"/>			
Dept: Planning Status: Approved with Conditions Reviewer: Deborah Andrews Approval Date: 12/16/2008 Note: Ok to Issue: <input checked="" type="checkbox"/> 1) Approved based on revised proposal dated November 5, 2008, which calls for a pair of banners on 2 light poles--total of 4 banners.			

Comments:

7/22/2008-lmd: Received permit application via postal mail on 7/14/08. Application was not complete. Left message with Michael on 7/15/2008. Received call back from Janet Miller, she stated that she would speak with Michael and mail all requested information. I received the additional information today, 7/22/2008.

9/8/2008-amachado: Gave permit to Deb Andrews. Cheverus has appealed to the planning division.

8/7/2008-amachado: Spoke to Michael Komich. Told him that we could not issue the permit because the zone (R-3 institutional use) only allows one free standing sign which they already have. He may appeal to the planning division. Also three of the banners are off premise which is not allowed, and there was no certificate of flamibility. See letter dated 8/8/08.



PORTLAND MAINE

Strengthening a Remarkable City, Building a Community for Life • www.portlandmaine.gov

Penny Littell - Director of Planning and Development
Marge Schmuckal, Zoning Administrator

August 8, 2008

Michael S. Komich
Cheverus High School
267 Ocean Avenue
Portland, ME 04103

RE: 267 Ocean Avenue – 156 F001 – R-3 – attach thirteen banner signs – permit #08-0885

Dear Mr. Komich,

I have reviewed your application to install thirteen banners at Cheverus High School. I must deny your application because it does not meet the requirements of the ordinance for signs.

Cheverus High School is located in the R-3 residential zone. Section 14-369.5, Table 2.2 of the ordinance outlines the requirements for signs for institutional uses in residential zones. This section only allows one freestanding sign for each street that the property abuts. There is already one freestanding sign on the property, so the ordinance does not allow for thirteen more. Also three of the proposed banners are located in the right of way and not on the property. Signs are considered an accessory use (section 14-404d). The use must be located on the property that it is accessory to. Section 14-368(e) states that signs are not allowed in the public right of way unless they are specifically listed in that section.

You have the right to appeal my decision. Section 14-368.5(g) of the ordinance states that an applicant who has been denied a permit or approval for failure to meet the signage regulations of section 14-369.5 "may apply to the planning authority for review of the denied signage pursuant to the standards set forth in section 14-526(a)(23)". If the planning authority disapproves the application, then under section 14-527 of the ordinance you may appeal the decision to the Planning Board within ten (10) days of the decision being rendered.

If you choose not to apply to the planning authority for a review, you are entitled to get most of your money back if you bring in the original receipt you got when you applied for the permit. Please feel free to call me at 874-8709 if you have any questions.

Yours truly,

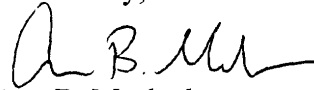
A handwritten signature in black ink, appearing to read 'A. B. Machado', with a stylized flourish at the end.

Ann B. Machado
Zoning Specialist
(207) 874-8709

The Jesuit College Preparatory School of Maine
CHEVERUS
267 Ocean Avenue, Portland, ME 04103-5707

August 14, 2008

Ms. Deborah G. Andrews
Historic Preservation Manager
City of Portland
389 Congress Street
Portland, ME 04101-3509

Dear Deborah,

I am writing to you today to appeal the decision to deny Cheverus High School the ability to install banners on our campus light poles.

I have enclosed a copy of the denial letter from Ann Machado, Zoning Specialist. Ann has agreed to provide you with a copy of our entire application submittal for your reference. In addition, I am enclosing a copy of the fire retardant certification for the banner material we plan to use.

These banners are an essential part of our ongoing plans to market Cheverus High School to the public and demonstrate to people walking and driving by our campus that we are a private School that may be an option for their children or someone's children they know.

As you probably know, similar banners of this type are in use currently by the Breakwater School and the University of New England.

We eagerly await your reply.

Sincerely,

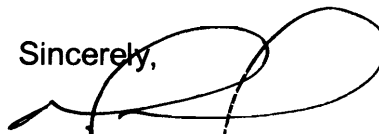

Michael S. Kornich
Business Manager

From: Molly Casto
To: Machado, Ann
Date: 9/5/2008 4:17:42 PM
Subject: Re: banner signs at Cheverus

Hi Ann-

Mike Komich called a few weeks ago and we discussed the appeal process for the banners. At a subsequent meeting I gave him Deb's card as a contact for his appeal application. I haven't heard anything since.

Molly

Molly P. Casto, Senior Planner
Portland Planning Division
389 Congress Street
Portland, Maine 04101-3509
207-874-8901
MPC@portlandmaine.gov

>>> Ann Machado 09/05 3:14 PM >>>
Molly -

I was just wondering if you had heard anything from Michael Komich at Cheverus High School about the thirteen banner signs that they want to add to their campus. I denied the permit on August 8 but he was going to appeal to the planning division. I have the original application in my hold basket.

Thanks, Ann

CC: Deb Andrews

The Jesuit College Preparatory School of Maine
CHEVERUS
267 Ocean Avenue, Portland, ME 04103-5707

*Revised
proposal
approved
under
Site Plan
exception*

November 5, 2008

Ms. Deborah G. Andrews
Historic Preservation Manager
City of Portland
389 Congress Street
Portland, ME 04101-3509

Dear Deborah,

As per our conversation earlier this week, we are pleased that your department will allow two (2) of our light poles to host two (2) banners each as previously described in my past correspondence.

Enclosed please find the pole locations we have identified in orange on the site plan copy. We greatly await your approval letter so that we may order the banners.

Sincerely,

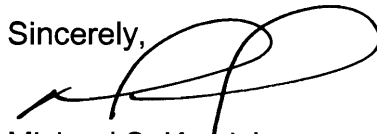

Michael S. Kornich
Business Manager

Encl.



Signage/Awning Permit Application

If you or the property owner owes real estate or personal property taxes or user charges on any property within the City, payment arrangements must be made before permits of any kind are accepted.

Location/Address of Construction: 267 Ocean Avenue Portland, ME 04103		
Tax Assessor's Chart, Block & Lot Chart# Block# Lot# 156 F 001	Owner: Cheverus High School	Telephone: 207-774-6238
Lessee/Buyer's Name (If Applicable) NA	Contractor name, address & telephone: NA	Total s.f. of signage x \$2.00 67.5 sq.ft. Per s.f. plus 30.00 \$65.00 For H.D. signage= Total Fee: \$ 165 Awning Fee= cost of work _____ Total Fee: \$ _____

Who should we contact when the permit is ready: Michael S. Komich phone: 774-6238 ext. 29

Tenant/allocated building space frontage (feet): Length: _____ Height: _____
Lot Frontage (feet) _____ Single Tenant or Multi Tenant Lot _____

Current Specific use: Private Secondary School campus

If vacant, what was prior use: _____

Proposed Use: _____

Information on proposed sign(s):

Freestanding (e.g., pole) sign? Yes _____ No ☒ Dimensions proposed: 18"x30" Height from grade: 14'
Bldg. wall sign? (attached to bldg) Yes _____ No _____ Dimensions proposed: _____

Proposed awning? Yes _____ No ☒ Is awning backlit? Yes _____ No ☒

Height of awning: _____ Length of awning: _____ Depth: _____

Is there any communication, message, trademark or symbol on it? Yes _____ No _____

If yes, total s.f. of panels w/communications, message, trademark or symbol: _____ s.f.

Information on existing and previously permitted sign(s): NA

Freestanding (e.g., pole) sign? Yes _____ No _____ Dimensions: _____

Bldg. wall sign? (attached to bldg) Yes _____ No _____ Dimensions: _____

Awning? Yes _____ No _____ Sq. ft. area of awning w/communication: _____

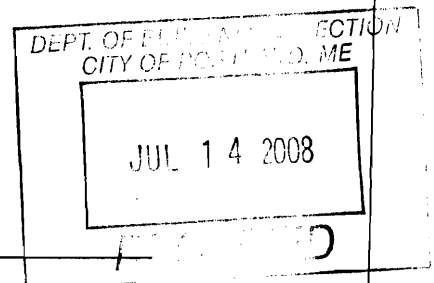

A site sketch and building sketch showing exactly where existing and new signage is located must be provided. Sketches and/or pictures of proposed signage and existing building are also required. See red circles on enclosed plan.

Please submit all of the information outlined in the Sign/Awning Application Checklist.

Failure to do so may result in the automatic denial of your permit.

In order to be sure the City fully understands the full scope of the project, the Planning and Development Department may request additional information prior to the issuance of a permit. For further information visit us on-line at www.portlandmaine.gov, stop by the Building Inspections office, room 315 City Hall or call 874-8703.

I hereby certify that I am the Owner of record of the named property, or that the owner of record authorizes the proposed work and that I have been authorized by the owner to make this application as his/her authorized agent. I agree to conform to all applicable laws of this jurisdiction. In addition, if a permit for work described in this application is issued, I certify that the Code Official's authorized representative shall have the authority to enter all areas covered by this permit at any reasonable hour to enforce the provisions of the codes applicable to this permit.

Signature of applicant: John A. Miller

Date: 6/30/08

This is not a permit; you may not commence ANY work until the permit is issued.

The Jesuit College Preparatory School of Maine
CHEVERUS
267 Ocean Avenue, Portland, ME 04103-5707

7/16/08

JUL 18 2008

Lisa Danforth
City of Portland
389 Congress Street
Room 315
Portland, ME 04101

Dear Lisa,

Please find enclosed the following items you requested from Michael Komich.

- 3 photos of existing signs
- 11 x 17 site map of the banner locations (see red markings)

The proposed number of banners is 13.

Please contact Michael Komich at 774-6238 ext. 29 if you have any questions.

Sincerely,

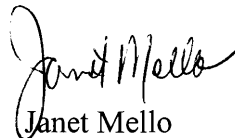

Janet Mello
Administrative/Finance Support Specialists

rec'd.
8/14/08



Acrylic Coated, 100% Polyester
61" Width • 9.6 Oz. Per Sq. Yd.

Main Street is for awnings and canopies that won't sag! Not only will Main Street continue to hold its shape, but you can count on rich, vibrant colors after years of exposure.

Features:

- Acrylic coating helps keep fabric clean
- Water resistant and repellent
- Ultraviolet resistant
- Mildew resistant
- Exceptional dimensional stability
- Superior tensile and tear strength
- Flame retardant to specifications of California State Fire Marshal, I-119, S: U.L.-214, Classified: NFPA-701; ASTM-E-84, Class A building materials
- Stripes also available in 61" width
- Quick drying
- Fabricates easily
- No puckering or fraying
- Heat sealable
- Accepts graphics
- 5 year limited awning warranty



Put up on approximately 50 linear yard rolls.

Applications:

- Awnings
- Canopies
- Banners
- Decorative panels
- Recreational luggage
- Duffle bags
- Patio furniture covers
- Other interior and exterior specialty applications

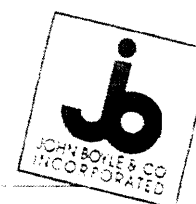

THE LEADER IN QUALITY AND INNOVATION

John Boyle & Co. Incorporated, 10000 E. 1st Avenue, Suite 100, Denver, CO 80231, USA
 Phone: (303) 751-1234, Fax: (303) 751-1235, Email: sales@johnboyle.com, Website: www.johnboyle.com
 John Boyle & Co. Incorporated, 10000 E. 1st Avenue, Suite 100, Denver, CO 80231, USA
 Phone: (303) 751-1234, Fax: (303) 751-1235, Email: sales@johnboyle.com, Website: www.johnboyle.com



2129 PERTAGE STREET
KALAMAZOO, MI 49001
PH: 269.376.6474
PH: 269.295.4532
FX: 269.352.2612
www.consort.com

KALAMAZOO BANNER WITH SIGN DISPLAY GROUP CENTER, TX BUCKLE, CONCORD, FL

COREY ROLFE

SALES REPRESENTATIVE

MOCK UP# 7082.08jm PAGE: 1 of 1
DATE: 6.2.2008 REVISION# 1
JOB NAME: Cheverus High School

BANNER INFO

FABRIC: Sunbrella XXXXXXXXXX Concord

SIZE: 18"x 30" HEMS: 3" SIDES: 2

PANTONE INKS



IMPORTANT, PLEASE NOTE: The colors shown on this mock up are reasonable representations of customer approved colors. If PMS color matches are required, Consort will, with the best technical methods possible, match PMS colors which may not necessarily be the exact colors represented on this paper mock up.

ARTWORK INFO:

Custom.

PLACEMENT:

Image is centered.

TYPEFONTS USED:

As shown.

ARTWORK READY TO PRINT: YES

CUSTOMER: PLEASE SIGN & RETURN

Authorized by _____

All designs displayed are copyrighted © 2008 Consort and/or its customers. Reproduction without expressed written permission is prohibited. Consort reserves the right to improve ink/fabric colors. Illustrations are provided as reasonable representations.

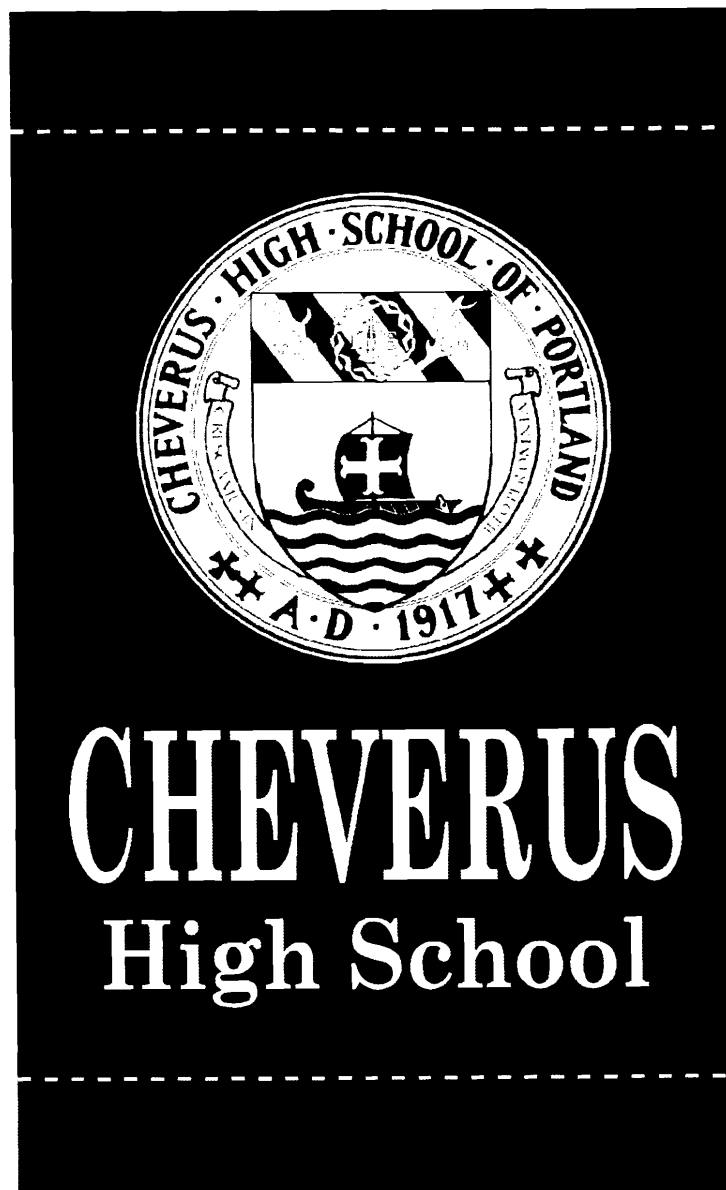

Banner®



Look to BannerFlex for the industry standard in banner mounting hardware.

One look at the BannerFlex banner mounting bracket from KBW will tell you why it's unquestionably the most innovative and dependable hardware for exterior banner installations. With a well-earned tradition of performance and durability, the BannerFlex bracket is designed to outperform all other banner hardware systems.

Hundreds of thousands of BannerFlex™ brackets throughout the United States and Canada provide fully functioning, attention grabbing examples of this banner mounting system's longevity and outstanding performance in virtually every type of weather condition. KBW originated and patented the BannerFlex™ Bracket System after researching the weaknesses of typical "steel arm/steel collar" bracket design. But the true tests of any bracket system are strong winds and severe weather. After rigorous wind tunnel testing and years of actual exposure to inclement weather, BannerFlex has always emerged as the proven winner.

BannerFlex. Performance, durability and innovation. Because you expect nothing less from the industry leader in exterior banner hardware and banner display systems — Kalamazoo Banner Works.

KBW™

Kalamazoo Banner Works

CONSORT
DISPLAY • SETUP

BannerFlex Jr:

This compact version of the BannerFlex bracket incorporates a straight fiberglass arm in place of the cantilever design. It mounts banners up to 20" by 70" or smaller on ornamental street lamps or utility poles.

Bannerflex Jr. is also available with removable rods.

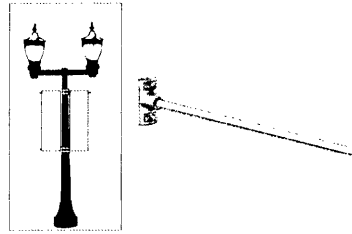

Plant Holder & Flag Pole Holder:

The Flag Pole Holder and the Plant Holder may be placed into the bracket when banners are not displayed. The Flag Pole Holder will accommodate a pole that is 1" in diameter by 6' in length. The Plant Holder is canted upward slightly.

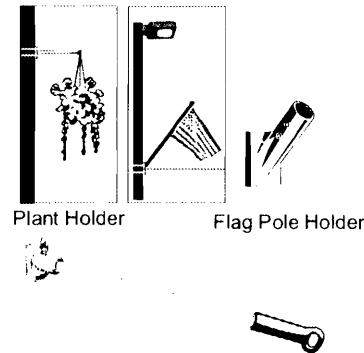

BannerFlex Bracket:

This universal bracket allows the BannerFlex system to be mounted on almost any type of pole, regardless of shape or surface, using Band-It materials or bolts. Interchangeable parts (described below) fit into the standard bracket.

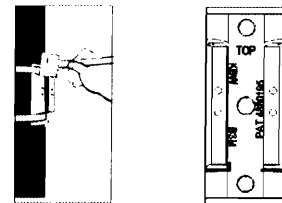

Band-It®, Buckle, Band-It Tool:

These tools and hardware make installation of BannerFlex brackets easy, fast and absolutely secure. The Band-It banding and buckles are made of stainless steel, to ensure performance.

Band-It is the registered trademark of IDEX Corp.

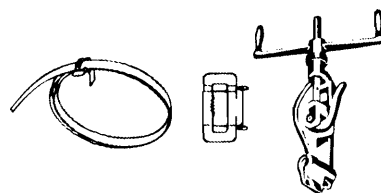

BannerFlex Arm:

Fiberglass construction along with our unique "cantilever" design helps dissipate the wind force, putting less stress on the mounted banner and utility pole. This arm holds banners ranging in size from 24"by 48" up to 31"by 94" and 31"x 96."

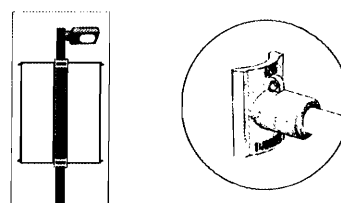

Square Pole Adapter & Tie-Down Bracket:

The Square Pole Adapter may be used when banding BannerFlex Brackets onto square utility poles that are 5" or larger in width. The Tie-Down Bracket allows the lower portion of a banner to flutter in the breeze. Call for advice on the use of these accessories.

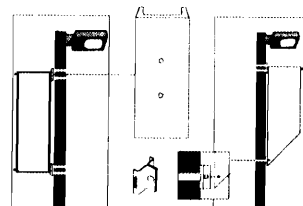

Customer Product Endorsement:

This letter was received by Kalamazoo Banner Works:

This winter's weather was the worst in the last 10 years. Three major storms and harsher than normal weather kept us hopping around here.

We were happily surprised at the lack of damage to the street banners we have installed using your bracket set. The surprise was especially shocking in view of the numerous flags and flagpoles that required emergency service.

We have more than 500 of your brackets in use and out of that number, we had to only retighten the banding on 15 sets. Not one set was lost or broken, which is pretty amazing when you think that the winds during these storms exceeded 90 miles per hour.

Now we know that your claims of durability are not just claims. This winter really put those brackets to the test and they passed with flying colors.

Thanks again for manufacturing such a fine product.

Ian Flamm

AAA American Flag Dec. Co., Inc.

The following is an excerpt from the wind tunnel test results of BannerFlex hardware:

"...a better alternative than the steel supports since the fiberglass arms flex under wind loads and return to the no-load position."

For a copy of the wind tunnel test, information on custom-printed banners, or interior display systems, please call or FAX us today.

KBW

Kalamazoo Banner Works

CONSORT
DIGITAL GROUP

2129 PORTAGE STREET
KALAMAZOO, MI 49001-6198
PH: 800/525-6424 FX: 269/388-2018
E-MAIL: info@consort.com
www.consort.com

KBW BannerFlex® D3 Bracket



The KBW BannerFlex D3 is the most recent manifestation of the first-ever fiberglass arm banner bracket system. After 20 years of extensive research and engineering, the KBW BannerFlex D3 is the most trusted, most recommended banner hardware in the industry. For quality and reliability look no further than the original, Kalamazoo Banner Works.

Often imitated but never duplicated, KBW/Consort's goal is to always be ahead of the curve. Placing a banner on a light pole is like adding a sail to an immovable object. Who will you trust to protect pedestrians, automobiles, and lightpoles - the innovator or the novice? Reduce your liability and protect your investment with the BannerFlex line of banner hardware. Available with both the standard 13/16" round fiberglass arm or the new premium Airow™ fiberglass arm.

Features and Benefits

Wind Tunnel Tested

(See Engineering Information Below)

KBW BannerFlex D3 Main Casting

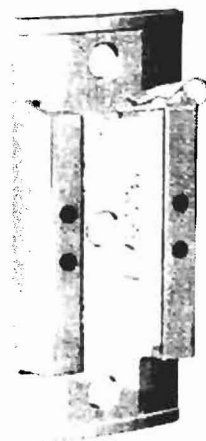

Feature	Benefit
356T6 Heat-Treated Cast Aluminum	<ul style="list-style-type: none">• Superior strength and durability• Corrosion resistant• Accepts powder coating
Bolt Holes	<ul style="list-style-type: none">• Casting may be easily bolted to poles in lieu of banding application
Banding Channels	<ul style="list-style-type: none">• Easily allows positioning of up to 3/4" wide banding to fasten casting to pole
Arm Slide Flanges	<ul style="list-style-type: none">• Banner can be installed or removed without moving or removing Main Casting• Allows banner-length adjustment of 1" at both top and bottom of banner• Arms may be removed when no banners are installed• Flower Pot Holder or Flag Pole Adapters may be installed when banners are not in use
Dacromet-Coated Set Screws and Zinc-Plated Hitch Pins	<ul style="list-style-type: none">• Corrosion resistant• Allows for easy installation and adjustment• Hitch Pin provides added security
Warranty	<ul style="list-style-type: none">• 10 Years when properly installed and maintained (See Warranty Information)

KBW BannerFlex D3 Arm Casting



Feature	Benefit
356T6 Heat-Treated Cast Aluminum	<ul style="list-style-type: none">• Superior strength and durability• Corrosion resistant• Accepts powder coating

KBW BannerFlex D3 Arm Casting (continued)

Feature

4-Degree Cantilevered Casting
(Top arm is canted up,
bottom arm is canted down)

Benefit

- Wind energy is transferred from banner to fiberglass arm
- Keeps banner trim and in tension
- Promotes banner longevity

Eyelet Included in Casting

- Allows for cable ties to be utilized through both the banner grommet and casting to secure banner
- Added security from loss or theft

KBW BannerFlex Standard 13/16" Round Fiberglass Arm

Feature

Pultruded Fiberglass Arm

Benefit

- Provides flexibility while maintaining strength
- Absorbs wind energy to reduce stress on banner and light pole
- Inherent flexibility of the arm allows for return of banner to original taut position once wind subsides
- Increases banner longevity

KBW BannerFlex Premium 3/4" Airow Fiberglass Arm

Feature

Eccentrically Milled, Pultruded
Fiberglass Arm with UV Coating
(Airow arm available for 24" to 30"
banner widths only)

Benefit

- Specially designed taper of fiberglass rod increases flexibility over standard rods by up to 50%
- Dissipates more wind energy to reduce stress on banner and light pole
- Inherent flexibility of the arm allows for return of arm and banner to original taut position once wind subsides
- Increases banner longevity
- Increases flexibility while maintaining strength
- Perfect for high wind areas and when extra wind load reduction is required

Engineering Information

KBW by Consort utilizes full-scale wind tunnel and material testing facilities along with computer-aided design programs to develop and affirm our product components, capabilities, features and warranties. For specific engineering data,

including our BannerFlex Wind Force Calculator, visit us at www.kalamazoobanner.com or contact your KBW/Consort Sales Representative at (800) 525-6424.

Consort Corporation
2129 Portage St. Kalamazoo, MI 49001
616.388.4532 fax 616.388.7920

PART NAME: BANNERFLEX MAIN BRACKET
PART NO. B3M
DESCRIPTION- SANDCAST
MATERIAL- ALMAG

SCALE 1:2
SHEET 1 of 1

DRAWN BY SDC ON 2.19.99
FILE NAME: B3Mbasicdim

UNLESS OTHERWISE SPECIFIED
DIMENSIONS ARE IN INCHES.
TOLERANCES ARE:

FRACTIONS DECIMALS ANGLES
 $\pm 1/64$ $\pm .01$ $\pm .5^\circ$

CAD GENERATED DRAWING
DO NOT MANUALLY UPDATE.

COPYRIGHT © CONSORT CORPORATION 2003

KBW Kalamazoo
Banner Works
by CONSORT

D
C
B
A

REVISIONS

DATE

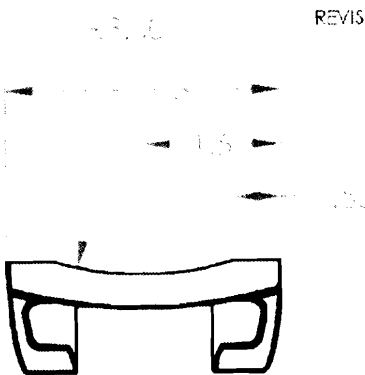

TOP VIEW

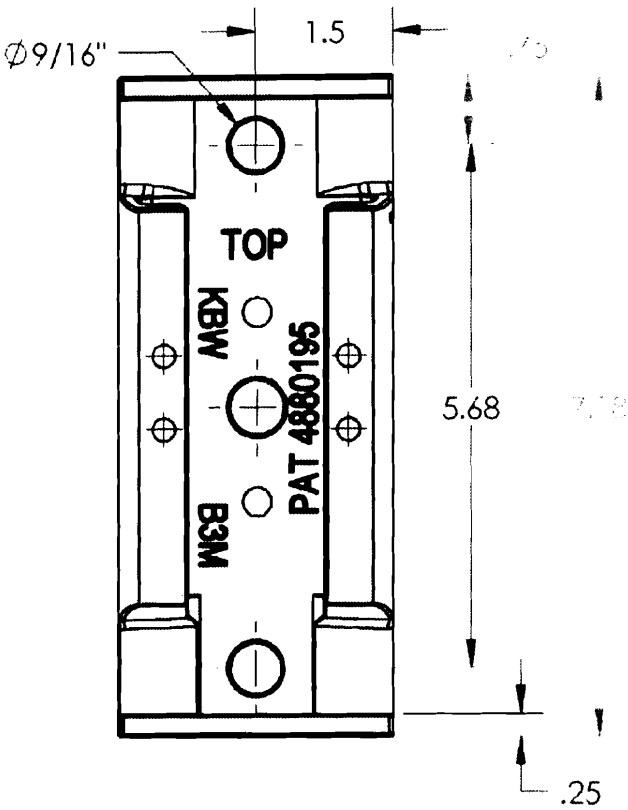

FRONT VIEW



RIGHT SIDE VIEW

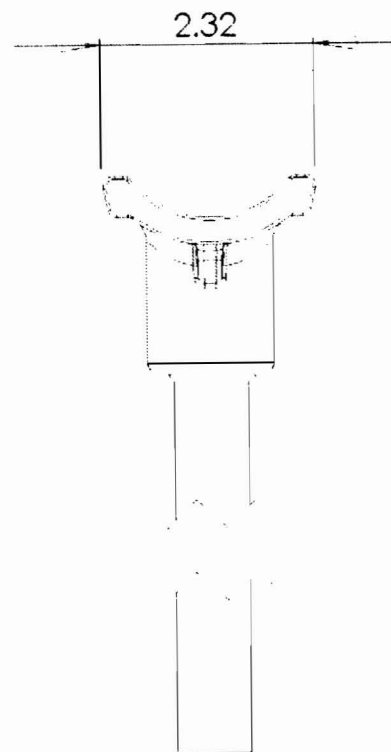

BANNERFLEX STRAIGHT ARM

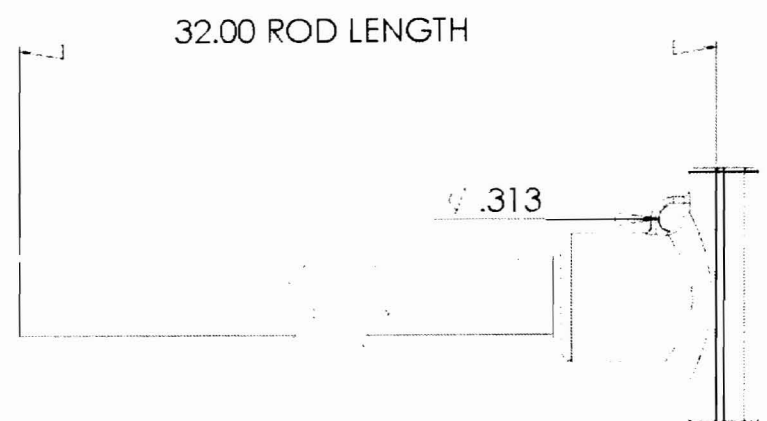
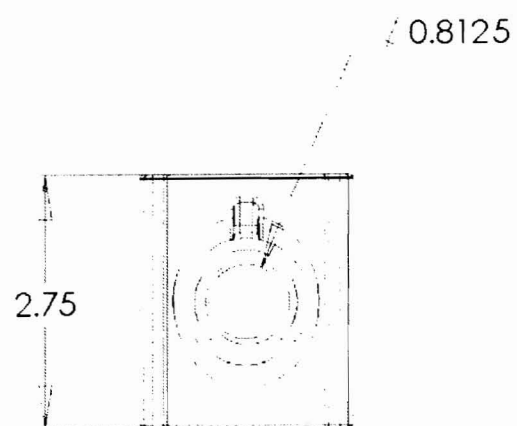
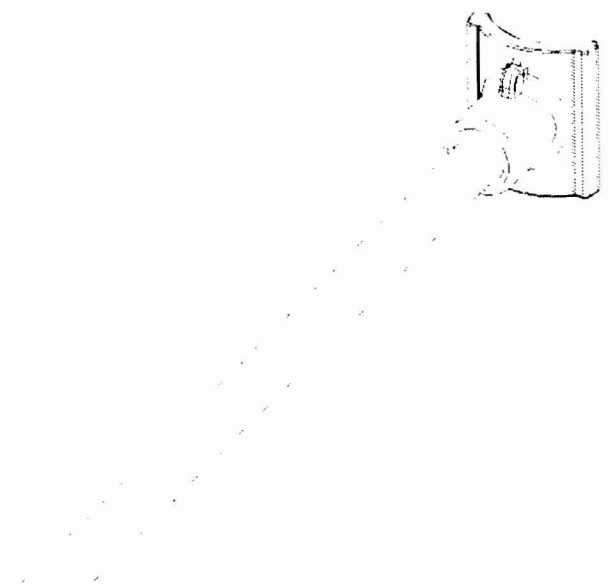

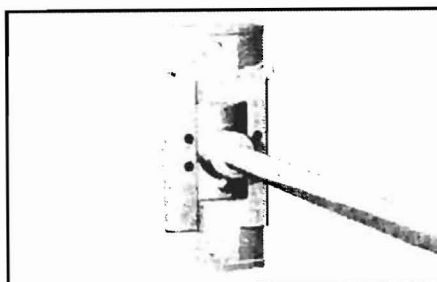

BannerFlex Patent # 4880195

PLEASE READ THIS FIRST!

See Page 2 for a list of tools required to install KBW BannerFlex Brackets. The buyer assumes full responsibility for determining that the light poles (or other substrates) are able to withstand the increased wind load generated by the installation of one or more banners of a particular size on each pole using top and bottom KBW BannerFlex brackets.

We recommend contacting the pole manufacturer or a structural engineer to assist in making this determination.

For older poles, we suggest visual inspections to determine the current structural integrity of the base connection as well as other portions of the pole, including the luminaire and its components.

If you have any questions concerning bracket installation, contact your KBW Sales Representative or the "Hardware Hotline" at 1-800-525-6424.

General Installation Guidelines

- Read these instructions carefully to understand the KBW "canting feature", how to "rock" the arms into place and how the fiberglass arms keep the banners tight.
- The KBW BannerFlex D3 main casting is designed to be attached to poles with bolts, screw-gear banding, or tool-applied Band-It solid banding.
- Always verify that high profile traffic, such as buses and trucks, will not come in contact with the installed brackets.
- "Fluted" poles sometimes do not allow an installation to "face" a particular direction due to the location of the flutes. We have found that slight angles away from perpendicular are not objectionable.
- These instructions explain banding brackets to the poles. If bolts are used, refer to these instructions for placement and proper use of the "canting feature."

Maintenance Guidelines

- We recommend new installations be visually inspected 30 days after initial installation to insure brackets are tight and trim, and every 60 days thereafter. Also, inspection should take place after unusually heavy windstorms, as abnormal gusts and flying debris may affect the quality of an installation.
- Banners which "whip" or "flutter" in the wind are not installed properly. This may cause undue wear and tear on the banner and eventually release from the bracket, which can heavily damage the banner. **Avoid this problem with inspections as suggested above. Repair loosened banners immediately.**
- Banners with puckers or stress lines along the fabric are too tight. Loosen and adjust the lower arm until banner is taut but smooth (see "Troubleshooting").

The KBW Banding Guideline Chart (© 2007 Consort Display Group)

This is a general guideline for the minimum banding strength necessary for single and double banner installations of various sizes for normal, non-catastrophic winds up to 70mph. Note: The quality of each installation affects the ultimate strength. Be sure bands or bolts are properly applied and at maximum pressure.

		Banding Options																Bolting Options	
		1/2", 9/16" or 5/8" Screw Gear Bands (SGB) Single wrap of 3/4" tool applied banding (9 poles/100' box) Double wrap of 3/4" tool applied banding (5 poles/100' box)																Brackets may be bolted in lieu of banding. See chart.	
		18" x 36"		24" x 48"		30" x 60"		30" x 72"		30" x 84"		30" x 94"		46" x 94"		30" x 120"		Maximum Single Banner Size	Maximum Total Sq Ft for 2 Banners Per Pole
		# banners	1	2	1	2	1	2	1	2	1	2	1	2	1	2	1	2	
KBW-D3	1/2" SGB	N/R	N/R	N/R	N/R	No	No	No	No	No	No	No	No	No	No	No	No	n/a	10
	9/16" SGB	N/R	N/R	N/R	N/R	No	No	No	No	No	No	No	No	No	No	No	No	n/a	16
	5/8" SGB	N/R	N/R	N/R	N/R	Yes	No	No	No	No	No	No	No	No	No	No	No	30" x 60"	16
	Single Wrap 3/4"	N/R	N/R	N/R	N/R	Yes	No	Yes	No	Yes	No	Yes	No	No	No	No	No	30" x 72"	25
	Double Wrap 3/4"	N/R	N/R	N/R	N/R	Yes	Yes	Yes	Yes	Yes	Yes	Yes	Yes	Yes	N/R	Yes	N/R	30" x 120"	30
KBW-D3 w/Arrow	1/2" SGB	n/a	n/a	N/R	N/R	No	No	No	No	No	No	No	No	n/a	n/a	No	No	30" x 54"	16
	9/16" SGB	n/a	n/a	N/R	N/R	Yes	No	Yes	No	No	No	No	No	n/a	n/a	No	No	30" x 60"	18
	5/8" SGB	n/a	n/a	N/R	N/R	Yes	No	Yes	No	Yes	No	No	No	n/a	n/a	No	No	30" x 94"	20
	Single Wrap 3/4"	n/a	n/a	N/R	N/R	Yes	Yes	Yes	Yes	Yes	No	Yes	N/R	n/a	n/a	Yes	No	30" x 108"	35
	Double Wrap 3/4"	n/a	n/a	N/R	N/R	Yes	Yes	Yes	Yes	Yes	Yes	Yes	Yes	n/a	n/a	Yes	Yes	30" x 120"	50

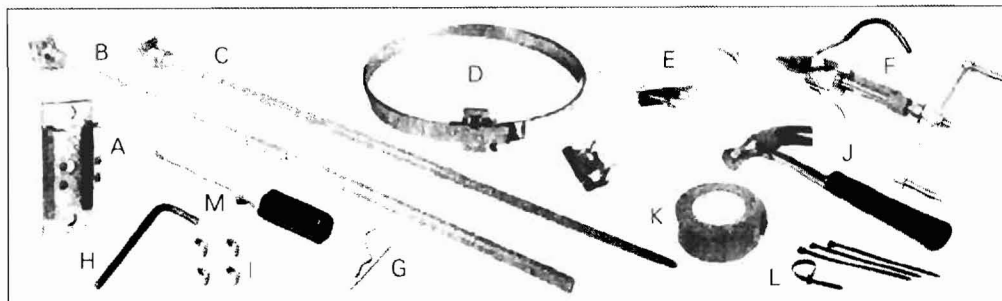

- A. Main Pole Casting
- B. Standard Arm/Arm Castings
- C. Premium Arrow Rod
- D. Band-It Banding & Buckle
- E. Screw Gear Banding
- F. Band-It Tool
- G. Hitch Pin
- H. Hex/Allen Wrench
- I. 4 Dacromet® Set Screws
- J. Hammer
- K. Duct Tape
- L. Nylon Cable Ties
- M. Screwdriver/Powerdriver

PLEASE READ COMPLETELY BEFORE BEGINNING INSTALLATION:

Start with the top banner bracket by mounting upper Main Casting(s) (A) first and complete all "top" procedures, including mounting the banner(s) and Nylon Cable Ties (L), before mounting lower casting(s). The upper castings must be mounted at a height that prevents any portion of the completed banner installation from being hit by vehicular traffic or pedestrians (see diagram right). You may use these instructions for both single and double banner per pole installations. First, inspect every pole to see if anything on the pole would wear against the banner fabric. Items to look for include signs and banding, flag pole holders, power or telephone lines or any other obstructions on the pole that might come into contact with the banner. Any object contacting a banner will eventually damage the banner, or the object, or both.

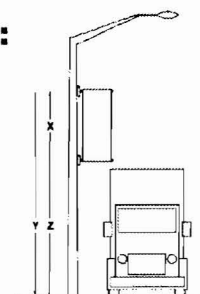

1 Slide buckle onto Band-It (D) by feeding buckle onto band "teeth" first" (see Band-It instructions included with tool).

2 Bend end of band under buckle about 2". You can use a hammer to crease band end down.



3 Using Duct Tape (K), temporarily hold casting(s) in place against utility pole at desired height. The word "TOP" on the Main Pole Casting (A) must be pointing up at ALL times for both Main Castings at both upper and lower locations.

4 Double wrap Band-It completely around pole at both the top part of the pole casting and the bottom part of the pole casting.

5 Be sure you understand double wrapping before proceeding.

6 Tighten the banding according to the instructions provided with the Band-It tool (F). Cut off excess banding with Band-It tool (F).

7 Pound Band-It down over buckle and pound buckle tabs over banding to secure each double wrapped band in place. Remove the duct tape.

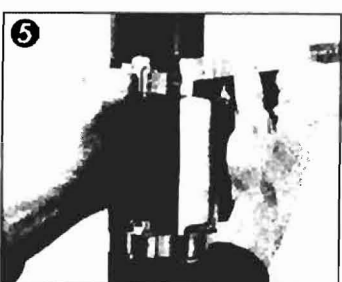

8 Remove Hitch Pin (G) from Main Casting and install upper Arm Casting (B or C) so the "BANNER" points toward where the banner will be located. Position the Arm Castings in the center of the Main Casting — this will allow some minor length adjustment either up or down, should the banners require adjustment. Re-install Hitch Pin.

Note: Bannerflex Arms are "canted" to put the banner in tension. This means that without a banner installed the upper arms will angle up slightly and the bottom arms will angle down slightly. When the banner is properly installed, the installation will be taught and trim. The fiberglass will bend down at the top and up at the bottom to make the banner appear square and stretched. This allows the wind to be immediately transferred to the fiberglass for deflection.

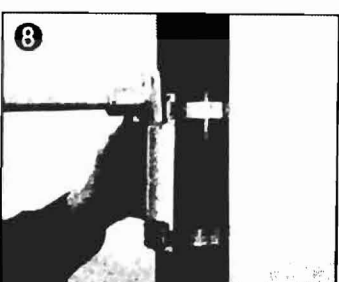

9 Tighten the Dacromet® Set Screws (I) with the appropriate Allen Wrench (H). Power tools are recommended here as well, for a speedy installation.

10 Slide top banner hem over fiberglass arm, grommet side first. Grommet side is closest to the pole. Allow banner to unfurl. Place banner hem up to (or over) the Arm Casting. Either look is acceptable but we recommend each banner be installed the same way for best appearance.

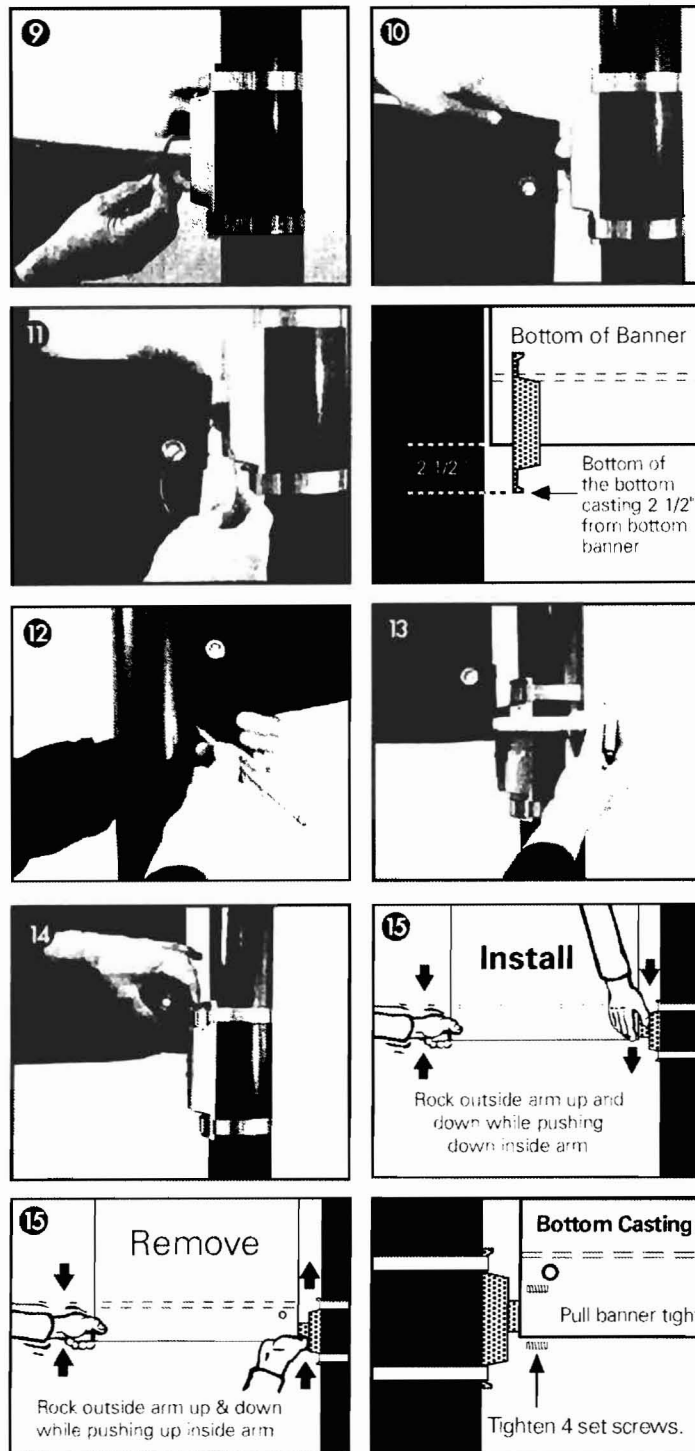

Illustration shows correct arm angle of finished installation

11 Slide second banner on opposite arm if mounting two banners per pole. Feed the Nylon Cable Tie (L) (or 18 gauge or larger galvanized wire) through the banner grommet and through the "eye" hole in the Arm Casting. This attachment is required to prevent the banner from sliding off.

Top portion of installation is now finished. Now you are ready to install the bottom Main Castings.

12 Pull banner down to mark pole for location of bottom casting/arm assembly - Mount bottom casting so that lowest edge of casting is approximately 2 1/2' lower than the bottom edge of the banner.

Repeat steps 1 through 7 to mount lower Main Castings in place.

13 14 Before putting Arm Castings into Main Castings, slide banner over the fiberglass arm. Important! see illustration on this page to understand how to slide arm casting into pole casting. When inserted correctly, bottom arms display a downward "cant" until banner is tightened between each arm. It will "bind up." See note in step #15 and illustrations at left for proper method. Be sure the banner arrows point towards the banner.

These next steps are very important! Please read carefully!

DO NOT USE EXCESSIVE FORCE OR TOOLS! IT IS NOT NECESSARY - Refer to illustration 15 to understand how to slide the Arm Casting into the Main Casting. Use a rocking action to position the Arm into place. Rock the Arm Casting until it is as far down into the Main Casting as possible and banner is taut and trim. If the banner(s) appear "pigeon-toed" or "fanned out," please see TROUBLESHOOTING.

15 ROCKING THE ARM INTO PLACE - VERY IMPORTANT! Each bottom arm can be easily "rocked" into position - see illustrations. Rock the arm assembly in the casting slot by pushing down on the outer end of the fiberglass arm and at the same time pressing the top of the Arm Casting downward with a thumb. Keep rocking the arm until it is seated as far down as it will go and the banner is taut. The arm should remain in position to tighten the Dacromet Set Screws (L). **Note: excessive hammering may damage the Casting and voids the KBW warranty.**

Secure the bottom of the banner to Main Casting with a Nylon Cable Tie (L) (or 18 gauge or larger galvanized wire) through the banner grommet and through the "eye" hole in the Arm Casting. This attachment is required to prevent the banner from sliding off.

CONGRATULATIONS! The banner installation is complete! If the banners appear "pigeon-toed" or "fanned out," please see TROUBLESHOOTING below.

TROUBLESHOOTING for Banner Installation and Maintenance

A) Are banners "pigeon-toed" or not square or perpendicular to pole?

This indicates that either the upper or lower Arm Castings are not "seated" properly in the Main Castings. The pigeon-toed look can be fixed by spreading the upper and lower arms apart more. Either lower the bottom Arm Casting further into the Main Casting, or raise the upper Arm Casting further into the top Main Casting. If there is not enough space in the Main Castings for this, either raise the upper Main Casting or lower the bottom Main Casting on the pole.

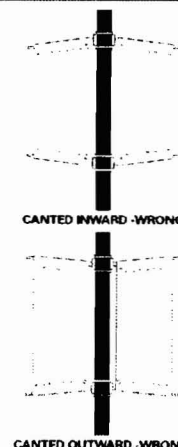

Troubleshooting (continued)

B) Is either the top of the banner slanted down significantly or the bottom of the banner slanted up significantly, or both?

This indicates that one or both of the arms are installed upside down. Make sure that the arrows beside the word, "BANNER" on the Arm Casting are pointed toward the actual banner.

C) Is the banner loose or flapping around?

This usually indicates that the Arm Castings are not seated properly to keep the banner trim and tight. Review numbers 10 through 14 in the Installation Instructions.

D) Are the banners puckered or do they have stress lines in them?

This may occur with certain fabrics and certain size banners. It results from the banner being stretched too tightly or the arms not being parallel (see "A" and "B" above). We recommend sliding the banner hem further over the Arm Casting's aluminum stub to relieve some of the puckering.

E) Are you seeing tearing or ripping of the banner fabric?

With the high-quality KBW banner fabrics, warranted for 2 years, you should never see this unless something is rubbing against the banner or if the installation has been allowed to flap around, without proper maintenance for two or more weeks. Other non-KBW banner fabrics may simply be too weak for exterior use. Call KBW or your dealer for advice on this topic.

First, check to see if installation is trim and tight. Next, see if anything on the utility pole has been allowed to wear against the banner fabric. This could be a sign, flag pole holder, power or telephone line or other abutment on the pole. Anything like this will always, eventually damage the banner.

F) My poles are tapered. How can these be installed on tapered poles?

See item G directly below

G) Are the Main Castings loosening on the pole and/or "crawling" up a tapered pole?

Any time a Main Casting is loose it is typically a result of three causes. First and usually, it may be that the fastening, such as Band-It Banding or Screw-Gear Banding is not applied properly and is not tight enough. With larger banner installations where "double wrapping" of 3/4" Band-It Banding is specified, double wrapping means the band needs to go around the pole twice before the Band-It Buckle is clamped. For screw-gear applications be sure that the correct size and strength of band has been applied and that it has been tightened properly. Note: almost every light pole is tapered. When the KBW bracket system has been correctly applied it will not loosen or crawl up a tapered pole.

The second most common reason an installation may loosen is if it has been hit by a truck, bus, fire engine or other such vehicle that has come in to contact with the bottom arm.

Third, an unusual or catastrophic windy condition may cause loosening or damage by flying objects hitting the installation.

KBW BannerFlex Warranty

KBW BannerFlex banner brackets are guaranteed for ten (10) years against defects in material and workmanship when installed according to KBW installation instructions. *Important: Bracket must be installed according to these instructions and banding method must be tight and secure at all times.* Also, inspect your bracket installation 30 days after initial installation and every 60 days thereafter, making any necessary adjustments immediately. Brackets which have been damaged by trucks, buses, etc. or flying debris are not warranted against that type of abuse.

Caring for your screen printed/textile banners

We suggest the following when storing your KBW banners for the season (Note: Other banner manufacturers caution against ink cracking and peeling if stored improperly. KBW inks will not crack or peel but we caution against folding and creasing banner simply from an appearance standpoint):

- Make sure banners are clean and dry before rolling up.
- Always roll banners to prevent creasing. Do not fold.
- Avoid crushing the banners. Do not store other items on top of them.

Cleaning KBW banners

- 1) Lay banners on clean surface such as concrete or asphalt with slope to drain.
- 2) Use a garden hose with moderate velocity spray and rinse banners. Lukewarm water works best, but cold water is acceptable.
- 3) For screen printed textile banners, use a soft bristle brush and a small amount of mild soap (such as liquid dish soap). For vinyl screen printed and digital banners, use a sponge. Always test a portion of ink before cleaning entire banner.
- 4) Rinse and hang to dry.

Note: Do not dry clean banners. Avoid machine washing as agitator may rub and damage ink. Do not use a commercial dryer to dry.

Smaller Utility Poles?

Call your KBW Sales Representative for information on our KBW BannerFlex JR bracket, for smaller banners, such as 18" x 36".

Thank you for selecting KBW, the industry leader in banner hardware.



ANOTHER FINE PRODUCT FROM

CONSORT
DISPLAY GROUP

2129 Portage Street
Kalamazoo, Michigan 49001
www.consort.com

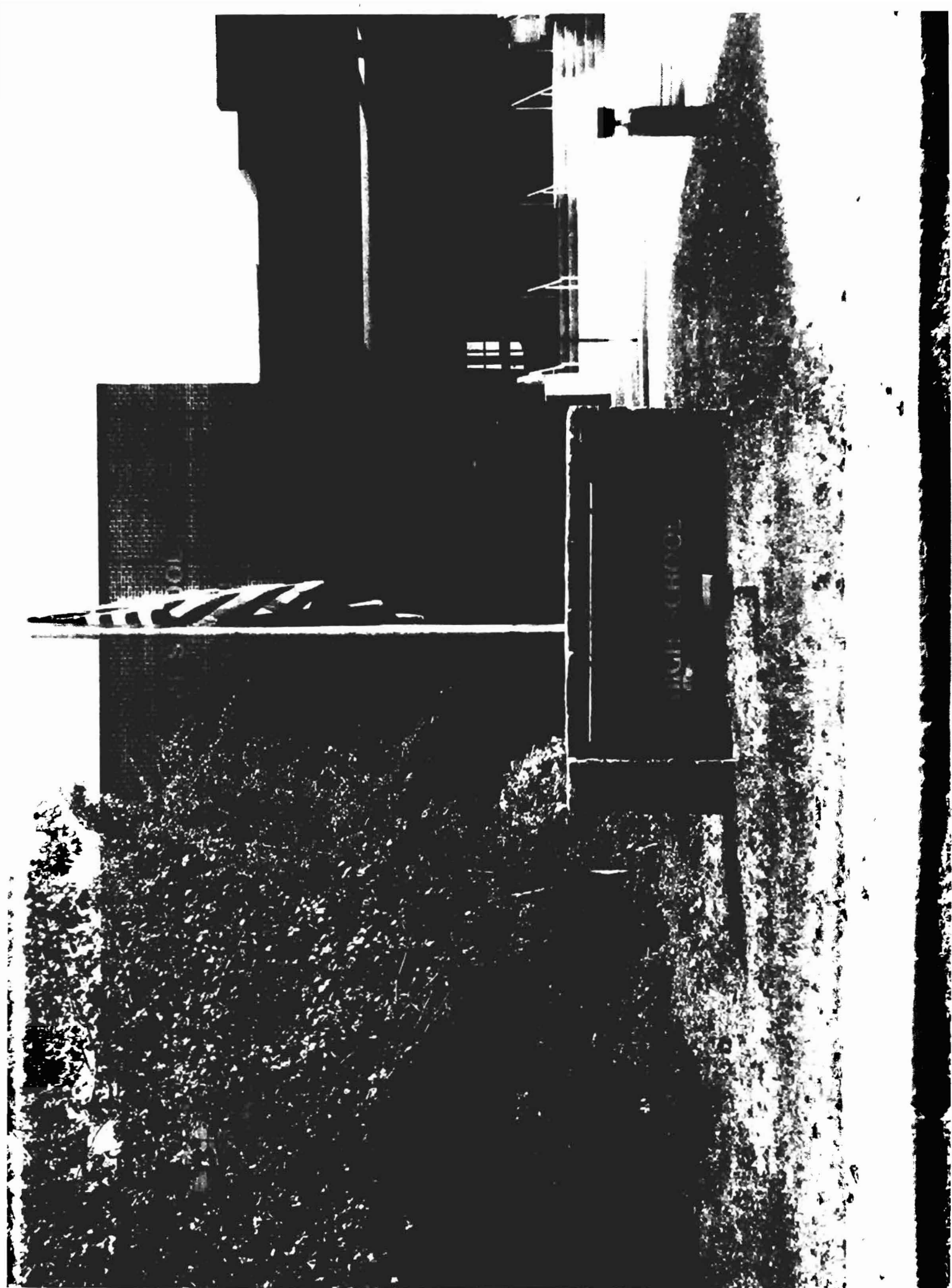



CHEVERUS HIGH SCHOOL

REV. JOHN J. KEEGAN S.J.
GYMNASIUM

CHEVERUS
HIGH SCHOOL

250' SETBACK FROM
HIGH WATER LINE

