

2"x4' Wall Construction w/ Sheetrock Interior and Batt Insulation

CEILING FINISH: Accoustical suspended (right half of finished space)
T&G wood (left half of finished space)

FLOORING: Carpeted in finished space
Dimensions of space approximate, +/- 3 inches

ELECTRICAL KEY:

- S** Switch
- S₃** 3 way Switch
- Light
- ⊕ Duplex

Symbol approximate location in finished space.

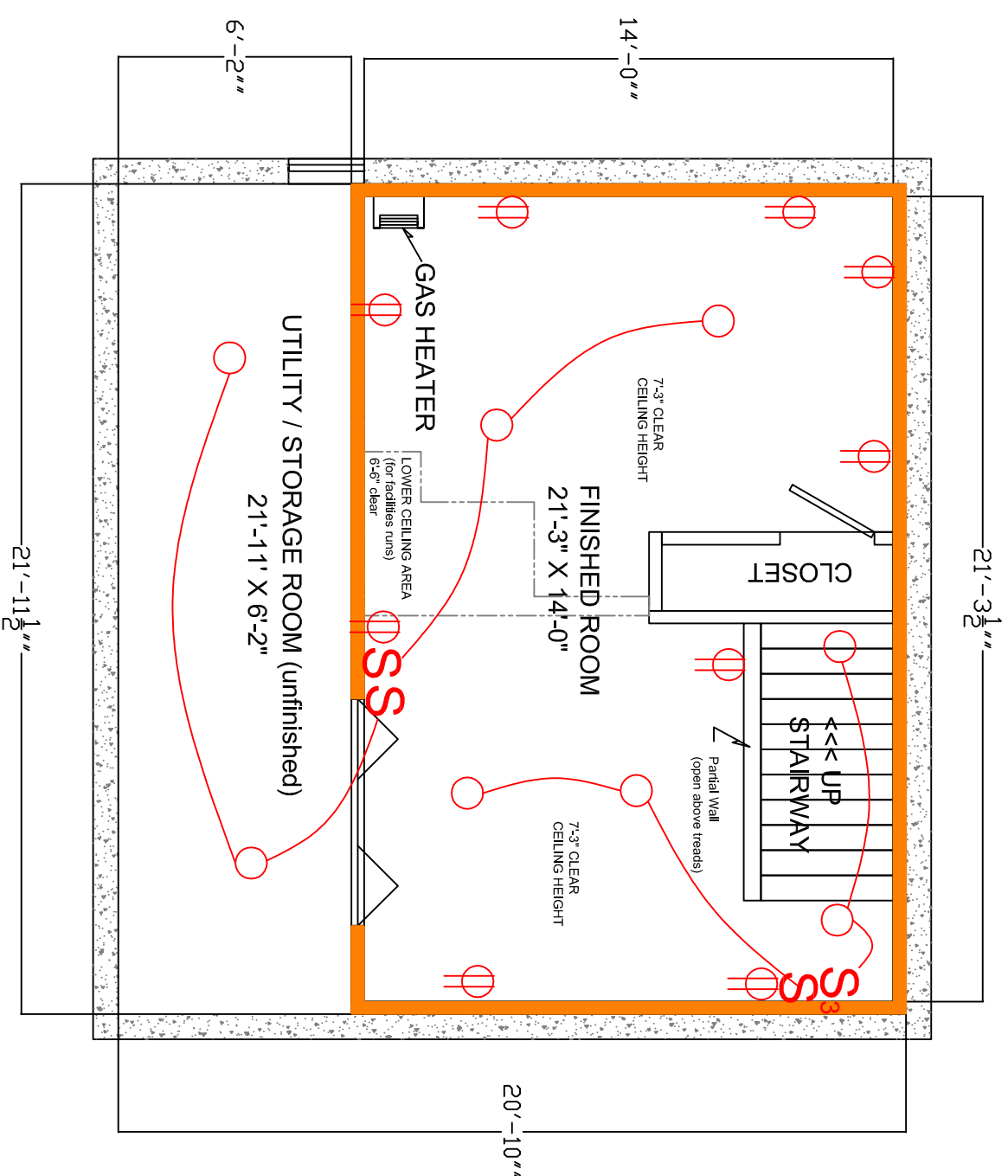

16 Bayview Terrace

EXISTING BASEMENT ROOM

| | | |
|----------------------------|--------------------------|-------|
| 1/4" = 1'-0" (on "B" size) | Rev DATE: 1 JUNE 2015 | S01-A |
|----------------------------|--------------------------|-------|