

2"x4' Wall Construction w/ Sheetrock Interior and Batt Insulation

CEILING FINISH:

Acoustical suspended (right half of finished space)
T&G wood (left half of finished space)

FLOORING: Carpeted in finished space

Dimensions of space approximate, +/- 3 inches

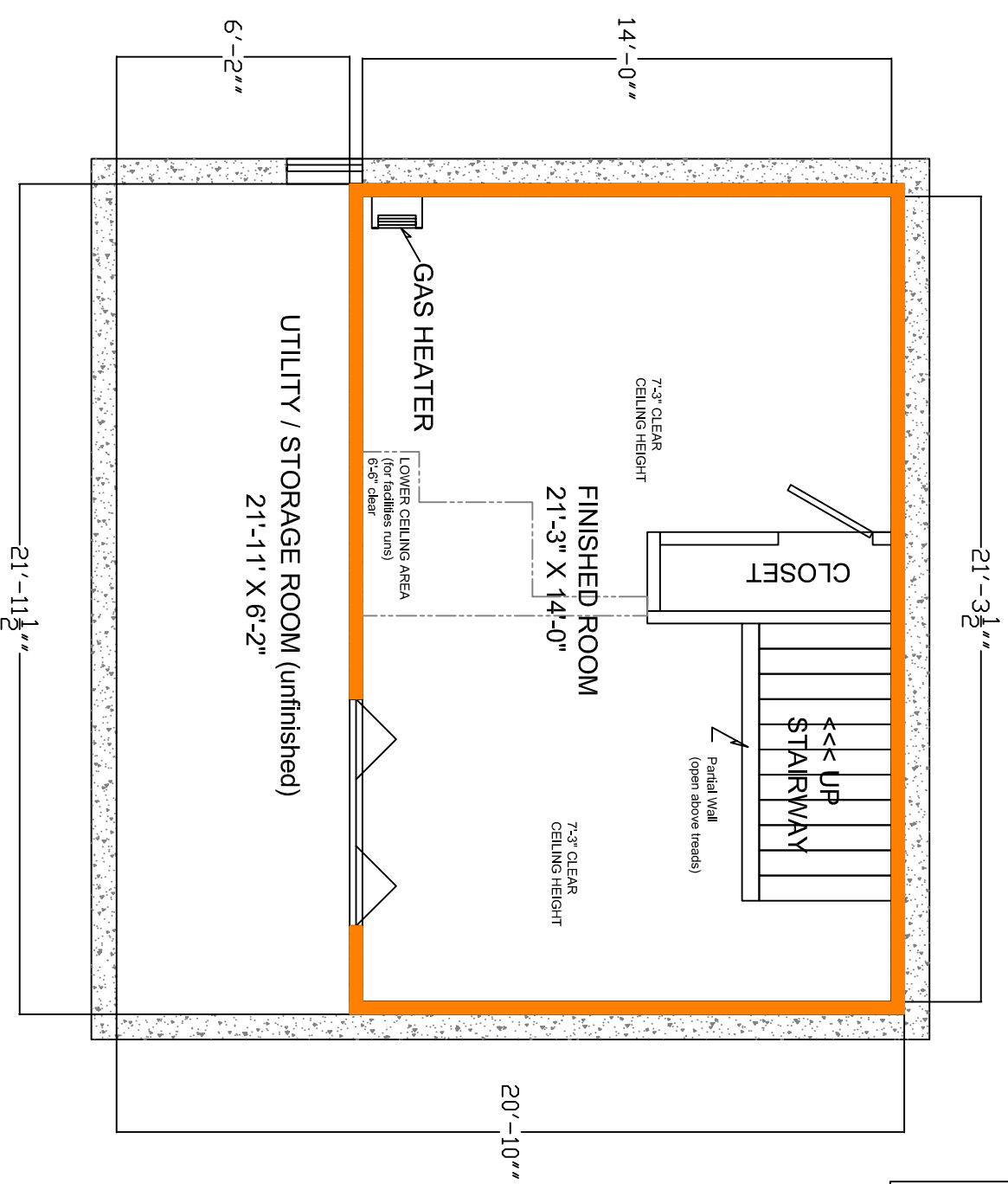

16 Bayview Terrace

EXISTING BASEMENT ROOM

1/4" = 1'-0" (on "B" size) Rev DATE: 9 JUNE 2015 A02-A