

**NOTES:**

1. (200) REFERS TO PLAN OF UNIVERSITY PARK RECORDED PLAN BOOK 024 PAGE 026
2. ● DENOTES 5/8" IRON ROD WITH CAP #1172 SET IN THE GROUND

**LOCUS DEED REFERENCE:**

Z. JOHN LITWINOWICH TO STAR HOMES INC DATED JULY 25, 2005

250 Harvard St 153A-A-18  
 256 Harvard St 153A-A-14

*David J. Dufon*  
 8/2/06

PLAN SHOWING A STANDARD BOUNDARY SURVEY MADE FOR	
<b>JOSEPH FRAUSTACI</b>	
PORTLAND MAINE	
SCALE: 1" = 40'	APPROVED BY:
DATE: 08-22-06	
BY: DANIEL S. DUFON & CO. LLC LAND SURVEYOR 87A OCEAN STREET SUITE 202 SOUTH PORTLAND MAINE 04106	
DRAWN BY	REVISID
207-799-0598	
DRAWING NUMBER	
<b>1098</b>	

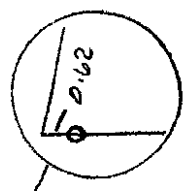
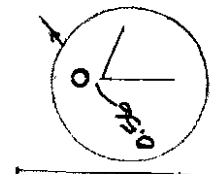

N/E  
 AMMER DOWN PLACE  
 CONDOMINIUM  
 PLAN BOOK 129 PAGE 57

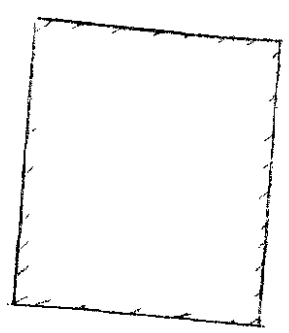

LEDGE ROAD

HARVARD STREET

FOUND 1 1/2" IRON PIPE FLUSH

498.0' TO WASHINGTON AVE. SOUTHWESTERLY SIDE LINE

N/E  
 ROBERT W. KATHERINE H KROLL  
 BK. 1531 PG. 119

N/E  
 HARVARD COMMON CONDOMINIUM  
 U.O. FILE NO. 112

LINE ESTABLISHED BY EXCHANGE OF OUT CLAIM DEEDS BETWEEN GRADY AND LITWINOWICH BOOK 4562 PAGE 5497

11765 SQ. FT.

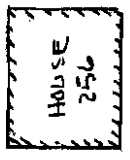

HOUSE 256

29,926 SQ. FT.

HOUSE LOT

N 62°-41'-00" E  
 122.28'  
 (122.24' ± DEED)

FOUND 1 1/2" GALV. IRON PIPE 12" HIGH

N/E  
 AMMER DOWN PLACE  
 BK. 1542 PG. 486

FOUND 1 1/2" IRON PIPE 12" HIGH

FOUND 3/4" IRON ROD 12" HIGH

S 21°-00'-E-32.27'

N 56°-49'-57" E  
 94.80'

FOUND 1 1/2" GALV. IRON PIPE 2" HIGH

120.00'

551.00' ± W  
 120.07'

FOUND 1 1/2" IRON PIPE FLUSH

FOUND 3/4" IRON PIPES FLUSH

N/E  
 JOHN D. + DOROTHY A GRADY  
 BK. 3413 PG. 292

FOUND 3/4" IRON ROD 2" HIGH

N 51°-02'-10" E  
 94.60'

FOUND 1 1/2" GALV. IRON PIPE 4" HIGH

(200)

FOUND 3/4" IRON PIPES FLUSH

FOUND 3/4" IRON PIPES FLUSH

67.0' PLANT MARK.

N 38°-20'-30" W  
 251.14'

FOUND 3/4" IRON ROD 12" HIGH

FOUND 1 1/2" GALV. IRON PIPE 12" HIGH

FOUND 1 1/2" GALV. IRON PIPE 12" HIGH

FOUND 1 1/2" GALV. IRON PIPE 12" HIGH

FOUND 1 1/2" GALV. IRON PIPE 12" HIGH

FOUND 1 1/2" GALV. IRON PIPE 12" HIGH

FOUND 1 1/2" GALV. IRON PIPE 12" HIGH

FOUND 1 1/2" GALV. IRON PIPE 12" HIGH

FOUND 1 1/2" GALV. IRON PIPE 12" HIGH

FOUND 1 1/2" GALV. IRON PIPE 12" HIGH

FOUND 1 1/2" GALV. IRON PIPE 12" HIGH

FOUND 1 1/2" GALV. IRON PIPE 12" HIGH

FOUND 1 1/2" GALV. IRON PIPE 12" HIGH

FOUND 1 1/2" GALV. IRON PIPE 12" HIGH

FOUND 1 1/2" GALV. IRON PIPE 12" HIGH

FOUND 1 1/2" GALV. IRON PIPE 12" HIGH

FOUND 1 1/2" GALV. IRON PIPE 12" HIGH

FOUND 1 1/2" GALV. IRON PIPE 12" HIGH