

- 8 GENERAL WIRING AND POWER NOTES**
- LABEL ALL CIRCUITS ON J-BOXES AND ALL OUTLETS WITH MULTIPLE CIRCUITS.
 - ALL WIRING ON FLOOR UNDER COUNTERS SHALL BE IN 3/8" FLEXIBLE CONDUIT.
 - RUN ALL CONDUIT AND CABLES UNDER AND NOT THROUGH SHELF SUPPORTS.
 - DO NOT PERMANENTLY ATTACH OUTLET BOXES OR FLEX CONDUIT TO FLOOR.
 - MOUNT OUTLETS IN KICKPLATES AFTER OWNER'S FIXTURES HAVE BEEN INSTALLED.
 - INSTALL JUNCTION BOX AT LOCATIONS SHOWN FOR POWER. INSTALL AUTOZONE FURNISHED FLEXIBLE QUICK CONNECTORS TO EACH BOX INDICATED POWER POLE SCHEDULE.
 - AUTOZONE'S CONTRACTOR CROSSCOM WILL INSTALL CAT. 5 CABLE FOR DATA AND PHONE LINES. IN ADDITION TO TAGGING THE ENDS OF ALL CABLES, CROSSCOM WILL CRIMP THE ENDS OF ALL CABLES WITH A 8 PIN RJ-45 CONNECTOR.
 - ALL CIRCUITS OVER 100 FEET IN LENGTH SHALL BE RUN WITH #10 AWG.
 - PROVIDE 2 PULL WIRES IN ALL EMPTY CONDUITS.
 - LOCATE ALL POWER POLES AFTER FIXTURES ARE IN PLACE.
- 1/8" = 1'-0" EUPN01

- 9 POWER POLE LEGEND**
- CONNECT THE APPROPRIATE OWNER FURNISHED PREWIRED FEMALE FLEXIBLE QUICK CONNECTOR TO THE CIRCUIT(S) IN THE JUNCTION BOX SERVING EACH OF THE PODS. FOR DETAILED WIRING INSTRUCTION, SEE ADDITIONAL INFORMATION IN WIRING DIAGRAMS ON THIS SHEET. COIL UP THE FLEXIBLE CONDUIT AND WIRE TIE TO THE CLOSEST BAR JOIST.
 - POSITION NON-POD POWER POLES AFTER FIXTURES ARE IN PLACE, ANCHOR ALL POLES PER MANUFACTURER'S INSTRUCTIONS. MAKE FINAL CONNECTIONS THROUGH FLEX CONDUIT TO JUNCTION BOXES AT ROOF DECK. POWER POLES FOR THE PODS WILL COME WITH A MALE QUICK CONNECTOR AND WILL BE PLUGGED IN BY OWNER.
 - AT THE BOTTOM OF THE OFFICE POWER POLE MAKE 1" FLEX CONNECTIONS TO JUNCTION BOXES AND FROM THE JUNCTION BOX MAKE CONNECTIONS USING 3/8" FLEX TO EACH OF THE DEVICES.
- 1/8" = 1'-0" EPPN01

- 10 POWER POLE NOTES**
- 1/8" = 1'-0" EPPN01

1/8" = 1'-0"
1 POWER POLE & JUNCTION BOX LOCATIONS

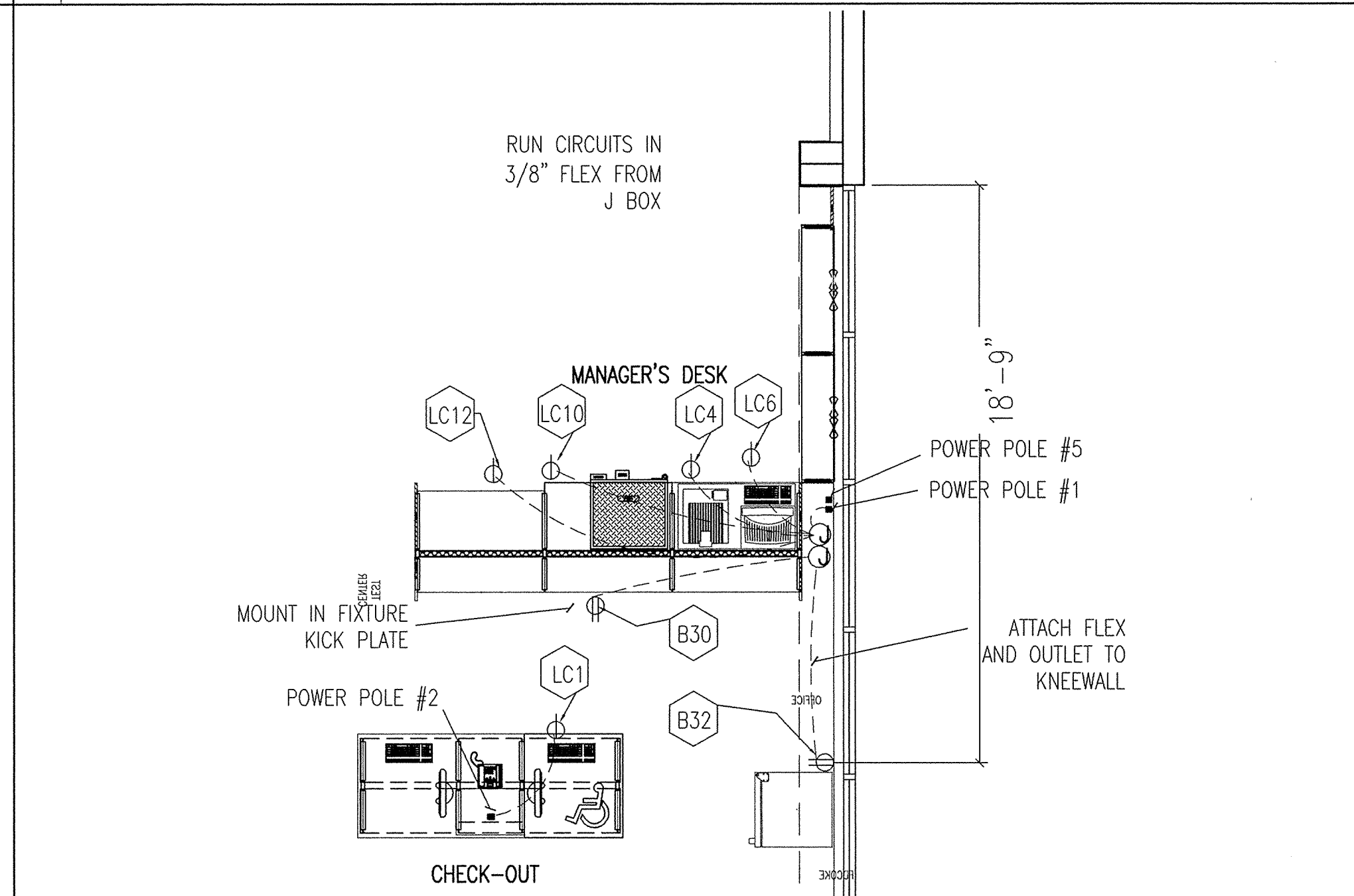
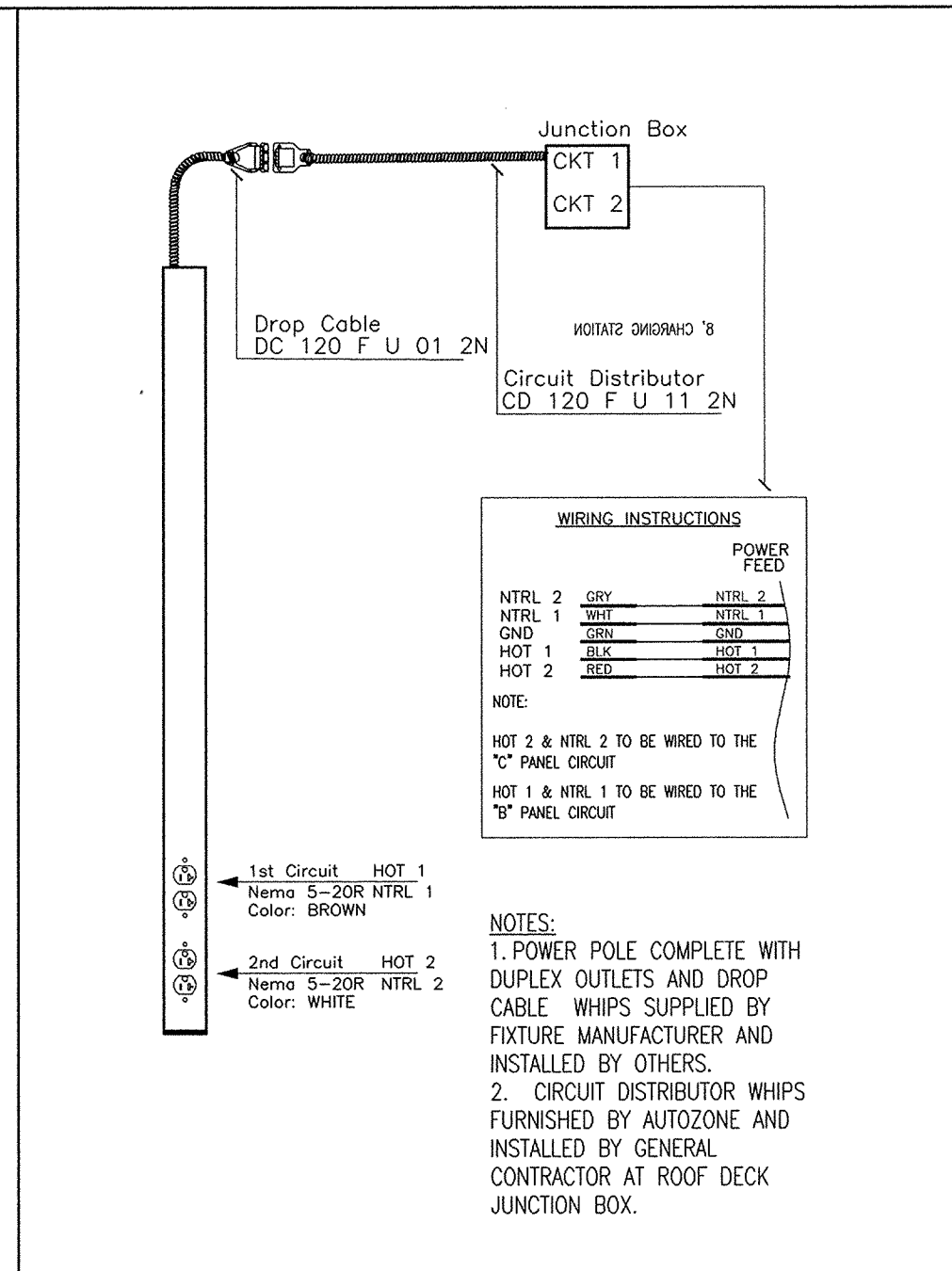
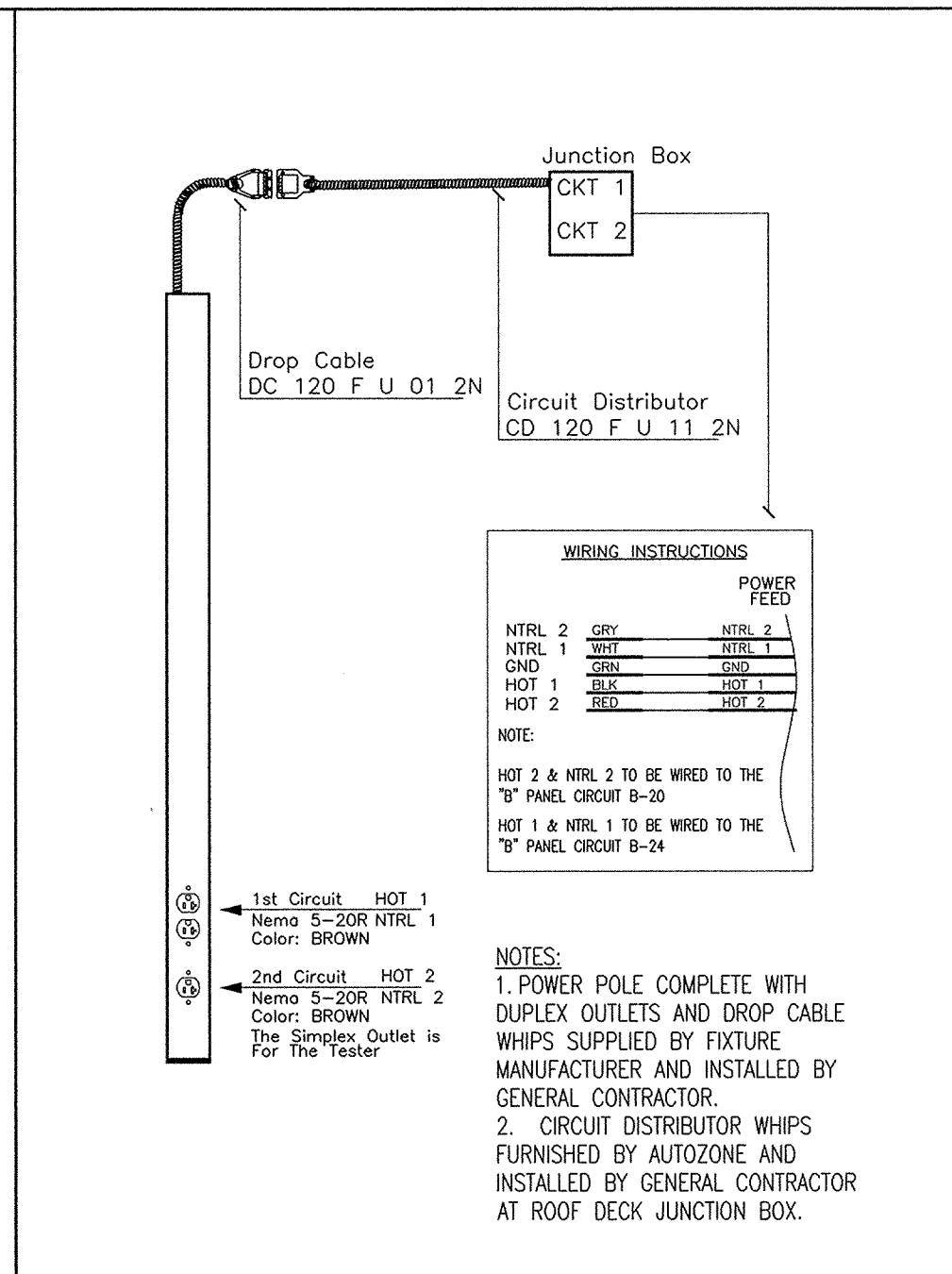
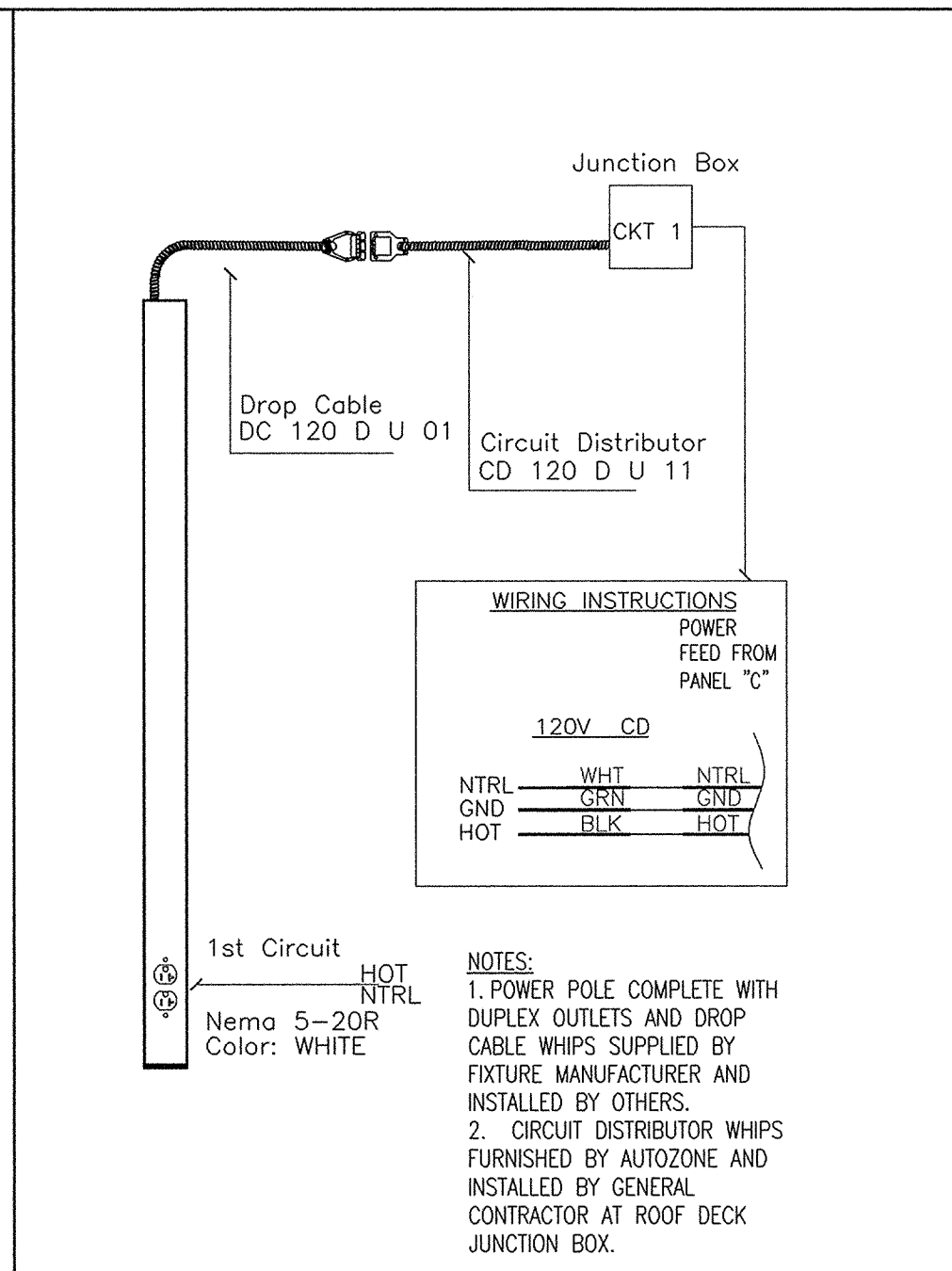
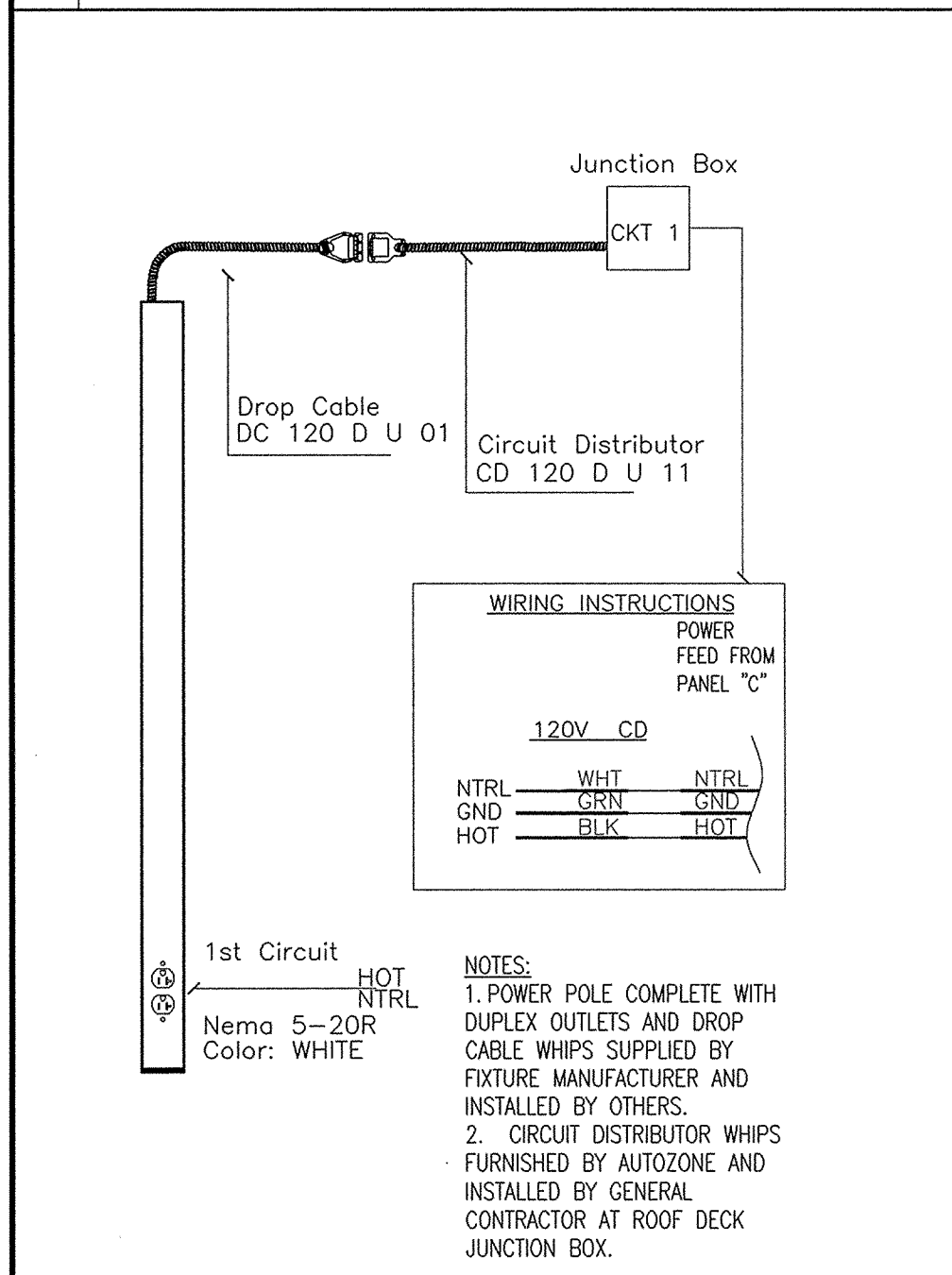

| REVISIONS | |
|-----------|--|
| 1 | |
| 2 | |
| 3 | |
| 4 | |
| 5 | |
| 6 | |

AutoZone Store No. 3879
1207 FOREST AVE
PORTLAND ME 04103

ENGINEER: DANNY E. DOSS P.E.
132 Kelley Drive
Rogers, Arkansas 72756
TEL: (479) 631-1712 FAX: (479) 631-1854
For Bidding & Contractor Information Contact:
McGrav - Hill Construction Tel. 615-884-1017
www.construction.com

STATE OF ARKANSAS
DANNY E. DOSS
NO. 9421
LICENSED PROFESSIONAL ENGINEER

04/04/16
7N2-R
E-2