

THIS IS NOT A BOUNDARY SURVEY

MORTGAGE INSPECTION OF: DEED BOOK 6705 PAGE 62 COUNTY Cumberland
 PLAN BOOK --- PAGE --- LOT ---

ADDRESS: 1152 Forest Avenue, Portland, Maine

Job Number: 493-17
 Inspection Date: 11-11-04
 Scale: 1" = 20'
 Client File#: 41312

Buyers: Dimitri & Anilda Gribizis
 Sellers: Richard & Jeanette Sylvester

1 3/4 story wood structure w/ concrete foundation

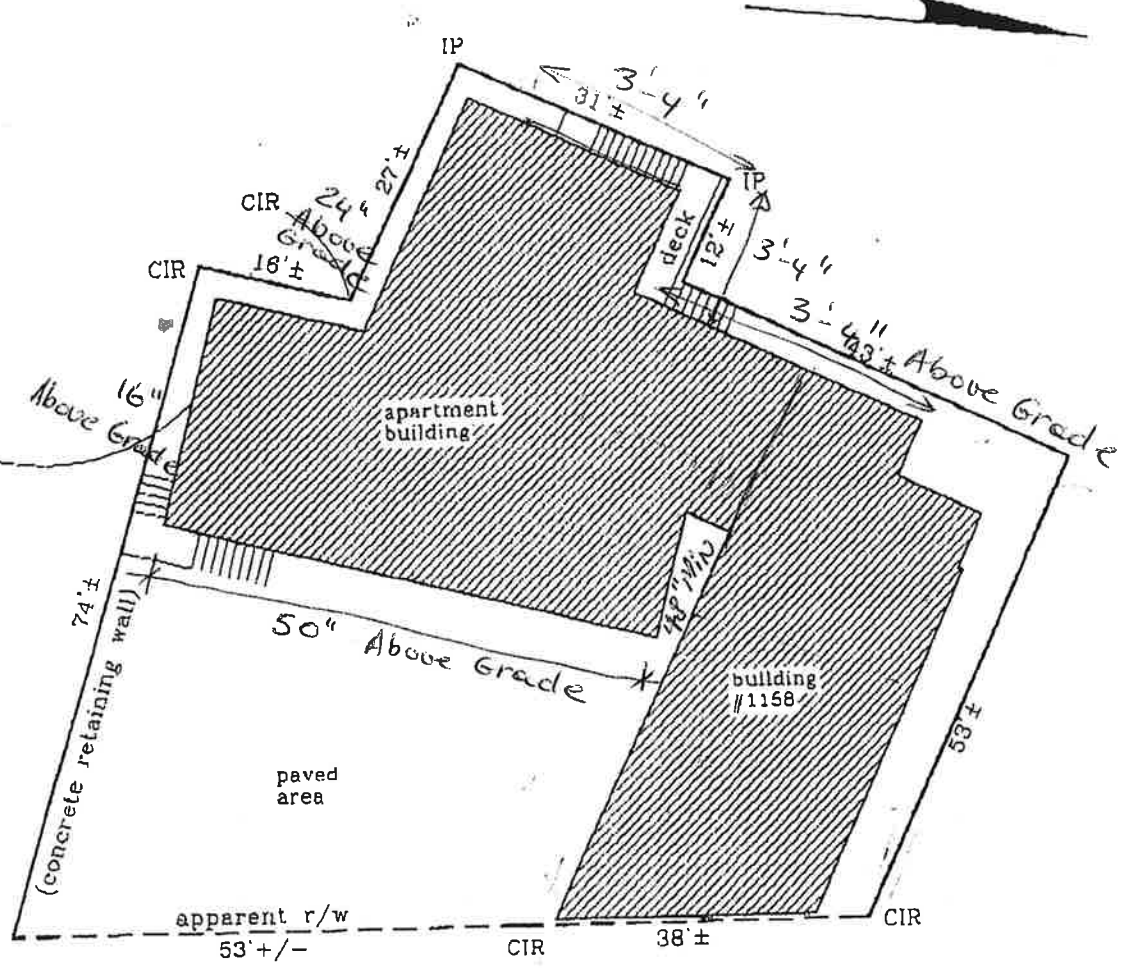

[Handwritten signature] Forest Avenue

to Stevens Ave.

APPARENT EASEMENTS AND RIGHTS OF WAY ARE SHOWN. OTHER ENCUMBRANCES, RECORDED OR NOT, MAY EXIST. THIS SKETCH WILL NOT REVEAL ABUTTING DEED CONFLICTS, IF ANY.

I HEREBY CERTIFY TO: Bay Area Title Services, Inc.; Pepporell Bank & Trust, and its title insurer.
 Monuments found did not conflict with the deed description.
 The dwelling setbacks do not violate town zoning requirements.
 As delineated on the Federal Emergency Management Agency Community Panel: 230051-0007 C
 The structure does not fall within the special flood hazard zone.
 The land does not fall within the special flood hazard zone.
 A wetlands study has not been performed.

Livingston - Hughes
 Professional Land Surveyors
 88 Guinea Road
 Kennebunkport - Maine 04046
 207-967-9761 phone 207-967-4831 fax