

912937

152-A002

Permit # _____ City of Portland BUILDING PERMIT APPLICATION Fee \$25.00 Zone _____ Map # _____ Lot# _____

Please fill out any part which applies to job. Proper plans must accompany form.

Owner: Furniture Express Phone # 797-4048
 Address: 832 Stevens Ave. Portland 04103
 LOCATION OF CONSTRUCTION 832 Stevens Ave.
 Contractor: self Sub: _____
 Address: _____ Phone # _____
 Est. Construction Cost: \$400.00 Proposed Use: Retail Furniture
 Past Use: vacant
 # of Existing Res. Units _____ # of New Res. Units _____
 Building Dimensions L _____ W _____ Total Sq. Ft. _____
 # Stories: _____ # Bedrooms _____ Lot Size: _____
 Is Proposed Use: Seasonal _____ Condominium _____ Conversion _____
 Explain Conversion from vacant to retail furniture as per plan

For Official Use Only

Date August 5, 1991 Subdivision: _____
 Inside Fire Limits _____ Name _____
 Bldg Code _____ Lot AUG 16 1991
 Time Limit _____ Ownership: _____
 Estimated Cost \$400.00 Public _____ Private _____

Zoning: Br 2
 Street Frontage Provided: _____
 Provided Setbacks: Front _____ Back _____ Side _____ Side _____

Review Required:
 Zoning Board Approval: Yes _____ No _____ Date: _____
 Planning Board Approval: Yes _____ No _____ Date: _____
 Conditional Use: _____ Variance _____ Site Plan _____ Subdivision _____
 Shoreland Zoning Yes _____ No _____ Floodplain Yes _____ No _____
 Special Exception _____
 Other WOF (Explain) 8-15-91

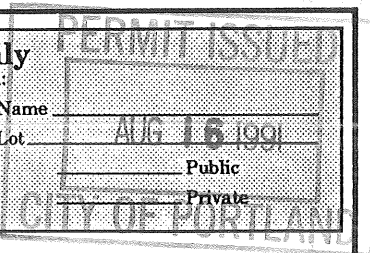

Foundation:
 1. Type of Soil: _____
 2. Set Backs - Front _____ Rear _____ Side(s) _____
 3. Footings Size: _____
 4. Foundation Size: _____
 5. Other _____

Floor:
 1. Sills Size: _____ Sills must be anchored.
 2. Girder Size: _____
 3. Lally Column Spacing: _____ Size: _____
 4. Joists Size: _____ Spacing 16" O.C.
 5. Bridging Type: _____ Size: _____
 6. Floor Sheathing Type: _____ Size: _____
 7. Other Material: _____

Exterior Walls:
 1. Studding Size _____ Spacing _____
 2. No. windows _____
 3. No. Doors _____
 4. Header Sizes _____ Span(s) _____
 5. Bracing: Yes _____ No _____
 6. Corner Posts Size _____
 7. Insulation Type _____ Size _____
 8. Sheathing Type _____ Size _____
 9. Siding Type _____ Weather Exposure _____
 10. Masonry Materials _____
 11. Metal Materials _____

Interior Walls:
 1. Studding Size _____ Spacing _____
 2. Header Sizes _____ Span(s) _____
 3. Wall Covering Type _____
 4. Fire Wall if required _____
 5. Other Materials _____

Ceiling:
 1. Ceiling Joists Size: _____
 2. Ceiling Strapping Size _____ Spacing _____
 3. Type Ceilings: _____
 4. Insulation Type _____ Size _____
 5. Ceiling Height: _____

Roof:
 1. Truss or Rafter Size _____ Span _____
 2. Sheathing Type _____ Size _____
 3. Roof Covering Type _____

Chimneys:
 Type: _____ Number of Fire Places _____

Heating:
 Type of Heat: _____

Electrical:
 Service Entrance Size: _____ Smoke Detector Required Yes _____ No _____

Plumbing:
 1. Approval of soil test if required Yes _____ No _____
 2. No. of Tubs or Showers _____
 3. No. of Flushes _____
 4. No. of Lavatories _____
 5. No. of Other Fixtures _____

Swimming Pools:
 1. Type: _____
 2. Pool Size: _____ x _____ Square Footage _____
 3. Must conform to National Electrical Code and State Law.

HISTORIC PRESERVATION

1. Ceiling Joists Size: _____ ~~Not in District nor Landmark.~~
 2. Ceiling Strapping Size _____ Spacing _____ ~~Does not require review.~~
 3. Type Ceilings: _____ ~~Requires Review.~~
 4. Insulation Type _____ Size _____
 5. Ceiling Height: _____

Roof:
 1. Truss or Rafter Size _____ Span _____ Action: Approved.
 2. Sheathing Type _____ Size _____ Approved with Conditions.
 3. Roof Covering Type _____ Denied.

Chimneys:
 Type: _____ Number of Fire Places _____
 Date: _____
 Signature: _____

Received By: Lattini
PERMIT ISSUED WITH LETTER
 Signature of Applicant: Kevin Griffith Date 8/5/91
 Signature of CEO: [Signature] Date 8-14-91
 Inspection Dates _____

PLOT PLAN



Done w/out Insp.

FEES (Breakdown From Front)

Base Fee \$ 25.00 _____
 Subdivision Fee \$ _____
 Site Plan Review Fee \$ _____
 Other Fees \$ _____
 (Explain) _____
 Late Fee \$ _____

Inspection Record

Type

Date

Type	Date
_____	____/____/____
_____	____/____/____
_____	____/____/____
_____	____/____/____
_____	____/____/____
_____	____/____/____

COMMENTS

change of use as per plan 2 sheets



Signature of Applicant

Kevin D. [Signature]

Date

August 5, 1991

CITY OF PORTLAND, MAINE

389 CONGRESS STREET
PORTLAND, MAINE 04101
(207) 874-8300



DEPARTMENT OF PLANNING & URBAN DEVELOPMENT

P. SAMUEL HOFFSES, CHIEF
INSPECTION SERVICES DIVISION

August 16, 1991

RE: 832 Stevens Avenue

Furniture Express
832 Stevens Avenue
Portland, Maine 04103

Dear Sir:

Your application to change from vacant to retail furniture has been reviewed and a permit is herewith issued subject to the following requirements:

No certificate of occupancy can be issued until all requirements of this letter are met.

1. Sprinkler protection shall be provided to all areas including offices, closets, etc. built below the existing sprinkler system Ref. N.F.P.A. #13 requirements.
2. Exits shall be marked in accordance with section 5-10 of the N.F.P.A. 101 Life Safety Code.
3. Hazardous areas shall be protected in accordance with section 25-3.2.1.
4. Interior finish on walls and ceilings shall be in accordance with section 25-3.3.
5. Portable fire extinguishers shall be provided in accordance with N.F.P.A. #10.

If you have any questions regarding these requirements, please do not hesitate to contact this office.

Sincerely,

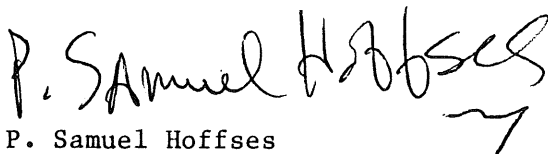
P. Samuel Hoffses
Chief of Inspection Services

/el

cc: LT. Wallace Garroway, Fire Prevention Bureau

FURNITURE
Express

New Location on
Stevens Ave,
No. 832

100' FRONT

100'

Red line is
Sprinkler System

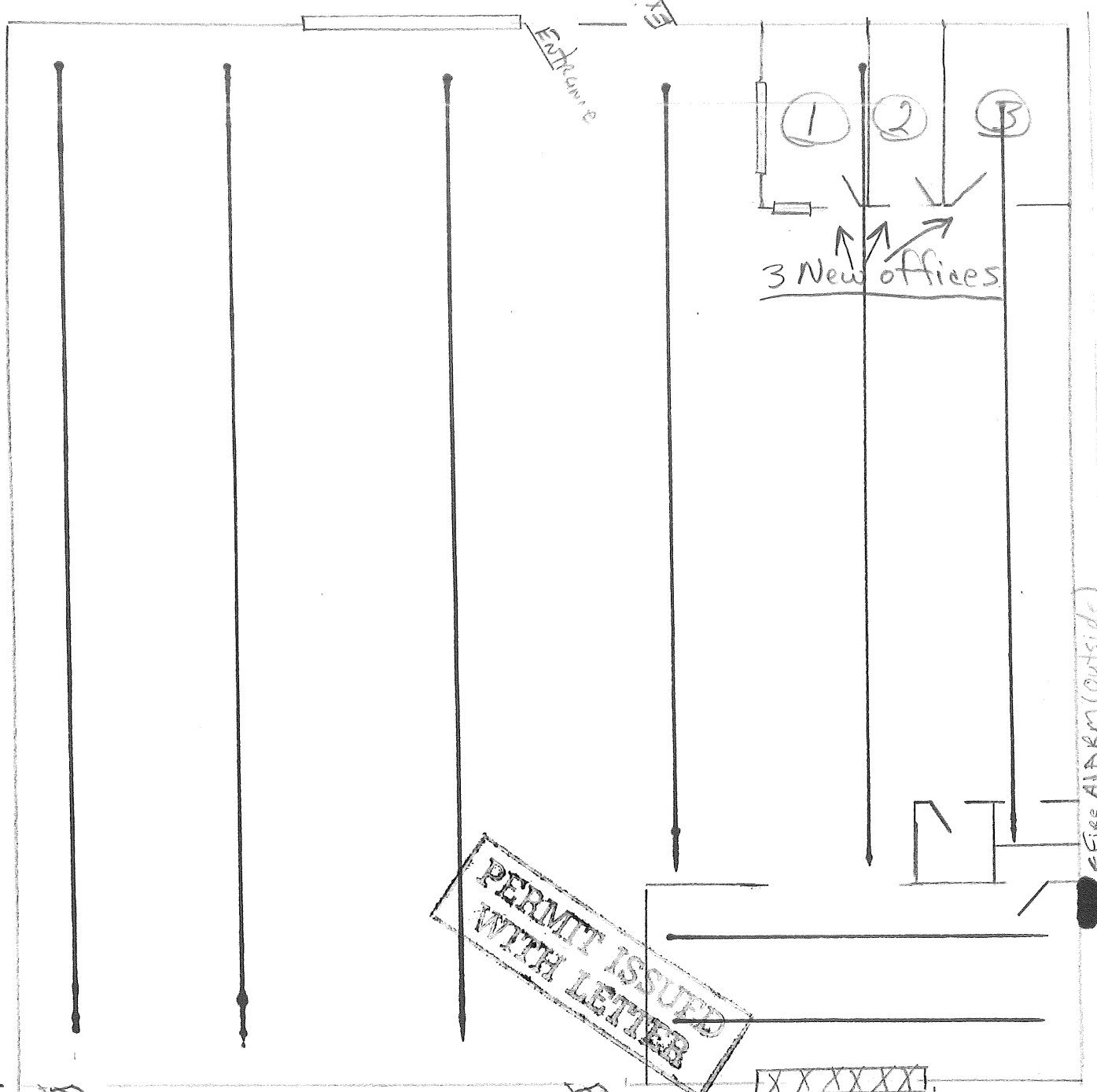

EXIT

EXIT

Rear

Overhead Door

FIRE ALARM (outside)

← Drive way to Rear of Building →