

DOOR SCHEDULE

WINDOW SCHEDULE

Typ	STYLE	QTY	Typ	STYLE	QTY
1	FEATHER BRICE DOOR 36x80"	1	A	M1 SERIES 1556 45-1/2" x 64-1/4"	2
2	INTERIOR PINE HOURS 32x80	6	B	M1 SERIES 1556 35" x 65"	4
3	INTERIOR PINE HOURS 30x80	1	C	M1 SERIES 1556 38x49"	1
4	INTERIOR PINE HOURS 36x80	1	D	M1 SERIES 1556 35x41"	1
5	TELD-MER STEEL DOOR 36x80	1	E	M1 SERIES 1556 35 1/2" x 50-1/2"	2
6	SLIDER SPARS 910 71-3/4" x 74-1/2"	1	F	M1 SERIES 9770 CASEMENT EGRESS 32" x 48"	3



Customer Name:

Project Name: ANDREW GERVAIS

Address:

Quote Name: UNIVERSITY STREET

Phone:

Quote Number: 1278505

Fax:

Order Date: Quote Not Ordered

Customer Information:

Comments:

PO Number:

ITEM & SIZES LOCATION / TAG PRODUCT DESCRIPTION UNIT PRICE / EXTENDED PRICE

Line Item: 100-1 **None Assigned** ***** PRODUCT *****
 Row 1 1556 Double Hung - Vent - 1 Units - 45.5W x 64.25H
Quantity: 2 ***** DIMENSIONS *****
RO Size: 46" X 64.75" 45.5W x 64.25H
Unit Size: 45.5" X 64.25" ***** FRAME *****
 Vinyl, Frame Type - Fin, Northern Energy Star Upgrade, Exterior Color - White
***** GLASS *****
 Glazing Type - Insulated, Glass Tint - Clear, Low-E, Argon Gas, Glass Strength - DSB
***** GRILLES *****
 Grille Type - GBG, Grille Thickness/Style - 5/8" Flat, Grille Pattern - Colonial
 Top Glass: Grille Division Type - Custom, Number Wide - 3, Number High - 2
***** SCREEN *****
 Screen - Rollform Full, Screen Mesh Type - Charcoal Fiber, Screens Packed Separately - Yes
***** WRAPPING *****
 Extension Jambes - None, J-Channel - Integral
***** NFRC *****
 Series 1556::DoubleHung, U-Factor::0.27, SHGC::0.26, VT::0.46

FRONT

A

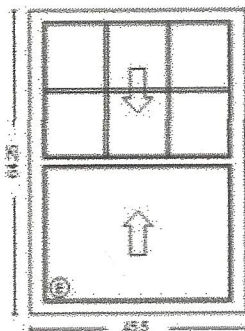

Unit Price: \$236.08

1556 Double Hung - Vent - CustomCustom

Extended Price: \$472.16

ITEM & SIZES LOCATION / TAG PRODUCT DESCRIPTION UNIT PRICE / EXTENDED PRICE

Line Item: 200-1 **None Assigned** ***** PRODUCT *****
 Row 1 1556 Double Hung - Vent - 1 Units - 39W x 65H
Quantity: 4 ***** DIMENSIONS *****
RO Size: 39.5" X 65.5" 39W x 65H
Unit Size: 39" X 65" ***** FRAME *****
 Vinyl, Frame Type - Fin, Northern Energy Star Upgrade, Exterior Color - White
***** GLASS *****
 Glazing Type - Insulated, Glass Tint - Clear, Low-E, Argon Gas, Glass Strength - DSB
***** GRILLES *****
 Grille Type - GBG, Grille Thickness/Style - 5/8" Flat, Grille Pattern - Colonial
 Top Glass: Grille Division Type - Custom, Number Wide - 3, Number High - 2
***** SCREEN *****
 Screen - Rollform Full, Screen Mesh Type - Charcoal Fiber, Screens Packed Separately - Yes
***** WRAPPING *****
 Extension Jambes - None, J-Channel - Integral
***** NFRC *****
 Series 1556::DoubleHung, U-Factor::0.27, SHGC::0.26, VT::0.46

1ST FLOOR SINKS

B

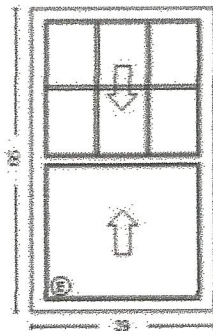

Unit Price: \$222.33

1556 Double Hung - Vent - CustomCustom

Extended Price: \$889.32

ITEM & SIZES	LOCATION / TAG	PRODUCT DESCRIPTION	UNIT PRICE / EXTENDED PRICE
--------------	----------------	---------------------	-----------------------------

Line Item: 300-1 None Assigned
 Quantity: 1
 RO Size: 33.5" X 49.5"
 Unit Size: 33" X 49"

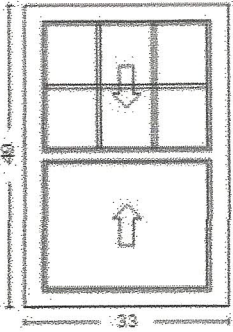

*** PRODUCT ***
 Row 1 1556 Double Hung - Vent - 1 Units - 33W x 49H
 *** DIMENSIONS ***
 33W x 49H
 *** FRAME ***
 Vinyl, Frame Type - Fin, Northern Energy Star Upgrade, Exterior Color - White
 *** GLASS ***
 Glazing Type - Insulated, Glass Tint - Clear, Low-E, Argon Gas, Glass Strength - DSB
 *** GRILLES ***
 Grille Type - GBG, Grille Thickness/Style - 5/8" Flat, Grille Pattern - Colonial
 Top Glass: Grille Division Type - Custom, Number Wide - 3, Number High - 2
 *** SCREEN ***
 Screen - Rollform Full, Screen Mesh Type - Charcoal Fiber, Screens Packed Separately - Yes
 *** WRAPPING ***
 Extension Jambes - None, J-Channel - Integral
 *** NFRC ***
 Series 1556::DoubleHung, U-Factor::0.27, SHGC::0.26, VT::0.46

BATH

Unit Price: \$189.56

1556 Double Hung - Vent - CustomCustom

Extended Price: \$189.56

ITEM & SIZES	LOCATION / TAG	PRODUCT DESCRIPTION	UNIT PRICE / EXTENDED PRICE
--------------	----------------	---------------------	-----------------------------

Line Item: 400-1 None Assigned
 Quantity: 1
 RO Size: 39.5" X 41.5"
 Unit Size: 39" X 41"

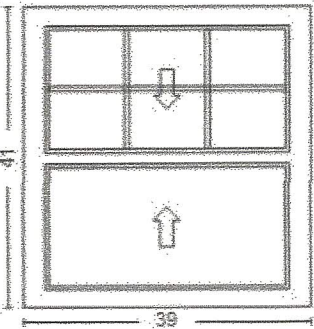

*** PRODUCT ***
 Row 1 1556 Double Hung - Vent - 1 Units - 39W x 41H
 *** DIMENSIONS ***
 39W x 41H
 *** FRAME ***
 Vinyl, Frame Type - Fin, Northern Energy Star Upgrade, Exterior Color - White
 *** GLASS ***
 Glazing Type - Insulated, Glass Tint - Clear, Low-E, Argon Gas, Glass Strength - DSB
 *** GRILLES ***
 Grille Type - GBG, Grille Thickness/Style - 5/8" Flat, Grille Pattern - Colonial
 Top Glass: Grille Division Type - Custom, Number Wide - 3, Number High - 2
 *** SCREEN ***
 Screen - Rollform Full, Screen Mesh Type - Charcoal Fiber, Screens Packed Separately - Yes
 *** WRAPPING ***
 Extension Jambes - None, J-Channel - Integral
 *** NFRC ***
 Series 1556::DoubleHung, U-Factor::0.27, SHGC::0.26, VT::0.46

KITCHEN

Unit Price: \$189.76

1556 Double Hung - Vent - CustomCustom

Extended Price: \$189.76

Line Item: 800-1 **None Assigned**
Quantity: 1
RO Size: 72.125" X 80"
Unit Size: 71.625" X 79.5"

***** PRODUCT *****
 Row 1 910 Two Panel Patio Door - XO - 1 Units - 71.625W x 79.5H
***** DIMENSIONS *****
 71.625W x 79.5H
***** FRAME *****
 Vinyl, Frame Type - Fin, Fin Setback - 1", Exterior Color - White
***** GLASS *****
 Glazing Type - Insulated, Glass Tint - Clear, Low-E, Argon Gas,
 Tempered Location - Full, Glass Strength - DSB
***** SCREEN *****
 Screen - 121 Aluminum, Screens Packed Separately - No
***** HARDWARE *****
 Hardware Color - White
***** WRAPPING *****
 Frame Trim - None, J-Channel - Integral
***** NFRC *****
 Series 910::DoubleSlidingDoor, U-Factor::0.28, SHGC::0.32, VT::0.58

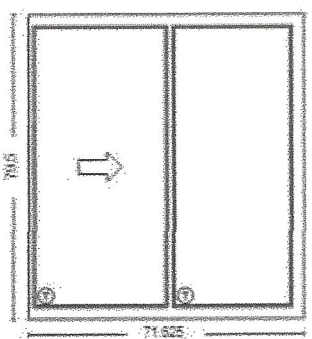

910 Two Panel Patio Door - XO - 6068

Unit Price: \$656.04
 Extended Price: \$656.04

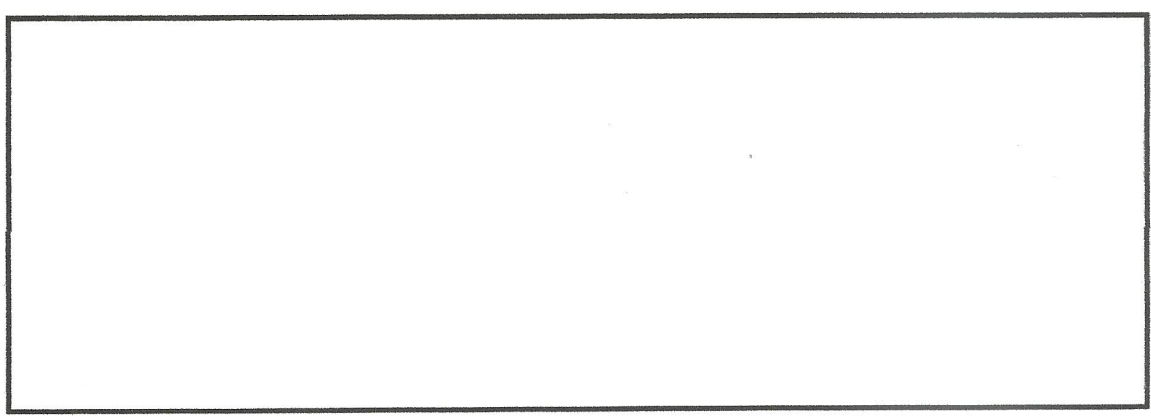

Sub Total: \$3,771.14
Freight: \$0.00
Labor: \$0.00
Sales Tax: \$0.00
Total Order Price: \$3,771.14

Submitted By: _____ Please Print Name
Signature: _____
Date: _____

Accepted By: _____ Please Print Name
Signature: _____
Date: _____

"Effective May 1 2013, U-Value and SHGC information has been added to the MIWD Paradigm Quoting Tool. This information is in beta-test format for the next 60 days and should not be used as a reliable source for specifying thermal performance of the windows. The thermal values printed on the MIWD Order Acknowledgement is what will be printed on the window's NFRC label. Your help in reporting any discrepancies in the thermal values shown on the MIWD Paradigm Quote vs. MIWD Order Acknowledgement is greatly appreciated."