

© 2013 RYAN SENATORE ARCHITECTURE

165 WOODLAWN AVENUE  
RENOVATIONS  
PORTLAND, MAINE



RYAN SENATORE  
**ARCHITECTURE**  
67 GRAY ROAD  
GORHAM, MAINE 04038  
207-650-6414  
senatorearchitecture.com

CONSULTANTS:  
**STRUCTURAL:**  
Structural Integrity  
77 Oak Street  
Portland, ME 04101  
207-774-4614

REVISIONS:

DATE:

PROJECT No.

DRAWN BY:

CHECKED BY:

SCALE: AS NOTED

SHEET TITLE:  
FIRST FLOOR  
FRAMING PLAN

S1.2

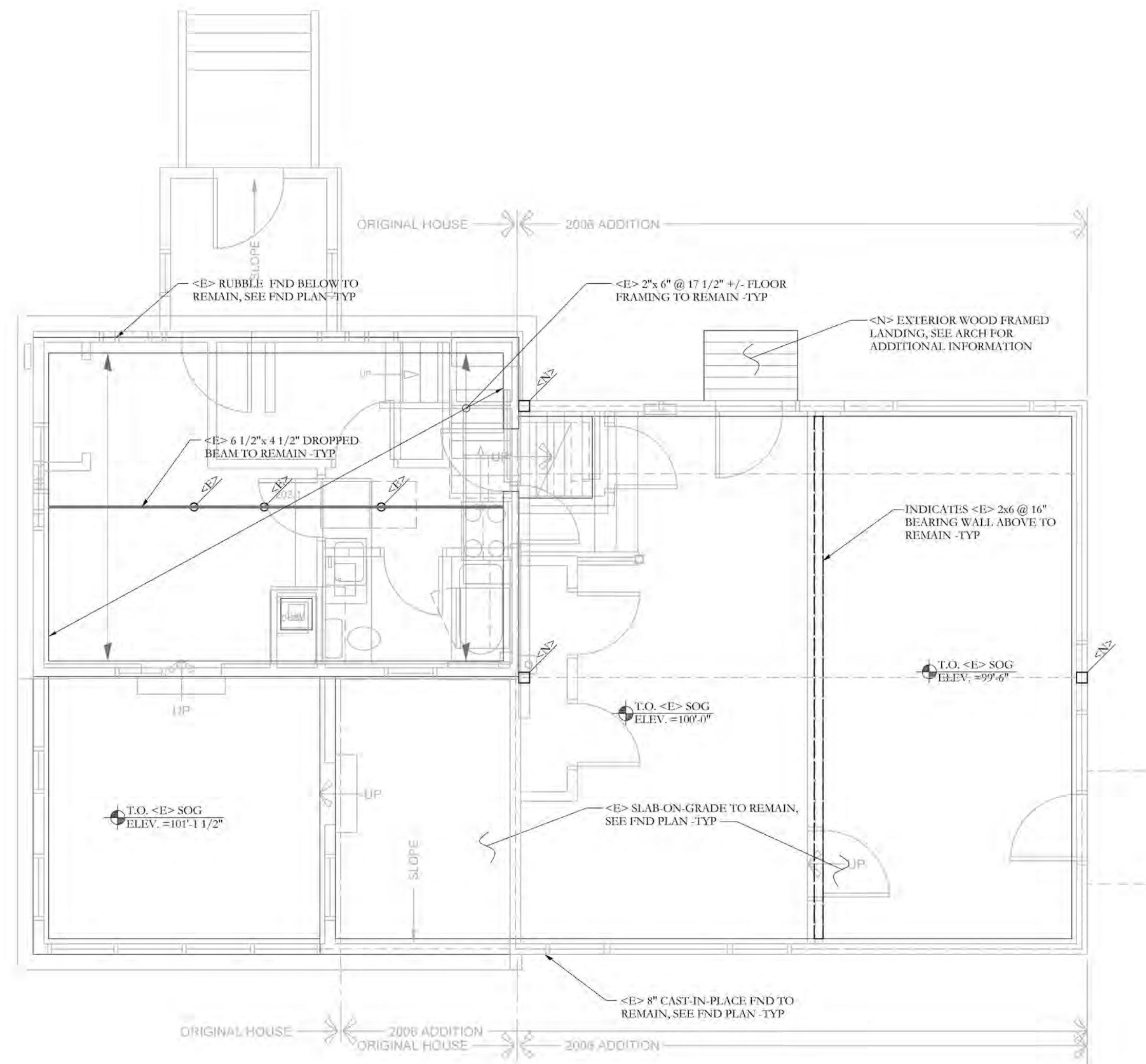

**FIRST FLOOR FRAMING PLAN**

- NOTES: SCALE 1/4"=1'-0"
1. VERIFY ALL EXISTING CONDITIONS IN FIELD, CONTACT SI Inc. IF CONDITIONS IN FIELD DO NOT MATCH PLAN
  2. IF MEMBER IS NOT INDICATED AS <E>, <N> OR <R> MEMBER IS TO BE CONSIDERED A NEW, <N>, MEMBER
  3. SEE ARCH. FOR DIMENSIONS AND ELEVATIONS OF NEW FLOOR PLANS
  4. SEE SHEET S1.0 FOR GENERAL STRUCTURAL NOTES

FRAMING PLAN SYMBOLS KEY	
□	WOOD POST
⊗	NUMBER OF WOOD STUDS IN POST BELOW
A	COLUMN ABOVE THIS LEVEL
C	COLUMN CONTINUOUS THROUGH THIS LEVEL
←	TRUSS OR JOIST BEARING
— —	FLUSH FRAMED JOIST BEARING WITH HANGER
⊗	INDICATES OVER FRAMING, SEE PLAN
⊗	WOOD STUD BEARING WALL BELOW
▨	SHEAR WALL
$\frac{N}{T}$	NUMBER OF TRIM STUDS UNDER HEADER
$\frac{N}{K}$	NUMBER OF KING STUDS ADJACENT TO HEADER
<E>	INDICATES EXISTING MEMBER TO REMAIN
<N>	INDICATES NEW MEMBER
<R>	INDICATES EXISTING MEMBER TO BE REMOVED



77 Oak Street  
Portland, ME, 04101  
p. 207-774-4614  
f. 866-793-7835  
[www.structuralinteg.com](http://www.structuralinteg.com)

BUILD WITH CONFIDENCE  
© 2013 Structural Integrity Consulting Engineers, Inc.  
SI 13-0183