

**GENERAL NOTES**

- 1: DRAWING NOTES:**  
CONTRACTOR TO FURNISH AND INSTALL ALL NOTED LABOR AND MATERIALS UNLESS OTHERWISE NOTED.
- 2: CODE COMPLIANCE:**  
ALL WORK SHALL CONFORM TO THE LATEST EDITION OF STATE, LOCAL, AND OTHER CODES WHICH APPLY TO THIS PROJECT OR HAVE JURISDICTION.
- 3: COORDINATION:**  
IT IS THE RESPONSIBILITY OF THE CONTRACTOR TO COORDINATE ALL DISCIPLINES AND TRADES SO THAT ALL BUILDING SYSTEMS AND COMPONENTS CAN BE ASSEMBLED WITHOUT CONFLICTS. IN THE EVENT THAT THE CONSTRUCTION DOCUMENTS DEFINE CONDITIONS WHICH PROHIBIT, OR MAY PROHIBIT, SUCH ASSEMBLY, THE CONTRACTOR SHALL BRING TO THE ARCHITECTS ATTENTION, IN WRITING AND IN A TIMELY FASHION, SUCH CONDITION. THE CONTRACTOR SHALL NOT PROCEED WITH RELATED WORK WITHOUT A WRITTEN RESOLUTION CLARIFICATION FROM THE ARCHITECT.
- 4: DISCREPANCIES & CLARIFICATIONS:**  
THIS PROJECT INVOLVES THE FIT-UP OF AN EXISTING BUILDING. EXISTING DIMENSIONS SHOWN ON THE DRAWINGS ARE BELIEVED TO BE ACCURATE, BUT CANNOT BE GUARANTEED. MEASURE AND VERIFY DIMENSIONS IN FIELD PRIOR TO FABRICATION AND CONSTRUCTION. IT IS THE RESPONSIBILITY OF THE CONTRACTOR TO BRING TO THE ARCHITECTS ATTENTION, IN WRITING, ANY DISCREPANCIES OR AMBIGUITIES IN THE DRAWINGS AND/OR SPECIFICATIONS. THE CONTRACTOR SHALL NOT PROCEED WITH RELATED WORK WITHOUT A WRITTEN RESOLUTION OR CLARIFICATION FROM THE ARCHITECT.
- 5: LAYOUT:**  
UNLESS INDICATED OTHERWISE, CENTER WALL FRAMING AND PARTITION FRAMING ON COLUMN LINES. FLOOR PLAN DIMENSIONS ARE TO CENTER OF FRAMING, FACE OF CONCRETE, FACE OF CMU, OR FROM COLUMN CENTERLINES, UNLESS INDICATED OTHERWISE. DOORS AND WINDOWS ARE DIMENSIONED TO CENTERLINES UNLESS INDICATED OTHERWISE.
- 6: CENTERING:**  
UNLESS INDICATED OTHERWISE, CENTER BUILDING ELEMENTS WITHIN OR BETWEEN OTHER ELEMENTS WHEN CONDITIONS OR THE DRAWINGS INDICATE OR IMPLY THAT SUCH IS THE INTENT, WHETHER OR NOT DIMENSIONS ARE INCLUDED.
- 7: SYMMETRY:**  
WHERE CONDITIONS OR THE DRAWINGS INDICATE OR IMPLY THAT SYMMETRY IS INTENDED, INFORMATION PROVIDED AT ONE SIDE APPLIES EQUALLY TO BOTH SIDES, UNLESS CONDITIONS CLEARLY PRECLUDE SUCH APPLICATION.
- 8: ACCESSIBILITY:**  
ALL HANDICAPPED ACCESSIBLE BATHROOMS, GRAB BARS, AND DOOR OPENINGS SHALL MEET THE REQUIREMENTS OF TITLE 94-34B, CHAPTER 5 OF THE MAINE HUMAN RIGHTS COMMISSION TITLE LATEST EDITION & THE DEPARTMENT OF JUSTICE ADA STANDARDS FOR ACCESSIBLE DESIGN.
- 9: DRAWING SCALES:**  
WORK FROM THE GIVEN DIMENSIONS ONLY. SCALE IS INDICATED ON THE DRAWINGS FOR CONVENIENCE ONLY. IT IS NOT INTENDED THAT INFORMATION BE DETERMINED BY SCALING THE DRAWINGS SINCE SOME ITEMS MAY NOT BE TO SCALE.
- 10: WATER-RESISTANT GWB:**  
INSTALL WATER-RESISTANT GYPSUM WALL BOARD IN ALL REST ROOMS & TOILET ROOMS OR AT ANY WALL WITH PLUMBING FIXTURES.
- 10A: HIGH IMPACT GWB:**  
INSTALL HIGH IMPACT GYPSUM WALL BOARD IN ALL STAIRWELLS
- 11: INTERIOR ELEVATIONS:**  
INTERIOR ELEVATIONS MAY BE REVERSED FROM AND/OR SIMILAR TO ACTUAL CONDITIONS. SEE FLOOR PLANS FOR WINDOW AND DOOR QUANTITIES AND LOCATIONS, FOR CASEWORK LAYOUTS, AND FOR MONITOR LOCATIONS.
- 12: BUILDING INSULATION:**  
BEFORE PENETRATING JOISTS, BEAMS OR OTHER STRUCTURAL MEMBERS WITH PARTITION TYPES, WHETHER OR NOT SHOWN IN DETAILS AND OTHER DRAWINGS. FOR CLARITY, INSULATION MAY NOT BE SHOWN IN SOME CASES, EVEN IF IT IS TO BE PROVIDED.
- 13: BLOCKING:**  
INSTALL BLOCKING BEHIND ALL SURFACE-APPLIED FIXTURES TRIM, CASEWORK, SHELVES, BRACKETS, TOILET ACCESSORIES, CHAIR RAILS, PICTURE RAILS, GRAB BARS, BASE MOLDINGS, AND AS OTHERWISE REQUIRED, WHEN SUCH ITEMS ARE APPLIED ON STUD WALLS.
- 14: PENETRATIONS AT STRUCTURAL MEMBERS:**  
BEFORE PENETRATING JOISTS, BEAMS OR OTHER STRUCTURAL MEMBERS, CONSULT WITH THE ARCHITECT.
- 15: DAMAGED WORK:**  
BUILDING OR SITE COMPONENTS WHICH ARE AFFECTED BY NEW WORK, DEMOLITION, OR WHICH MAY BE DAMAGED BY THE GENERAL CONTRACTOR OR ANY SUB-CONTRACTOR SHALL BE REPLACED OR RESTORED TO ORIGINAL CONDITION AND COLOR TO MEET THE APPROVAL OF THE ARCHITECT.
- 16: UTILITIES:**  
VERIFY THE SIZE AND LOCATION OF ALL UNDERGROUND UTILITIES AND REPORT ANY DISCREPANCIES TO THE ARCHITECT IN WRITING. DO NOT PROCEED WITH WORK UNTIL THE DISCREPANCY HAS BEEN RESOLVED TO THE SATISFACTION OF THE ARCHITECT.
- 17: RATED CONSTRUCTION:**  
PROVIDE RATED CONSTRUCTION AS REQUIRED BY CODE, AS SPECIFIED, AND AS INDICATED ON DRAWINGS. IT IS THE RESPONSIBILITY OF THE CONTRACTOR TO PROVIDE AND INSTALL ALL COMPONENTS REQUIRED TO CREATE SUCH RATED CONSTRUCTION, REGARDLESS OF WHETHER OR NOT SUCH COMPONENTS ARE INDICATED. PROVIDE CONTINUITY OF SUCH RATED CONSTRUCTION AROUND AND BETWEEN SPACES, INCLUDING AT CHASES AND AT FLOORS, TO MAINTAIN COMPLETE SEPARATIONS, EVEN IF NOT SPECIFICALLY INDICATED.
- 18: SHOP DRAWINGS:**  
SUBMIT SHOP DRAWINGS TO THE ARCHITECT FOR REVIEW PRIOR TO FABRICATIONS. SUBMITTALS REQUIRED INCLUDE, BUT ARE NOT LIMITED TO, SHOP DRAWINGS FOR ALL PREFABRICATED CONCRETE, STEEL, MILLWORK & SIGNAGE, SAMPLES OF ALL PROPOSED PAINTS, METALS, WALL COVERINGS, LAMINATES, SOLID SURFACE MATERIALS, CERAMIC TILE, AND HARDWARE. SUBMIT MANUFACTURERS' DATA FOR ALL LIGHTING SYSTEMS, AND HARDWARE.
- 19: PERMITS:**  
THE GENERAL CONTRACTOR SHALL OBTAIN AND PAY FOR ANY BUILDING PERMITS REQUIRED AND CARRY ANY INSURANCE COVERAGES REQUIRED.
- 20: INTERIOR FINISHES:**  
ALL INTERIOR FINISHES AND FURNISHINGS ARE TO BE CLASS 'A' FIRE-RATED AND ARE TO COMPLY WITH SECTION 920.0 BOCA (INTERIOR FLAME SPREAD).
- 21: ELECTRICAL DESIGN:**  
REFER TO ELECTRICAL DRAWINGS AND SPECIFICATIONS
- 22: WASTE REMOVAL:**  
THE GENERAL CONTRACTOR SHALL DISPOSE OF ALL WASTE AND DEBRIS OFF THE PREMISES.
- 23: NOT USED**
- 24: TEMPORARY FACILITIES:**  
PROVIDE ALL TEMPORARY FACILITIES AND SERVICES, CONSTRUCTION AND SUPPORT FACILITIES, AND SECURITY AND PROTECTION AS NEEDED TO PROTECT NEW AND EXISTING CONSTRUCTION FOR THE DURATION OF A COMPLETE INSTALLATION.
- 25: FINAL CLEANING:**  
EMPLOY EXPERIENCED WORKERS FOR FINAL CLEANING. CLEAN EACH SURFACE TO THE CONDITION EXPECTED IN A COMMERCIAL BUILDING CLEANING PROGRAM.
- 26: MANUFACTURERS INSTRUCTIONS:**  
ALL MATERIALS & EQUIPMENT SHALL BE INSTALLED ACCORDING TO MANUFACTURER'S SPECIFICATIONS.
- 27: GUARANTEE:**  
ALL MATERIALS & WORKMANSHIP SHALL BE GUARANTEED FOR A PERIOD OF ONE YEAR FROM THE DATE OF FINAL ACCEPTANCE UNLESS OTHERWISE SPECIFIED FOR A LONGER PERIOD OF TIME ON A CERTAIN ITEM.
- 28: ASBESTOS:**  
ALL MATERIAL USED FOR THE CONSTRUCTION OF THIS PROJECT, WHETHER BUILDING MATERIALS OR APPURTENANCES, SHALL BE NON-ASBESTOS CONTAINING MATERIAL.
- 29: HAZARDOUS FUMES:**  
THE GENERAL CONTRACTOR SHALL CONFIRM THAT ALL MATERIAL AND FINISHES SPECIFIED AND THEIR FABRICATION OR INSTALLATION WILL NOT RELEASE FUMES OR AROMAS DURING CONSTRUCTION WHICH MAY BE A HAZARD OR NUISANCE TO PERSONNEL.
- 30: PEST CONTROL:**  
SEAL AND CAULK AROUND ALL PENETRATIONS, CRACKS AND CREVICES AND ANY OPENINGS CAPABLE OF HARBORING INSECTS/RODENTS.
- 31. EXPOSED UTILITIES:**  
ALL EXPOSED UTILITY WIRES AND PIPES (ELECTRICAL, PLUMBING, ETC.) SHALL BE INSTALLED IN A WAY THAT DOES NOT OBSTRUCT OR PREVENT THE CLEANING OF FLOORS, WALLS, AND CEILING AREAS. THEY SHALL BE INSTALLED A MINIMUM OF 6" OFF FLOORS AND 1" OFF WALLS, CEILINGS AND ADJACENT PIPES.
- 32. OWNER SUPPLIED EQUIPMENT:**  
EQUIPMENT SUPPLIED BY THE OWNER AND INSTALLED BY THE GENERAL CONTRACTOR. EQUIPMENT INFORMATION AND SPECIFICATIONS ARE TO BE THE MOST CURRENT AVAILABLE AT THE TIME OF DOCUMENTATION PREPARATION. THE GENERAL CONTRACTOR SHALL BE RESPONSIBLE FOR VERIFYING WITH THE OWNER THE EXACT DIMENSIONS AND EQUIPMENT CONNECTION REQUIREMENTS (INCLUDING ELECTRICAL CIRCUIT REQUIREMENTS) OF EQUIPMENT TO BE SUPPLIED. THE GENERAL CONTRACTOR SHALL MAKE ALL FINAL CONNECTIONS AS NOTED ON THE DRAWINGS, INSTALL THE SET UP IN WORKING ORDER, CHECK WARRANTIES, TEST AND NOT VOID WARRANTIES. THE GENERAL CONTRACTOR SHALL COORDINATE WITH THE OWNER DELIVERY, STORAGE AND INSTALLATION OF ALL OWNER SUPPLIED EQUIPMENT. THE GENERAL CONTRACTOR SHALL STORE EQUIPMENT IF REQUESTED BY THE OWNER UNTIL INSTALLATION. SEE DRAWINGS FOR OTHER OWNER SUPPLIED/GENERAL CONTRACTOR INSTALLED ITEMS.
- 33: FIRE PROTECTION NOTE:**  
EXISTING SPRINKLERHEADS, ALARM SYSTEM AND DETECTORS ARE TO BE MODIFIED TO CONFORM WITH THE PROPOSED PLAN. COORDINATE WITH THE ARCHITECT, ANY MODIFICATION OR LOCATIONS WHERE EXISTING SYSTEMS ARE AFFECTED BY THE NEW DESIGN.
- 34: SOILS AT FOOTINGS:**  
REPORT THE LOCATION OF ALL UNSUITABLE SOILS AND MATERIALS BELOW ANTICIPATED LEVEL OF FOOTING TO THE ARCHITECT PRIOR TO THE SETTING OF FORMS.
- 35: ACCESS PANELS:**  
CONTRACTOR IS RESPONSIBLE FOR COORDINATING QUANTITY AND LOCATION OF ALL REQUIRED ACCESS PANELS FOR ALL MEP CONTROLS, CLEANOUTS, DAMPERS, PULL BOXES, ETC.
- 36: EXISTING HAZARDOUS MATERIALS**  
ALL HAZARDOUS MATERIALS INCLUDING BUT NOT LIMITED TO ASBESTOS AND LEAD PAINT ARE TO BE HANDED, ENCAPSULATED, ABATED AND DISPOSED OF IN ACCORDANCE WITH ANY AND ALL FEDERAL, STATE AND LOCAL REQUIREMENTS AND REGULATIONS.
- 37: INDUSTRY STANDARDS:**  
ALL WORK SHALL BE PERFORMED IN ACCORDANCE WITH INDUSTRY STANDARDS. STANDARDS INCLUDE BUT ARE NOT LIMITED TO THE FOLLOWING:

- AAMA AMERICAN ARCHITECTURAL MANUFACTURERS ASSOCIATION  
ACI AMERICAN CONCRETE INSTITUTE  
ANSI AMERICAN NATIONAL STANDARDS INSTITUTE  
ASTM AMERICAN SOCIETY FOR TESTS AND MATERIALS  
AWI ARCHITECTURAL WOODWORK INSTITUTE "CUSTOM GRADE"  
AWS AMERICAN WELDING SOCIETY  
IGMA INSULATING GLASS MANUFACTURERS ALLIANCE  
NAAMM NATIONAL ASSOCIATION OF ARCHITECTURAL METAL MANUFACTURERS  
NRCA NATIONAL ROOFING CONTRACTORS ASSOCIATION  
NTCA NATIONAL TILE CONTRACTORS ASSOCIATION  
SMACNA SHEET METAL AND AIR CONDITIONING NATIONAL ASSOCIATION  
WDMA WINDOW AND DOOR MANUFACTURERS ASSOCIATION

**ABBREVIATIONS**

A	AIR CONDITIONING	L	LABORATORY
AC	ACOUSTICAL CEILING TILE	LAB	LAMINATED
AD	AREA DRAIN	LD	LEAD
ADAAG	AMERICANS WITH DISABILITIES ACT ACCESSIBILITY'S GUIDELINES	LH	LEFT-HAND
ADD	ADDENDUM	LCC	LEAD COATED COPPER
AFF	ABOVE FINISHED FLOOR	M	MACH
AHU	AIR-HANDLING UNIT	MAS	MASONRY
AL	ALUMINUM	MATL	MATERIAL
ARCH	ARCHITECT/ARCHITECTURAL	MAX	MAXIMUM
AWP	ARCHITECT WALL PANEL	MDO	MEDIUM-DENSITY OVERLAY
B	BACK-TO-BACK ANGLES	MECH	MECHANICAL
B B O C	BASE BUILDING GENERAL CONTRACTOR	MEMB	MEMBRANE
BLDG	BUILDING	MET	METAL
BLD	BUILDING LINE	MEZZ	MEZZANINE
BLKG	BLOCKING	MFR	MANUFACTURER
BSMT	BASEMENT	MIN	MINIMUM
BTVN	BETWEEN UNIT	MISC	MISCELLANEOUS
BO	BY OTHERS	MO	MASONRY OPENING
C	COURSE (MASONRY)	MD	MOUNTED
CER	CERAMIC	MTL	METAL
CG	CORNER GUARD	MB	MARKER BOARD
CH	COAT HOOK	N	NORTH
CH	CONTROL JOINT	N#	NUMBER
CL	CENTER LINE	NIC	NOT IN CONTACT
CLG	CEILING	NOM	NOMINAL DIMENSION
CMU	CONCRETE MASONRY UNIT	NTS	NOT TO SCALE
CO	CLEAN OUT	O	ON/OVER
COL	COLUMN	OC	ON CENTER
COND	CONCRETE	OD	OUTSIDE DIAMETER/OUTSIDE DIMENSION
COND	CONDITION	OFF	OFFICE
CONN	CONNECTION	OPNG	OPENING
CONST	CONSTRUCTION	OPPOS	OPPOSITE
CONT	CONTINUOUS	OR	ORIENTED STRAND BOARD
CORR	CORRIDOR	OSB	ORIENTED STRAND BOARD
CT	CERAMIC TILE	OZ	OUNCE
CUH	CABINET UNIT HEATER	P	PURCHASED BY OWNER INSTALLED BY CONTRACTOR
D	DOUBLE	PBOIBC	PURCHASED BY OWNER INSTALLED BY CONTRACTOR
DF	DRINKING FOUNTAIN	PC	PLATE
DIA	DIAMETER	PL	PLASTIC LAMINATE
DIFF	DIFFUSER	PLAM	PAIR
DIM	DIMENSION	PRE FAB	PREFABRICATE
DN	DOWN	PRIM	PRIMED
DOR	DOOR	PSF	POUNDS PER SQUARE FOOT
DSP	DRY STAND PIPE	PTD	PAINTED
DWG	DRAWING	PTN	PARTITION
E	EAST	PVC	POLYVINYL CHLORIDE
EA	EACH	PWD	PLYWOOD
EL	ELEVATION	PT	PRESSURE TREATED
ELEC	ELECTRICAL	PERF	PERFORATED
ELEV	ELEVATOR	Q	QUARTY TILE
ENTR	ENTRANCE	QTR	QUARTER
EQ	EQUAL	R	RISER/RADIUS
EQUIP	EQUIPMENT	RD	RUBBER BASE
EXP	EXPANSION	RCP	REFLECTED CEILING PLAN
EXPB	EXPANSION BOLT	RD	ROOF DRAIN
EXT	EXTERIOR	REBAR	REINFORCING BAR
EXT	EXTERIOR	REF	REFRIGERATOR
EXTR	EXTRUSION	REFR	REFRIGERATED
EXTR	EXTRUSION	REQ	REQUIRED
EXTR	EXTRUSION	RES	RESILIENT
EXTR	EXTRUSION	REV	REVERSE
EXTR	EXTRUSION	RM	ROOM
EXTR	EXTRUSION	RO	ROUGH OPENING
EXTR	EXTRUSION	ROW	RIGHT OF WAY
F	FAHRENHEIT	S	SOUTH
FB	FLAT BAR	SCHED	SCHEDULE
FD	FLOOR DRAIN	SFE	SQUARE FEET
FE	FIRE EXTINGUISHER	SI	SIMILAR
FE	FIRE EXTINGUISHER	SPEC	SPECIFICATION
FE	FIRE EXTINGUISHER	SQ	SQUARE
FE	FIRE EXTINGUISHER	ST	STAINLESS STEEL
FE	FIRE EXTINGUISHER	STC	SOUND TRANSMISSION CLASS
FE	FIRE EXTINGUISHER	STD	STANDARD
FE	FIRE EXTINGUISHER	STL	STEEL
FE	FIRE EXTINGUISHER	STOR	STORAGE
FE	FIRE EXTINGUISHER	STRUC	STRUCTURE/STRUCTURAL
FE	FIRE EXTINGUISHER	SUSP	SUSPENSION
FE	FIRE EXTINGUISHER	T	TONGUE/GROOVE
FE	FIRE EXTINGUISHER	TG	TELEPHONE
FE	FIRE EXTINGUISHER	TEL	THICK
FE	FIRE EXTINGUISHER	THK	TOP OF DECK
FE	FIRE EXTINGUISHER	TK	TOP OF STEEL
FE	FIRE EXTINGUISHER	TYP	TYPICAL
FE	FIRE EXTINGUISHER	TV	TELEVISION
FE	FIRE EXTINGUISHER	TB	TACK BOARD
FE	FIRE EXTINGUISHER	TOC	TOP OF CONCRETE
FE	FIRE EXTINGUISHER	U	UNDERWRITERS LABORATORIES, INC.
FE	FIRE EXTINGUISHER	UL	UNIT VENTILATOR
FE	FIRE EXTINGUISHER	UV	UNIT VENTILATOR
FE	FIRE EXTINGUISHER	V	VCT
FE	FIRE EXTINGUISHER	VCT	VINYL COMPOSITION TILE
FE	FIRE EXTINGUISHER	VERT	VERTICAL
FE	FIRE EXTINGUISHER	VERIF	VERIFY IN FIELD
FE	FIRE EXTINGUISHER	VOL	VOLUME
FE	FIRE EXTINGUISHER	W	WEST
FE	FIRE EXTINGUISHER	W/O	WITHOUT
FE	FIRE EXTINGUISHER	WD	WITH
FE	FIRE EXTINGUISHER	WID	WIDE
FE	FIRE EXTINGUISHER	WF	WIDE FLANGE
FE	FIRE EXTINGUISHER	WP	WORK POINT
FE	FIRE EXTINGUISHER	WT	WEIGHT

**FIRESTOPPING DETAILS**

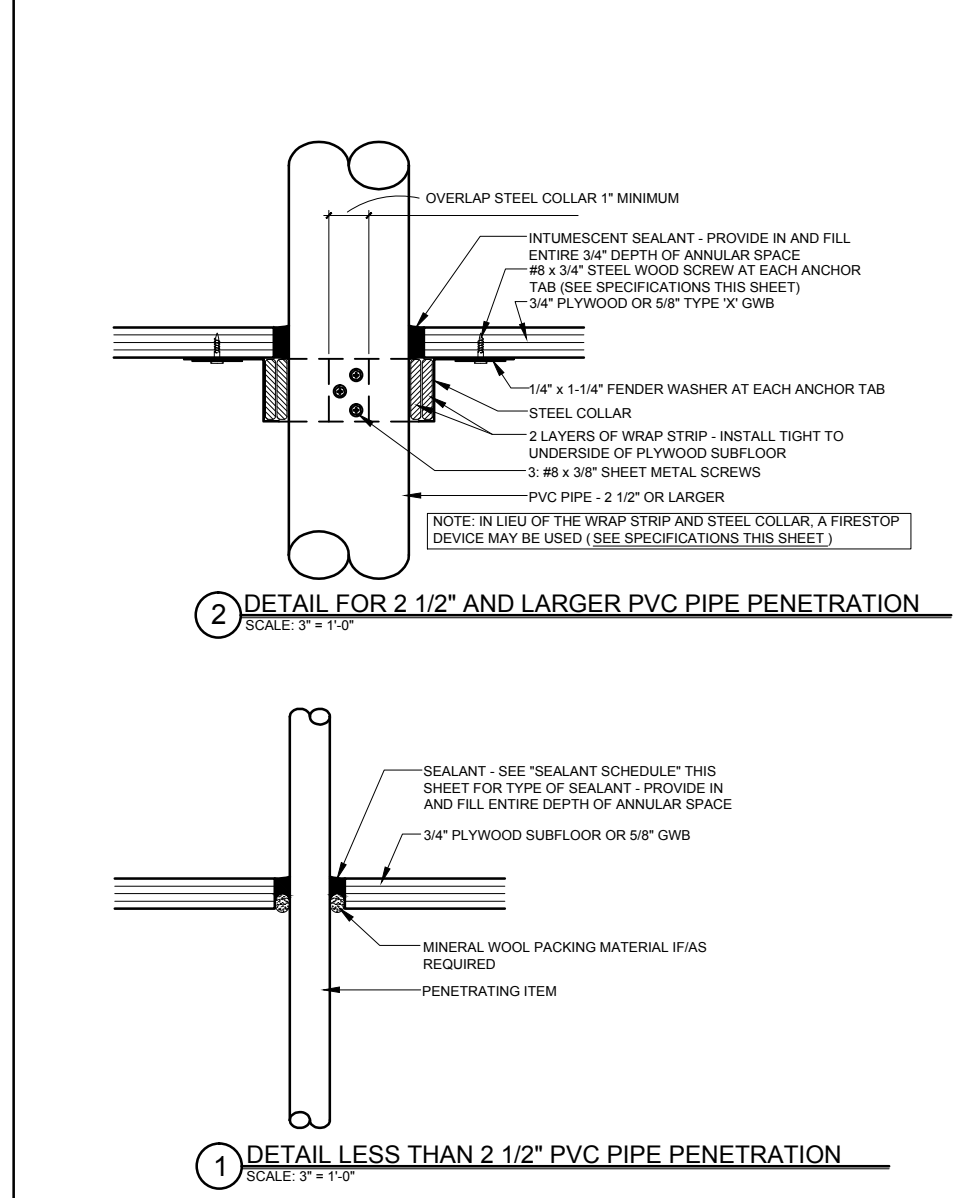

**SPECIFICATIONS**

**WRAP STRIP:** 1/4" THICK x 1 1/2" MINIMUM WIDTH INTUMESCENT MATERIAL WITH PLASTIC FILM FACING BOTH SIDES. TEMPORARILY SECURE WITH MASKING TAPE. SPECIFIED TECHNOLOGIES INC. (STI) "SpecSeal RED Wrap Strip" OR "SpecSeal BLU Wrap Strip" OR EQUAL.

**STEEL COLLAR:** WRAP STRIP MANUFACTURER'S STEEL COLLAR, FABRICATED FROM .016 INCH THICK GALVANIZED SHEET STEEL, WIDTH TO MATCH WRAP STRIP (1 1/2" MINIMUM), WITH 1 INCH x 2 INCH ANCHOR TABS AND RETAINER TABS. ANCHOR TABS TO BE SYMMETRICALLY OPPOSED AROUND COLLAR. PROVIDE 3 TABS FOR 2 1/2" AND 3" PIPE, PROVIDE 4 TABS FOR 4" PIPE.

**INTUMESCENT SEALANT:** ONE-PART, INTUMESCENT, LATEX ELASTOMER TESTED TO ASTM E 814. MINIMUM EXPANSION OF 3x AT 1000°F. 3M "FIRE BARRIER SEALANT CP 25WB" OR EQUAL.

**FIRESTOP SEALANT:** SINGLE COMPONENT NONCOMBUSTIBLE FIRE RATED SEALANT TESTED TO ASTM E 814. TESTED TO 3000°F. "BOSS 136 FIRESTOP/DRAFT SEALANT" MANUFACTURED BY ACCUMETRIC, LLC, OR EQUAL.

**SEALANT SCHEDULE:**

**INTUMESCENT SEALANT:** PROVIDE AT ALL PENETRATIONS THROUGH RATED CONSTRUCTION FOR PENETRATING ITEMS INCLUDING BUT NOT LIMITED TO: PVC PIPE; ROOF LEADER PIPES; GAS PIPES & LINES; SPRINKLER PIPES; ELECTRICAL & COMMUNICATIONS CABLES & WIRES; AND ALARM SYSTEM WIRES. DO NOT USE INTUMESCENT SEALANT AT DOMESTIC HOT WATER OR HYDRONIC HEATING SYSTEM PIPES.

**FIRESTOP SEALANT:** PROVIDE AT ALL PENETRATIONS THROUGH RATED CONSTRUCTION FOR PENETRATING ITEMS INCLUDING DOMESTIC HOT AND COLD WATER PIPES AND HYDRONIC HEATING SYSTEM PIPES.

**NOTE:**

FOR LOCATIONS OF RATED CONSTRUCTION, SEE ARCHITECTURAL FLOOR PLANS AND SECTIONS

**DRAWING LEGEND**

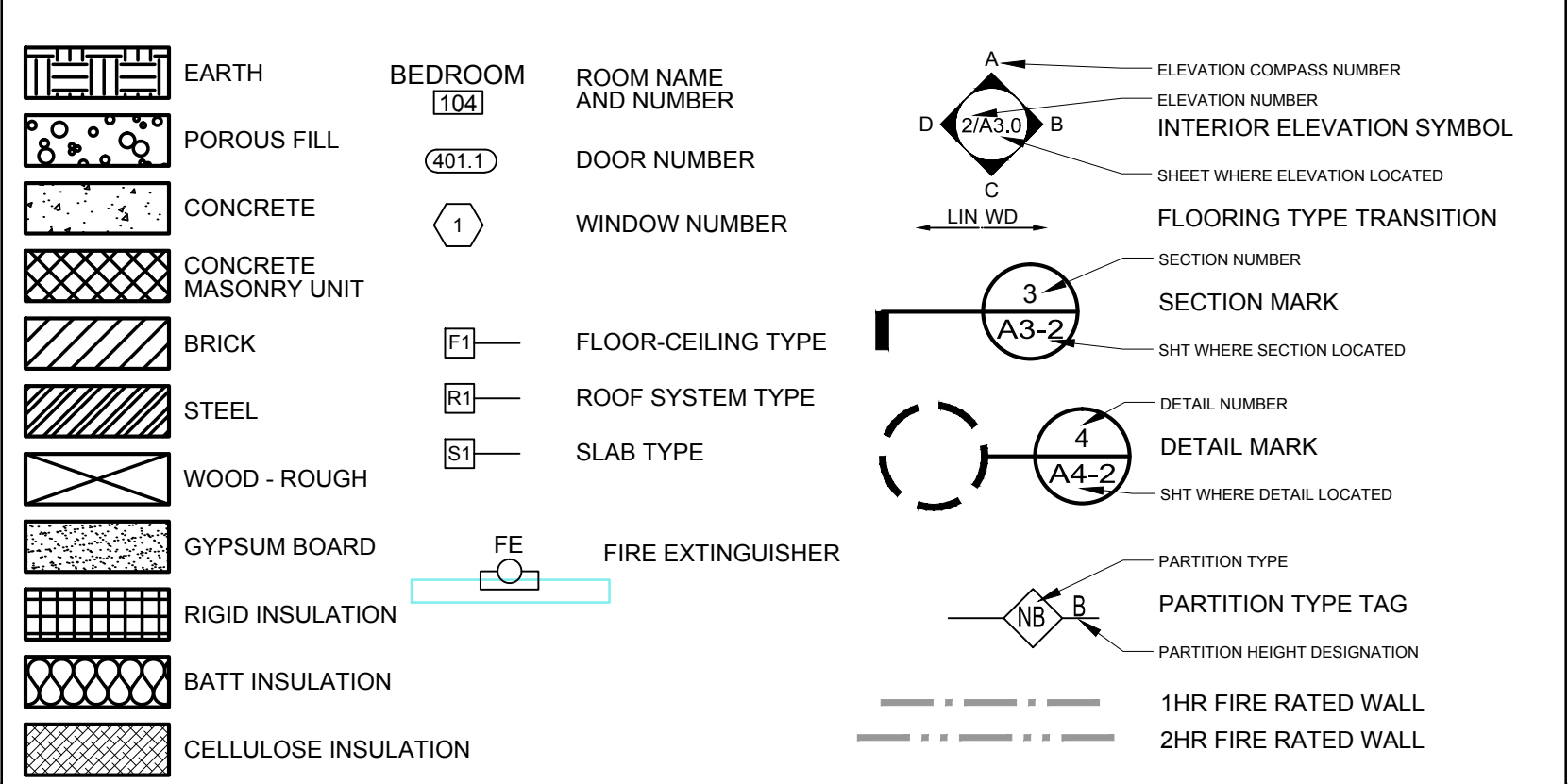

© 2013 RYAN SENATORE ARCHITECTURE

**165 WOODLAWN AVENUE**  
**RENOVATIONS**  
**PORTLAND, MAINE**



**RYAN SENATORE ARCHITECTURE**  
565 CONGRESS STREET  
SUITE 304, PORTLAND, ME 04101  
207-650-8414  
senatorearchitecture.com

**CONSULTANTS:**  
Structural Integrity  
77 Oak Street  
Portland, ME 04101  
207-774-4614

REVISIONS:

DATE: DECEMBER 27, 2013

PROJECT No. 1327

DRAWN BY: RRT / RJS

CHECKED BY: RJS

SCALE: AS NOTED

SHEET TITLE:  
**GENERAL NOTES, ABBREVIATIONS AND LEGEND**

**G1-0**