

2 ROOF PLAN
1/4" = 1'-0"

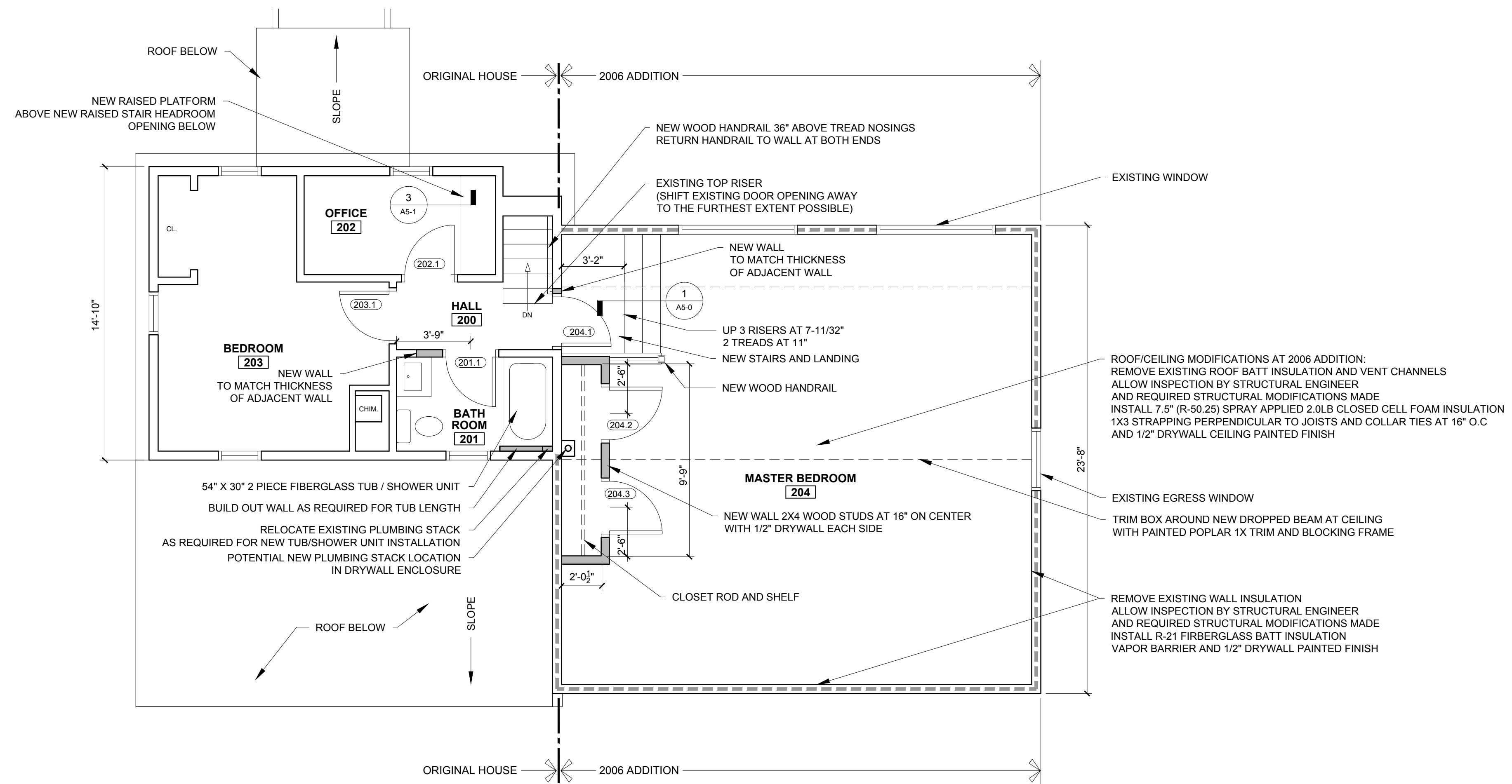

1 SECOND FLOOR PLAN
1/4" = 1'-0"

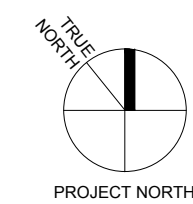
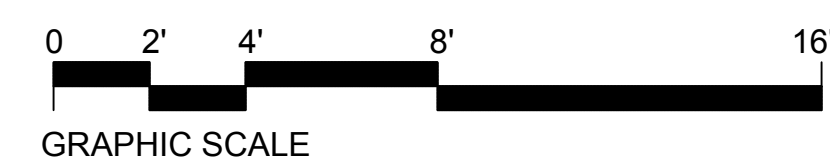

WALL LEGEND	
	EXISTING WALL
	NEW WALL
	INDICATES EXISTING WALL TO BE INSULATED

- PLAN NOTES**
- G.C. TO HAVE A LICENSED ELECTRICIAN REVIEW ALL WIRING RELATED TO THE 2006 ADDITION WHEN INSULATION IS REMOVED FROM WALLS AND MAKE ALL ELEMENTS CODE COMPLIANT
 - G.C. TO REVIEW CURRENT MECHANICAL AND PLUMBING SYSTEMS AND MAKE CODE COMPLIANT, AND PROVIDE FULLY FUNCTIONAL SYSTEMS



© 2013 RYAN SENATORE ARCHITECTURE

165 WOODLAWN AVENUE
RENOVATIONS
PORTLAND, MAINE



RYAN SENATORE ARCHITECTURE
565 CONGRESS STREET
SUITE 304, PORTLAND, ME 04101
207-650-6414
senatorearchitecture.com

CONSULTANTS:
STRUCTURAL: 3 Structural Integrity 77 Oak Street Portland, ME 04101 207-774-4614

REVISIONS:

DATE: DECEMBER 27, 2013

PROJECT No. 1327

DRAWN BY: RRT / RJS

CHECKED BY: RJS

SCALE: AS NOTED

SHEET TITLE:
SECOND FLOOR AND ROOF PLANS

A1-1