

© 2013 RYAN SENATORE ARCHITECTURE

165 WOODLAWN AVENUE
 RENOVATIONS
 PORTLAND, MAINE



RYAN SENATORE ARCHITECTURE
 565 CONGRESS STREET
 SUITE 304, PORTLAND, ME 04101
 207-650-6414
 senatorearchitecture.com

CONSULTANTS:
STRUCTURAL:
 Structural Integrity
 77 Oak Street
 Portland, ME 04101
 207-774-4614

REVISIONS:

DATE: DECEMBER 27, 2013
 PROJECT No. 1327
 DRAWN BY: RRT / RJS
 CHECKED BY: RJS
 SCALE: AS NOTED

SHEET TITLE:
 CRAWL SPACE
 AND FIRST
 FLOOR PLANS

A1-0

WALL LEGEND	
	EXISTING WALL
	NEW WALL
	INDICATES EXISTING WALL TO BE INSULATED

- PLAN NOTES**
- G.C. TO HAVE A LICENSED ELECTRICIAN REVIEW ALL WIRING RELATED TO THE 2006 ADDITION WHEN INSULATION IS REMOVED FROM WALLS AND MAKE ALL ELEMENTS CODE COMPLIANT
 - G.C. TO REVIEW CURRENT MECHANICAL AND PLUMBING SYSTEMS AND MAKE CODE COMPLIANT, AND PROVIDE FULLY FUNCTIONAL SYSTEMS

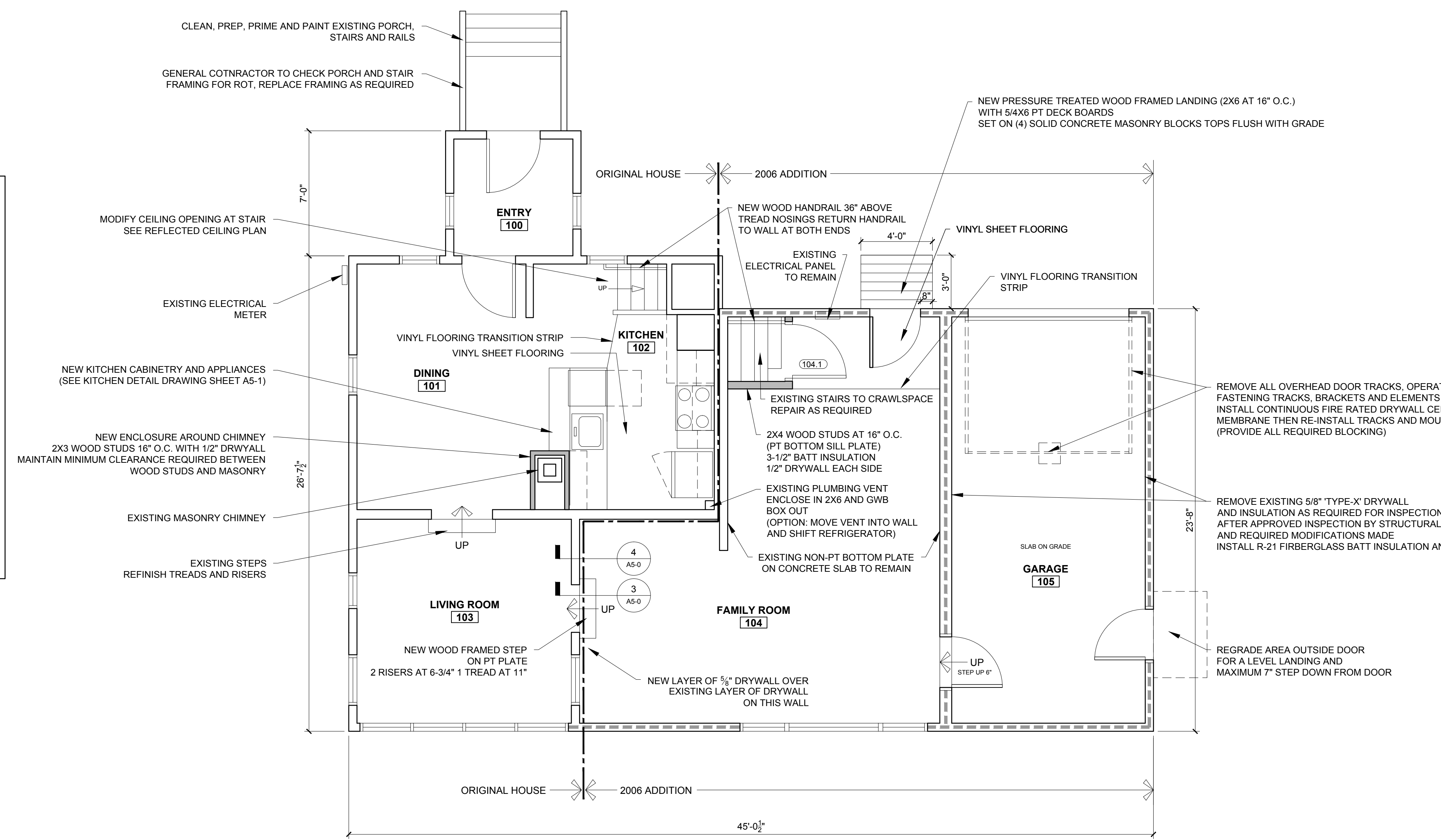

2 FIRST FLOOR PLAN
 1/4" = 1'-0"

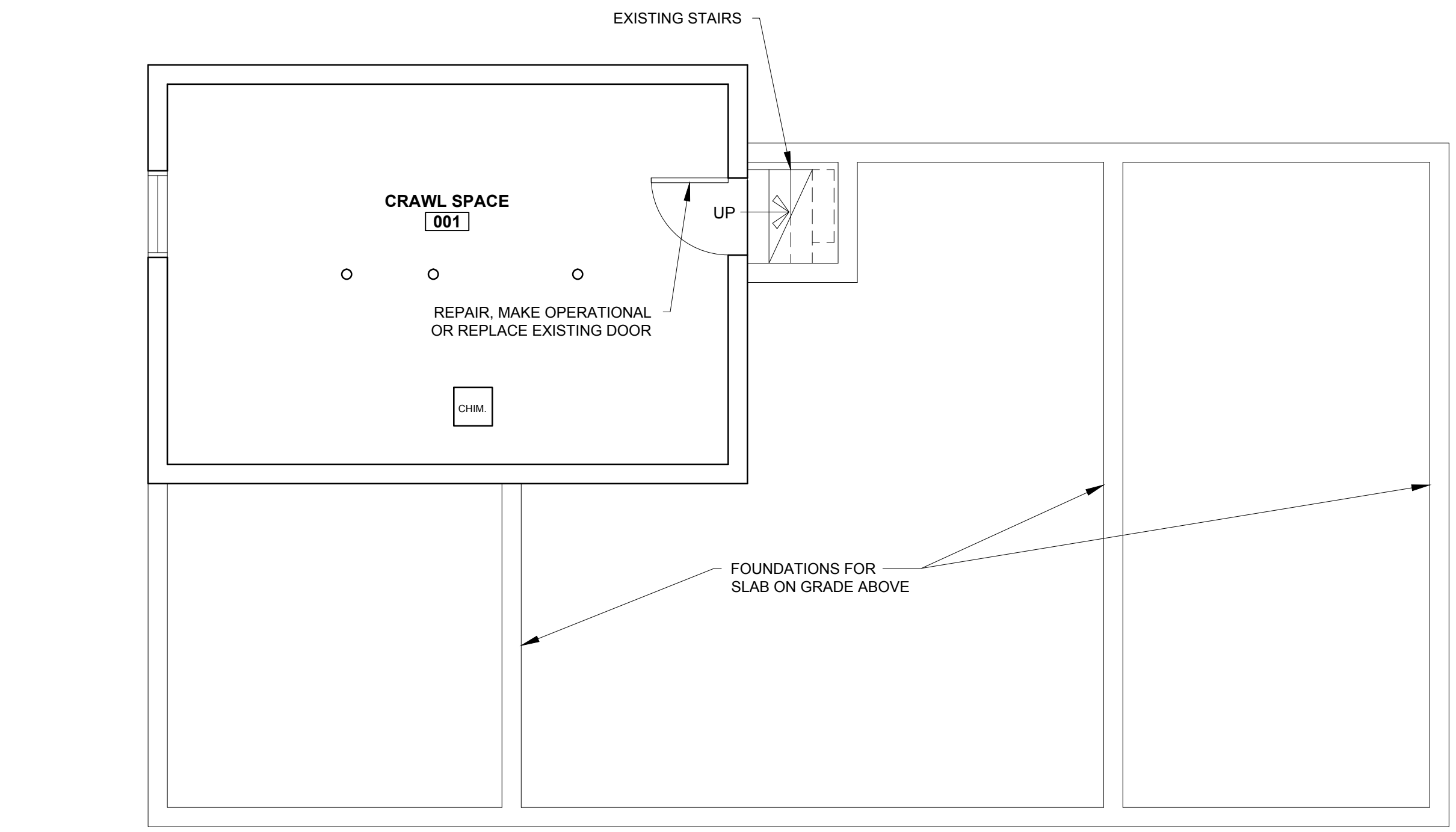

1 CRAWL SPACE PLAN
 1/4" = 1'-0"

