

NOTE:
 SMOKE ALARMS SHALL BE INSTALLED IN THE FOLLOWING LOCATIONS:

1. EACH SLEEPING AREA
2. OUTSIDE EACH SEPARATE SLEEPING AREA IN THE IMMEDIATE VICINITY OF THE BEDROOM.
3. ON EACH ADDITIONAL STORY OF THE DWELLING INCLUDING BASEMENT.
4. ALL SMOKE ALARMS SHALL BE INTERCONNECTED.
5. FIRE SEPARATION PER TOWN OR LOCAL CODE WHEN REQUIRED.

* EGRESS WINDOW
CONSTRUCTION NOTE:
 CONTRACTOR TO VERIFY GRADE AND ALL DIMENSIONS IN FIELD BEFORE STARTING NEW CONSTRUCTION.

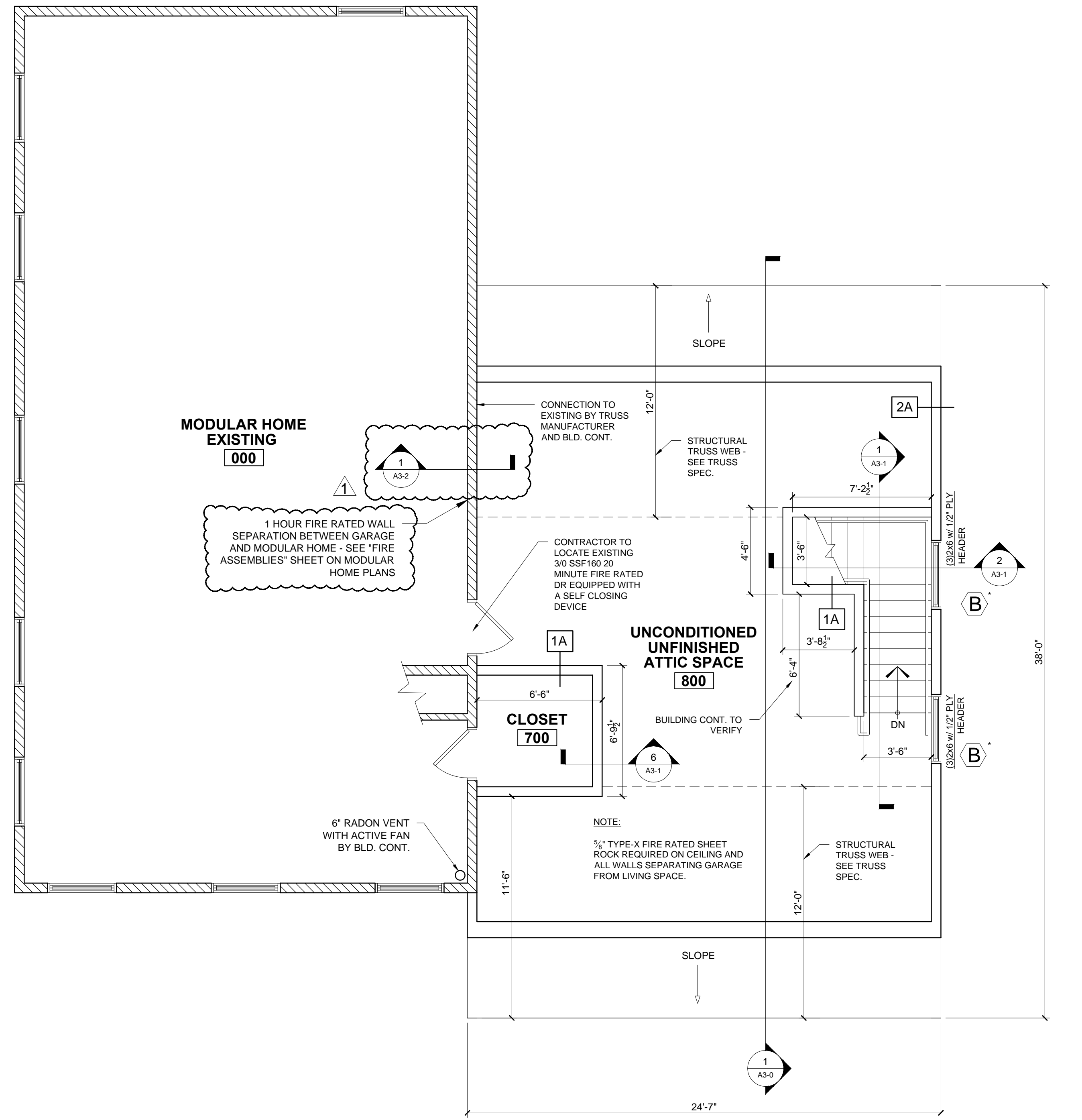
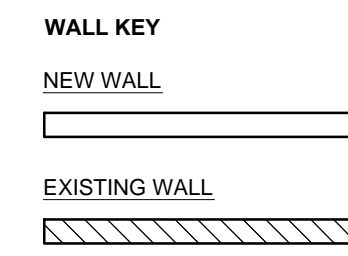

1 SECOND FLOOR PLAN
 1/4" = 1'-0"



DRAWINGS ARE PROVIDED BY REID TOZIER AS A SERVICE TO HIS CUSTOMERS. REID TOZIER IS NOT RESPONSIBLE FOR THE ACCURACY OF THE INFORMATION PRESENTED IN THESE DRAWINGS. THESE DRAWINGS ARE NOT PREPARED OR REVIEWED BY A LICENSED ARCHITECT OR REGISTERED ARCHITECT AND SHOULD NOT BE USED AS A BASIS FOR CONSTRUCTION. REID TOZIER SUGGESTS THAT HIS CUSTOMERS SEEK THE SERVICES OF A LICENSED ARCHITECT TO OBTAIN TECHNICAL BLUE PRINTS IF THE CUSTOMER DESIRES TO PROCEED FURTHER. THESE DRAWINGS ARE NOT TO BE USED AS A BASIS FOR CONSTRUCTION AND REID TOZIER DISCLAIMS ANY RESPONSIBILITY IF THEY ARE SO USED.

REVISIONS:
 REVISION #1 - 6/24/14

DATE: MAY 5, 2014

PROJECT No.

DRAWN BY:

CHECKED BY:

SCALE: AS NOTED

SHEET TITLE:
 SECOND FLOOR PLAN