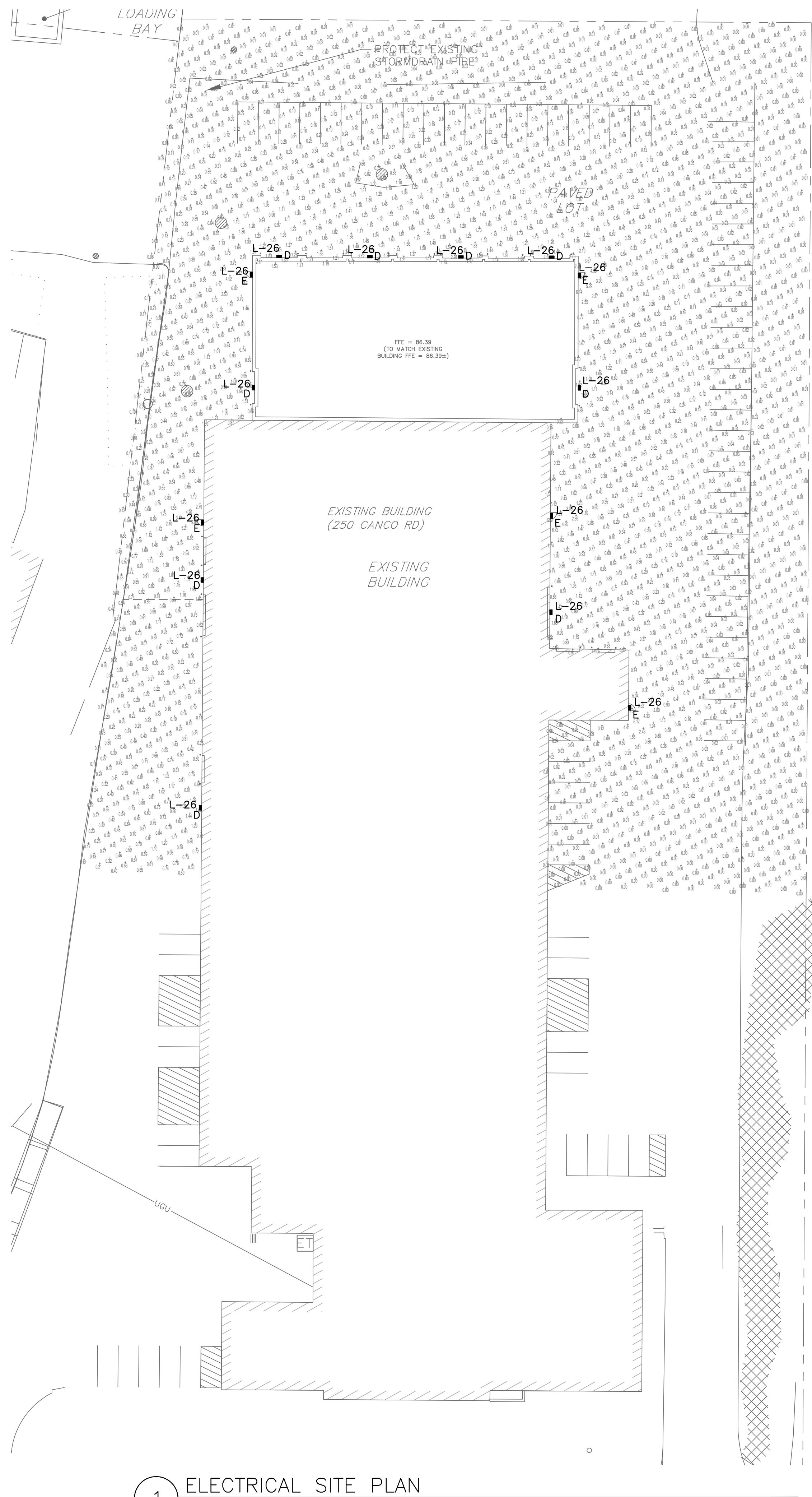

Exhibit 10: Lighting

The proposed project is part of a larger facility with an approved lighting plan. The project site is already lit and does not require any substantive changes in lighting. See this exhibit for the lighting cut sheets.



1 ELECTRICAL SITE PLAN
SCALE: 1"=30'

LAREDO SERIES
LMC-30 LEDs

SPALDING LIGHTING

SPECIFICATIONS
Intended Use: Full cut off LED ambient perimeter or entry lighting for 10-18ft mounting heights that require high SFP output and maximum energy efficiency. Laredo LMC-30 LED wallpack provides low maintenance costs with little or no maintenance and up to 90% energy savings. Ideal for schools, factories, hospitals, warehouses and retail applications.

Construction: Durable die-cast aluminum housing and steel rugged design protects internal components and provides excellent thermal management for over 75,000 hours mean life span at 30,000 hours minimum LED life. Laredo wallpack series provides great lighting quality and appearance in outdoor environments. Five standard finishes include: Black, Gray, White and Platinum.

Optical/Electrical: LED: High power LEDs delivers up to 2000 lumens at 7000K and up to 3000 lumens at 4000K. Selectable distribution - Types D and E (downward facing) and L (upward facing). High CRI LEDs provide excellent color rendition up to 100 lumens per watt efficiency.

LEDs: CCT: 3000K, 4000K, 5000K, 6000K, 7000K, 8000K, 9000K, 10000K. CRI: 90+ (Type D and E) or 95+ (Type L). Beam angle: 120° or 180°. Mounting height: 10-18ft. Mounting hole: 1.5" or 2.0".

Options/Accessories: LMC-30LU Motion Sensor, LMC-30LU BBU.

ORDERING INFORMATION
ORDERING EXAMPLE: LMC-30LU-3K-3-1-PO4

SERIES	NUMBER OF LED SOURCES WALLPAC	CCT	LED DISTRIBUTION	DRIVER CURRENT	FINISH	OPTIONS
LMC-30LU	30 LEDs, Universal voltage 120-277V	3K 3000K	2 Type D	BLANK, 500MA	1 Bronze	BBP: Integral battery for 120 or 277V rated for 30' of clearance. Available in 3000K, 5000K and 6000K.
LMC-30LU	30 LEDs, 120V	4K 4000K	3 Type B	05S 500MA	2 Black	2 Day
LMC-30LU	30 LEDs, 200V	4K 4000K	4 Type B	nominal	4 White	PC: Full cut-off photometric (must specify voltage per fixture 1, not available in 4000K)
LMC-30LU	30 LEDs, 240V	nominal	5 Footcandle	nominal	5 Platinum	F: Flaring lip only voltage per fixture.
LMC-30LU	30 LEDs, 277V	nominal	nominal	nominal	nominal	SCPM: Programmable motion control, battery output is 10% light output.
LMC-30LU	30 LEDs, 347V	nominal	nominal	nominal	nominal	
LMC-30LU	30 LEDs, 480V	nominal	nominal	nominal	nominal	

3 TYPE "D" FIXTURE
SCALE: NOT TO SCALE

SLING SERIES
SG

HUBBELL Outdoor Lighting

SPECIFICATIONS
Intended Use: Slings are available in two sizes for use in applications including building perimeter lighting, entrance, driveway, walkway, loading docks or garages for schools, apartments or commercial buildings.

Construction: Rugged die-cast aluminum housing with corrosion resistant powder coat finish both interior and exterior. Superior performance with 5-11 degree IP mounting height. Minimum operating temperature is -47°F (-47°C).

Control: Control is 0-10V dimming standard. Photocell and occupancy sensor options available for complete control and dimming control.

LEDs: • LED: 277V, 5000K electronic drivers
• 347V and 480V available in larger S22 housing
• 100% surge protection included

LEDs Optics, CCT: • 3000K, 4000K and 5000K CCT
• CCT: 3000K, 4000K, 5000K, 6000K, 7000K, 8000K, 9000K, 10000K

Options/Accessories: S22 with occupancy sensor and battery options.

ORDERING INFORMATION
ORDERING EXAMPLE: SG1-20-4K7-FT-UNV-DB

FINISH	CCT	DISTRIBUTION	VOLTAGE	COLLECTION	CONTROL OPTIONS	OPTIONAL
SG1-20 1.5w 1.5w	3K 3000K, 70 DR	120° 120V	120V	DB: Textured Black	SCPM: Sensor Control, Programmable	ES: Battery DC
SG1-30 1.5w 1.5w	4K 4000K, 70 DR	120° 120V	120V	WB: Textured White	SCPM: Sensor Control, Programmable	ES: Battery DC
SG2-20 2.0w 2.0w	3K 3000K, 70 DR	277° 277V	277V	PS: Smooth Gray	SCPM: Sensor Control, Programmable	ES: Battery DC
SG2-30 2.0w 2.0w	4K 4000K, 70 DR	277° 277V	277V	SL: Silver	SCPM: Sensor Control, Programmable	ES: Battery DC
SG2-40 2.0w 2.0w	5K 5000K, 70 DR	277° 277V	277V	CD: Custom Color	SCPM: Sensor Control, Programmable	ES: Battery DC

4 TYPE "E" FIXTURE
SCALE: NOT TO SCALE

LIGHTING SCHEDULE

TYPE	DESCRIPTION	MANUFACTURER	LAMPS	MOUNTING	NOTES
D	FULL CUTOFF WALL MOUNTED LED SITE LIGHTS 120/277V	SPALDING LIGHTING	35W LED 4000K 3903 LUMENS	WALL MOUNT 16' AFG	MODEL #: LMC-30LU-4K-4-035-1
E	FULL CUTOFF WALL MOUNTED LED DOOR LIGHT 120/277V	HUBBELL OUTDOOR LIGHTING	21W LED 4000K 2310 LUMENS	WALL MOUNT 9' AFG	MODEL #: SG1-20-4K7-FT-UNV-DB

2 LIGHTING SCHEDULE
SCALE: NOT TO SCALE



CITY OF PORTLAND PUBLIC WORKS

250 Canco Road
Portland, Maine

ELECTRICAL SITE PLAN

Scale: AS NOTED

ES1.0

March 13, 2017

PROGRESS PRINT
NOT FOR
CONSTRUCTION