

3 EXTERIOR LIGHTING CONTROL DIAGRAM  
SCALE: NOT TO SCALE



1 ELECTRICAL LIGHTING & SYSTEMS PLAN – (PARTIAL) FIRST FLOOR  
SCALE: 1/8"=1'

NOTES:

1. SEE E0.0 FOR LEGEND, ABBREVIATIONS AND GENERAL NOTES.

KEYED NOTES:

① \*\*\*

LIGHTING SCHEDULE

TYPE	DESCRIPTION	MANUFACTURER	LAMPS	MOUNTING	NOTES
A	2' X 2' LED CENTER LENS TROFFER. 120V	COLUMBIA LIGHTING	29W LED 3500K 3300 LUMENS	CEILING GRID	MODEL #: CCL22-3335
B	2' X 2' LED ACRYLIC LENSED TROFFER. 120V	COLUMBIA LIGHTING	31W LED 3500K 3365 LUMENS	CEILING GRID	MODEL #: LJT22-35MLG-FSA12-EU
B4	2' X 4' LED ACRYLIC LENSED TROFFER. 120V	COLUMBIA LIGHTING	34W LED 3500K 4268 LUMENS	CEILING GRID	MODEL #: LJT24-35LWG-FSA12-EU
C	12" INDIRECT/DIRECT 2" APERTURE LED FIXTURE. FIXTURE – MOUNTED OCCUPANCY SENSOR. 120V	FINELITE	126W LED 3500K 4939 LUMENS UP 7724 LUMENS DN	CEILING SUSPENDED	MODEL #: HP-2-ID-12'-S-H-3500K-TG-120V-SC-FA-OBO
CB	8' INDIRECT/DIRECT 2" APERTURE LED FIXTURE. FIXTURE – MOUNTED OCCUPANCY SENSOR. 120V	FINELITE	84W LED 3500K 3292 LUMENS UP 5150 LUMENS DN	CEILING SUSPENDED	MODEL #: HP-2-ID-8'-S-H-3500K-TG-120V-SC-FA-OBO
D	4" OPEN LED RECESSED FIXTURE. 120V	ATLANTIC LIGHTING	14W LED 3500K 1500 LUMENS	CEILING RECESSED	MODEL #: LED4-DLM15-35K-U/4LED10-CL
E	4" OPEN LED RECESSED FIXTURE. WET LOCATION. 120V	ATLANTIC LIGHTING	14W LED 3500K 1500 LUMENS	CEILING RECESSED	MODEL #: LED4-DLM15-35K-U/4LEDPR-CL
F	4' LED WRAPAROUND FIXTURE. 120V	COLUMBIA LIGHTING	37W LED 3500K 4000 LUMENS	CEILING SURFACE	MODEL #: CWP4-4035
G	4' LED HIGH BAY FIXTURE. WIDE DISTRIBUTION. FIXTURE – MOUNTED OCCUPANCY SENSOR. 120V	COLUMBIA LIGHTING	89W LED 5000K 13152 LUMENS	CEILING SUSPENDED	MODEL #: LLHV4-50L-WST-EU-OS1360
H	4' INDIRECT/DIRECT 2" APERTURE LED FIXTURE. WITH INTEGRATED OCCUPANCY SENSOR. 120V	FINELITE	43W LED 3500K 1572 LUMENS UP 2458 LUMENS DN	WALL SURFACE	MODEL #: HP-2-WM-ID-4'-S-H-835-TG-120V-MB-SC-OBO
J	4' WALL WASH 4" APERTURE RECESSED FIXTURE. 120V	FINELITE	10W LED 3500K 935 LUMENS	CEILING RECESSED	MODEL #: HP-4-WW-R-FO-4'-B-835-120V-SC-C1
K	VAPORTITE ELEVATOR PIT FIXTURE 120V	HUBBELL LIGHTING	11W LED 4000K 757 LUMENS	WALL SURFACE	MODEL #: VWGL-1
M	EXTERIOR WALL SCONCE. FULL CUTOFF. DARK BRONZE FINISH. 120V	LITHONIA LIGHTING	20W LED 4000K 2697 LUMENS	WALL SURFACE	MODEL #: OLWX1-LED-20W-40K
C	CEILING MOUNTED DUAL TECHNOLOGY ULTRASONIC AND PASSIVE INFRARED OCCUPANCY SENSOR 120V	HUBBELL	N/A	CEILING SURFACE	MODEL #: OMNIDT500 FURNISH RELAYS/POWER PACKS AS REQUIRED FOR A COMPLETE AND OPERABLE INSTALLATION
CM	CORNER MOUNTED DUAL TECHNOLOGY ULTRASONIC AND PASSIVE INFRARED OCCUPANCY SENSOR 120V	HUBBELL	N/A	WALL CORNER	MODEL #: LODT FURNISH RELAYS/POWER PACKS AS REQUIRED FOR A COMPLETE AND OPERABLE INSTALLATION
W	WALL MOUNT PASSIVE INFRARED OCCUPANCY SENSOR 120V	HUBBELL	N/A	WALL SURFACE	MODEL #: LHIRS11
WD	WALL MOUNT DIMMING PASSIVE INFRARED OCCUPANCY SENSOR 120V	SENSOR SWITCH	N/A	WALL SURFACE	MODEL #: WSX-D-SA-IV
	EMERGENCY BATTERY UNIT 120V	DUAL-LITE	2W LED	WALL SURFACE	MODEL #: EV4D-02L
WP	WEATHER PROOF REMOTE HEAD. WHITE FINISH. 120V	DUAL-LITE	(2) 1W LED	WALL SURFACE	MODEL #: EVO-D-W
	LED EXIT SIGN EMERGENCY BATTERY UNIT COMBINATION WITH REMOTE CAPACITY 120V	DUAL-LITE	(2) 1W LED	CEILING SURFACE	MODEL #: EVCU-R-W-D4
	LED EXIT SIGN EMERGENCY BATTERY UNIT 120V	DUAL-LITE	2W LED	CEILING SURFACE	MODEL #: EVEU-R-W

2 LIGHTING SCHEDULE  
SCALE: NOT TO SCALE

KEY PLAN – FIRST FLOOR

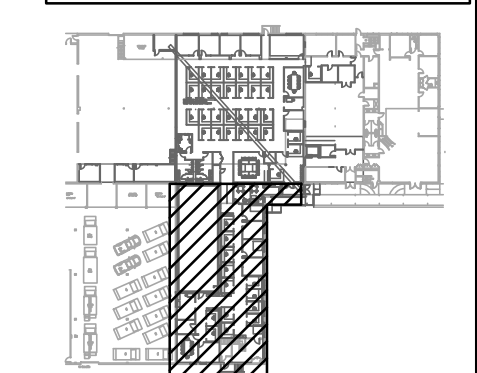

5 Milk Street, Portland, ME  
04101  
207.774.4811 |  
wintonscott.com

Structural Engineering:  
STRUCTURAL INTEGRITY  
CONSULTING ENGINEERS, INC.

46 Forest Avenue  
Portland, ME 04101  
T. 207.774.4614  
structuralinteg.com

HVAC & Plumbing  
Engineering:  
HOLBRICK ENGINEERING, LLC

52 Heath Road  
Saco, ME 04072  
T. 207.283.9127  
aholbrick@maine.rr.com

Electrical Engineering:  
SWIFT CURRENT ENGINEERING  
SERVICES

Royal River Center, Unit 8B  
10 Forest Falls Drive  
Yarmouth, ME 04096  
T. 207.847.9280

CITY OF PORTLAND  
DEPARTMENT  
HEADQUARTERS:

–Parks, Recreation &  
Facilities  
–Public Works

RENOVATION PROJECT

212 Conco Road,  
Portland

REVIEW SET  
NOT FOR CONSTRUCTION

Scale: AS NOTED

ELECTRICAL LIGHTING  
& SYSTEMS PLAN –  
(PARTIAL) FIRST  
FLOOR

E2.1

March 12, 2018