

**NOTES:**

1. SEE E.O.0 FOR LEGEND, ABBREVIATIONS AND GENERAL NOTES.

**KEYED NOTES:**

- ① MOUNT RECEPTACLE 6" ABOVE COUNTERTOP. COORDINATE WITH BACKSLASH.
- ② WEATHER NEMA RECEPTACLES FOR ELECTRIC CAR CHARGING STATIONS. CONSULT CHARGER MANUFACTURER'S INSTRUCTIONS FOR NEMA RECEPTACLES TYPE, AND REQUIRED CONDUCTOR AND BREAKER SIZE. ESTIMATED MINIMUM CONDUCTOR SIZE IS 2#10AWG & #10GND, 3/4".



5 Milk Street, Portland, ME  
04101  
207.774.4811 |  
wintonscott.com

Structural Engineering:  
STRUCTURAL INTEGRITY  
CONSULTING ENGINEERS, INC.

46 Forest Avenue  
Portland, ME 04101  
T. 207.774.4614  
structuralinteg.com

HVAC & Plumbing  
Engineering:  
HOLBRICK ENGINEERING, LLC

52 Heath Road  
Saco, ME 04072  
T. 207.283.9127  
aholbrick@maine.rr.com

Electrical Engineering:  
SWIFT CURRENT ENGINEERING  
SERVICES

Royal River Center, Unit 8B  
10 Forest Falls Drive  
Yarmouth, ME 04096  
T. 207.847.9280

CITY OF PORTLAND  
DEPARTMENT  
HEADQUARTERS:

-Parks, Recreation &  
Facilities  
-Public Works

RENOVATION PROJECT  
212 Conco Road,  
Portland

REVIEW SET  
NOT FOR CONSTRUCTION

Scale: AS NOTED

ELECTRICAL POWER  
& SYSTEMS PLAN -  
(PARTIAL) FIRST  
FLOOR

**E1.1**

March 12, 2018

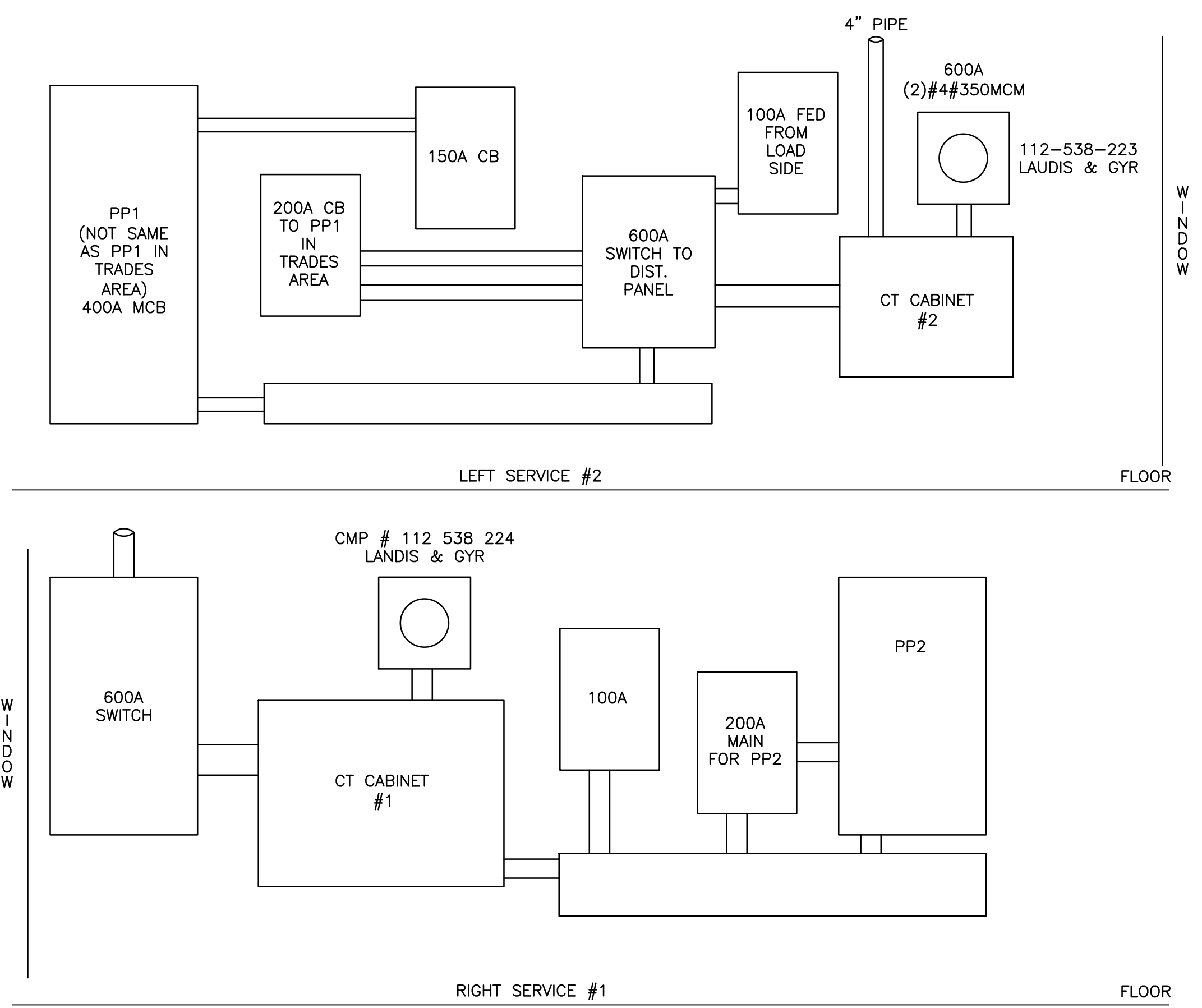
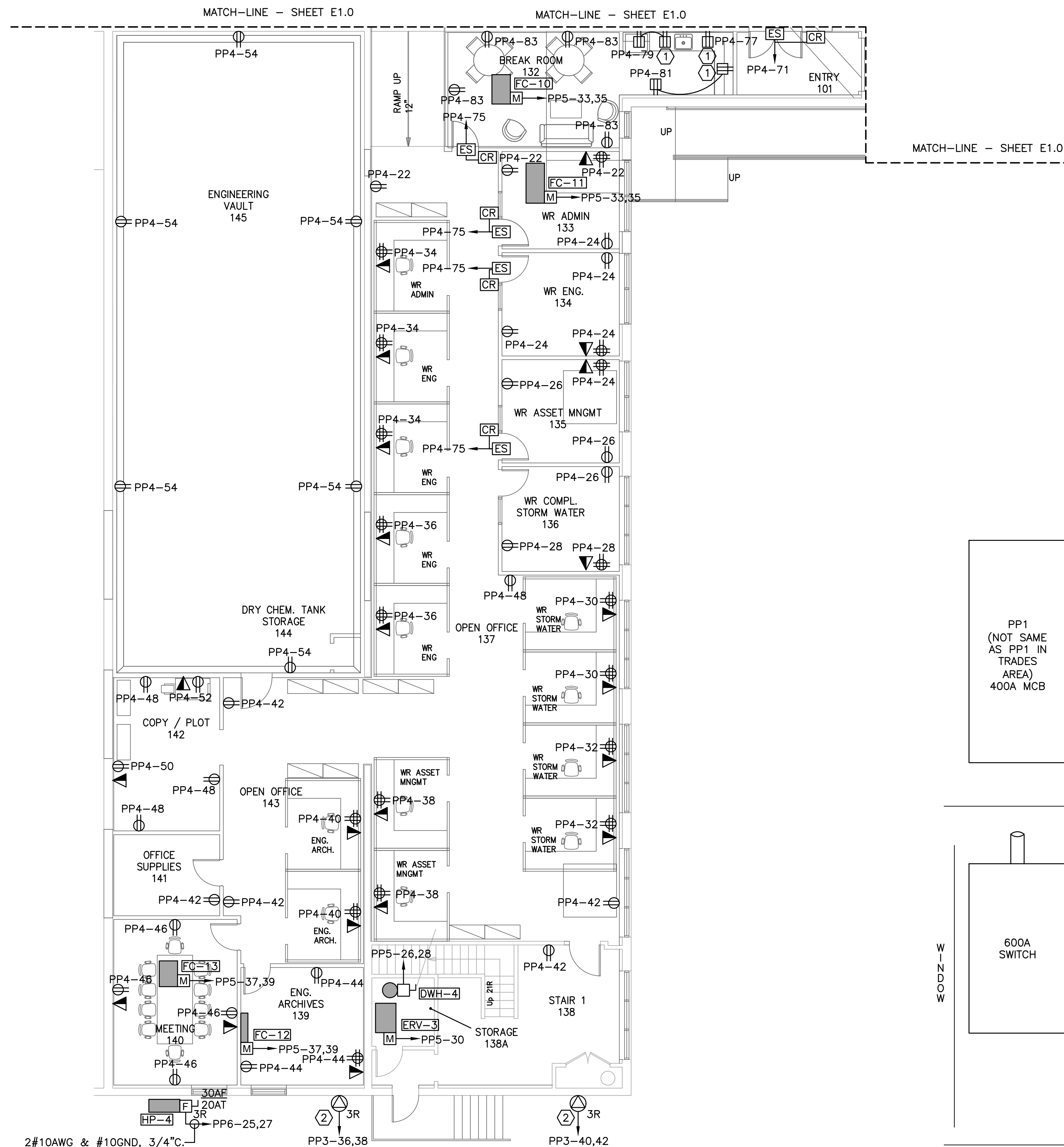

KEY PLAN - FIRST FLOOR

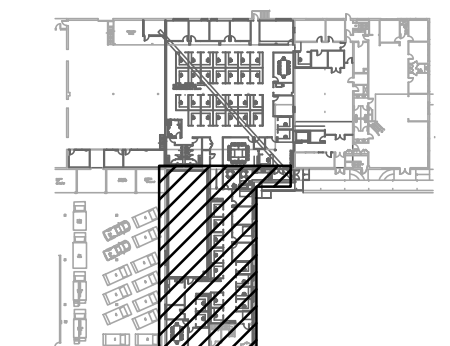

**1** ELECTRICAL POWER & SYSTEMS PLAN - (PARTIAL) FIRST FLOOR  
SCALE: 1/8"=1'

**2** EXISTING ELECTRICAL ELEVATION DETAIL  
SCALE: NOT TO SCALE