

Structural Engineering:
STRUCTURAL INTEGRITY CONSULTING ENGINEERS, INC.

46 Forest Avenue
 Portland, ME 04101
 T. 207.774.4614
 structuralinteg.com

HVAC & Plumbing Engineering:
HOLBROOK ENGINEERING, LLC

T. 207.283.9127
 holbrookengineering.com

Electrical Engineering:
SWIFT CURRENT ENGINEERING SERVICES

Royal River Center, Unit 8B
 10 Forest Falls Drive
 Yarmouth, ME 04096
 T. 207.847.9280

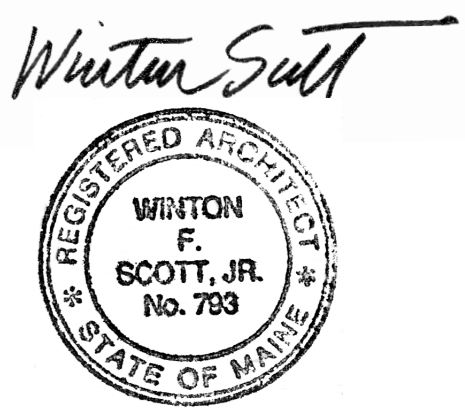

CITY OF PORTLAND DEPARTMENT HEADQUARTERS:

-Parks, Recreation & Facilities
 -Public Works

RENOVATION PROJECT
 212 Canco Road,
 Portland

REVIEW SET NOT FOR CONSTRUCTION

Scale: 1/16" = 1'-0"

OCCUPANCY LOAD PLAN
 FIRST FLOOR

A0.1

March 12, 2018

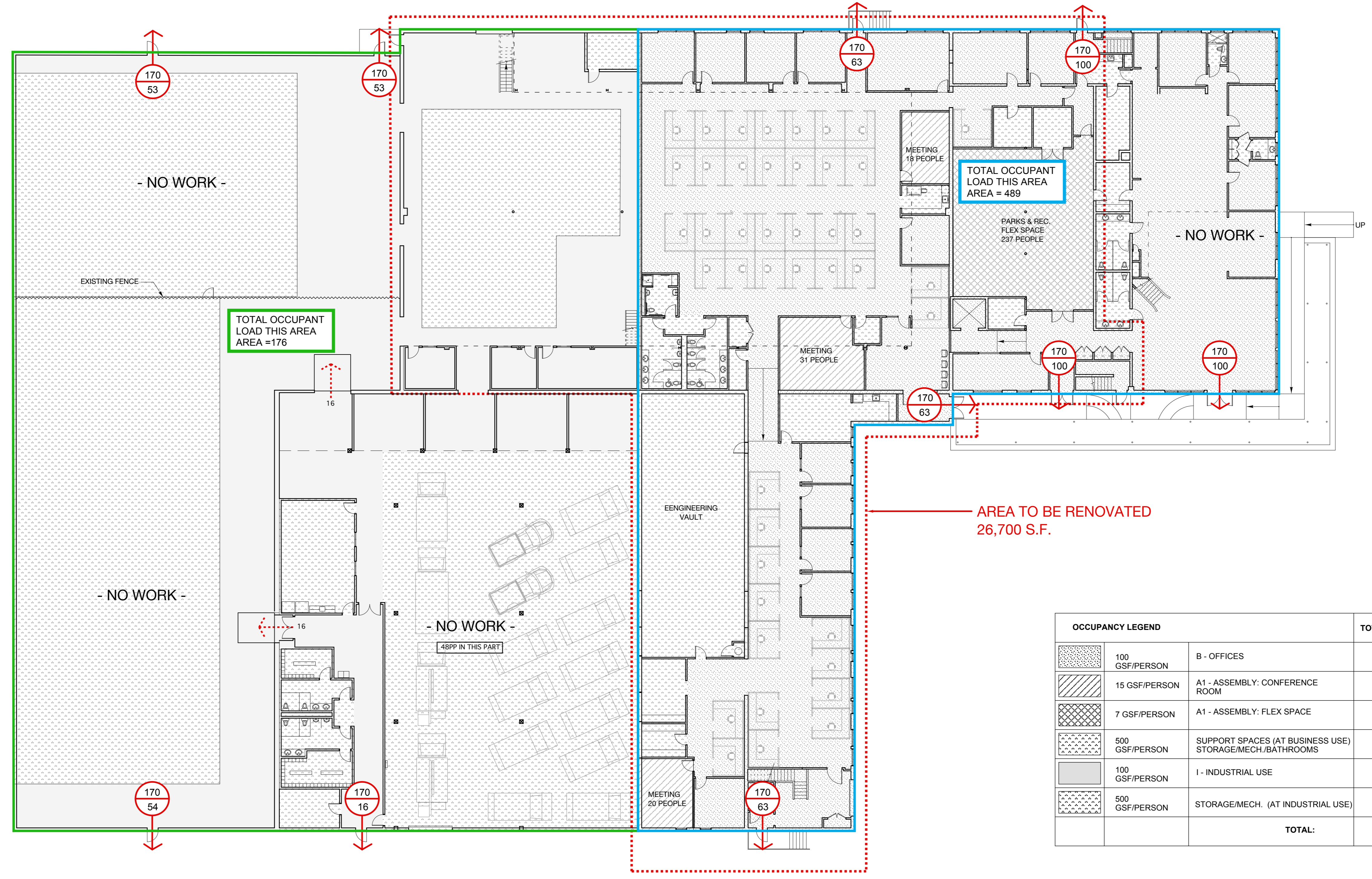

OCCUPANCY LEGEND			TOTAL SQ. FT.	OCCUPANT LOAD
	100 GSF/PERSON	B - OFFICES	17,274	173
	15 GSF/PERSON	A1 - ASSEMBLY: CONFERENCE ROOM	1,036	69
	7 GSF/PERSON	A1 - ASSEMBLY: FLEX SPACE	1,662	237
	500 GSF/PERSON	SUPPORT SPACES (AT BUSINESS USE) STORAGE/MECH./BATHROOMS	5,086	10
	100 GSF/PERSON	I - INDUSTRIAL USE	12,645	127
	500 GSF/PERSON	STORAGE/MECH. (AT INDUSTRIAL USE)	24,550	49
TOTAL:			62,253	665

