

PROJECT COORDINATION BY:

SURVEYOR



PROJECT NO: 3618148351

DRAWN BY: CBM

RELEASED BY: MSD

SUBMITTALS

5/2/14 ISSUED FOR CONSTRUCTION

PORTLAND 5
 20130930169

52 CANCO ROAD
 PORTLAND, ME 04103

SHEET TITLE

SECTIONS AND DETAILS

SHEET NUMBER

D-1

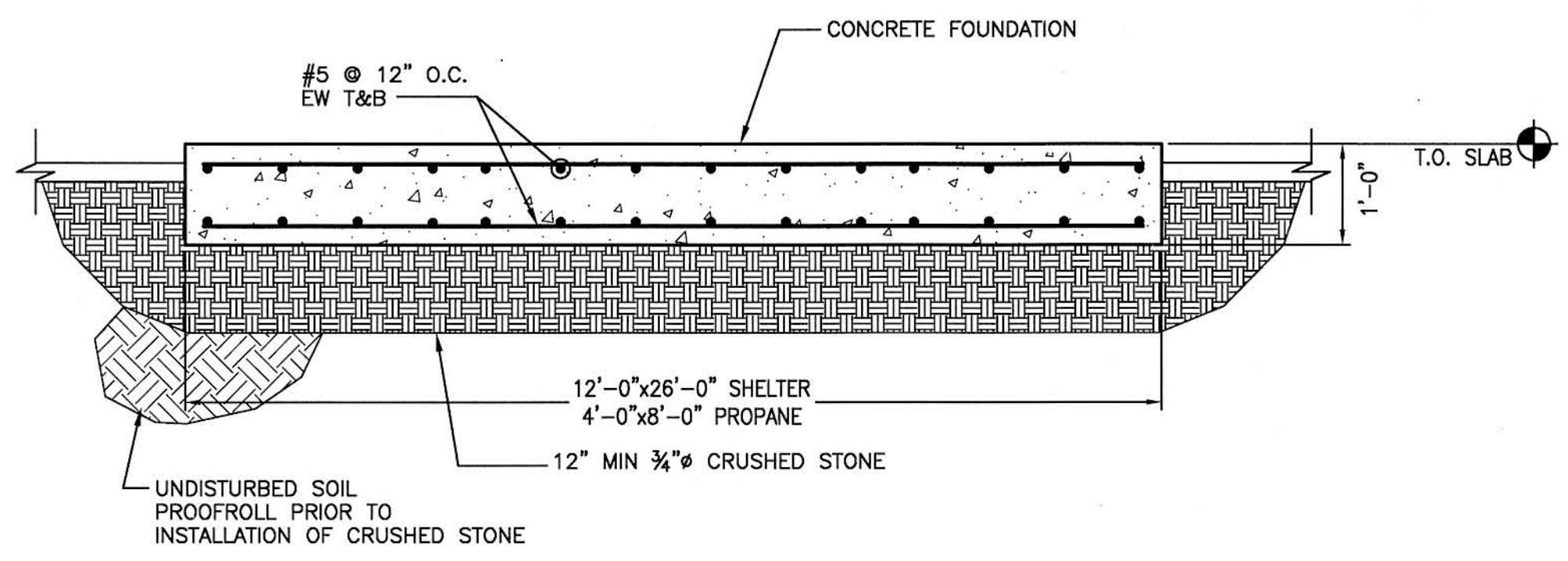

TYPICAL EQUIPMENT SHELTER FOUNDATION DETAIL
 N.T.S.

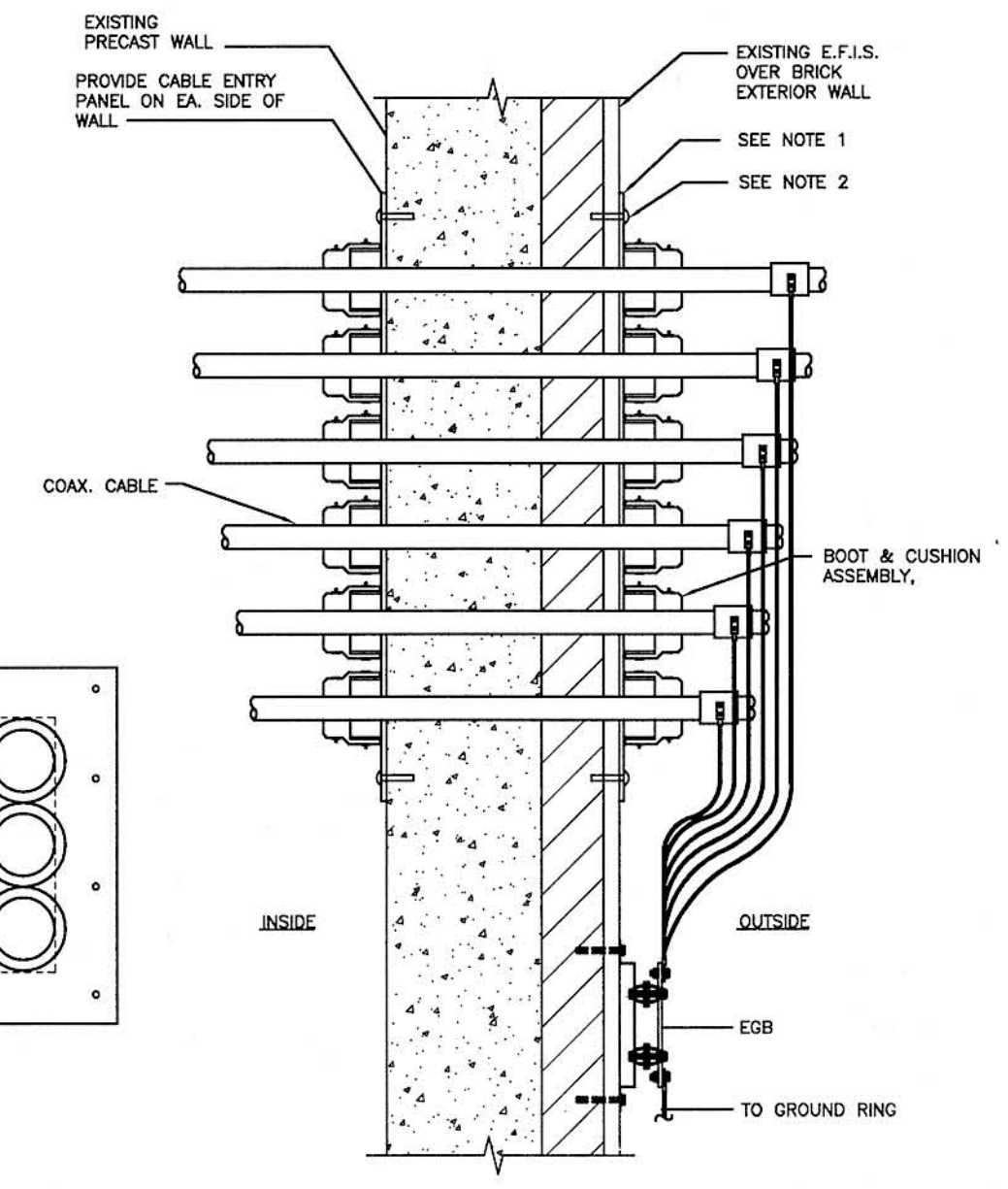

WAVEPORT ENTRY DETAIL
 N.T.S.

1. SEAL PERIMETER OF CABLE ENTRY TO SURFACE OF WALL W/ A ONE COMPONENT POLYURETHANE BASE ELASTOMERIC SEALANT.
2. FASTEN CABLE ENTRY TO WALL W/ STAINLESS STEEL SCREWS W/ LEAD SHIELD INSERTS INTO BRICK, MASONRY, AND CONC. USE TOGGLE BOLTS INTO STUD WALLS.

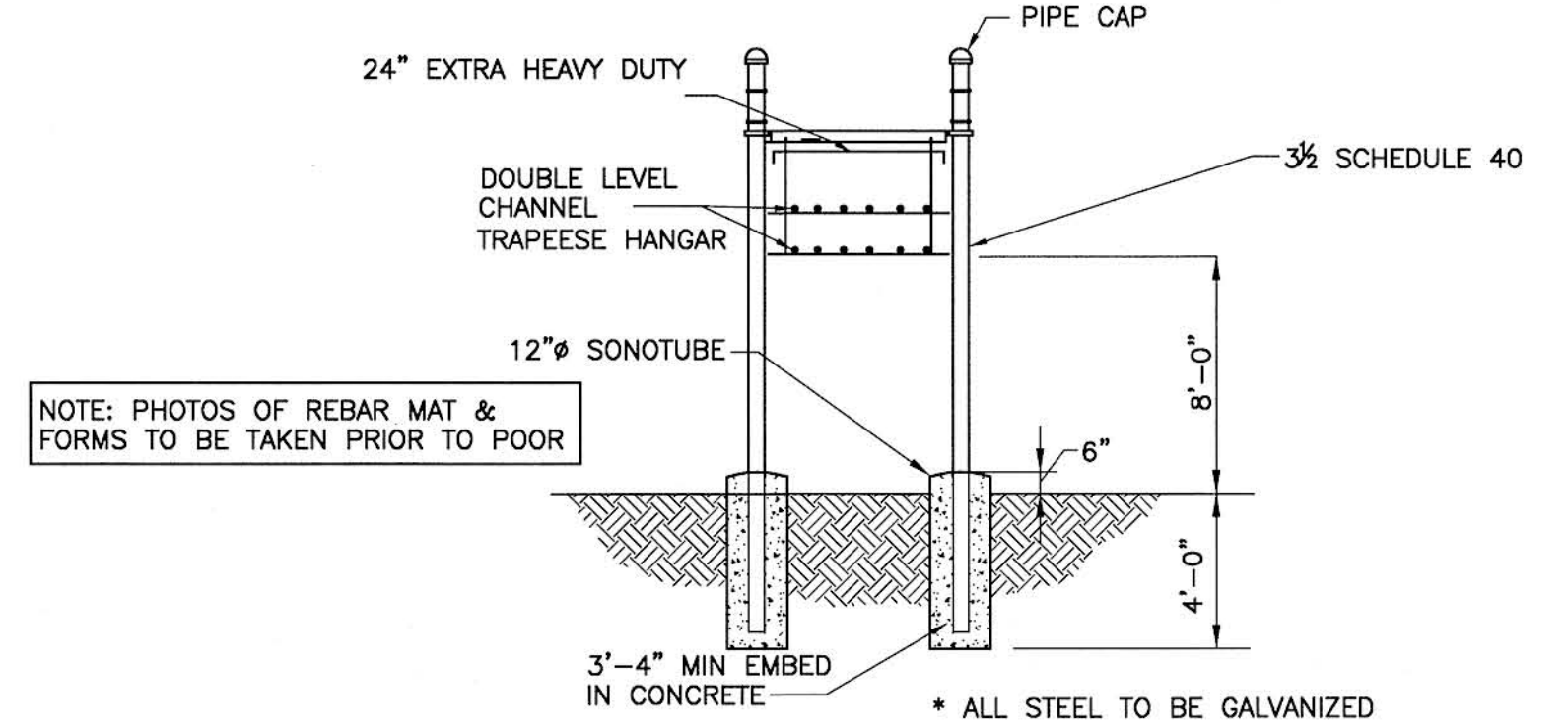

NOTE: PHOTOS OF REBAR MAT & FORMS TO BE TAKEN PRIOR TO POOR

- NOTES:
1. TYPICAL HANGER KIT SHOWN. CONTRACTOR MAY REPLACE WITH EQUAL AS APPROVED BY CONSTRUCTION MANAGER.
 2. SEE COAXIAL CABLE BRIDGE NOTES SHEET G-1
 3. FOR BURIED LEDGE AT LESS THAN 3'-6", CORE LEDGE WITH 4-1/2"x8" DEEP HOLES & GROUT. #3 REINFORCING STEEL WITH #3 TIES @ 6" O.C.

ICE BRIDGE DETAIL

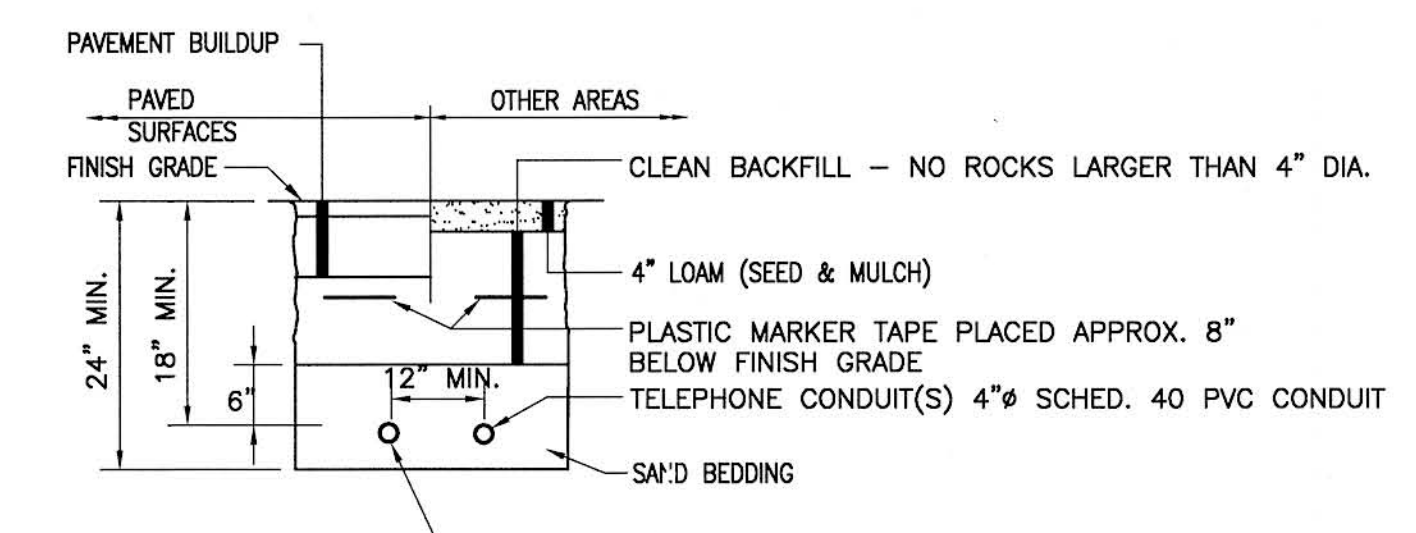

TYPICAL SECTION
 ELECTRICAL & TELEPHONE SERVICE TRENCH
 N.T.S.

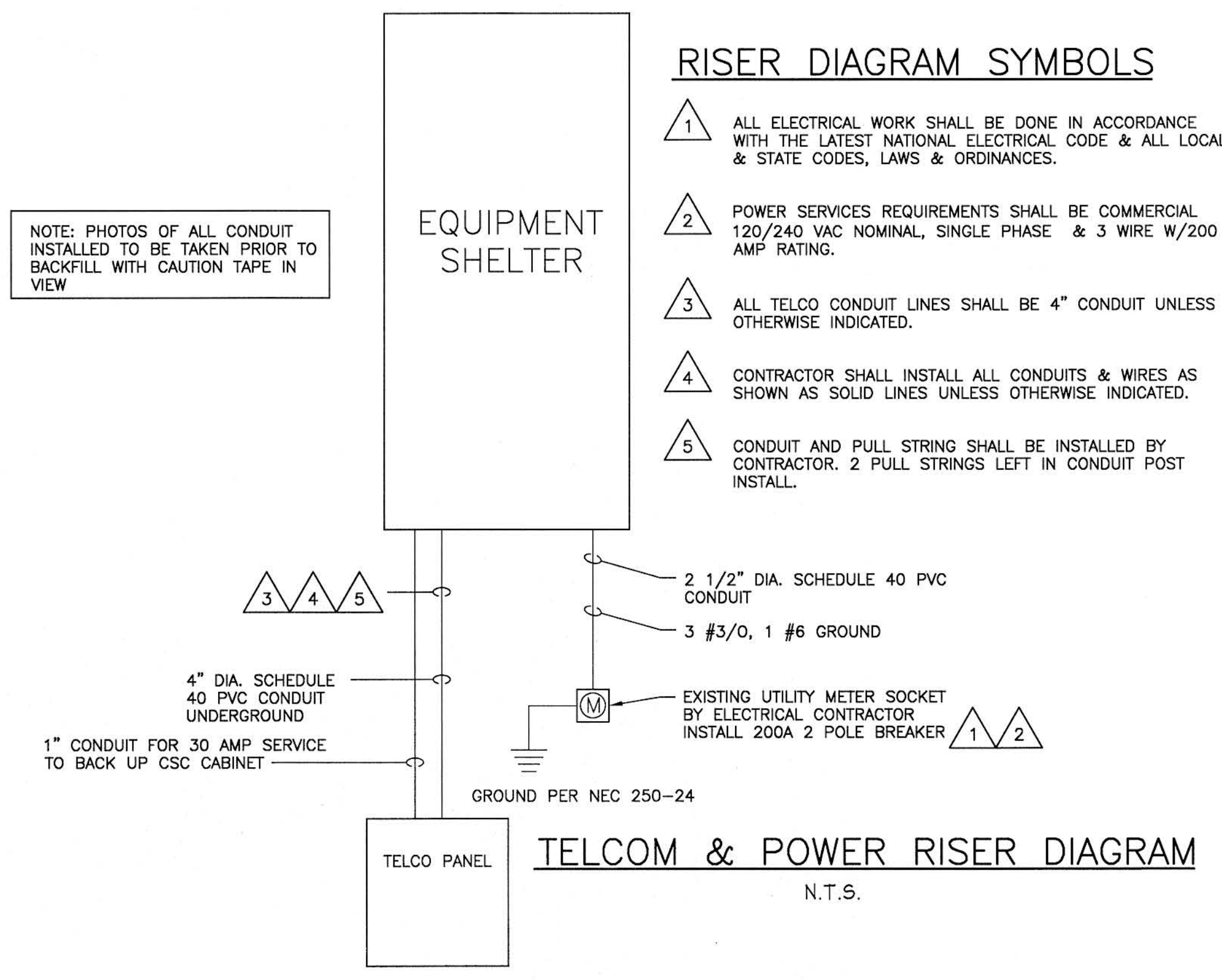

RISER DIAGRAM SYMBOLS

1. ALL ELECTRICAL WORK SHALL BE DONE IN ACCORDANCE WITH THE LATEST NATIONAL ELECTRICAL CODE & ALL LOCAL & STATE CODES, LAWS & ORDINANCES.
2. POWER SERVICES REQUIREMENTS SHALL BE COMMERCIAL 120/240 VAC NOMINAL, SINGLE PHASE & 3 WIRE W/200 AMP RATING.
3. ALL TELCO CONDUIT LINES SHALL BE 4" CONDUIT UNLESS OTHERWISE INDICATED.
4. CONTRACTOR SHALL INSTALL ALL CONDUITS & WIRES AS SHOWN AS SOLID LINES UNLESS OTHERWISE INDICATED.
5. CONDUIT AND PULL STRING SHALL BE INSTALLED BY CONTRACTOR. 2 PULL STRINGS LEFT IN CONDUIT POST INSTALL.

RISER DIAGRAM NOTES:

1. THE ELECTRICAL CONTRACTOR SHALL COORDINATE ALL CONDUIT ROUTING WITH LOCAL UTILITY COMPANIES AND VERIZON CONSTRUCTION MANAGER.
2. UTILITY SERVICES SHOWN ARE PROPOSED, THE ELECTRIC CONTRACTOR SHALL COORDINATE EXACT TELEPHONE AND ELECTRIC SERVICE CONNECTION POINTS, ROUTING, ASSOCIATED REQUIREMENTS AND BACK CHARGES WITH LOCAL UTILITY COMPANIES.
3. ALL CONDUITS ROUTED BELOW GRADE SHALL TRANSITION TO RIGID GALVANIZED ELBOWS WITH RIGID GALVANIZED STEEL CONDUIT ABOVE GRADE.
4. ALL METAL CONDUITS SHALL BE PROVIDED WITH GROUNDING BUSHINGS.
5. GENERAL CONTRACTOR SHALL PROVIDE ALL DIRECT BURIED CONDUITS WITH PLASTIC WARNING TAPE IDENTIFYING CONTENTS. TAPE COLORS SHALL BE ORANGE FOR TELEPHONE AND RED FOR ELECTRIC.

NOTE: PHOTOS OF ALL CONDUIT INSTALLED TO BE TAKEN PRIOR TO BACKFILL WITH CAUTION TAPE IN VIEW

