



Proposed Propane Generator  
within Verizon Wireless  
equipment shelter.

SITE NAME: PORTLAND 5  
 SITE NO. 20130930169  
 LATITUDE: 43° 40' 54.07"  
 LONGITUDE: 70° 17' 13.28"

EXISTING 150' MONOPOLE TOWER AND  
 PROPOSED CO-LOCATION OF EQUIPMENT BUILDING AND ANTENNAS

**SITE NUMBER:** 2013090169  
**SITE NAME:** PORTLAND 5  
**TOWER TYPE:** 150' MONOPOLE TOWER (EXISTING)  
**SITE ADDRESS:** 52 CANCO ROAD  
 PORTLAND, ME 04103

**PROPERTY OWNER:** F. GILBERT CONGDON III ET ALS  
 141 PROSPECT ST  
 PORTLAND, ME 04103

**MAP/BLOCK/LOT:** 147/C/1

**APPLICANT:** VERIZON WIRELESS  
 400 FRIBERG PARKWAY  
 WESTBOROUGH, MA 01581

**PROJECT SUMMARY**

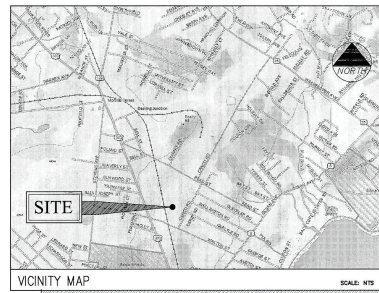

**DIRECTIONS**  
 FROM PORTLAND INTERNATIONAL AIRPORT: FROM AIRPORT TAKE THE ACCESS ROAD TO ROUTE 9/22 (APPROX. .6 MILES) AND TAKE A RIGHT ONTO OUTER CONGRESS STREET. PROCEED 2.1 MILES ON CONGRESS STREET TO THE INTERSTATE 295 NORTH EXIT AND FOLLOW I 295 NORTH TO EXIT 6B. THE EXIT WILL PUT YOU ON FOREST AVENUE WEST AND CONTINUE OUT FOREST AVE FOR 1 MILE WHERE YOU CROSS THE RAILROAD TRACKS AND THEN IN .5 MILES YOU WILL TAKE A RIGHT ONTO WALTON STREET. PROCEED DOWN WALTON STREET FOR .2 MILES AND TAKE A LEFT ONTO CANCO ROAD. THE SITE IS ON YOUR LEFT .3 MILES DOWN CANCO ROAD.

SHEET NO.	DESCRIPTION	DATE	REV. NO.
T-1	TITLE SHEET	5/2/14	0
C-1	PLOT PLAN	5/2/14	0
C-1A	UTILITY PLAN	5/2/14	0
C-2	SITE PLAN	5/2/14	0
C-3	LAYOUT PLAN AND TOWER ELEVATION	5/2/14	0
D-1	SECTIONS AND DETAILS	5/2/14	0
D-2	SHELTER ELEVATION PLAN	5/2/14	0
D-3	SHELTER FLOOR PLAN	5/2/14	0
E-1	GROUNDING DETAILS	5/2/14	0
G-1	GENERAL NOTES	5/2/14	0

**SHEET INDEX**

**BUILDING REQUIREMENTS:**  
 BUILDING IS UNMANNED AND NOT FOR HUMAN HABITATION. HANDICAPPED ACCESS REQUIREMENTS NOT REQUIRED.

**PLUMBING REQUIREMENTS:**  
 FACILITY HAS NO PLUMBING.



**verizon wireless**  
 400 FRIBERG PARKWAY  
 WESTBOROUGH, MA 01581  
 PHONE: (508) 330-3300  
 FAX: (781) 481-1396

**amec**  
 343 Goshen Road, South Portland ME 04106  
 P: (207) 791-1770 F: (207) 774-1246 www.amec.com

PROJECT COORDINATION BY:

SURVEYOR

*Michael S. Dolan*  
 MICHAEL S. DOLAN  
 No. 6023  
 PROFESSIONAL ENGINEER  
 2/14/14

PROJECT NO: 3618148351

DRAWN BY: CBM

RELEASED BY: MSD

**SUBMITTALS**

NO.	DATE	DESCRIPTION
1	5/2/14	ISSUED FOR CONSTRUCTION

PORTLAND 5  
 20130930169  
 52 CANCO ROAD  
 PORTLAND, ME 04103

SHEET TITLE  
 TITLE SHEET

SHEET NUMBER  
 T-1