

1 LG1 CONCRETE SEGMENTAL RETAINING WALL NOT TO SCALE

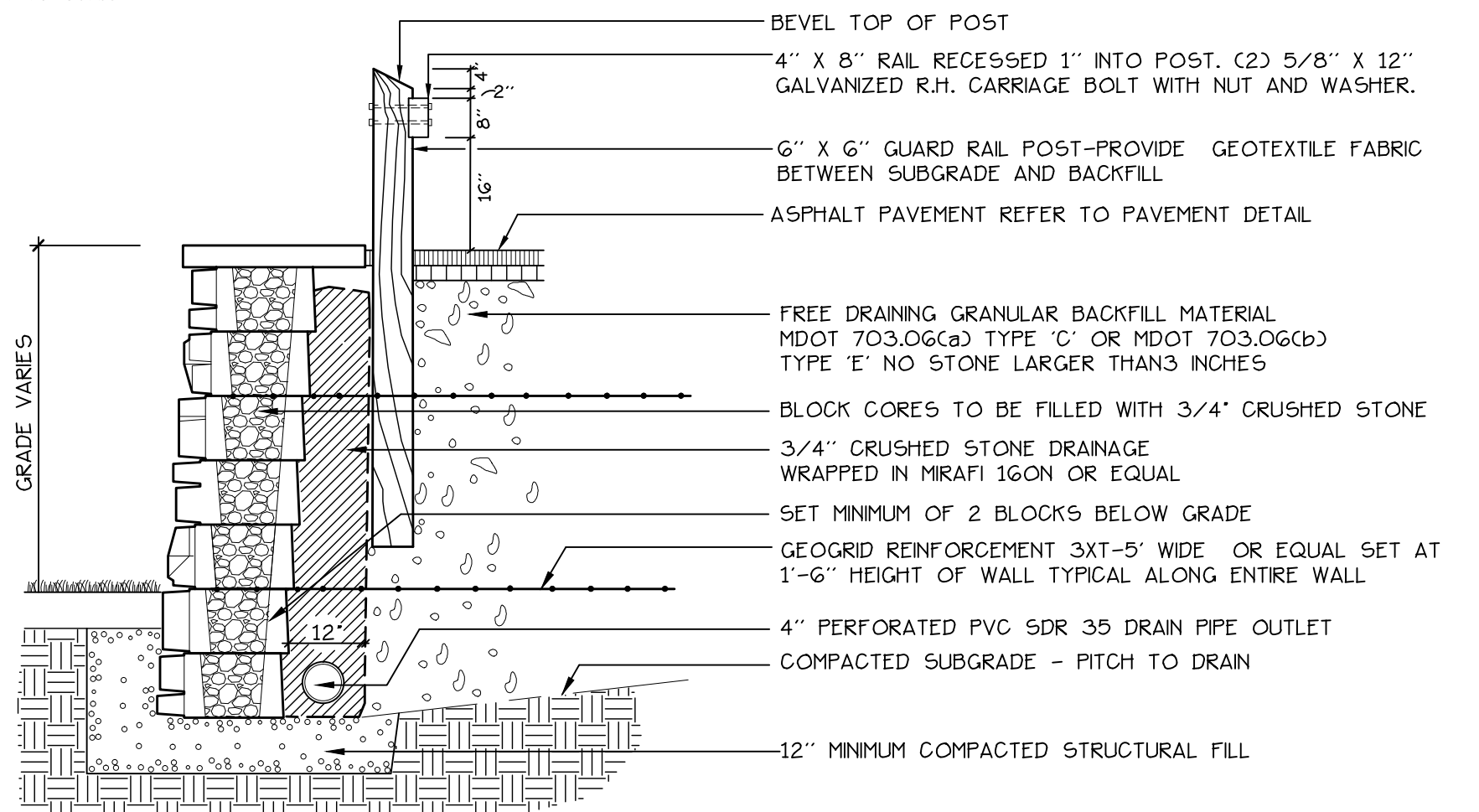

2 LG1 CONCRETE SEGMENTAL RETAINING WALL WITH GUARDRAIL NOT TO SCALE

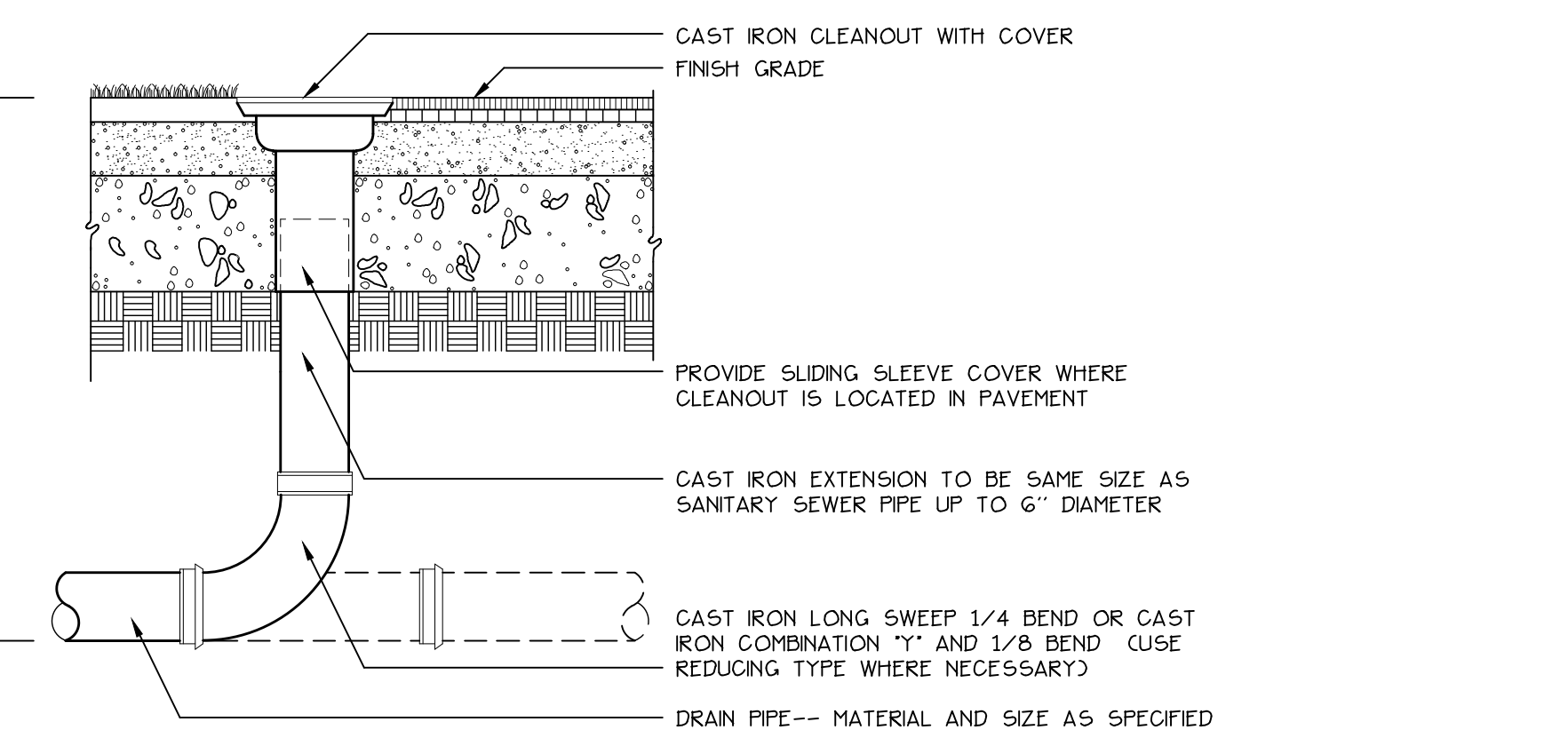

3 LG1 FOUNDATION DRAIN CLEANOUT DETAIL NOT TO SCALE

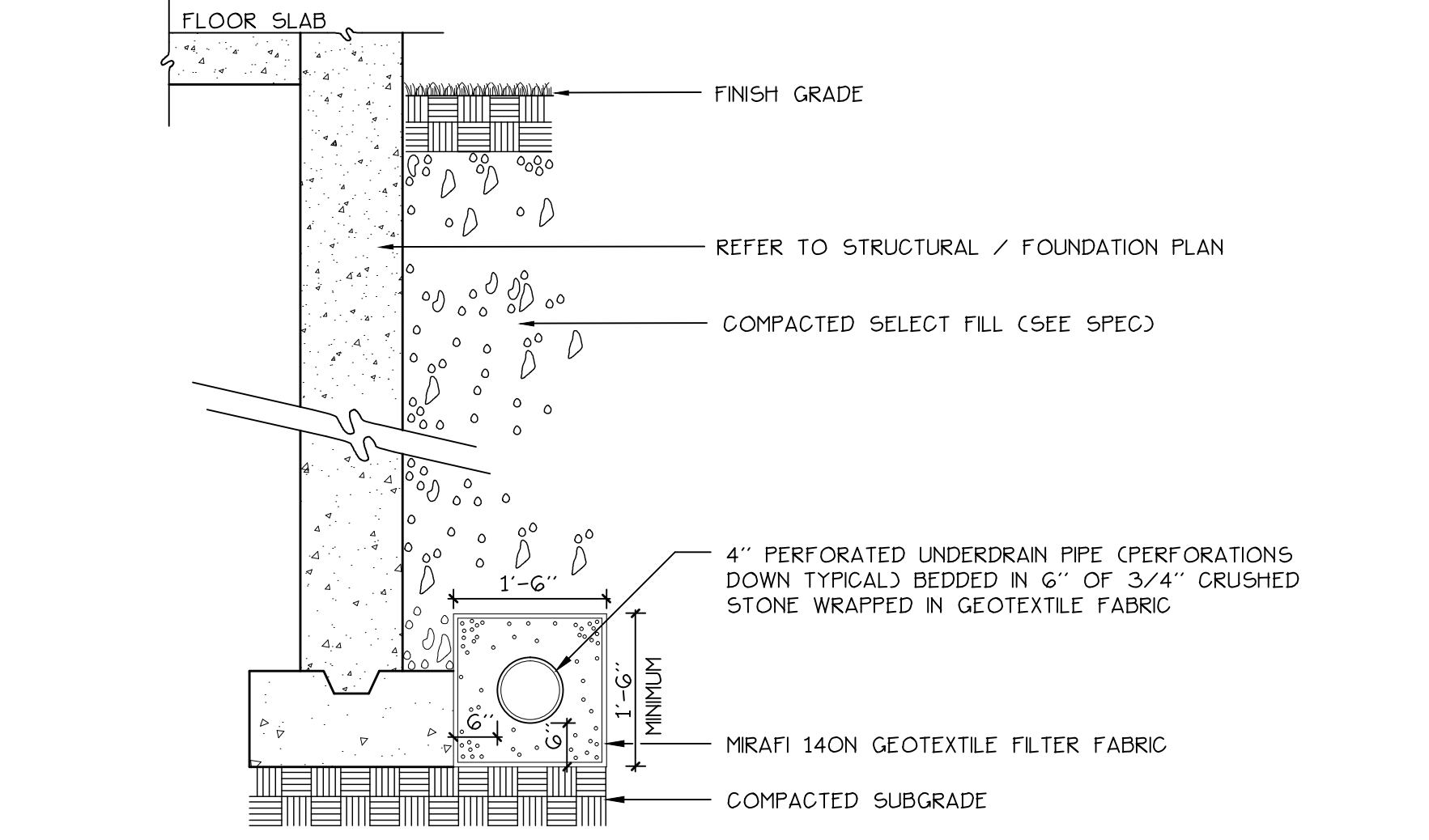

4 LG1 FOUNDATION DRAIN NOT TO SCALE

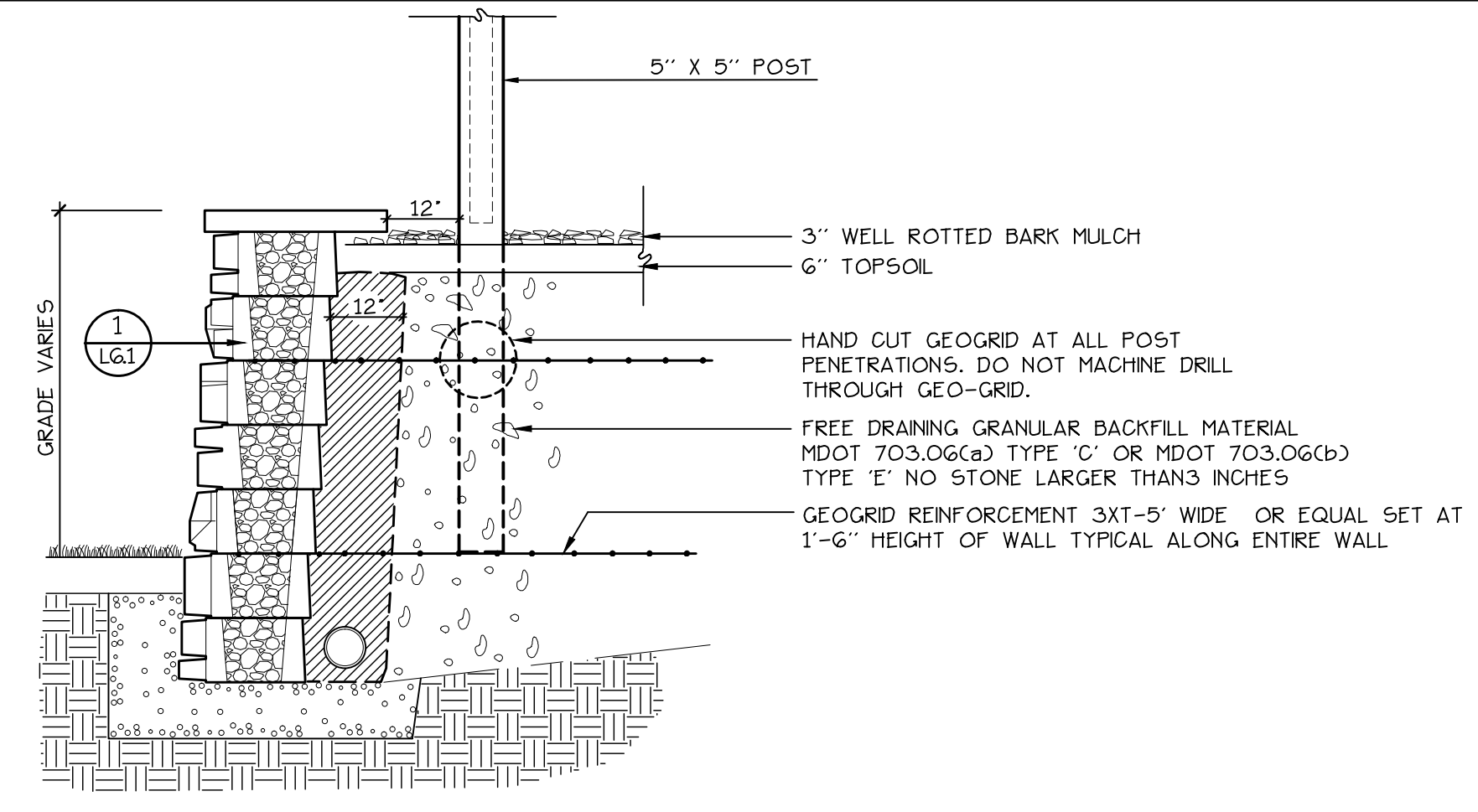

5 LG1 FENCE POSTS AT RETAINING WALL NOT TO SCALE

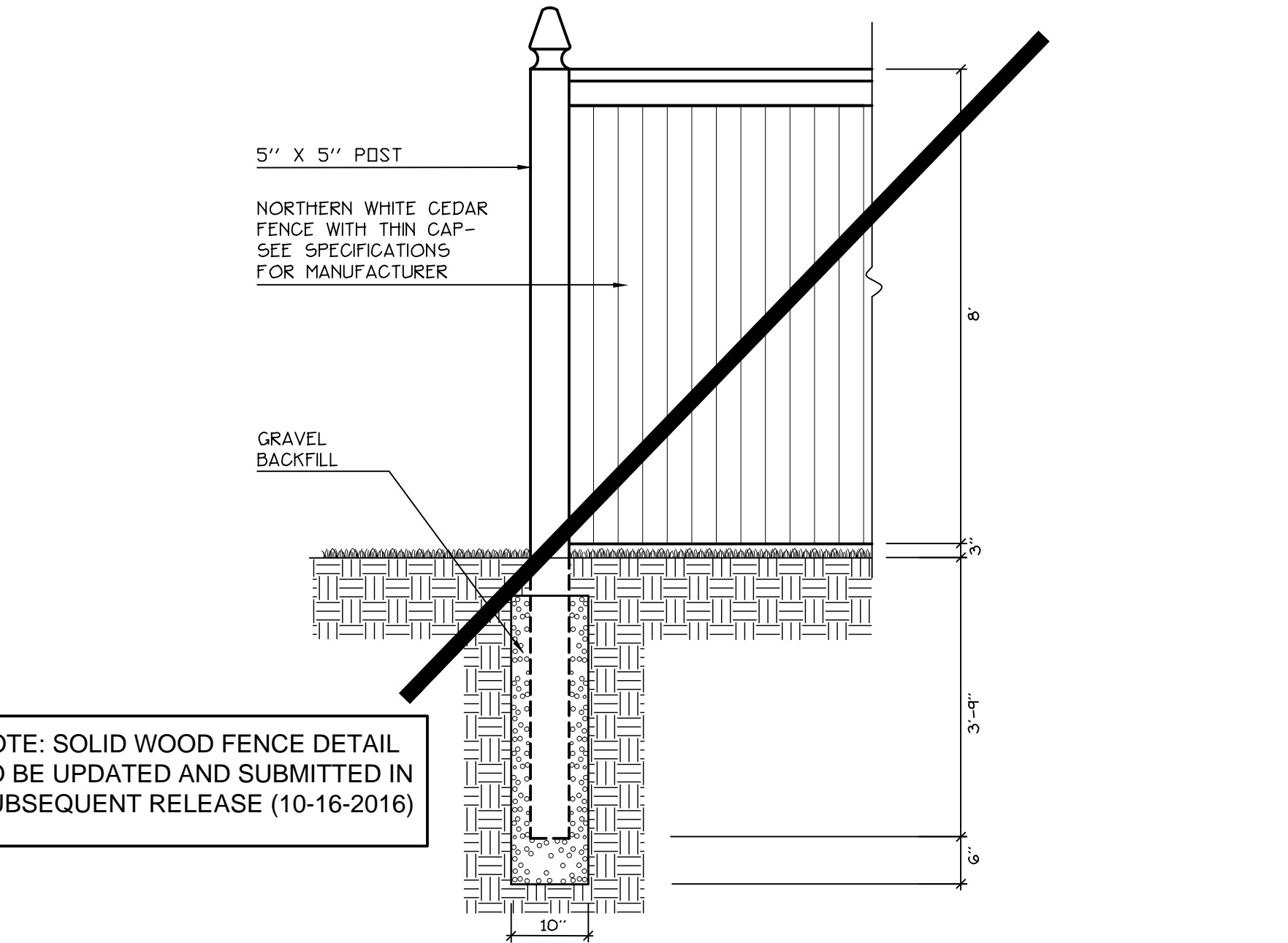

6 LG1 SOLID WOOD FENCE NOT TO SCALE

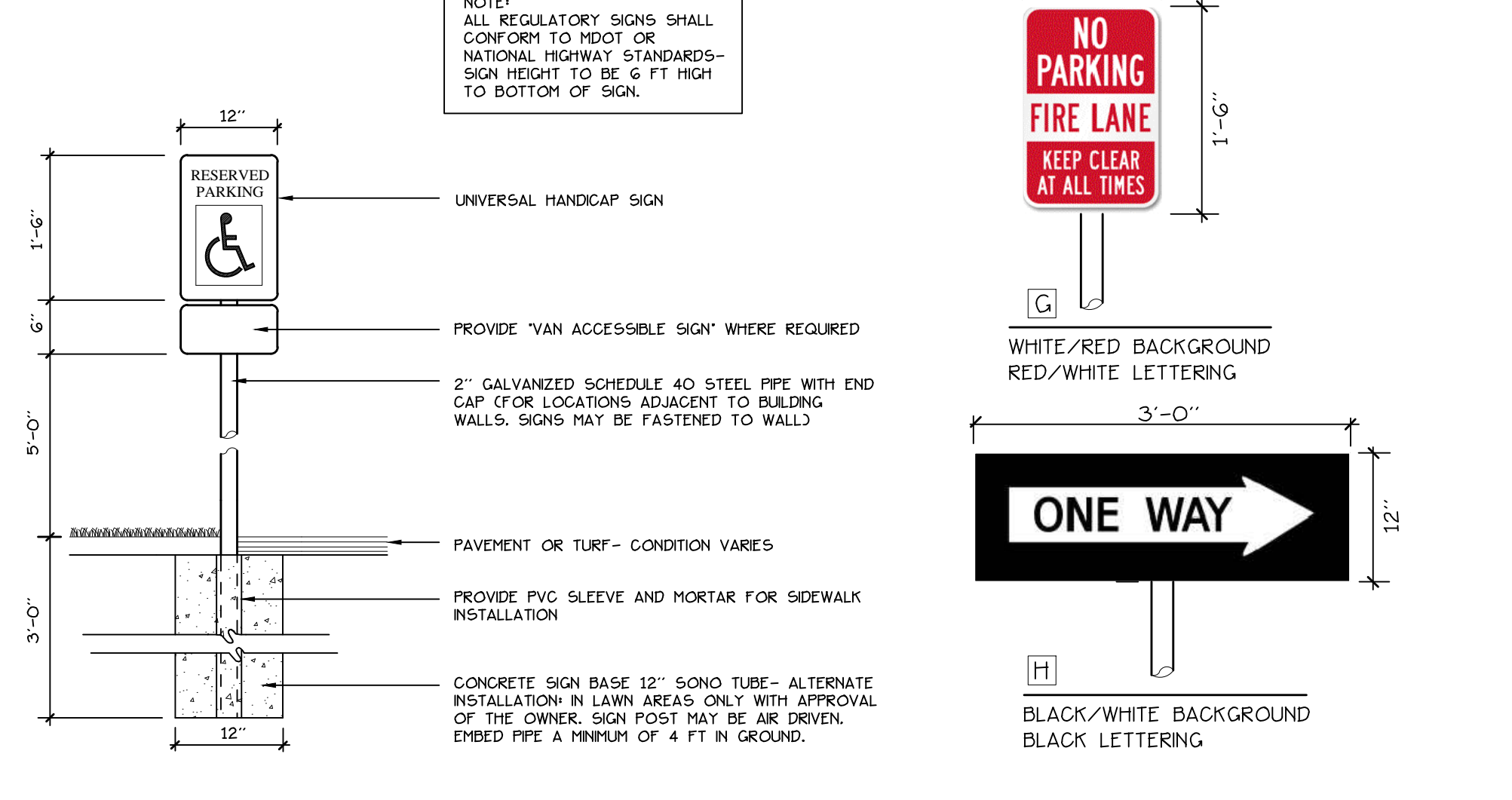
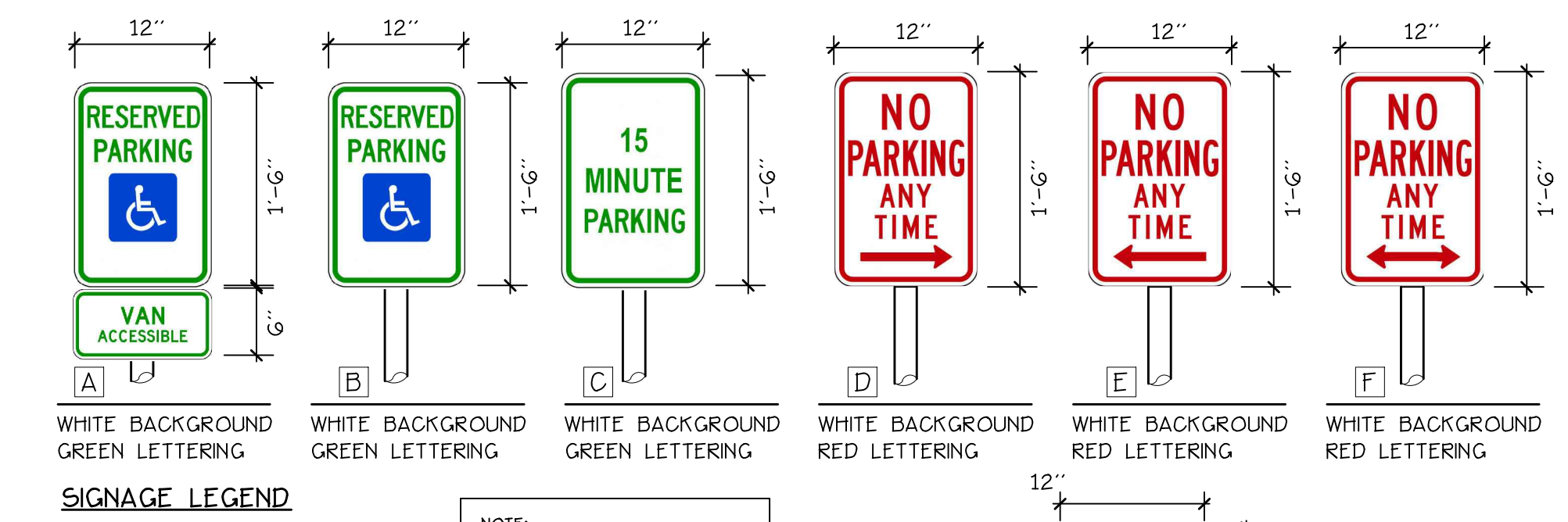

7 LG1 SIGNAGE NOT TO SCALE

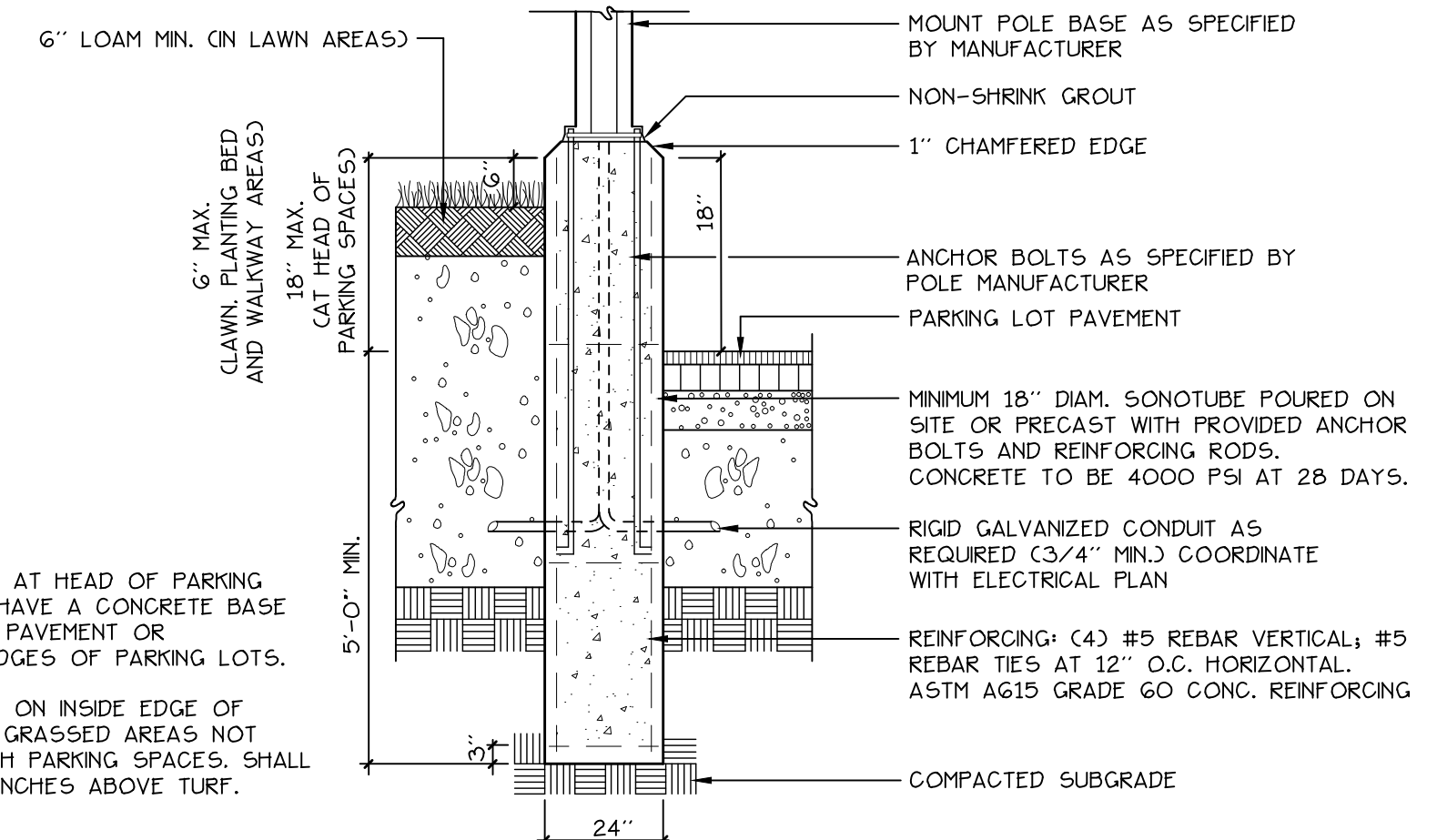

8 LG1 CONCRETE LIGHT POLE BASE NOT TO SCALE

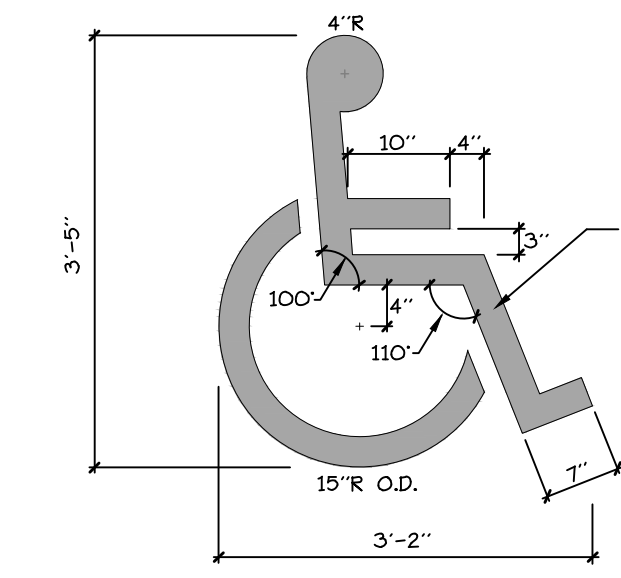

9 LG1 ACCESSIBLE SPACE MARKINGS NOT TO SCALE

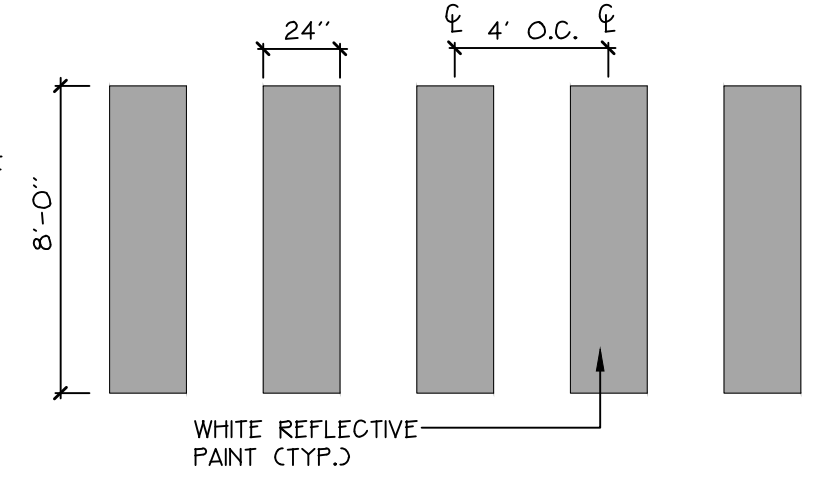

11 LG1 PAINTED CROSSWALK NOT TO SCALE

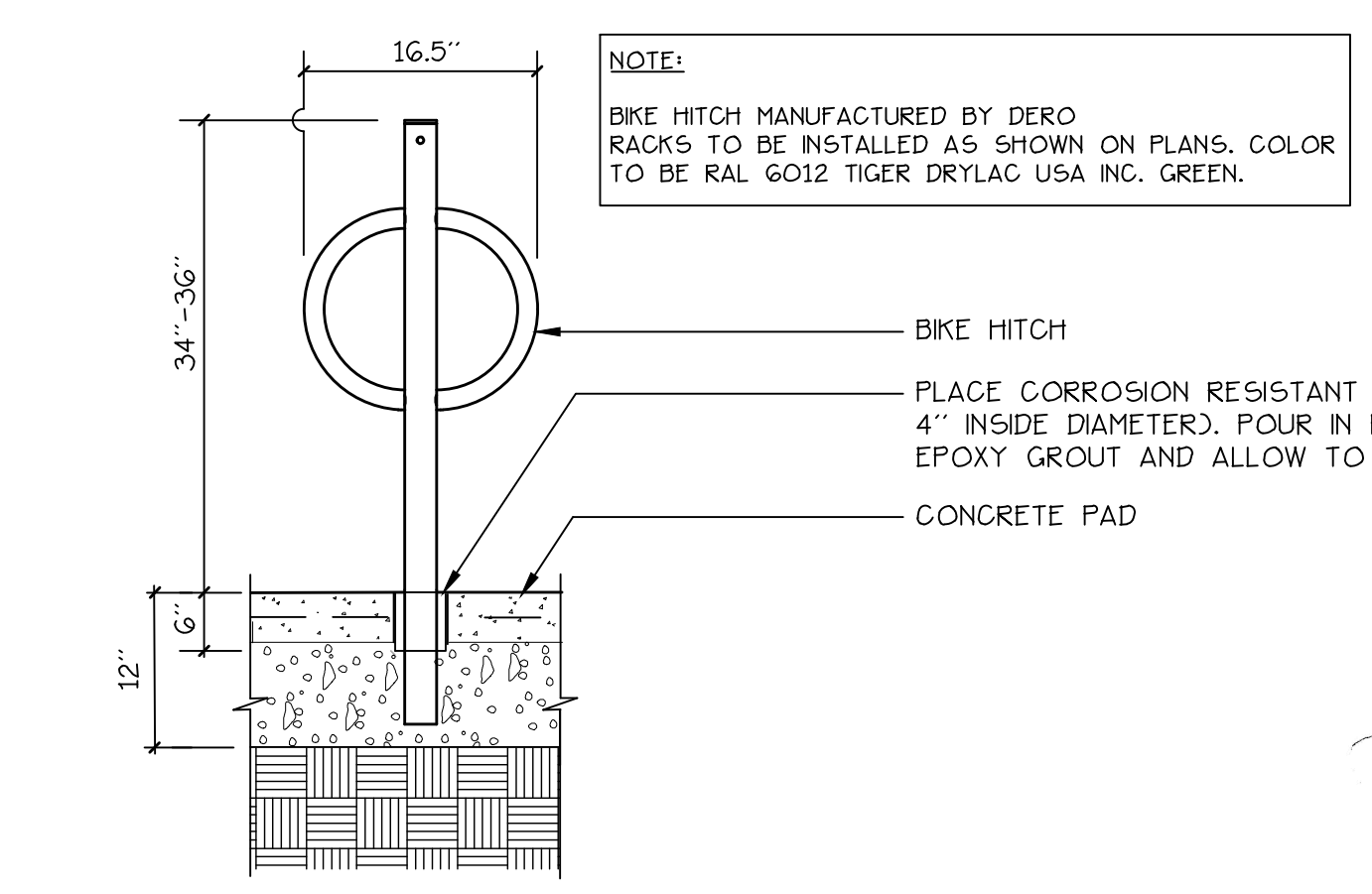

10 LG1 BIKE RACK NOT TO SCALE

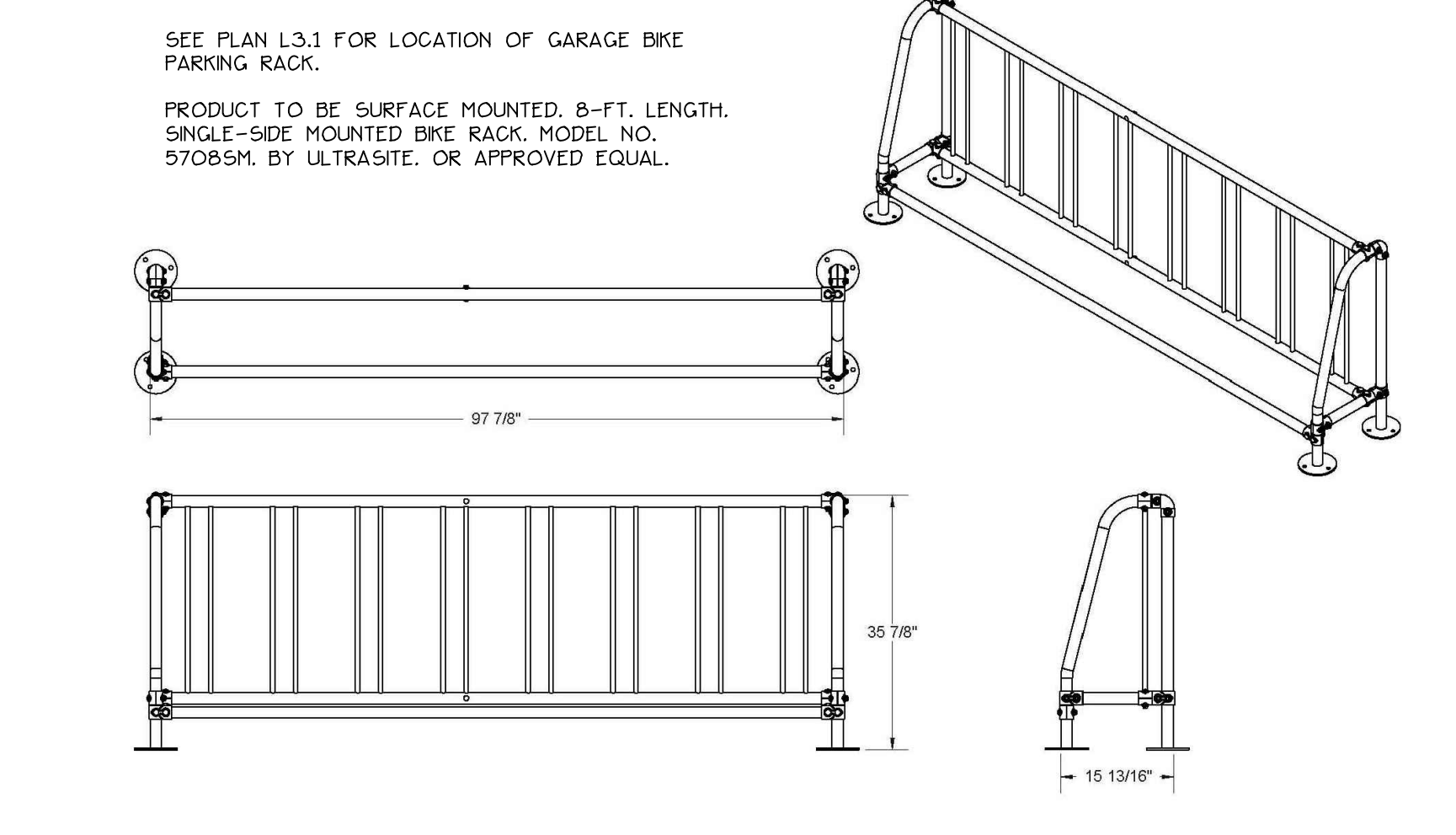

12 LG1 BIKE RACK -- GARAGE NOT TO SCALE

Prepared For:
 Owner:
 Home For The Aged
 777 Stevens Avenue
 Portland, Maine 04103
 Tel.: 207-797-7710

Applicant:
 The Park Danforth
 777 Stevens Avenue
 Portland, Maine 04103
 Tel.: 207-797-7710

Prepared By:
 MITCHELL & ASSOCIATES
 Landscape Architects
 The Staples School
 70 Center Street
 Portland, Maine 04101
 Tel.: 207-774-4427

The Park Danforth
 Portland, Maine
 777 Stevens Avenue

Date:
 OCTOBER 17, 2014

Issued For:
 CONSTRUCTION

Revisions:
 NOV. 25, 2014: Per City of Portland Staff Review Comments
 JAN. 5, 2015: Per City of Portland Staff Review Comments
 APR. 10, 2015: Amended Site Plan and Subdivision Plan
 OCT. 16, 2015: 100% Construction Documents

Reproduction or reuse of this document without the expressed written consent of Mitchell & Associates is prohibited.
 © 2015

Title:
 SITE DETAILS

Scale: AS SHOWN

North:

Sheet No.:
L6.1