

**Allied Engineering**  
 Structural Mechanical Electrical Commissioning

160 Veranda Street  
 Portland, Maine 04103  
 T: 207.231.2349  
 F: 207.231.2346  
 Web: www.allied-eng.com

STATE OF MAINE  
 CATHERINE A. FAUCHER  
 No. 7575  
 LICENSED PROFESSIONAL ENGINEER

Graphic Scale: 1" = 10' 0"

The Park Danforth

777 Stevens Ave, Portland, ME, 04103

NO.	DESCRIPTION	DATE
1	Addendum No 2	2015-06-25

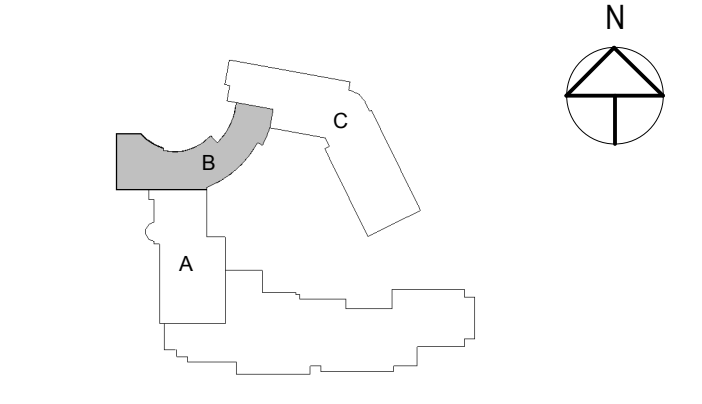

CONTENT:

LEVEL 1 - AUDITORIUM AND CONNECTOR LIGHTING PLAN

DRAWN BY: DLL

PROJECT NO: -

DATE: 06/05/2015

REVISED:

SCALE: AS NOTED

**EL1.1B**

Project Phase  
 100% CONSTRUCTION DOCUMENTS

COPYRIGHT © 2014 BY LAVALLEE BRENSINGER PROFESSIONAL ASSOCIATION. ALL RIGHTS RESERVED. NO REPRODUCTION WITHOUT PERMISSION.

**CIRCUITING NOTES**

ALL LIGHTING ON THIS SHEET SHALL BE CIRCUITED TO PANEL CN1 UNO.

EMERGENCY LIGHTING ON THIS SHEET SHALL BE CIRCUITED TO PANEL GE1.

REFER TO PANEL SCHEDULES.

ENTIRE SHEET ISSUED

- 1 LIGHTING CONTROL SHALL BE AUTO ON/AUTO OFF CEILING SENSOR(S) (NO DETAIL).
- 2 LIGHTING CONTROL SHALL BE DUAL-CIRCUIT SWITCHING WITH 2-BUTTON OCCUPANCY SENSOR - SEE DETAIL A1/EL5.1
- 3 LIGHTING CONTROL SHALL BE DUAL-CIRCUIT SWITCHING WITH AUTO OFF VIA CEILING SENSOR(S) - SEE DETAIL E1/EL5.1
- 4 LIGHTING CONTROL SHALL BE AUTO ON/AUTO OFF WALL SENSOR SWITCH WIRED FOR 3-WAY OPERATION - SEE DETAIL A3/EL5.1
- 5 LIGHTING CONTROL SHALL BE MANUAL ON/AUTO OFF WALL SENSOR SWITCH - SEE DETAIL B4/EL5.1
- 6 LIGHTING CONTROL SHALL BE MANUAL ON/AUTO OFF VIA CEILING SENSOR(S) - SEE DETAIL D1/EL5.1
- 7 LIGHTING CONTROL SHALL BE AUTO ON/AUTO OFF VIA CEILING SENSORS WITH 0-10V DIMMING CONNECTED TO LOAD SIDE OF OCCUPANCY SENSOR RELAY - SEE DETAIL B1/EL5.1
- 8 EMERGENCY SHUNT RELAY CONNECTION DIAGRAM - SEE DETAIL D4/EL5.1
- 9 LIGHTING CONTROLLED FROM LIGHTING CONTROL PANEL - REFER TO LIGHTING CONTROL PANEL SCHEDULES, EMERGENCY LIGHTING SHALL OPERATE CONTINUOUSLY, UNO
- 10 LIGHTING CONTROL SHALL BE MANUAL ON/MANUAL OFF VIA WALL SWITCHES.
- 11 STAIRWAY LIGHTING SHALL OPERATE CONTINUOUSLY
- 12 PROVIDE EMERGENCY SHUNT RELAY TO BYPASS LIGHTING CONTROLS AND FORCE EMERGENCY LIGHTING ON UPON LOSS OF NORMAL POWER - SEE DETAIL D4/EL5.1
- 13 LIGHTING SHALL OPERATE AT 50% OUTPUT WHEN SPACE IS UNOCCUPIED AND SHALL BRIGHTEN TO FULL OUTPUT UPON ACTIVATION OF FIXTURE-MOUNTED DIMMING OCCUPANCY SENSORS.
- 14 LIGHTING SHALL OPERATE CONTINUOUSLY

- 1 LIGHTING SHALL BE CIRCUITED TO PANEL GN1. REFER TO PANEL SCHEDULES.
- 2 WALL MOUNT LIGHT FIXTURE AT 7'-6"

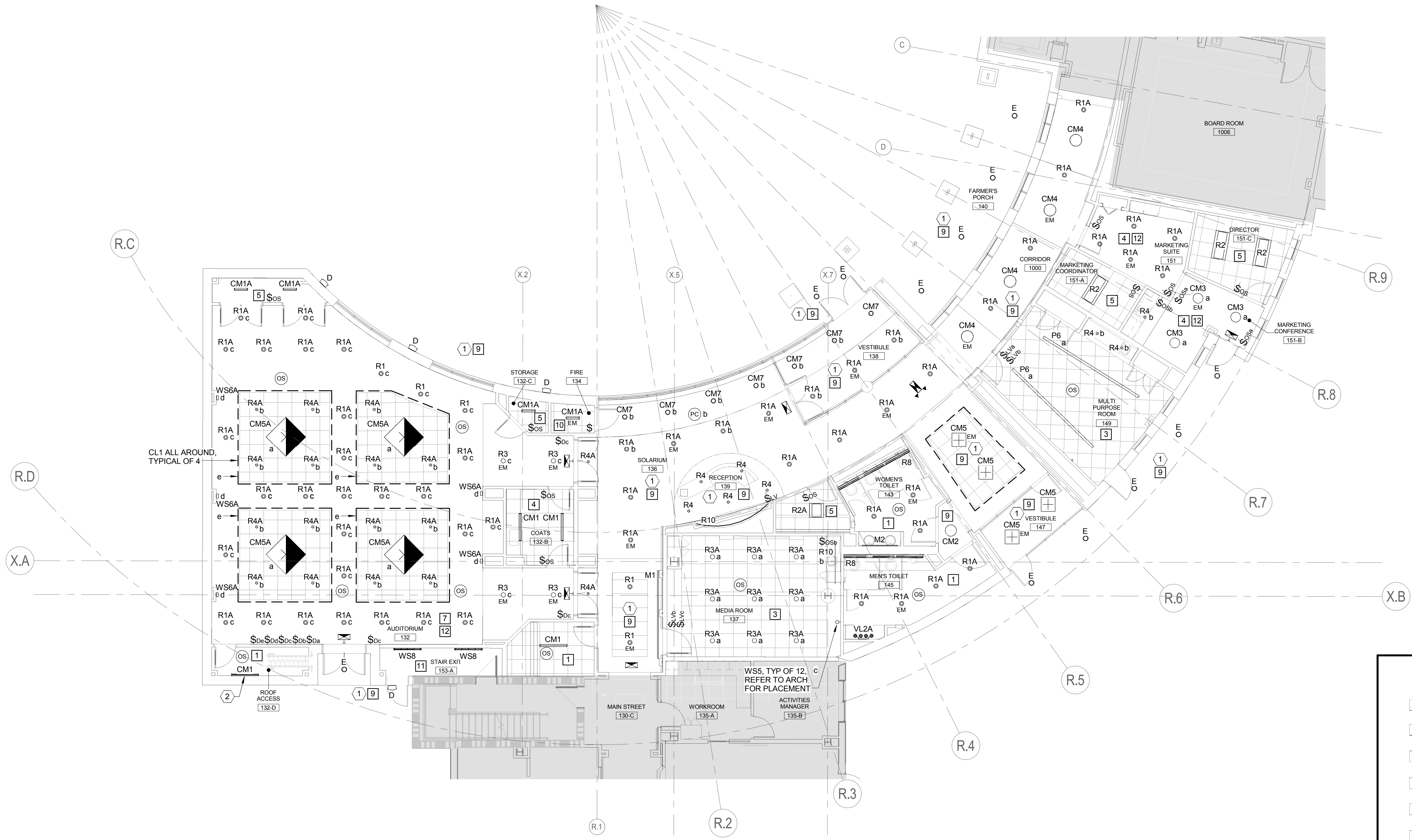

6/29/2015 10:08:38 AM N:\Projects\2014\141018 - Park Danforth\100 Drawing Files - REV\17 2015\141018.rvt