

M1 Mechanical Floor Plan (Sheet M1)

MECHANICAL WORK NOTES

- ◆ CONTRACTOR SHALL RELOCATE EXISTING DEFUSERS OUT OF WALK-IN COOLER AREA. COORDINATE WITH KITCHEN EQUIPMENT DRAWINGS.
- ◆ CONTRACTOR SHALL EXTEND HOT WATER AND COLD WATER TO PROPOSED SINK LOCATION. ROUTE SINK DRAIN TO EXISTING FLOOR SINK. COORDINATE LOCATION WITH KITCHEN EQUIPMENT DRAWINGS.
- ◆ CONTRACTOR SHALL RUN CONDENSATE FROM WALK-IN COOLERS TO EXISTING FLOOR DRAIN. COORDINATE WITH KITCHEN EQUIPMENT DRAWINGS.
- ◆ REWORK SPRINKLER HEADS AS NEEDED FOR NEW FREEZER/COOLER

MECHANICAL GENERAL NOTE

ALL WORK SHALL COMPLY WITH MAINE STATE PLUMBING CODE.

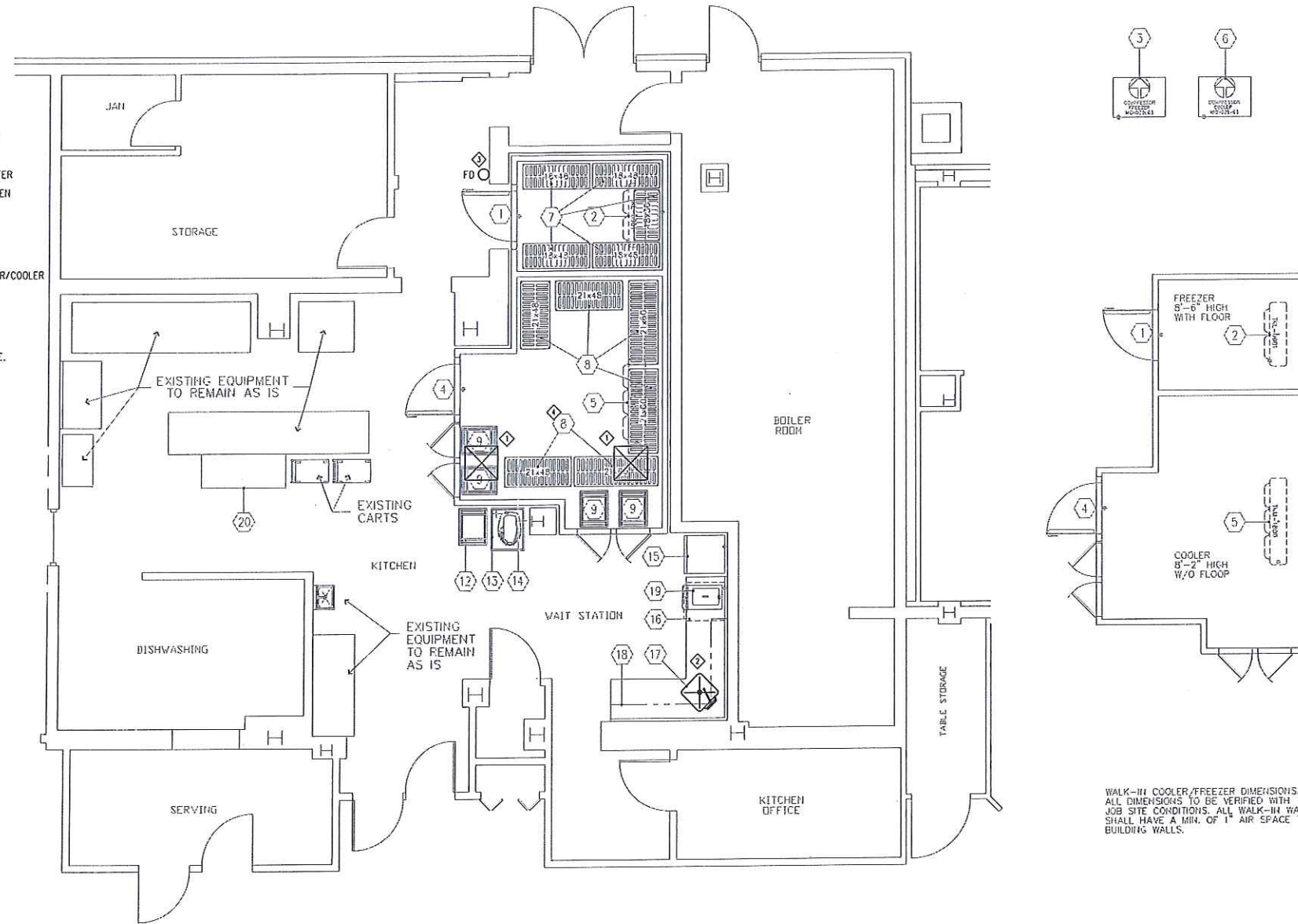

FOODSERVICE EQUIPMENT SCHEDULE

MK.	QTY	DESCRIPTION	ELECTRICAL					WATER		WASTE		GAS		STEAM					MANUFACTURER	MODEL	REMARKS	
			FLAMPS	KW	HP	VOLTS	PHASE	DIRECT	PLUG	COLD	HOT	DIRECT	INDIRECT	SIZE	MBTUH	LBS/HR	PSIG	INLET				RETURN
1	1	WALK-IN FREEZER	4.0			120	1	X												THERMO-KOOL	CUSTOM	
2	1	EVAPORATOR COIL, FREEZER	4.3	0.5		115	1	X				3/4"							THERMO-KOOL	TKL-0901		
3	1	COMPRESSOR, FREEZER	8.8	1.9		208	1	X											THERMO-KOOL	MOH025L63		
4	1	WALK-IN COOLER	12.5		2-1/2	208	3	X											THERMO-KOOL	CUSTOM		
5	1	EVAPORATOR COIL, COOLER	4.0			120	1	X				3/4"							THERMO-KOOL	TKM-1800		
6	1	COMPRESSOR, COOLER	2.7	0.2		115	1	X											THERMO-KOOL	MOH025X63		
7	5	SHELVING UNIT	11.3		2-1/2	208	3	X											CAMBRO	ELEMENTS SERIES		
8	7	SHELVING UNIT																	CAMBRO	ELEMENTS SERIES		
9	4	SHEET PAN RACK																	NEW AGE	4339	WITH 6" HIGH LEGS WITH FLANGED FEET	
10	-	- SPARE NUMBER -																				
11	-	- SPARE NUMBER -																				
12	1	SHEET PAN RACK (EXISTING)																	UNKNOWN	UNKNOWN		
13	1	MIXER STAND																	ADVANCE/TABCO	MX-SS-302	WITH CASTERS, TWO LOCKING	
14	1	MIXER, 20-QUART (EXISTING)	8.0		1/2	115	1	X											HOBART	A-200		
15	1	REFRIGERATOR, 1-SECTION (EXISTING)	7.6		1/3	115	1	X											TRUE	T-23		
16	1	FREEZER, UNDERCOUNTER (EXISTING)	6.0		1/4	115	1	X											BEVERAGE AIR	UCF27A		
17	1	WORK TABLE WITH SINK							1/2"	1/2"		2"							FABRICATED	CUSTOM		
18	3	WALL SHELF "L"																	FABRICATED	CUSTOM		
19	1	SOFT SERVE MACHINE	15.0			208	3	X											SANISERV	401		
20	1	WORK COUNTER																	ADVANCE/TABCO	EB-SS-245-M		

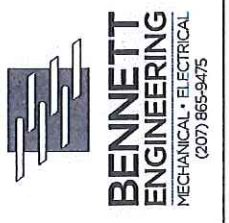

THE PARK DANFORTH
WALK IN FREEZER RENOVATIONS
111 STEVENS AVE. PORTLAND, MAINE 04103
MECHANICAL MODIFICATIONS

Date Drawn - 03/01/13

Drawn By - bwt

Revised -

Project # 3402

Scale - 1/4" = 1'-0"

Sheet Number - M1