

**1 FOOD SERVICE PLAN**

Scale: 1/4" = 1'-0"

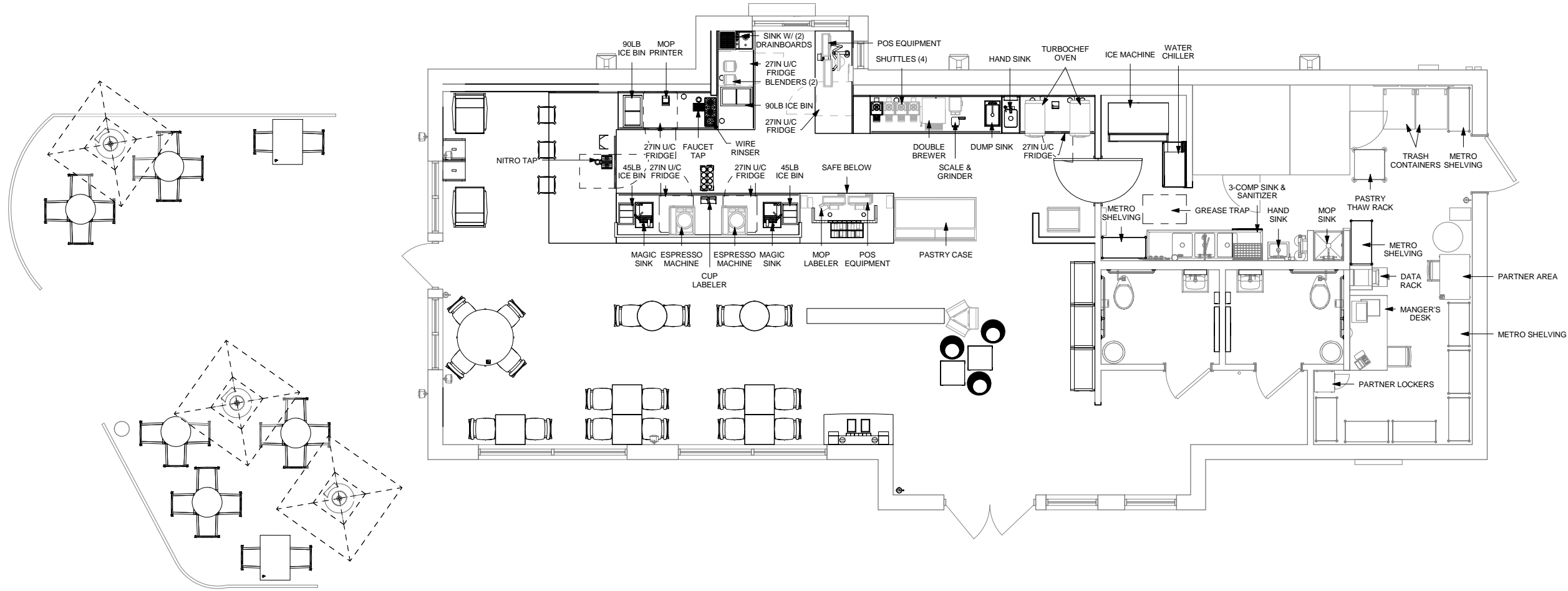

**DESIGN DEVELOPMENT ONLY - NOT INTENDED FOR CONSTRUCTION USE**



**STARBUCKS COFFEE COMPANY**  
 2401 UTAH AVENUE SOUTH  
 SEATTLE, WASHINGTON 98134  
 (206) 319-1575

THESE DRAWINGS AND SPECIFICATIONS ARE CONFIDENTIAL AND SHALL REMAIN THE SOLE PROPERTY OF STARBUCKS CORPORATION, WHICH IS THE OWNER OF THE COPYRIGHT IN THIS WORK. THEY SHALL NOT BE REPRODUCED (IN WHOLE OR IN PART), SHARED WITH THIRD PARTIES OR USED IN ANY MANNER ON OTHER PROJECTS OR EXTENSIONS TO THIS PROJECT WITHOUT THE PRIOR WRITTEN CONSENT OF STARBUCKS CORPORATION. THESE DRAWINGS AND SPECIFICATIONS ARE INTENDED TO EXPRESS DESIGN INTENT FOR A PROTOTYPICAL STARBUCKS STORE (WHICH IS SUBJECT TO CHANGE AT ANYTIME) AND DO NOT REFLECT ACTUAL SITE CONDITIONS. NEITHER PARTY SHALL HAVE ANY OBLIGATION NOR LIABILITY TO THE OTHER (EXCEPT STATED ABOVE) UNTIL A WRITTEN AGREEMENT IS FULLY EXECUTED BY BOTH PARTIES.

STARBUCKS TEMPLATE VERSION I2016.12.23

**NORR**

ARCHITECTS PLANNERS  
 325 N. LaSalle St., Suite 500 | Chicago, IL 60654  
 1.312.424.2400 | www.norr.com

ENGINEER OF RECORD

William J. Abmayor, P.E.  
 263 Marshall Avenue  
 St. Louis, Missouri 63119  
 Phone (314) 772-1782  
 Fax (314) 772-0908

Engineering Consultant



PROJECT NAME:  
**RENOVATION OF STARBUCKS COFFEE PORTLAND, 1080 FOREST AVE.**  
 PROJECT ADDRESS:  
 1080 FOREST AVENUE  
 PORTLAND, ME 04103  
 CUMBERLAND COUNTY

STORE #: 11917  
 PROJECT #: 37548-037  
 ISSUE DATE: 08/23/2017  
 PROGRAM MANAGER: J. BOND  
 DESIGNER: A. LEE  
 LEED® AP: N/A  
 PRODUCTION DESIGNER: E. VEGA  
 CHECKED BY: P. BENVENUTO

Revision Schedule			
Rev	Date	By	Description

SHEET TITLE:  
**FOOD SERVICE PLAN**

SCALE: AS SHOWN

SHEET NUMBER:  
**I-1105.1**

