

# ABBREVIATIONS

|  |   |
|--|---|
| 3PL THIRD PARTY LOGISTICS                | HC HOLLOW CORE                                    |
| A/C AIR CONDITIONING                     | HDW HARDWARE                                      |
| ACT ACOUSTICAL CEILING TILE              | HM HOLLOW METAL                                   |
| ADJ ADJUSTABLE                           | HRZ HORIZONTAL                                    |
| AFF ABOVE FINISHED FLOOR                 | HR HOUR   |
| AMP AMPERE                               | HT HEIGHT   |
| ARCH ARCHITECT                           | HVAC "HEATING, VENTILATING, AND AIR CONDITIONING" |
| BOH BACK OF HOUSE                        | ID INSIDE DIAMETER                                |
| CAB CABINET                              | LL LANDLORD                                       |
| CL CENTER LINE                           | MAX MAXIMUM                                       |
| CLG CEILING                              | MEP "MECHANICAL, ELECTRICAL, AND PLUMBING"        |
| CM CONSTRUCTION MANAGER                  | MFR MANUFACTURER                                  |
| CTR CENTER                               | MIN MINIMUM                                       |
| CX COMMISSIONING                         | NIC NOT IN CONTRACT                               |
| CXA COMMISSIONING AGENT                  | NL NIGHT LIGHT                                    |
| DEG DEGREE                               | NTS NOT TO SCALE                                  |
| DET DETAIL                               | OC ON CENTER                                      |
| DIA DIAMETER                             | OD OUTSIDE DIAMETER                               |
| DIM DIMENSION                            | OF/CI OWNER FURNISHED/CONTRACTOR INSTALLED        |
| DM DESIGN MANAGER                        | OF/OI OWNER FURNISHED/OWNER INSTALLED             |
| DN DOWN                                  | PD PRODUCTION DESIGNER                            |
| EA EACH                                  | PLC PLACE   |
| EL ELEVATION                             | PM PROJECT MANAGER                                |
| EQ EQUAL                                 | R RADIUS  |
| EXIST EXISTING                           | ROM RENOVATIONS CONSTRUCTION MANAGER              |
| EXT EXTERIOR                             | REF REFERENCE                                     |
| FF&E "FURNITURE, FIXTURE, AND EQUIPMENT" | REQ(D) REQUIRE(D)                                 |
| FIO FURNISHED AND INSTALLED BY OWNER     | REV REVISION                                      |
| FLR FLOOR                                | RND ROUND   |
| FOH FRONT OF HOUSE                       | SB STARBUCKS                                      |
| FT FOOT/FEET                             | SC SOLID CORE                                     |
| G GROUND                                 | SF SQUARE FEET                                    |
| GC GENERAL CONTRACTOR                    | SHT SHEET   |
|  | SIM SIMILAR                                       |
|  | SPEC SPECIFICATION                                |
|  | SQ SQUARE   |
|  | TEMP TEMPORARY                                    |
|  | TYP TYPICAL                                       |
|  | UON UNLESS OTHERWISE NOTED                        |
|  | VD VENDOR DIRECT                                  |
|  | VERT VERTICAL                                     |
|  | VIF VERIFY IN FIELD                               |

# LEGEND:

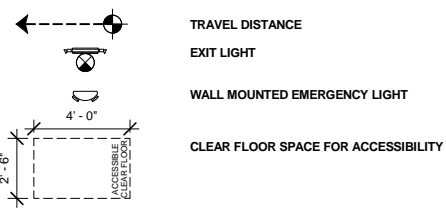

# FLAME SPREAD RATING:

FLAME SPREAD RATING FOR ALL PROPOSED INTERIOR FINISHES SHALL COMPLY WITH LOCAL BUILDING CODE.

# INTERIOR FINISH NOTES:

- INTERIOR WALL AND CEILING FINISH MATERIALS SHALL BE CLASS C WITH FLAME SPREAD RATING LESS THAN 200 AND SMOKE DEVELOPED LESS THAN 450
- FLOOR COVERINGS IN THE EXIT PATH OF ALL COMMON AREAS SHALL MEET CLASS A REQUIREMENTS.

# EXIT DIRECTION SIGN NOTES:

- INDICATED INSCRIPTION, ARROWS, AND SINGLE OR DOUBLE FACED AS SHOWN. SHADED QUADRANTS INDICATE DIRECTION OF LIGHTED FACES.
- ALL EXIT SIGNS SHALL COMPLY WITH LOCAL RULES AND ORDINANCES AND MEET OSHA REQUIREMENTS.
- GC SHALL VERIFY TYPE OF MOUNTING WITH CONSTRUCTION MANAGER FOR ALL EXIT SIGNS PRIOR TO ORDERING.

# ACCESSIBILITY KEY:

- (A) ACCESSIBLE SEAT REQUIREMENTS:  
(26) INTERIOR SEATS: 23 X 0.05 = 2 ACCESSIBLE SEATS PROVIDED  
(28) EXTERIOR SEATS: 23 X 0.05 = 2 ACCESSIBLE SEATS PROVIDED
- (B) DINING SURFACE AT ADA TABLE BETWEEN 28IN AND 34IN AFF
- (C) 30" X 48" CLEAR FOR WHEELCHAIR ACCESS
- (D) 32" MINIMUM CLEAR AT DOOR
- (E) LEVEL LANDING THRESHOLD
- (F) POS, BARISTA HAND-OFF PLANE, AND CONDIMENT COUNTERTOP ARE 2' - 10" AFF FOR WHEELCHAIR ACCESSIBILITY.
- (G) 60" DIAMETER CLEAR FOR WHEELCHAIR ACCESS.

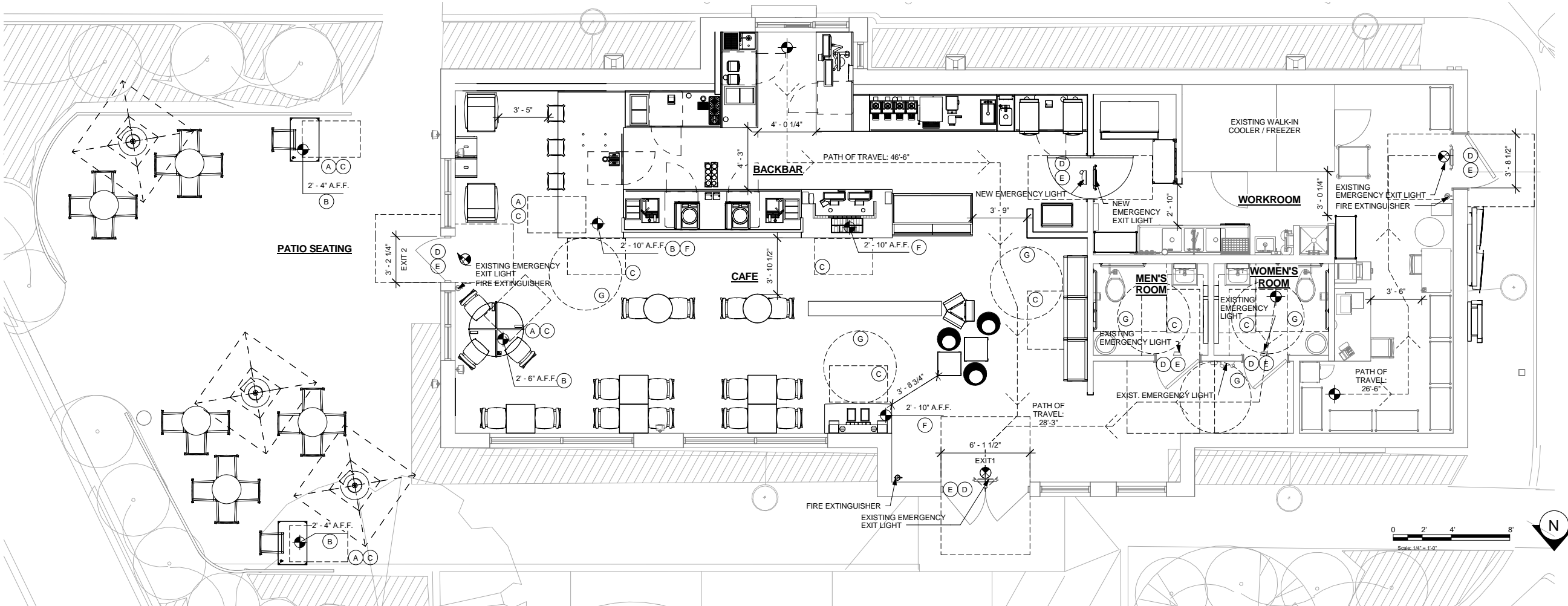

# 4 LIFE SAFETY PLAN

Scale: 1/4" = 1'-0"

ISSUE FOR CONSTRUCTION 08/23/2017



**STARBUCKS COFFEE COMPANY**  
2401 UTAH AVENUE SOUTH  
SEATTLE, WASHINGTON 98134  
(206) 318-1575

THESE DRAWINGS AND SPECIFICATIONS ARE CONFIDENTIAL AND SHALL REMAIN THE SOLE PROPERTY OF STARBUCKS CORPORATION, WHICH IS THE OWNER OF THE COPYRIGHT IN THIS WORK. THEY SHALL NOT BE REPRODUCED (IN WHOLE OR IN PART), SHARED WITH THIRD PARTIES OR USED IN ANY MANNER ON OTHER PROJECTS OR EXTENSIONS TO THIS PROJECT WITHOUT THE PRIOR WRITTEN CONSENT OF STARBUCKS CORPORATION. THESE DRAWINGS AND SPECIFICATIONS ARE INTENDED TO EXPRESS DESIGN INTENT FOR A PROTOTYPICAL STARBUCKS STORE (WHICH IS SUBJECT TO CHANGE AT ANYTIME) AND DO NOT REFLECT ACTUAL SITE CONDITIONS. NEITHER PARTY SHALL HAVE ANY OBLIGATION NOR LIABILITY TO THE OTHER (EXCEPT STATED ABOVE) UNTIL A WRITTEN AGREEMENT IS FULLY EXECUTED BY BOTH PARTIES.

STARBUCKS TEMPLATE VERSION i2016.12.23

# NORR

ARCHITECTS PLANNERS  
325 N. LaSalle St., Suite 500 | Chicago, IL 60654  
1.312.424.2400 | www.norr.com

# ENGINEER OF RECORD

William J. Abmayor, P.E.  
303 Marshall Avenue  
St. Louis, Missouri 63119  
Phone (314) 772-1782  
Fax (314) 772-0208  
Engineering Consultant



PROJECT NAME:  
**RENOVATION OF STARBUCKS COFFEE PORTLAND, 1080 FOREST AVE.**

PROJECT ADDRESS:  
1080 FOREST AVENUE  
PORTLAND, ME 04103  
CUMBERLAND COUNTY

STORE #: 11917  
PROJECT #: 37548-037  
ISSUE DATE: 08/23/2017  
PROGRAM MANAGER: J. BOND  
DESIGNER: A. LEE  
LEED® AP: N/A  
PRODUCTION DESIGNER: E. VEGA  
CHECKED BY: P. BENVENUTO

| Revision Schedule |      |    |             |
|-------------------|------|----|-------------|
| Rev               | Date | By | Description |
|                   |      |    |             |

SHEET TITLE:  
**LIFE SAFETY PLAN**

SCALE: AS SHOWN

SHEET NUMBER:  
**G-0005**