

Inspection Services  
Samuel P. Hoffsee  
Chief



Planning and Urban Development  
Joseph E. Gray Jr.  
Director

CITY OF PORTLAND

November 7, 1991

Ms. Rebecca Rice  
Susan Eklund  
1135 Forest Ave  
Portland, ME

Re: 1135 Forest Ave

Dear Ms. Rice & Ms. Eklund,

Your application to erect a lighted sign 4 X 6 has been reviewed and a permit is herewith issued subject to the following requirement:

1. This permit is being issued with the understanding that a licensed Master Electrician will wire this proposed signage.

If you have any questions regarding this requirement, please do not hesitate to contact this office.

Sincerely,

*P. Samuel Hoffsee*  
P. Samuel Hoffsee  
Chief of Inspection Services

cc: Sven Borglund, Chief Electrical Inspector

Susan's Fish N Chips 878-3240  
1135 Forest Ave Portland ME 04103

45 FT

SUSAN fish n Chips

66 FT

Below  
existing  
sign

SUSAN'S

Side walk

Forest St

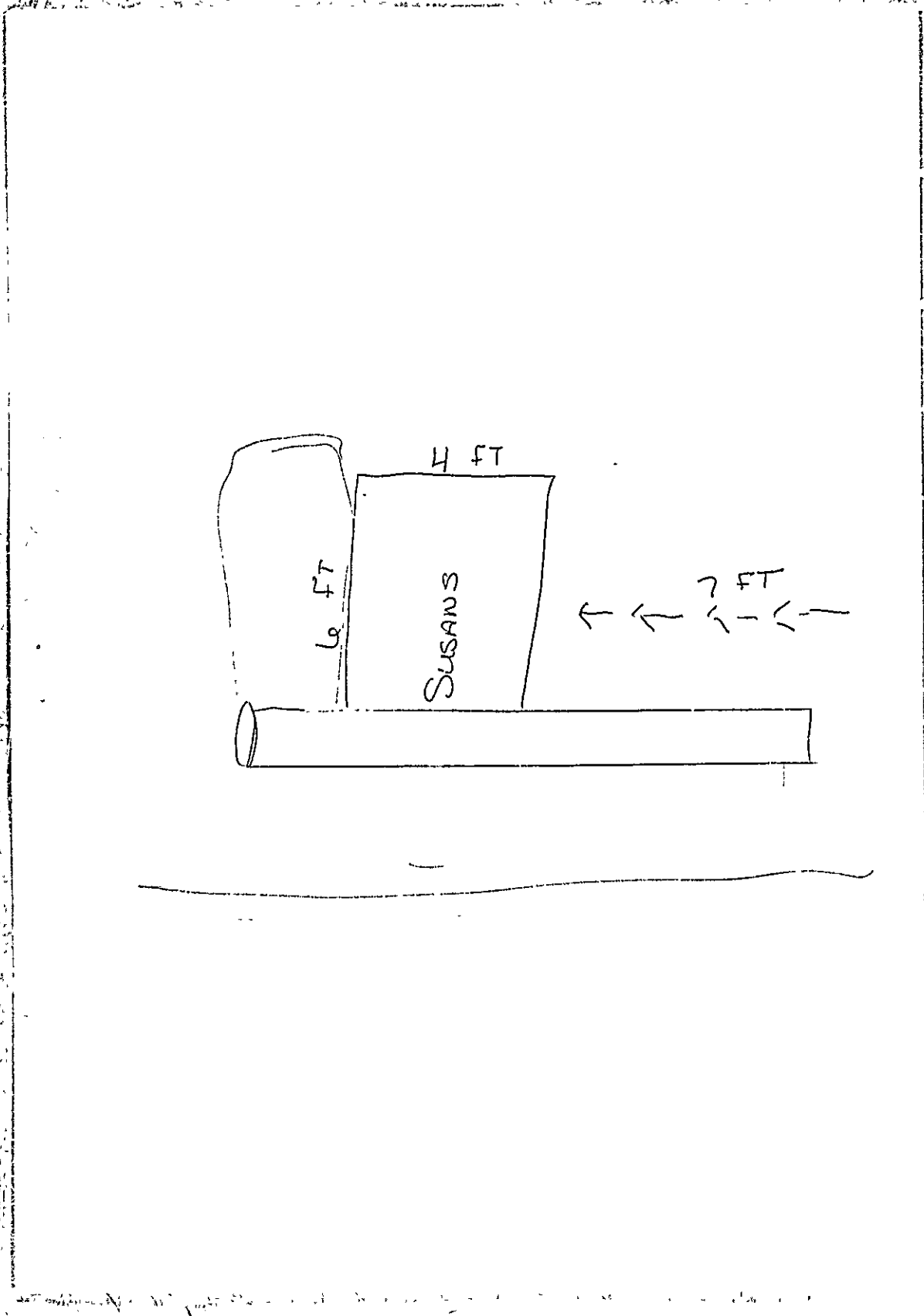

**NORTH EAST INSURANCE COMPANY**  
HOME OFFICE, PORTLAND, MAINE

**COMMERCIAL GENERAL LIABILITY COVERAGE PART  
DECLARATIONS**

Renewal of Number:

Policy No. **CPP 1512**

Named Insured and Mailing Address (No., Street, Town or City, County, State, Zip Code)\*

Policy Period\*: From \_\_\_\_\_ to \_\_\_\_\_ at 12:01 A.M. Standard Time at your mailing address shown above.

IN RETURN FOR THE PAYMENT OF THE PREMIUM, AND SUBJECT TO ALL THE TERMS OF THIS POLICY, WE AGREE WITH YOU TO PROVIDE THE INSURANCE AS STATED IN THIS POLICY.

**LIMITS OF INSURANCE**

General Aggregate Limit (Other Than Products—Completed Operations)	\$ 600,000
Products—Completed Operations Aggregate Limit	\$ 600,000
Personal and Advertising Injury Limit	\$ 300,000
Each Occurrence Limit	\$ 300,000
Fire Damage Limit	\$ 50,000 Any One Fire
Medical Expense Limit	\$ 5,000 Any One Person

**RETROACTIVE DATE (CG 00 02 only)**

Coverage A of this Insurance does not apply to "bodily injury" or "property damage" which occurs before the Retroactive Date, if any, shown here: \_\_\_\_\_  
(Enter Date or "None" if no Retroactive Date applies)

**DESCRIPTION OF BUSINESS AND LOCATION OF PREMISES**

Form of Business:  
 Individual     Joint Venture     Partnership     Organization (Other than Partnership or Joint Venture)  
 Business Description\*:

Location of All Premises %    or    Occupy:  
 1135 Forest Avenue  
 Portland, Maine

**PREMIUM**

Classification	Code No.	Premium Basis	Rate		Advance Premium	
			Pr/Co	All Other	Pr/Co	All Other
Restaurants-with no sale of alcoholic beverages-without dance floor	16814	60,000	1.162	11.271¢	296.00	\$ 676.00 (Min Prem)

Total Advance Premium \$296.00    676.00

Premium shown is payable\*: \$ 972.00 at inception;\$    1st Anniversary;\$    2nd Anniversary

**FORMS AND ENDORSEMENTS**

Forms and Endorsements applying to this Coverage Part and made part of this policy at time of issue:  
 CG0001(11/88) CG2137(11/85)  
 CG0037(10/80) CG2407(11/85)

Courtersigned\*:

By *Lowell*  
 Authorized Representative

\*Entry optional if shown in Common Policy Declarations  
 Forms and Endorsements applicable to this Coverage Part omitted if shown elsewhere in the policy.

THESE DECLARATIONS AND THE COMMON POLICY DECLARATIONS, IF APPLICABLE, TOGETHER WITH THE COMMON POLICY CONDITIONS, COVERAGE FORMS) AND FORMS AND ENDORSEMENTS, IF ANY, ISSUED TO FORM A PART THEREOF, COMPLETE THE ABOVE NUMBERED POLICY

WRITTEN CONSENT AND AGREEMENT RELATING TO A CERTAIN SIGN PROPOSED  
TO BE ERECTED PROJECTING OVER A PUBLIC SIDEWALK FROM THE PREMISES  
AT 1135 FOREST AVE IN PORTLAND, MAINE

Rebecca Rice being the owner of the premises  
at 1135 FOREST AVE in Portland, Maine hereby  
gives consent to the erection of a certain sign owned by  
SUSAN EKLAND projecting over the public  
sidewalk from said premises as described in application to the  
Inspector of Buildings of Portland, Maine for a permit to cover  
erection of said sign;

And in consideration of the issuance of said permit  
Rebecca Rice, owner of said premises,  
in event said sign shall cease to serve the purpose for which  
it was erected or shall become dangerous and in event the owner  
of said sign shall fail to remove said sign or make it permanently  
safe in case the sign still serves the purpose for which it was  
erected, hereby agrees for himself or itself, for his heirs,  
its successors, and his or its assigns, to completely remove  
said sign within ten days of notice from said Inspector of  
Buildings that said sign is in such condition and of order from  
him to remove it.

In Witness whereof, the owner of said premises has signed this  
consent and agreement this Rebecca Rice day of  
October 30, 1991.

389 CONGRESS STREET • PORTLAND MAINE 04111 • TELEPHONE (207) 775-5451

cc: Lt. James P. Collins, Fire Prevention Bureau

/s/

P. Samuel Holmes  
Chief of Inspection Services

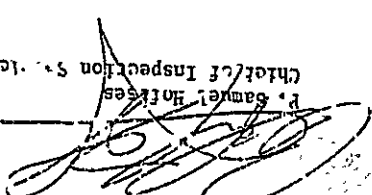

Sincerely,

If you have any questions on this requirement, please call this office.  
exterior. There shall be no communication with the first floor.  
hour fire rated construction and shall terminate at the building  
1. The stairwell which serves this new or proposed area shall be one (1)  
building permit is herewith issued subject to the following requirement:

Your application to remove 15' X 32' canopy on front of building and to  
construct a 20' X 20' second story addition, has been reviewed and a

New England Bldgs.  
P.O. Box 1248  
Portland, Maine

Dear Sir:

RE: 1139 Forest Avenue, Portland, Maine

April 2, 1987

DEPARTMENT OF PLANNING & URBAN DEVELOPMENT  
INSPECTION SERVICES DIVISION



CITY OF PORTLAND



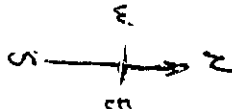

Forest ave

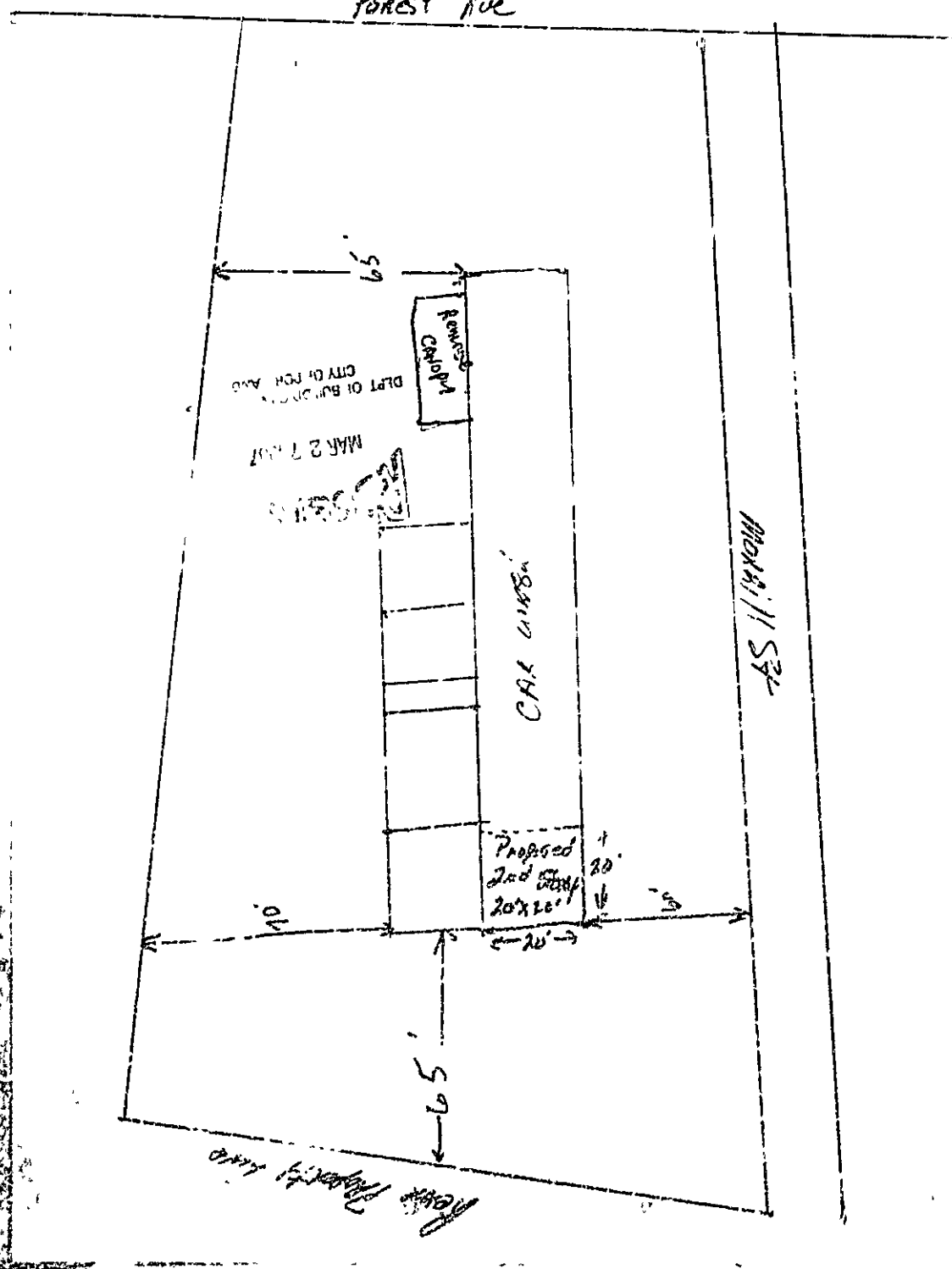

DEPT OF BUILDING AND  
MAR 27 1987

POWERED  
CANTINA

CRA 4188a

MORRIS ST

Proposed  
2nd Story  
20x20

New Property Line





**APPLICATION FOR PERMIT**  
**DEPARTMENT OF PERMITS AND LICENSING**  
**ELECTRICAL**

Date: 10/6/92  
 Self and Permit Number: 7765

To the CHIEF ELECTRICAL INSPECTOR, Portland, Oregon  
 The undersigned hereby applies for a permit to make alterations in accordance with the laws of  
 the City of Portland, Oregon, the Portland Electrical Ordinance, the National Electrical Code and the following specifications:

LOCATION OF WORK: 1139 Forest Ave  
 OWNER'S NAME: Classy Chassis Car Wash ADDRESS: \_\_\_\_\_

	FEES
<b>OUTLETS:</b>	
Receptacles _____ Switches _____ Plug.nold _____ ft. TOTAL _____	
<b>FIXTURES (number of)</b>	
Incandescent _____ Fluorescent _____ (not strip) TOTAL _____	
Strip Fluorescent _____ ft _____	
<b>SERVICES:</b>	
Overhead _____ Underground _____ Temporary _____ TOTAL amperes _____	
<b>METERS (number of)</b> <u>1</u> _____	<u>1.00</u>
<b>MOTORS (number of)</b>	
Fractional _____	
1 HP or over _____	
<b>RESIDENTIAL HEATING:</b>	
Oil or Gas (number of units) _____	
Electric (number of rooms) _____	
<b>COMMERCIAL OR INDUSTRIAL HEATING:</b>	
Oil or Gas (by a main boiler) _____	
Oil or Gas (by separate units) _____	
Electric Under 20 kws _____ Over 20 kws _____	
<b>APPLIANCES: (number of)</b>	
Ranges _____ Water Heaters _____	
Cook Tops _____ Disposals _____	
Wall Ovens _____ Dishwashers _____	
Dryers _____ Compactors _____	
Fans _____ Others (denote) _____	
<b>TOTAL</b> _____	
<b>MISCELLANEOUS (number of)</b>	
Branch Panels _____	
Transformers _____	
Air Conditioners Central Unit _____	
Separate Units (windows) _____	
Signs 20 sq. ft. and under _____	
Over 20 sq. ft. _____	
Swimming Pools Above Ground _____	
In Ground _____	
Fire/Burglar Alarms Residential _____	
Commercial _____	
Heavy Duty Outlets, 220 Volt (such as welders) 30 amps and under _____	
over 30 amps _____	
Circus, Fairs, etc. _____	
Alterations to wires <u>x relocate mater. to outside</u> _____	<u>5.00</u>
Repairs after fire _____	
Emergency Lights, battery _____	
Emergency Generators _____	

FOR ADDITIONAL WORK NOT ON ORIGINAL PERMIT INSTALLATION FEE DUE \_\_\_\_\_  
 FOR REMOVAL OF A "STOP ORDER" (304-10 b) DOUBLE FEE DUE \_\_\_\_\_

TOTAL AMOUNT DUE: 15.00  
 minimum fee

INSPECTION: Will be ready on 10/7 - 10 am if possible or Will Call 10/7 - 9 am - Thank you  
 CONTRACTOR'S NAME: T. A. Napolitano Inc  
 ADDRESS: Box 2501 - So. Plld  
 TEL.: 799-0538  
 MASTER LICENSE NO. #7765 SIGNATURE OF CONTRACTOR: [Signature]  
 LIMITED LICENSE NO. \_\_\_\_\_

INSPECTOR'S COPY — WHITE  
 OFFICE COPY — CANARY  
 CONTRACTOR'S COPY — GREEN

Inspection Services  
Samuel P. Hoffses  
Chief



Planning and Urban Development  
Joseph E. Gray Jr.  
Director

CITY OF PORTLAND

146-11-12

April 8, 1974

RE: 1135 Forest Avenue  
Submeter Application

Susan Eklund  
1135 Forest Avenue  
Portland, ME 04103

Dear Susan,

We are returning a copy of your submeter application. As the Code Enforcement Officer explained to you, your ice machine can not be submetered because it can be shown that water from that line drains into the sewerage system. This is not allowed.

We are in the process of refunding your \$20.00 fee.

If you have any other questions, do not hesitate to call.

Very truly yours,

Marge Schmuckal  
Asst. Chief of Inspection Services

/el