

145-B-42

746 Stevens

Ave

Conditional Use

UNE

145-B-42

746 Stevens

Ave

Conditional Use

UNE

L:\PROJECTS\2000031\2000031 C1.dwg Tue Nov 07 13:18:55 2000 COPYRIGHT 2000 TAYLOR ENGINEERING ASSOCIATES

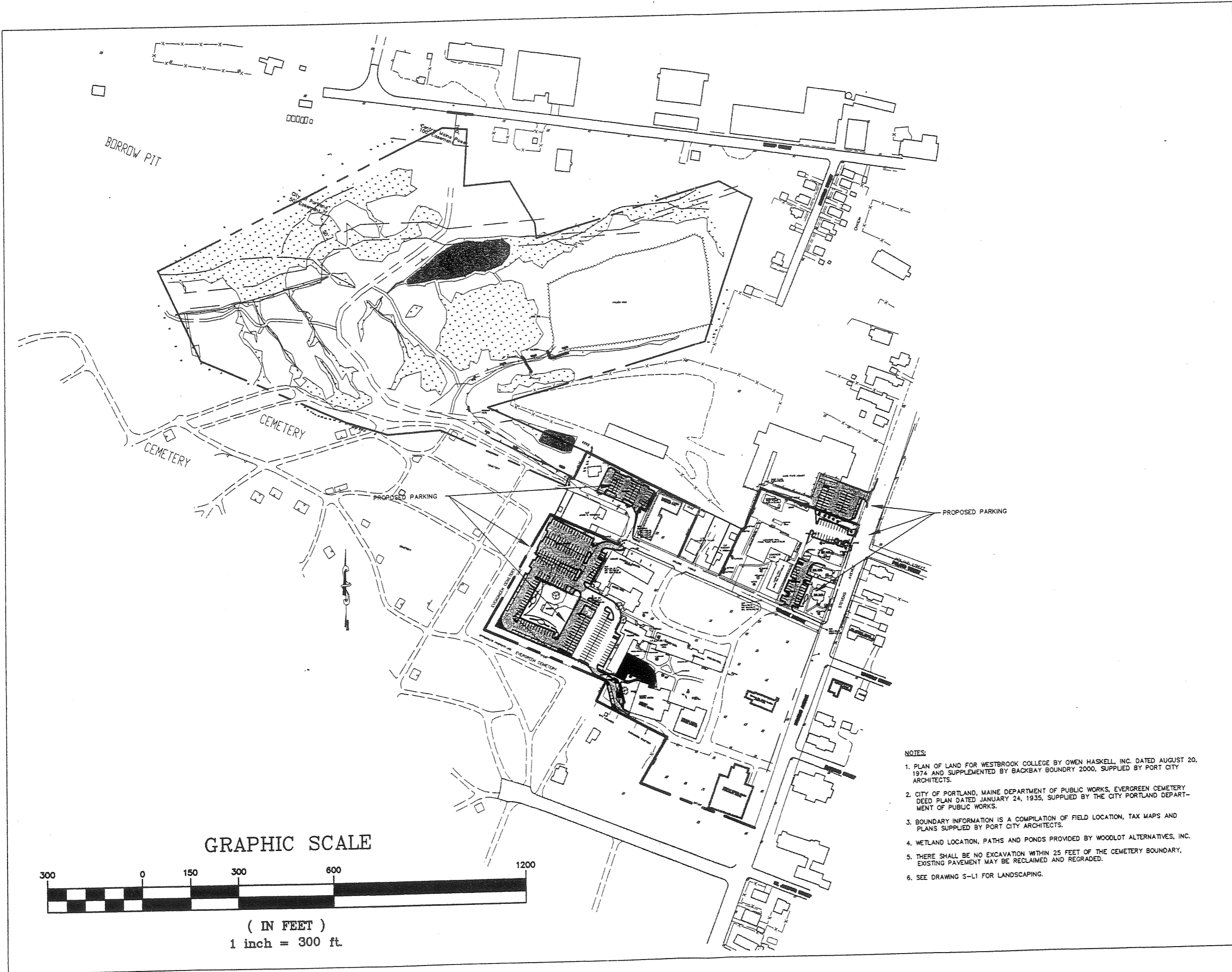

GRAPHIC SCALE



( IN FEET )  
1 inch = 300 ft.

NOTES:

1. PLAN OF LAND FOR WESTBROOK COLLEGE BY OWEN HASKELL, INC. DATED AUGUST 20, 1974 AND SUPPLEMENTED BY BACKBAY BOUNDARY 2000, SUPPLIED BY PORT CITY ARCHITECTS.
2. CITY OF PORTLAND, MAINE DEPARTMENT OF PUBLIC WORKS, EVERGREEN CEMETERY DEED PLAN DATED JANUARY 24, 1935, SUPPLIED BY THE CITY PORTLAND DEPARTMENT OF PUBLIC WORKS.
3. BOUNDARY INFORMATION IS A COMPILATION OF FIELD LOCATION, TAX MAPS AND PLANS SUPPLIED BY PORT CITY ARCHITECTS.
4. WETLAND LOCATION, PATHS AND PONDS PROVIDED BY WOODLOT ALTERNATIVES, INC.
5. THERE SHALL BE NO EXCAVATION WITHIN 25 FEET OF THE CEMETERY BOUNDARY, EXISTING PAYEMENT MAY BE RECLAIMED AND REGRADED.
6. SEE DRAWING S-11 FOR LANDSCAPING.

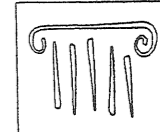

PORT CITY  
ARCHITECTURE  
65 NEWBURY STREET  
PORTLAND, ME 04101  
207.761.9000  
fax 761.2010  
info@portcityarch.com

© COPYRIGHT  
Reuse or reproduction  
of the contents of this  
document is not per-  
mitted without the  
written permission of  
Port City  
ARCHITECTURE PA



College of Health Professions  
Building Renovation  
University of New England, Westbrook College Campus

JOB 99506

ISSUE DATE	
PRELIM	11-7-00
APRVL	
BID	
C.D.S	
REVISION I	
PRINT	

OVERALL  
SITE  
PLAN

SK-C-1

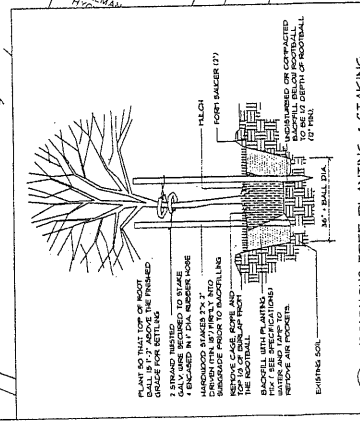
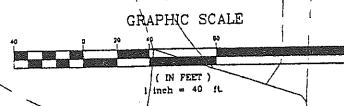
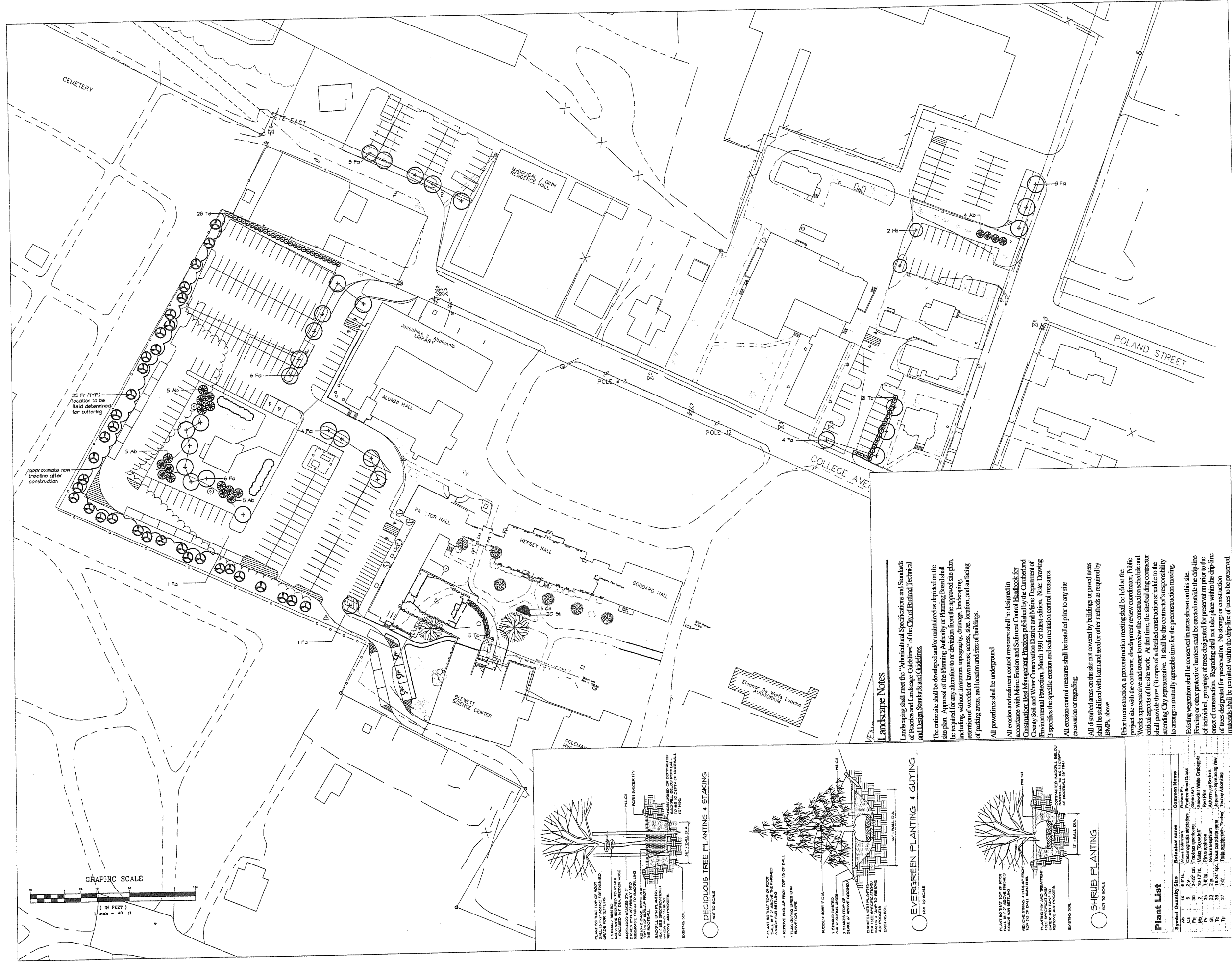

DECIDUOUS TREE PLANTING & STAKING  
NOT TO SCALE

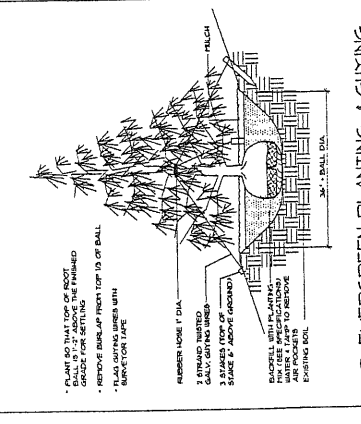

EVERGREEN PLANTING & GUTTING  
NOT TO SCALE

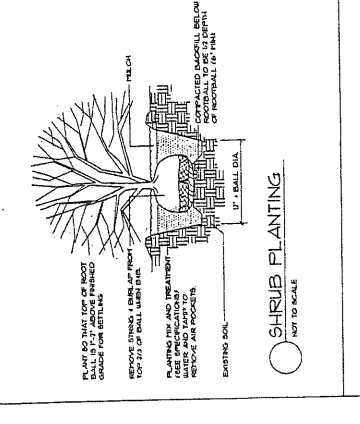

SHRUB PLANTING  
NOT TO SCALE

**Landscaping Notes**

Landscaping shall meet the "Arboreal Specifications and Standards of Practice and Landscape Guidelines" of the City of Portland, Technical and Design Standards and Guidelines.

The entire site shall be developed and/or maintained as depicted on the site plan. Approval of the Planning Authority or Planning Board shall be required for any alteration to or deviation from the approved site plan, including, without limitation, topography, drainage, landscaping, retention of wooded or lawn areas, access, size, location, and surfacing of parking areas, and location and size of buildings.

All pavements shall be underground.

All erosion and sediment control measures shall be designed in accordance with Maine Erosion and Sediment Control Handbook for Construction, Best Management Practices published by the Cumberland County Soil and Water Conservation District and Maine Department of Environmental Protection, March 1991 or latest edition. Note: Drawing 3 specifies the specific erosion and sedimentation control measures.

All erosion control measures shall be installed prior to any site excavation or regrading.

All disturbed areas on the site not covered by buildings or paved areas shall be stabilized with loam and seed or other methods as required by BMPs, above.

Prior to construction, a preconstruction meeting shall be held at the project site with the contractor, development review coordinator, Public Works representative and owner to review the construction schedule and critical aspects of the site work. At that time, the site/building contractor shall provide three (3) copies of a detailed construction schedule to the attending City representative. It shall be the contractor's responsibility to arrange a mutually agreeable time for the preconstruction meeting.

Existing vegetation shall be conserved in areas shown on this site. Fencing or other protective barriers shall be erected outside the drip-line of individual groupings of trees designated for preservation prior to the onset of construction. Regrading shall not take place within the drip-line of trees designated for preservation. No storage or construction materials shall be permitted within the drip-line of trees to be preserved.

**Plant List**

Symbol	Quantity	Size	Botanical Name	Common Name
C	5	8" H.	Aster laevis	Bluestem
Ch	5	2 1/2' H.	Chamaenerion strictum	Fraser Red Gages
F	30	2 1/2' H.	Fragaria virginiana	Wild Strawberry
Fl	35	7 1/2' H.	Floribunda	Snowball White Crabapple
P	20	2 1/2' H.	Prunella	Red Plum
S	20	2 1/2' H.	Solanum elaeagnifolium	Aurum-leaf Solanum
T	27	2 1/2' H.	Thuja occidentalis	Tricky
				Tricky Abonitas

PORT CITY ARCHITECTURE  
65 NEWBURY STREET  
PORTLAND, ME 04101  
207.761.9000  
fax: 761.2010  
info@portcityarch.com

COPYRIGHT  
Reuse or reproduction of the contents of this document is not permitted without written permission of PORT CITY ARCHITECTURE, P.A.

tjd&a  
TERRANCE J. DAVEN & ASSOCIATES  
LANDSCAPE ARCHITECTS & PLANNERS  
121 WEST MAIN STREET, PORTLAND, ME 04101  
TEL: 207.761.2010  
WWW.TJDANDASSOCIATES.COM



College of Health Professions  
Campus Renovations  
University of New England, Westbrook College Campus

JOB: 99506

ISSUE DATE	
PRELIM.	8-14-00
APRVL.	-
BID	-
C.D.'s	-
REVISION 3	10-13-00
PRINT	10-13-00

CAMPUS LANDSCAPE PLAN  
SK-SL-1