

DESIGNED BY: JEG  
 DRAWN BY: MJC  
 CHECKED BY: DMM  
 PROJECT: 21502.10

UNIVERSITY OF NEW ENGLAND  
 PORTLAND CAMPUS  
 STEVEN AVENUE ARMORY  
 716 STEVENS AVE  
 PORTLAND, MAINE 04103  
 (207) 283-0171

RENOVATIONS TO THE  
 STEVENS AVENUE ARMORY

STAIR S02  
 MASONRY  
 WALL  
 ELEVATIONS

SCALE: AS NOTED  
 DATE: 05-24-16  
 DWG. SF203  
 SHEET: 34 OF 169

**DRAWING NOTES:**

- COORDINATE EXACT SIZE AND LOCATION OF MASONRY OPENINGS WITH ARCHITECTURAL PLANS.
- LAP SPLICE #5'S = 1'-8".

**KEYNOTES: (THIS SHEET ONLY)**

- △ CONTINUOUS HORIZONTAL JOINT REINFORCEMENT AT 1'-4" ON-CENTER.
- △ 8" REINFORCED CMU LINTEL WITH (1) #5. EXTEND REINFORCING 2'-0" PAST OPENING, UNLESS NOTED OTHERWISE.
- △ CONTINUOUS 8" CMU BOND BEAM WITH (1) #5.
- △ (1) #5 VERTICAL IN JAMBS. EXTEND REINFORCING 2'-0" PAST OPENING IN EACH DIRECTION.
- △ #5'S VERTICAL AT 2'-8" ON-CENTER. GROUT ALL CELLS SOLID.
- △ #5 DOWELS, 3'-0" LONG, SPACING TO MATCH VERTICAL REINFORCING.
- △ TOP OF WALL BRACING. SEE DETAIL 5/SF203.
- △ 1'-0" THICK x 2'-0" WIDE CONTINUOUS REINFORCED CONCRETE WALL FOOTING. SEE DETAIL 5/SB502.

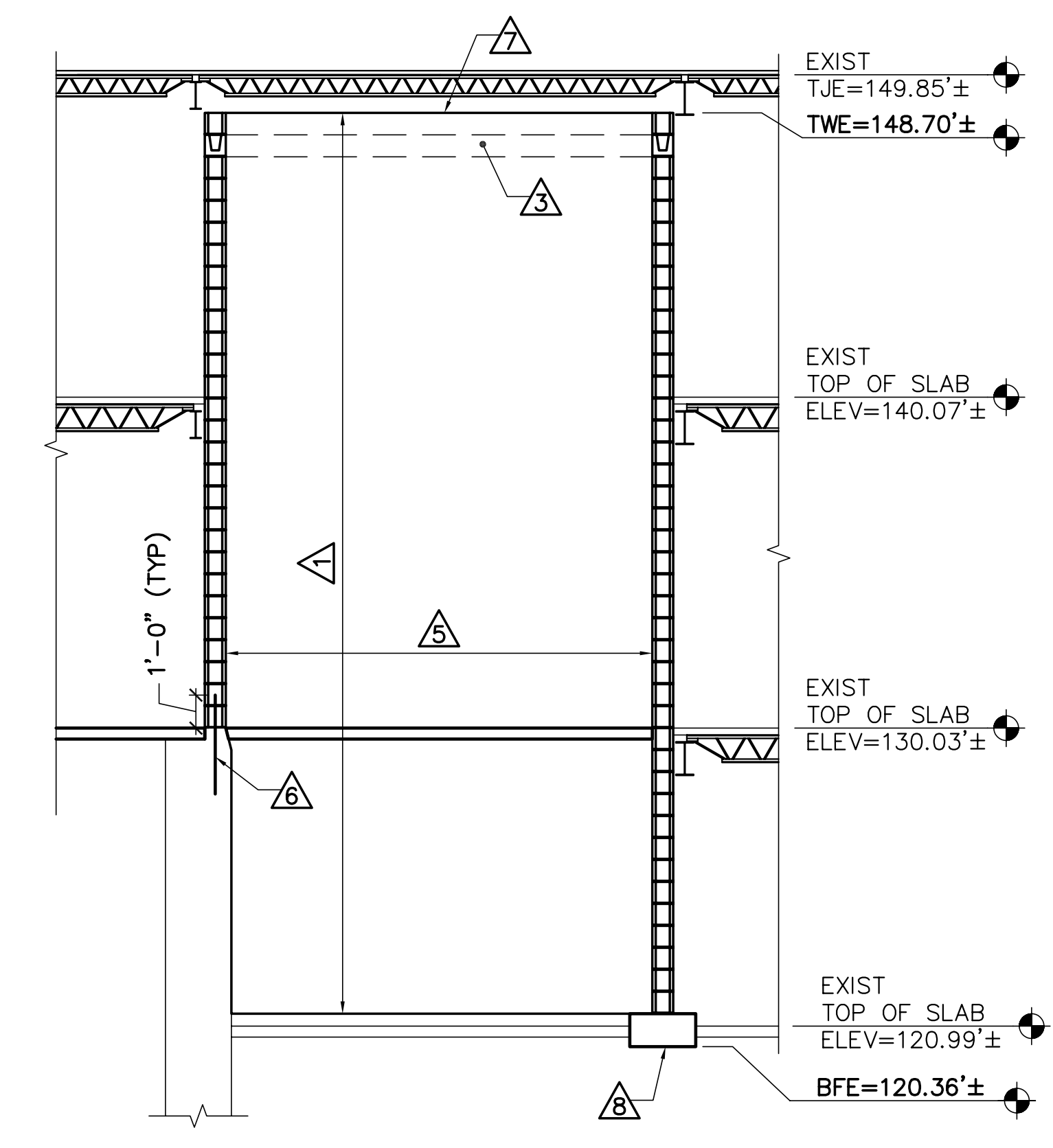

**1 STAIR S02 MASONRY WALL ELEVATION 1**  
 SF102, SF203 SCALE: 1/4"=1'-0"

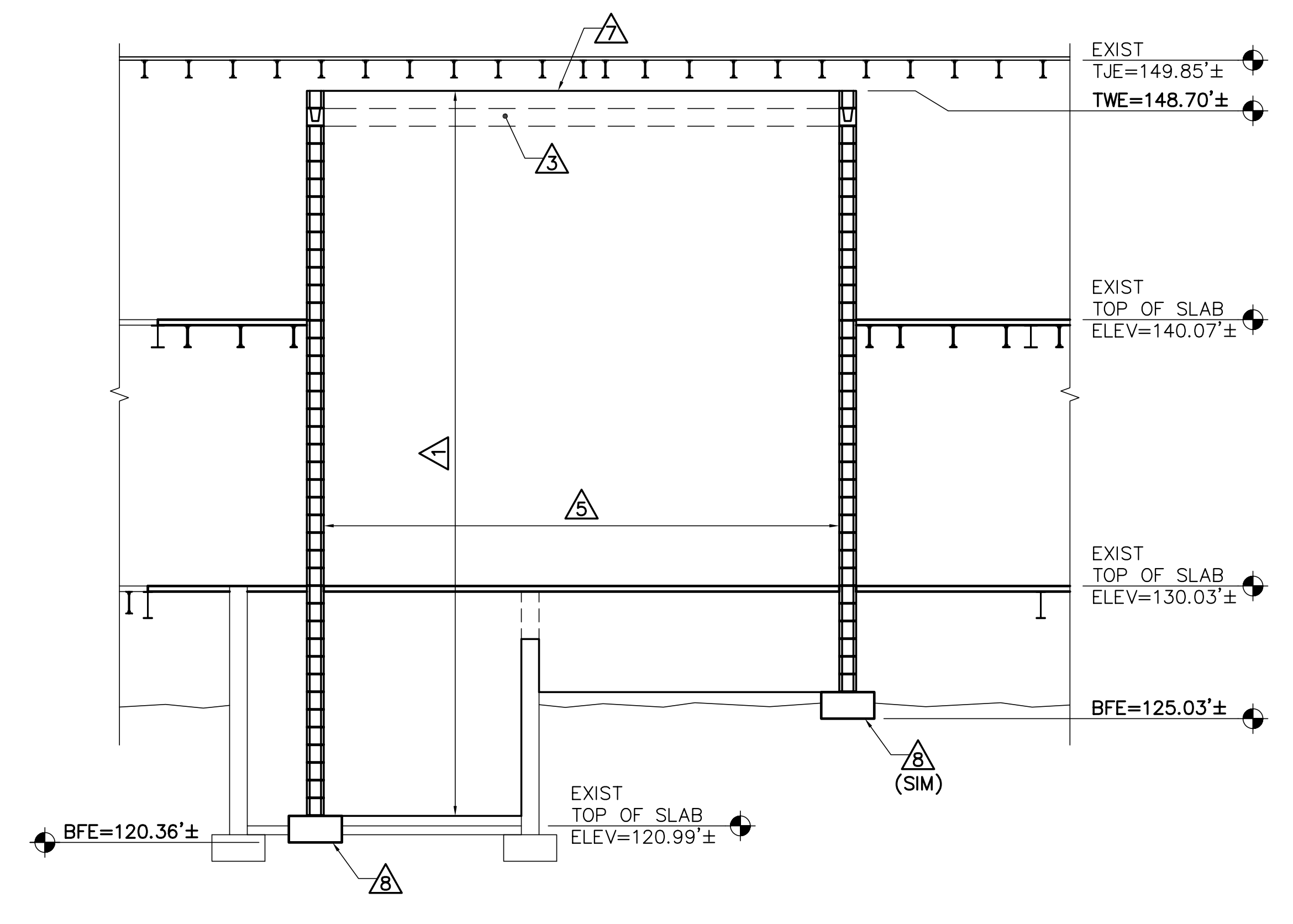

**2 STAIR S02 MASONRY WALL ELEVATION 2**  
 SF102, SF203 SCALE: 1/4"=1'-0"

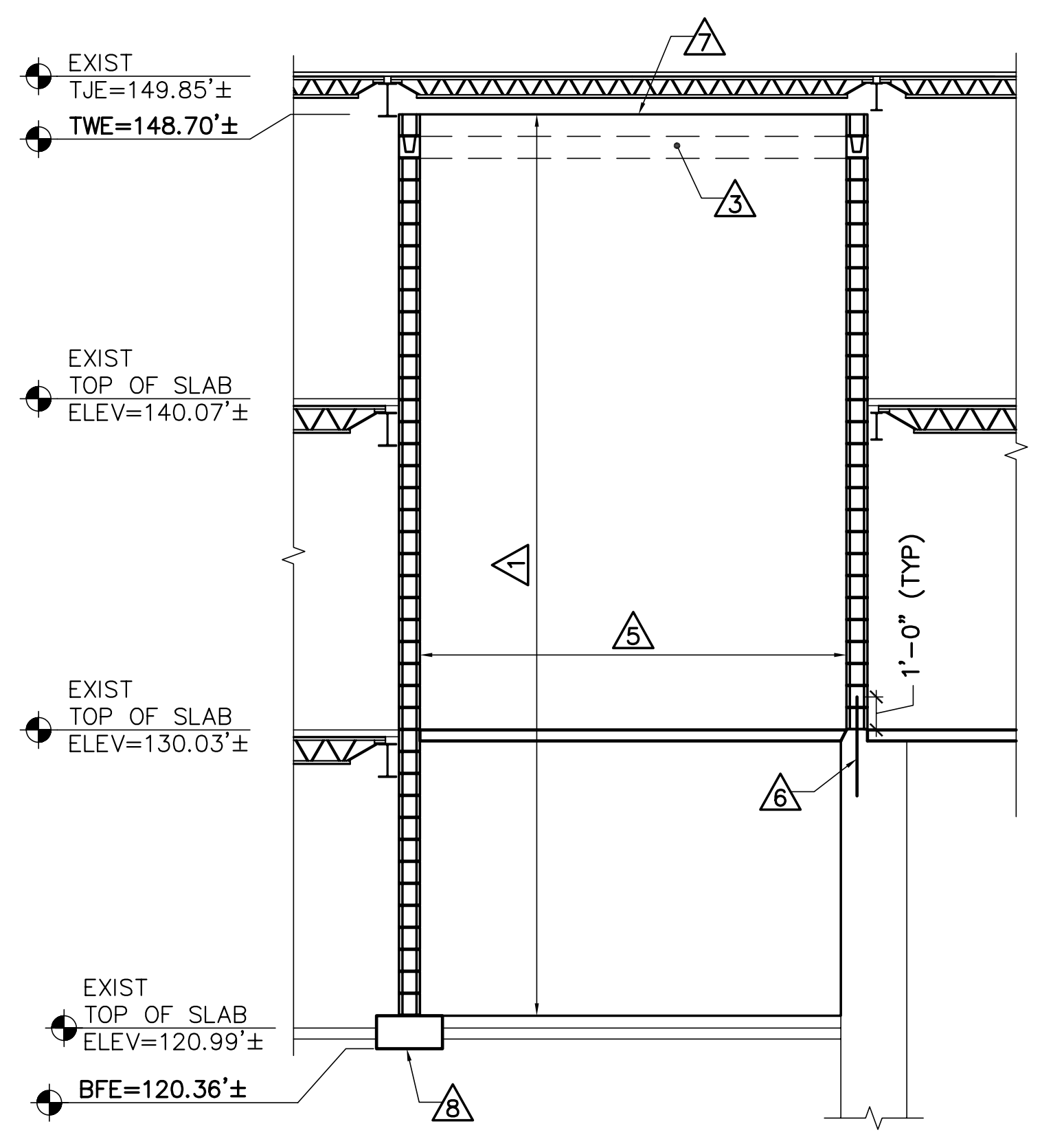

**3 STAIR S02 MASONRY WALL ELEVATION 3**  
 SF102, SF203 SCALE: 1/4"=1'-0"

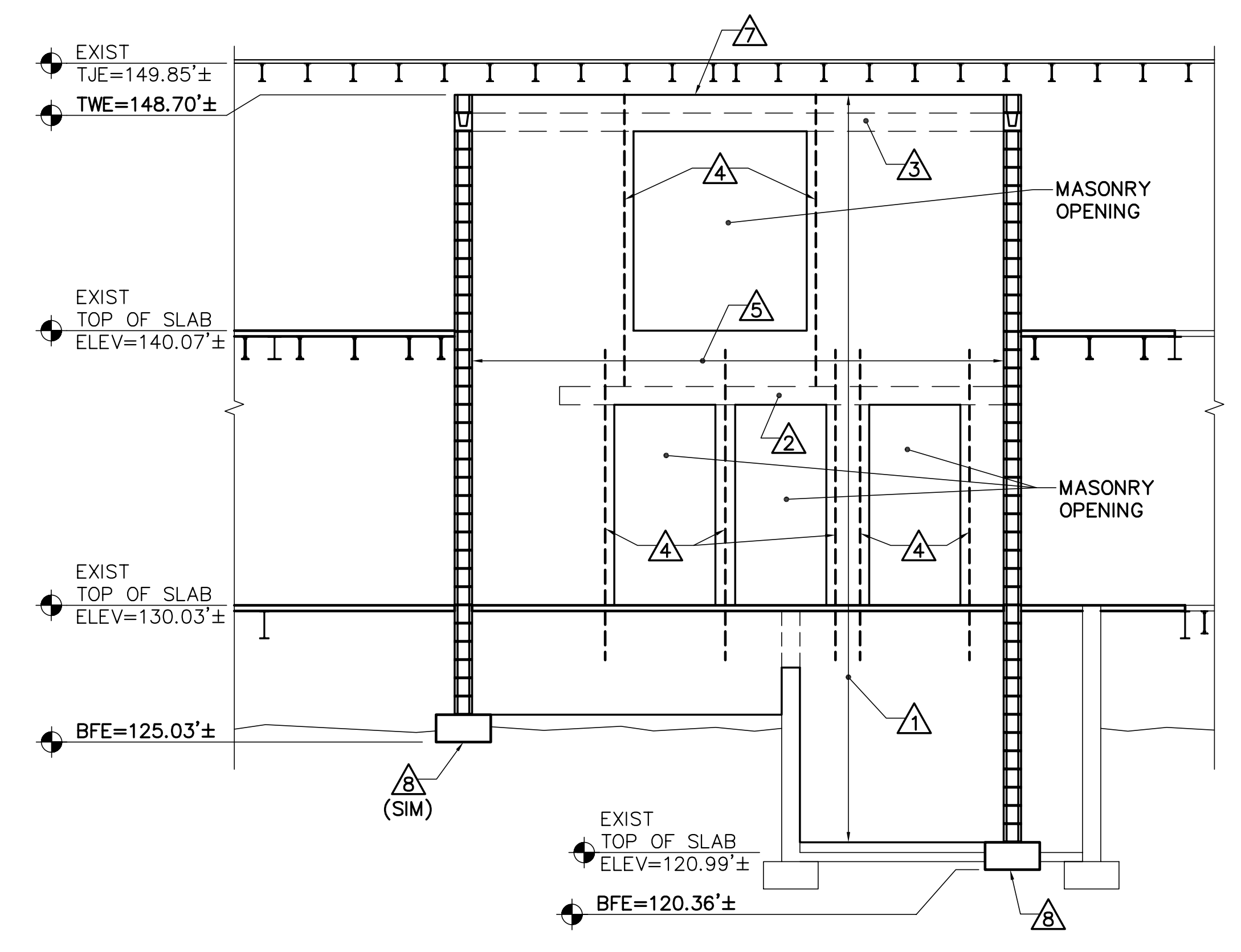

**4 STAIR S02 MASONRY WALL ELEVATION 4**  
 SF102, SF203 SCALE: 1/4"=1'-0"

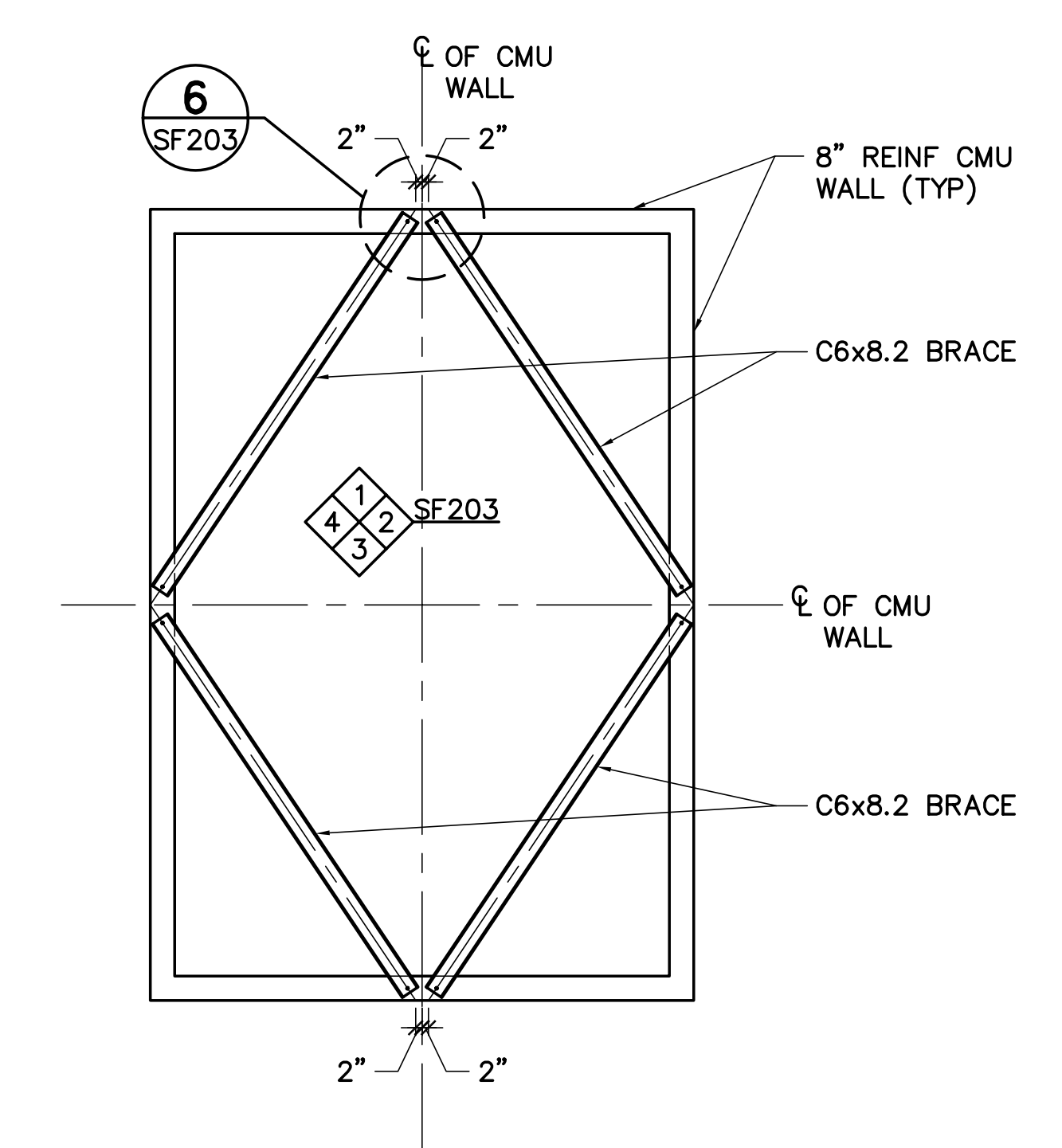

**5 STAIR S02 TOP OF CMU WALL BRACING PLAN**  
 SF203 SCALE: 1/4"=1'-0"

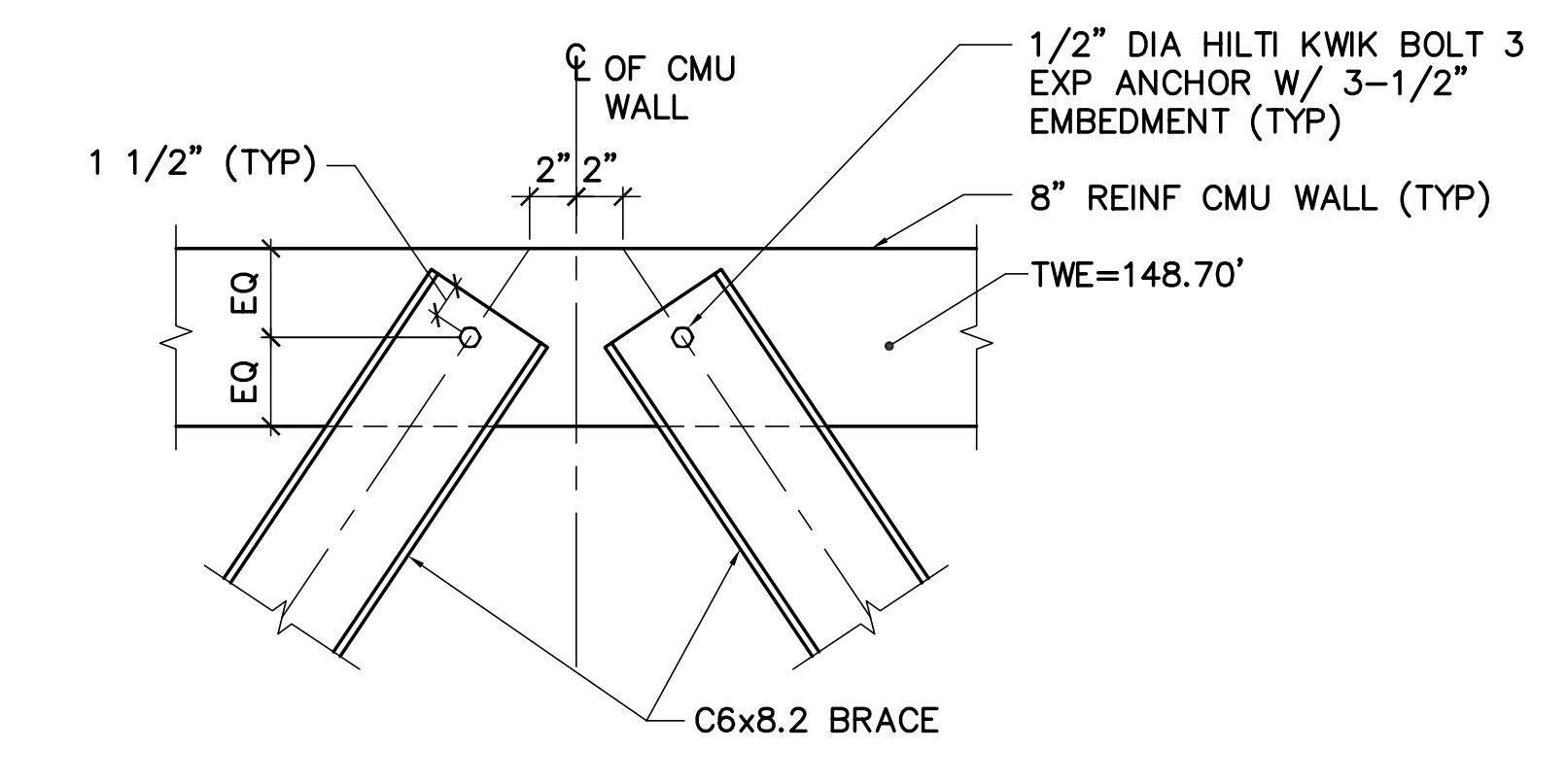

**6 TYP C6x8.2 CMU WALL BRACE CONN DETAIL**  
 SF203 SCALE: 1-1/2"=1'-0"

