

DESIGNED BY: MSA
 DRAWN BY: KLG
 CHECKED BY: CAL
 PROJECT: 21502.10

UNIVERSITY OF NEW ENGLAND
 PORTLAND CAMPUS
 STEVEN AVENUE ARMORY
 716 STEVENS AVE
 PORTLAND, MAINE 04103
 T (207) 283-0171

RENOVATIONS TO THE
 STEVENS AVENUE ARMORY

SECOND FLOOR
 FIRE SUPPRESSION
 PART PLAN

SCALE: AS NOTED
 DATE: 05-24-16

DWG. **FX103**

SHEET: 110 OF 169

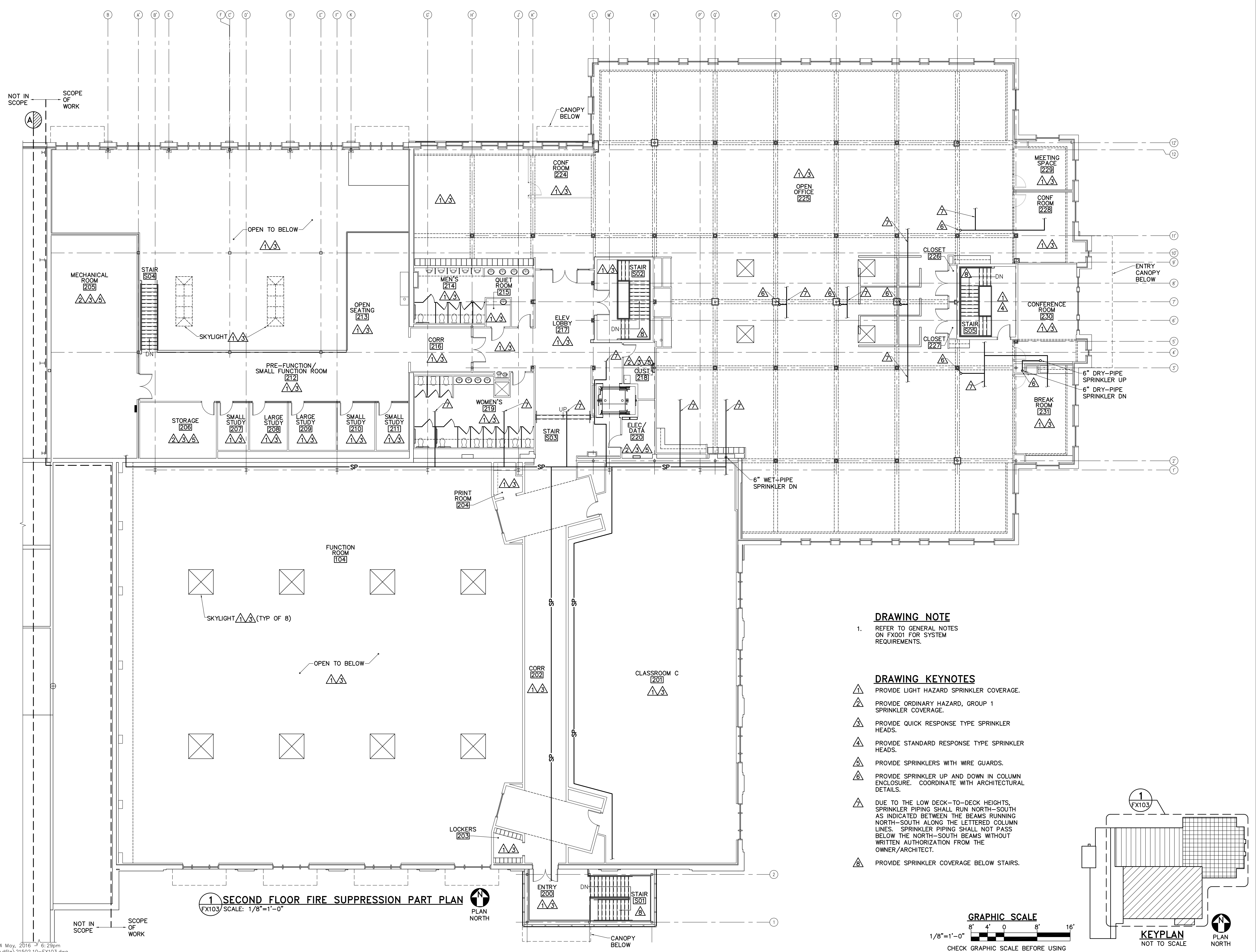

DRAWING NOTE

- REFER TO GENERAL NOTES ON FX001 FOR SYSTEM REQUIREMENTS.

DRAWING KEYNOTES

- 1. PROVIDE LIGHT HAZARD SPRINKLER COVERAGE.
- 2. PROVIDE ORDINARY HAZARD, GROUP 1 SPRINKLER COVERAGE.
- 3. PROVIDE QUICK RESPONSE TYPE SPRINKLER HEADS.
- 4. PROVIDE STANDARD RESPONSE TYPE SPRINKLER HEADS.
- 5. PROVIDE SPRINKLERS WITH WIRE GUARDS.
- 6. PROVIDE SPRINKLER UP AND DOWN IN COLUMN ENCLOSURE. COORDINATE WITH ARCHITECTURAL DETAILS.
- 7. DUE TO THE LOW DECK-TO-DECK HEIGHTS, SPRINKLER PIPING SHALL RUN NORTH-SOUTH AS INDICATED BETWEEN THE BEAMS RUNNING NORTH-SOUTH ALONG THE LETTERED COLUMN LINES. SPRINKLER PIPING SHALL NOT PASS BELOW THE NORTH-SOUTH BEAMS WITHOUT WRITTEN AUTHORIZATION FROM THE OWNER/ARCHITECT.
- 8. PROVIDE SPRINKLER COVERAGE BELOW STAIRS.

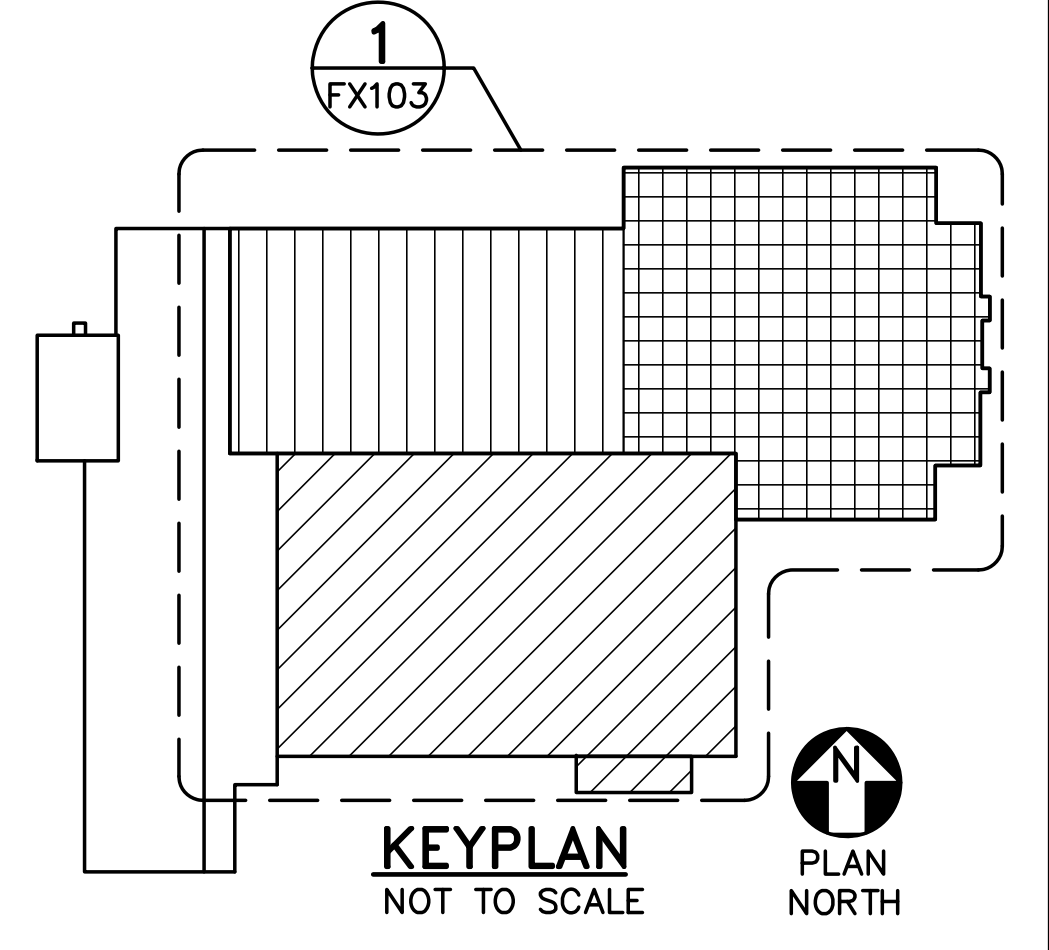
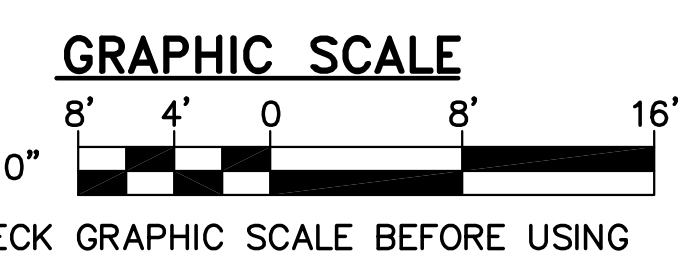

1 SECOND FLOOR FIRE SUPPRESSION PART PLAN
 FX103 SCALE: 1/8"=1'-0"
 PLAN NORTH