

**1 FIRST FLOOR LIGHTING PLAN**  
 EL101 SCALE: 1/8"=1'-0"

**DRAWING NOTE**  
 1. CONENCT EXIT SIGNS AND EMERGENCY LIGHTS TO LOCAL LIGHTING CIRCUIT AHEAD OF ANY SWITCHES, OCCUPANCY SENSORS ETC.

- DRAWING KEYNOTES**
- 1 CONTINUOUS ROW FIXTURE LENGTH OF 9'-2". CONFIRM PRIOR TO ORDERING.
  - 2 CONTINUOUS ROW FIXTURE LENGTH OF 28'-11/4". CONFIRM PRIOR TO ORDERING.
  - 3 CONTINUOUS ROW FIXTURE LENGTH OF 4'. CONFIRM PRIOR TO ORDERING. FIXTURE SHALL HAVE EMERGENCY BATTERY BACKUP.
  - 4 CONTINUOUS ROW FIXTURE LENGTH OF 14'-8-1/2". CONFIRM PRIOR TO ORDERING.
  - 5 CONTINUOUS ROW FIXTURE LENGTH OF 14'-9-1/16". CONFIRM PRIOR TO ORDERING.
  - 6 FIXTURE LOCATED IN CRAWL SPACE TO ILLUMINATE MECHANICAL EQUIPMENT AREA. PROVIDE SWITCH AT CRAWL SPACE ENTRANCE.

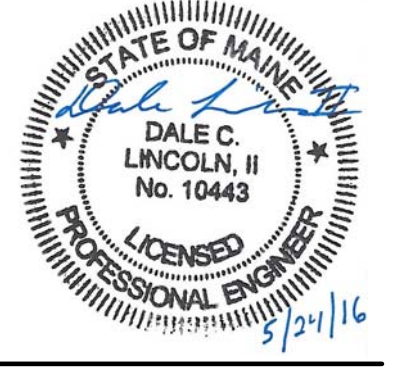
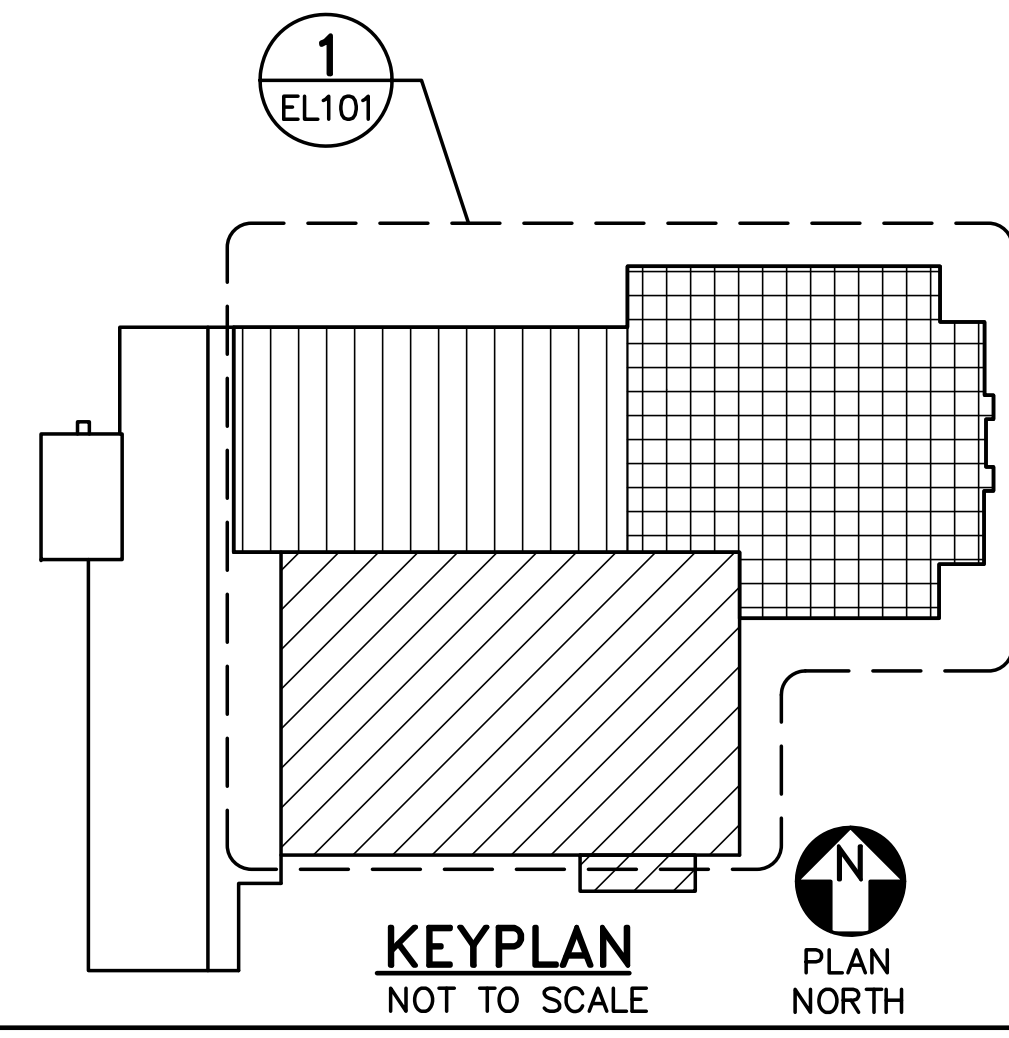
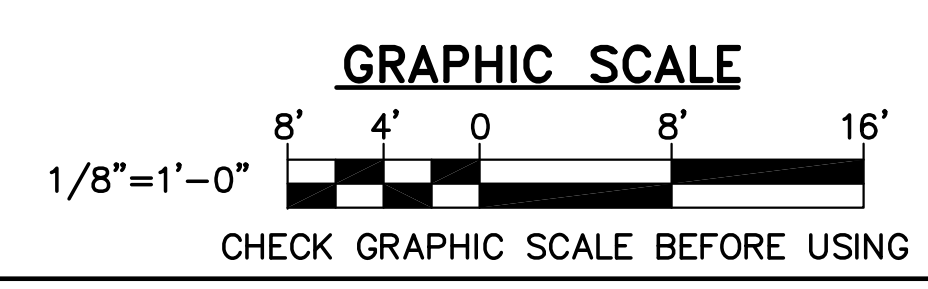

MNL BPD DCL  
 21502.10  
 DESIGNED BY:  
 DRAWN BY:  
 CHECKED BY:  
 PROJECT:

**UNIVERSITY OF NEW ENGLAND  
 PORTLAND CAMPUS**  
 STEVENS AVENUE ARMORY  
 716 STEVENS AVE  
 PORTLAND, MAINE 04103  
 (1) 207 285-0111

**RENOVATIONS TO THE  
 STEVENS AVENUE ARMORY**

**FIRST FLOOR  
 LIGHTING  
 PLAN**

SCALE: AS NOTED  
 DATE: 05-24-16

DWG. **EL101**

SHEET: 160 OF 169