

TYPICAL WALKWAY LANDING AREA PAVING PATTERN

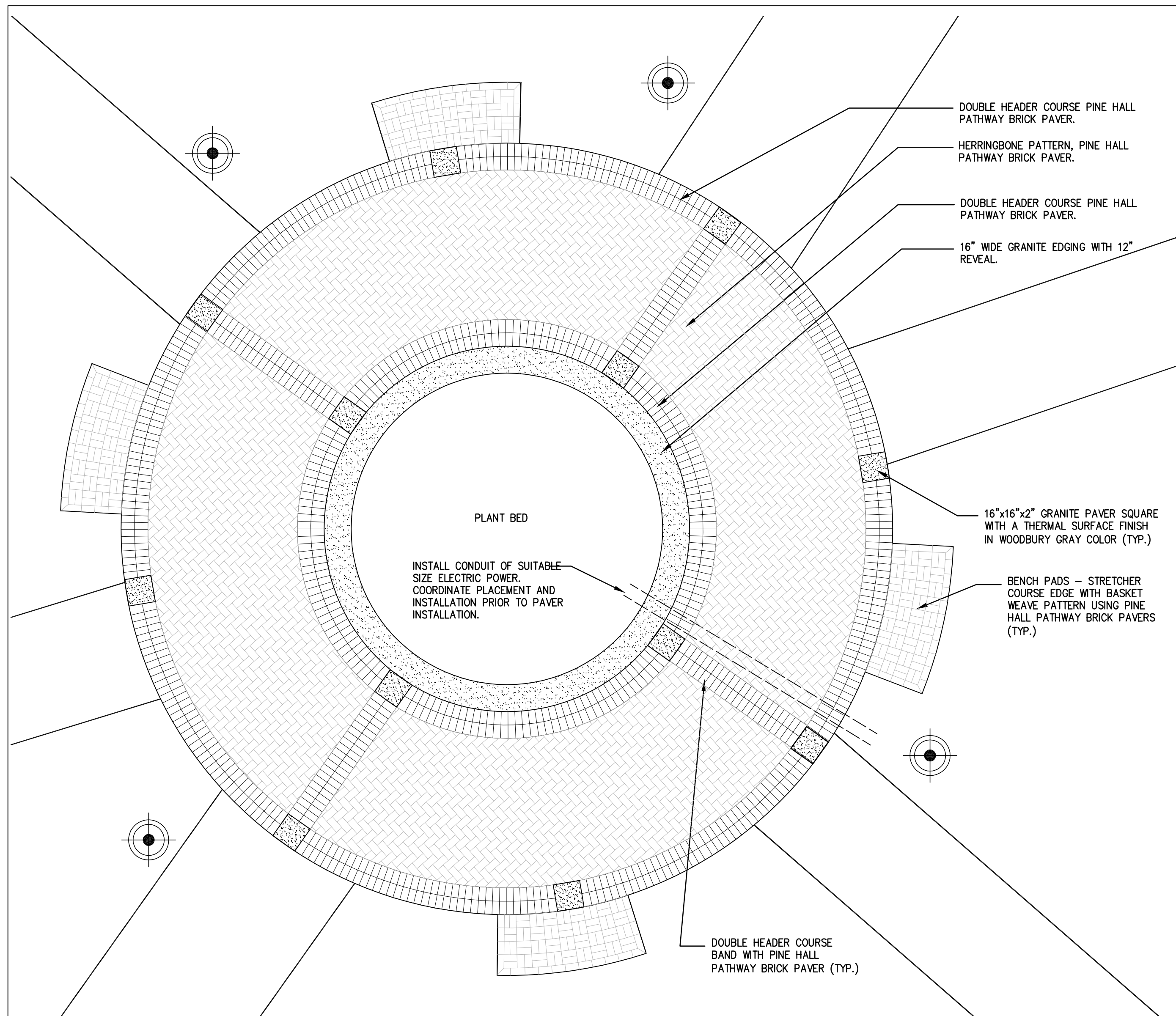

CIRCLE PAVING PATTERN ENLARGEMENT

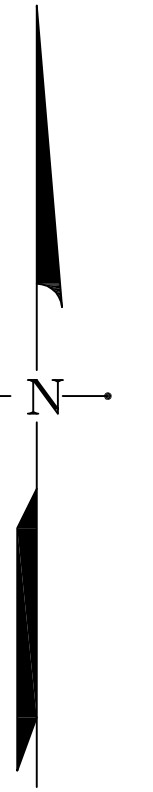
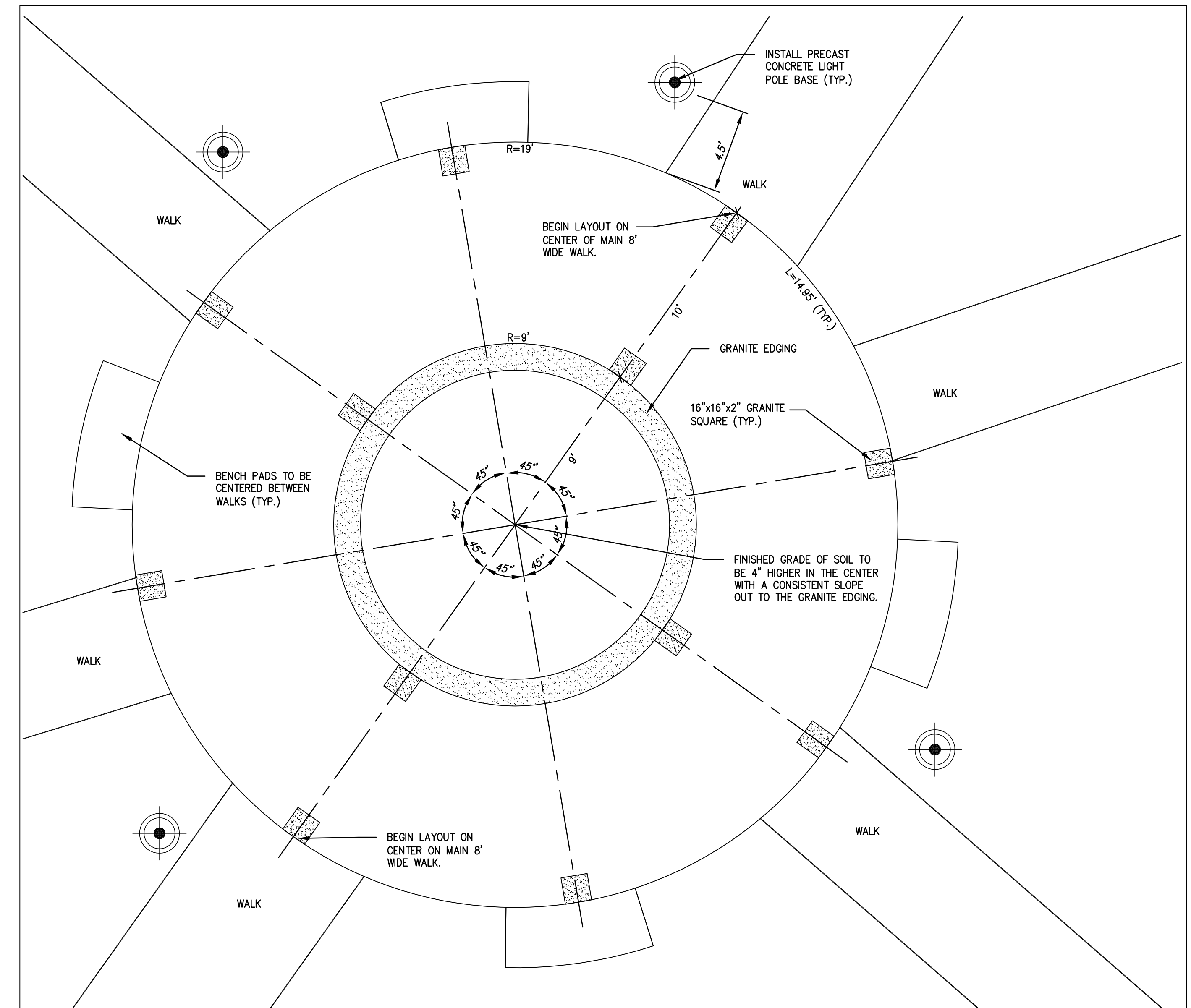

CIRCLE LAYOUT ENLARGEMENT

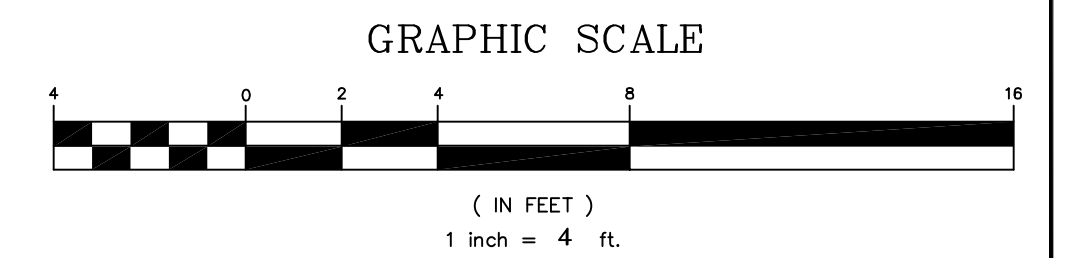

REV.	DATE	STATUS	BY	CHKD.	APPD.	REV.	DATE	STATUS	BY	CHKD.	APPD.
B	6/8/16	ISSUED FOR CITY OF PORTLAND REVIEW		PBB	PBB						
A	5/23/14	ISSUED TO OWNER FOR REVIEW		PBB	PBB						

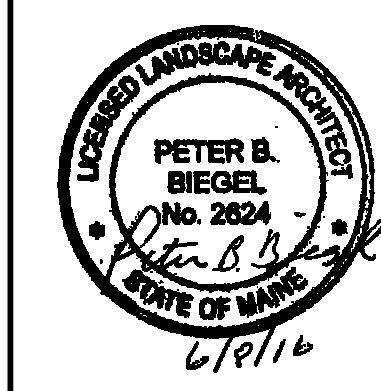

LAND DESIGN SOLUTIONS
 LAND PLANNING, SITE PLANNING & LANDSCAPE ARCHITECTURE
 P.O. Box 316, 160 Longwoods Road, Cumberland, ME 04091 tel: (207) 494-1171
 CLIENT & OWNER:
UNIVERSITY OF NEW ENGLAND
 11 HILLS BEACH ROAD, BIDDEFORD, ME 04005

DESIGN: PBB
 DRAWN: DEPT.
 CHKD: PBB
 DATE: SEPT. 2013
 SCALE: 1/4"=1'

CAMPUS GREEN LANDSCAPE
 ONE CAMPUS, STEVENS AVENUE, PORTLAND, MAINE
CIRCLE AND WALKWAY LANDING AREA ENLARGEMENTS PLAN
 PROJ. NO. _____
 DWG. NO. _____
 REV. _____