

LEGEND:

- EXISTING CONIFEROUS TREE
- EXISTING DECIDUOUS TREE
- TREE TO BE REMOVED
- EXISTING POLE & LIGHT FIXTURE
- LIMIT OF WORK LINE

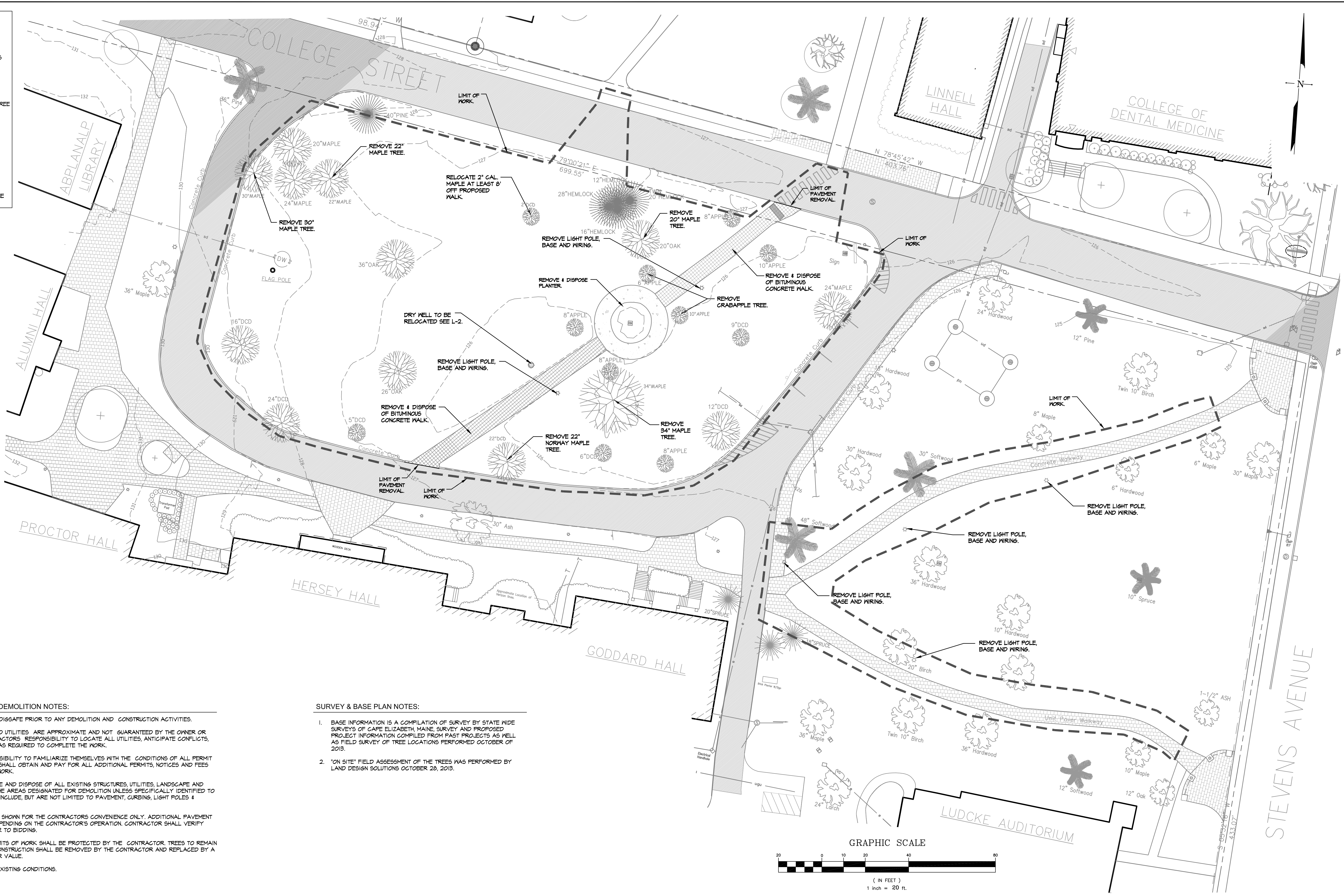

- EXISTING CONDITIONS AND DEMOLITION NOTES:**
1. THE CONTRACTOR SHALL NOTIFY DIGSAFE PRIOR TO ANY DEMOLITION AND CONSTRUCTION ACTIVITIES.
 2. THE LOCATIONS OF UNDERGROUND UTILITIES ARE APPROXIMATE AND NOT GUARANTEED BY THE OWNER OR THE ENGINEER. IT IS THE CONTRACTOR'S RESPONSIBILITY TO LOCATE ALL UTILITIES, ANTICIPATE CONFLICTS, AND REPAIR EXISTING UTILITIES AS REQUIRED TO COMPLETE THE WORK.
 3. IT IS THE CONTRACTOR'S RESPONSIBILITY TO FAMILIARIZE THEMSELVES WITH THE CONDITIONS OF ALL PERMIT APPROVALS. THE CONTRACTOR SHALL OBTAIN AND PAY FOR ALL ADDITIONAL PERMITS, NOTICES AND FEES NECESSARY TO COMPLETE THE WORK.
 4. THE CONTRACTOR SHALL REMOVE AND DISPOSE OF ALL EXISTING STRUCTURES, UTILITIES, LANDSCAPE AND PAVEMENT ON THE SITE WITHIN THE AREAS DESIGNATED FOR DEMOLITION UNLESS SPECIFICALLY IDENTIFIED TO REMAIN. ITEMS TO BE REMOVED INCLUDE, BUT ARE NOT LIMITED TO PAVEMENT, CURBING, LIGHT POLES & BASES, AND LANDSCAPING.
 5. PAVEMENT REMOVAL LIMITS ARE SHOWN FOR THE CONTRACTOR'S CONVENIENCE ONLY. ADDITIONAL PAVEMENT REMOVAL MAY BE REQUIRED DEPENDING ON THE CONTRACTOR'S OPERATION. CONTRACTOR SHALL VERIFY FULL LIMITS OF PAVEMENT PRIOR TO BIDDING.
 6. TREES TO REMAIN WITHIN THE LIMITS OF WORK SHALL BE PROTECTED BY THE CONTRACTOR. TREES TO REMAIN WHICH ARE DAMAGED DURING CONSTRUCTION SHALL BE REMOVED BY THE CONTRACTOR AND REPLACED BY A TREE OF EQUAL SIZE OR DOLLAR VALUE.
 7. SCREENED IMAGES REPRESENT EXISTING CONDITIONS.

- SURVEY & BASE PLAN NOTES:**
1. BASE INFORMATION IS A COMPILATION OF SURVEY BY STATE WIDE SURVEYS OF CAPE ELIZABETH, MAINE, SURVEY AND PROPOSED PROJECT INFORMATION COMPILED FROM PAST PROJECTS AS WELL AS FIELD SURVEY OF TREE LOCATIONS PERFORMED OCTOBER OF 2013.
 2. "ON SITE" FIELD ASSESSMENT OF THE TREES WAS PERFORMED BY LAND DESIGN SOLUTIONS OCTOBER 28, 2013.

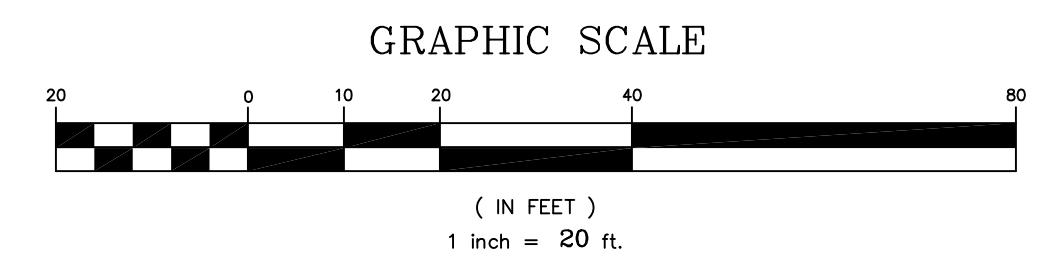

| REV. | DATE | STATUS | BY | CHKD. | APPD. | REV. | DATE | STATUS | BY | CHKD. | APPD. |
|------|---------|------------------------------------|-------|-------|-------|------|------|--------|----|-------|-------|
| B | 6/8/16 | ISSUED FOR CITY OF PORTLAND REVIEW | DEPT. | PBB | PBB | | | | | | |
| A | 5/23/14 | ISSUED TO OWNER | DEPT. | PBB | PBB | | | | | | |

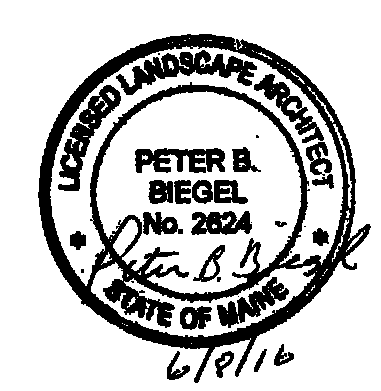

LAND DESIGN SOLUTIONS
 LAND PLANNING, SITE PLANNING & LANDSCAPE ARCHITECTURE
 P.O. Box 316, 160 Longwoods Road, Cumberland, ME 04021 tel: (207) 494-1111
 CLIENT & OWNER:
UNIVERSITY OF NEW ENGLAND
 11 HILLS BEACH ROAD, BIDDEFORD, ME 04005

DESIGN: PBB
 DRAWN: DEPT.
 CHKD: PBB
 DATE: SEPT. 2013
 SCALE: 1"=20'

CAMPUS GREEN LANDSCAPE
 ONE CAMPUS, PORTLAND, MAINE
EXISTING CONDITIONS AND DEMOLITION PLAN
 PROJ. NO. _____
 DWG. NO. _____
 REV. _____