

UTILITY NOTES:

- THE CONTRACTOR SHALL COORDINATE THE INSTALLATION OF NEW UTILITIES WITH THE APPROPRIATE UTILITY COMPANY.
- THE CONTRACTOR SHALL VERIFY ACTUAL FIELD LOCATION OF UTILITIES PRIOR TO CONSTRUCTION.
- ALL UTILITY WORK SHALL BE IN CONFORMANCE WITH THE CITY OF PORTLAND AND UTILITY COMPANY STANDARDS.
- WATER SERVICE SHALL BE COORDINATED WITH THE PORTLAND WATER DISTRICT. CONSTRUCTION INCLUDING POLYWRAP TO R.O.W. MATERIALS, TESTING AND CHLORINATION SHALL BE IN ACCORDANCE WITH DISTRICT STANDARDS. WATER VALVES TO BE LEFT OPEN. WATER SYSTEM LAYOUT IS SUBJECT TO REVIEW BY THE PORTLAND WATER DISTRICT.
- CONTRACTOR SHALL EXCAVATE TEST PITS AT ALL POINTS WHERE UTILITIES CROSS EXISTING UTILITIES. THIS INFORMATION SHALL BE PROVIDED TO THE OWNER'S REPRESENTATIVE PRIOR TO CONSTRUCTION.
- PROVIDE CONDUIT OF SUITABLE SIZE WITH FULL LINES FOR ALL UNDERGROUND WIRING.
- ALL MANHOLES AND CATCH BASINS SHALL BE PROVIDED WITH FLEXIBLE BOOT CONNECTIONS FOR PIPES.
- PROPOSED CONNECTIONS INTO EXISTING MANHOLES AND CATCH BASINS SHALL BE CORE DRILLED AND A FLEXIBLE BOOT INSTALLED WITH A PRESS WEDGE SYSTEM FOR WATER TIGHTNESS.
- PIPE MATERIAL FOR 4" AND 6" WATER LINE SHALL BE CLASS 32 DOUBLE CEMENT LINED DUCTILE IRON.
- MINIMUM COVER OVER WATER LINES AND CHILLED WATER SUPPLY AND RETURN LINES SHALL BE 5'-6".
- WHERE THERE IS LESS THAN 5'-6" COVER OVER SEWER LINES, PLACE 2 LAYERS OF 2" THICK RIGID INSULATION OVER PIPE FOR FULL WIDTH OF TRENCH. INSULATION JOINTS SHALL BE STAGGERED.
- THE OWNER SHALL SUBMIT AS-BUILT RECORD DRAWINGS TO THE CITY FOR ANY UTILITY SERVICE THAT IS UPGRADED OR REPLACED DURING CONSTRUCTION.
- GENERATOR TO BE 250KW STANDBY DIESEL GENERATOR IN WEATHERPROOF ENCLOSURE. PROVIDE REINFORCED CONCRETE PAD. OWNER TO APPROVE MAKE AND MODEL PRIOR TO PURCHASING. COORDINATE HOOK-UP WITH THE MECHANICAL ENGINEER. GENERATOR AND WIRING TO BE INSTALLED PER ALL APPLICABLE CODES AND THE MANUFACTURER'S RECOMMENDATIONS.
- TRANSFORMER - TO BE TEOKVA PAR MOUNTED UTILITY TRANSFORMER, FURNISHED BY CENTRAL MAINE POWER COMPANY. CONCRETE PAD TO BE PROVIDED BY THE CONTRACTOR. COORDINATE INSTALLATION WITH UTILITY COMPANY. UTILITY METERING TO BE AT TRANSFORMER. COORDINATE METERING INSTALLATION REQUIREMENTS WITH UTILITY COMPANY.
- REFER TO DRAWING C-102 FOR STORM DRAIN INFORMATION.
- DECORATIVE LAMP FIXTURE AND POSTS TO BE CAMPUS STANDARD AS MANUFACTURED BY DYNAMIC LIGHTING PD623(PA)/00HP5-120V-BLK-L3(FIXTURE) WITH IES CUT-OFF OPTION #D19-10/BLK(pole)
LAMP: 100W HIGH PRESSURE SODIUM
POLE HEIGHT: 10'
DESCRIPTION: POST MOUNTED DECORATIVE LIGHT
CLEAR DIFFUSER PANELS AND IESNA TYPE III DISTRIBUTION PATTERN.
- ADD ALTERNATE C-1 (MIVARIUM EMERGENCY BACK UP COOLING OPTION. PURCHASE AND INSTALL):
- 30 TON CHILLER
- REINFORCED 8'-6"x8'-6" REINFORCED CONCRETE PAD
- ENLARGEMENT OF UTILITY ENCLOSURE (3'-6" EXTENSION)
- ASSOCIATED REMOVAL OF PAVEMENT
- INSTALLATION OF CRUSHED STONE
- APPROXIMATELY 210 LF OF 6" CHILLED WATER SUPPLY AND RETURN TO PROPOSED BUILDING
- ANY OTHER SITE, MECHANICAL AND ELECTRICAL WORK ASSOCIATED WITH INSTALLATION AND HOOK UP OF CHILLER SYSTEM.
- ADD ALTERNATE C-2 INSTALL 3X3 REBAR REINFORCED, SIX INCH THICK CONCRETE PAD AND FIVE FEET OF 4" DIA. PVC SCHEDULE 40 CONDUIT.
- PUMP STATION - SEE C-102 AND DETAILS FOR ADDITIONAL INFORMATION.
- SEE MECHANICAL SPECIFICATIONS FOR ADDITIONAL CHILLED WATER SUPPLY AND RETURN INFORMATION.
- REFER TO C-100 THRU C-104 AND C-300 THRU C-304 ARCHITECTURAL, STRUCTURAL AND MECHANICAL DRAWINGS AND THE PROJECT MANUAL FOR ADDITIONAL INFORMATION.

LEGEND	
EXISTING	PROPOSED
	BUILDING
	EDGE OF PAVEMENT
	BITUMINOUS CURB
	EDGE OF CONCRETE
	PROPERTY LINE
	RIGHT-OF-WAY LINE
	INTERMEDIATE CONTOUR
	INDEX CONTOUR
	STORM DRAIN MANHOLE
	STORM DRAIN CATCH BASIN
	STORM DRAIN LINE
	STORM DRAIN CULVERT
	CHILLED WATER SUPPLY & RETURN
	GAS LINE
	SANITARY SEWER MANHOLE
	SANITARY SEWER LINE
	ELECTRIC LINE
	ELECTRIC MANHOLE
	LIGHT POLE & FIXTURE
	TELEPHONE LINE
	TELEPHONE MANHOLE
	TREE

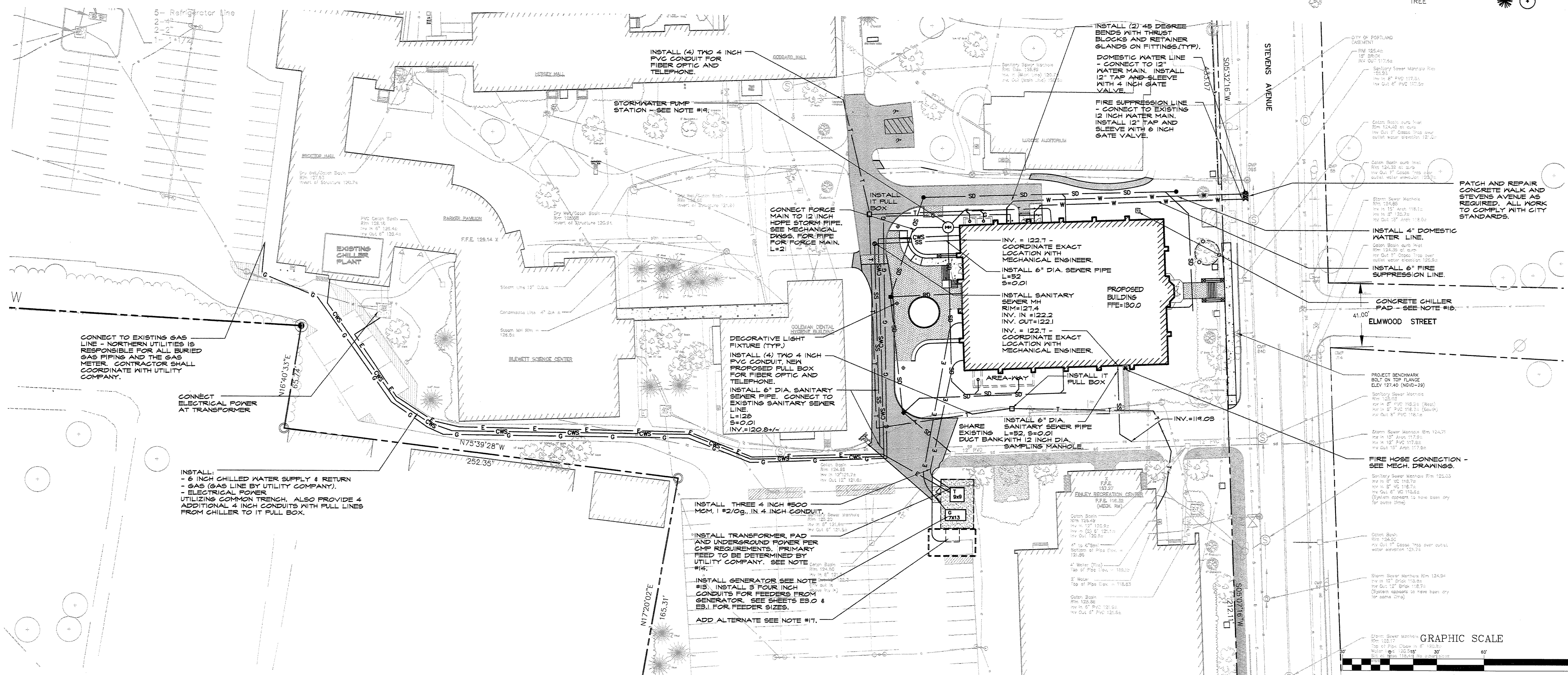

THIS PLAN SHALL NOT BE MODIFIED WITHOUT WRITTEN PERMISSION FROM SYTDdesign Consultants, ANY ALTERATIONS, OTHERWISE, SHALL BE AT THE USER'S SOLE RISK AND WITHOUT LIABILITY TO SYTDdesign Consultants.

REV.	DATE	STATUS	BY	CHKD.	APPD.	REV.	DATE	STATUS	BY	CHKD.	APPD.
G	1/24/08	PERMIT SET	PBB	PBB	TWS						
F	12/20/07	SUBMITTED TO THE CITY OF PORTLAND FOR SITE PLAN REVIEW	PBB	PBB	TWS						
E	12/6/07	ISSUED FOR DESIGN DEVELOPMENT	PBB	PBB	TWS						
D	11/27/07	ISSUED TO ARCHITECT FOR CHECK SET	PBB	PBB	TWS						
-	-	-	-	-	-	1	2/8/08	ISSUED FOR BID NOT FOR CONSTRUCTION	PBB	PBB	TWS
B	10/19/07	ISSUED FOR SCHEMATIC DESIGN	PBB	PBB	TWS						
A	10/12/07	SUBMITTED TO THE CITY OF PORTLAND FOR SITE PLAN REVIEW	PBB	PBB	TWS	H	2/5/08	REVISED AND SUBMITTED TO THE CITY OF PORTLAND FOR SITE PLAN REVIEW	PBB	PBB	TWS

SYTDdesign
CONSULTANTS
CIVIL ENGINEERING & LANDSCAPE ARCHITECTURE

PO. Box 88A
180 Longwoods Road
Cumberland, Maine 04021
tel: 207.829.6994 fax: 207.829.2231

CLIENT:
UNIVERSITY OF NEW ENGLAND
11 HILLS BEACH ROAD, BIDDEFORD, MAINE 04005

DESIGN: PBB	COLLEGE OF PHARMACY 716 STEVENS AVENUE, PORTLAND, MAINE 04103
DRAWN: DAM	
CHKD: TWS	SITE UTILITY PLAN
DATE: AUGUST 2007	
SCALE: 1" = 30' *	PROJ. NO. 06-216.08 REV. 1
	DWG. NO. C-103