

11 PROCEDURE ROOM 336
SCALE: 1/4" = 1'-0"

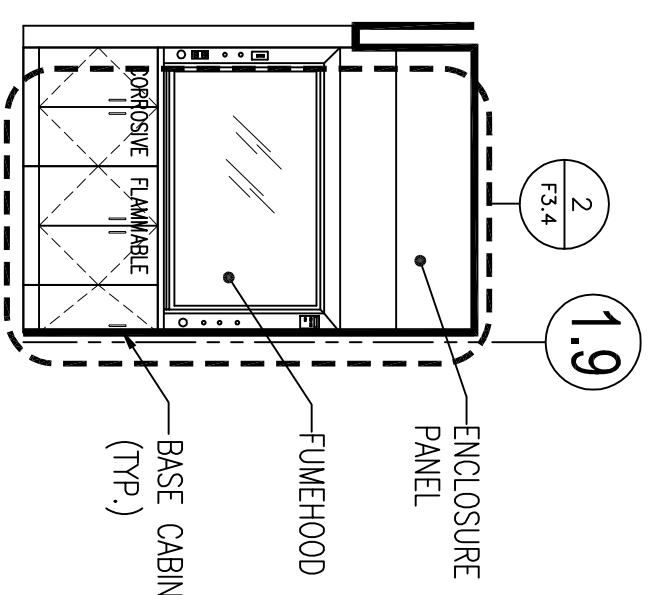

9 FUME HOOD ALCOVE 334
SCALE: 1/4" = 1'-0"

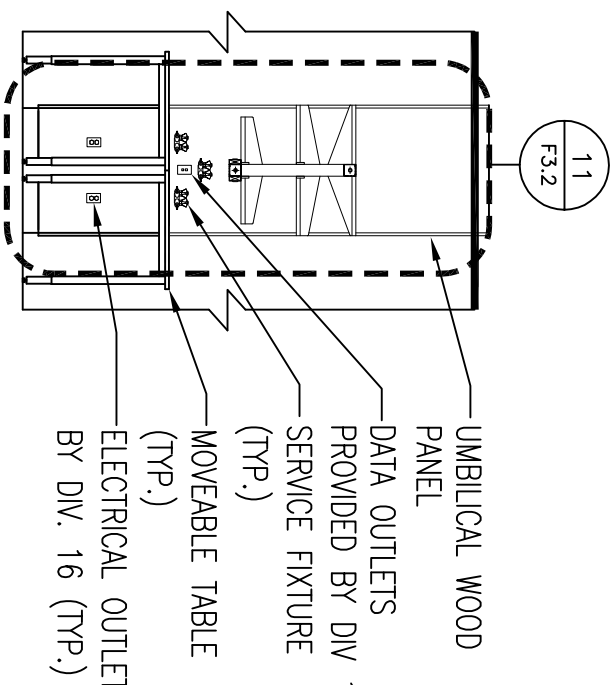

5 LABORATORY ROOM 327
SCALE: 1/4" = 1'-0"

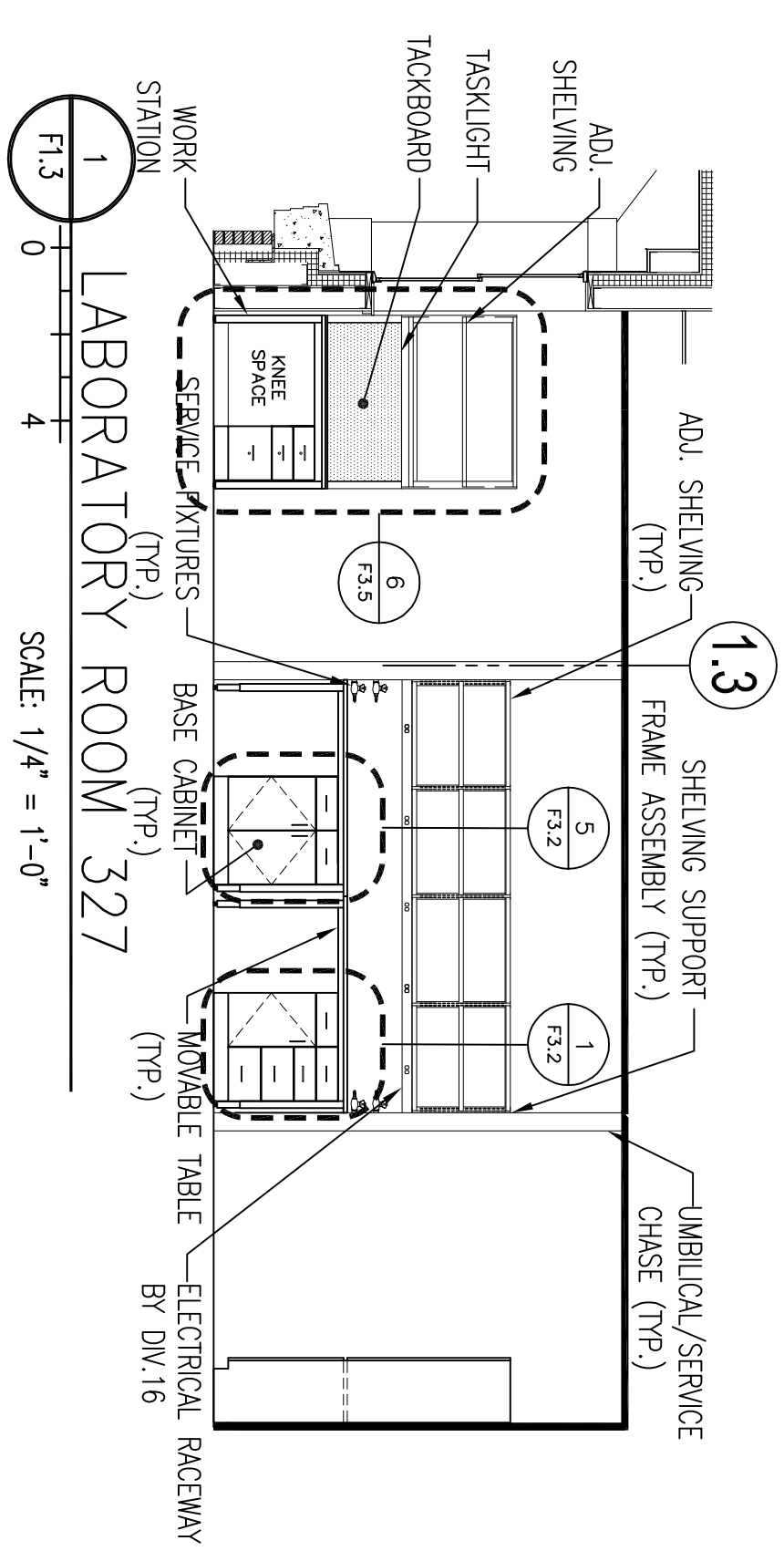

1 LABORATORY ROOM 327
SCALE: 1/4" = 1'-0"

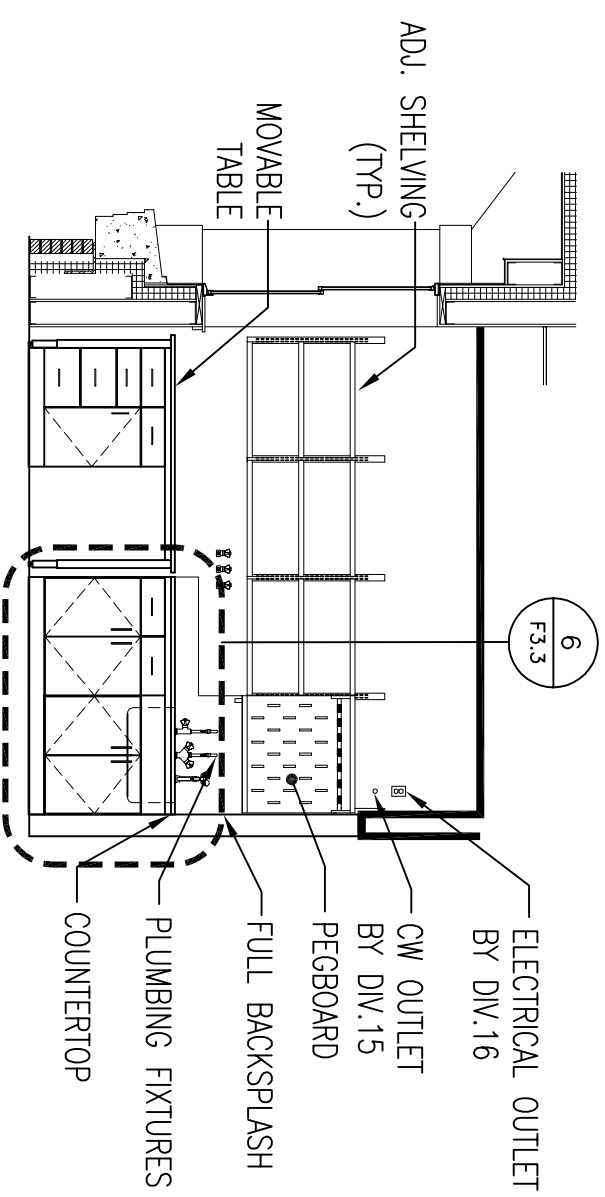

12 PROCEDURE ROOM 336
SCALE: 1/4" = 1'-0"

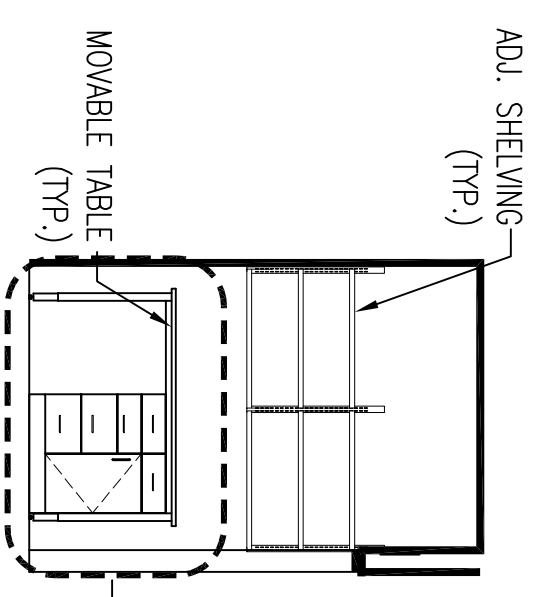

10 FUME HOOD ALCOVE 334
SCALE: 1/4" = 1'-0"

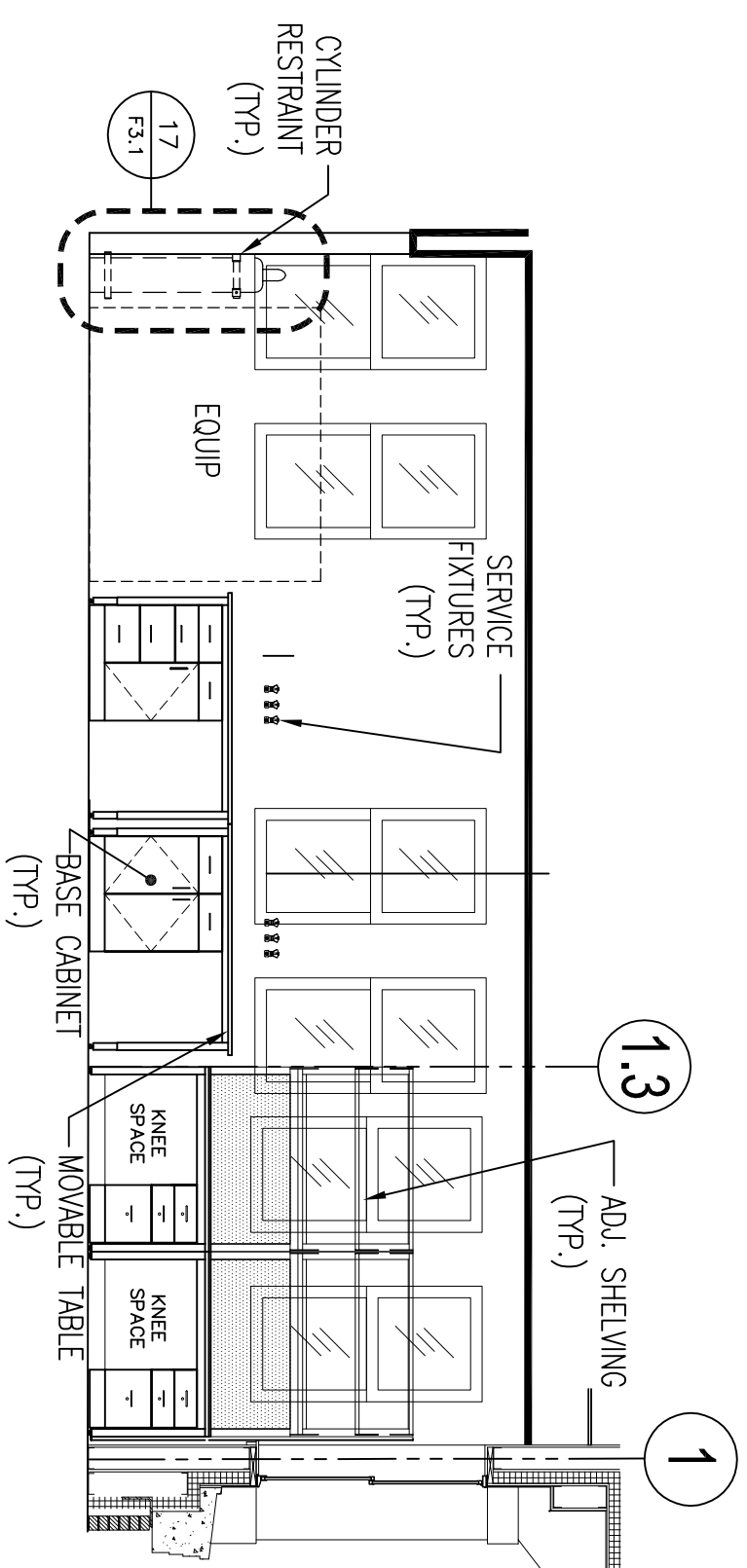

6 LABORATORY ROOM 327
SCALE: 1/8" = 1'-0"

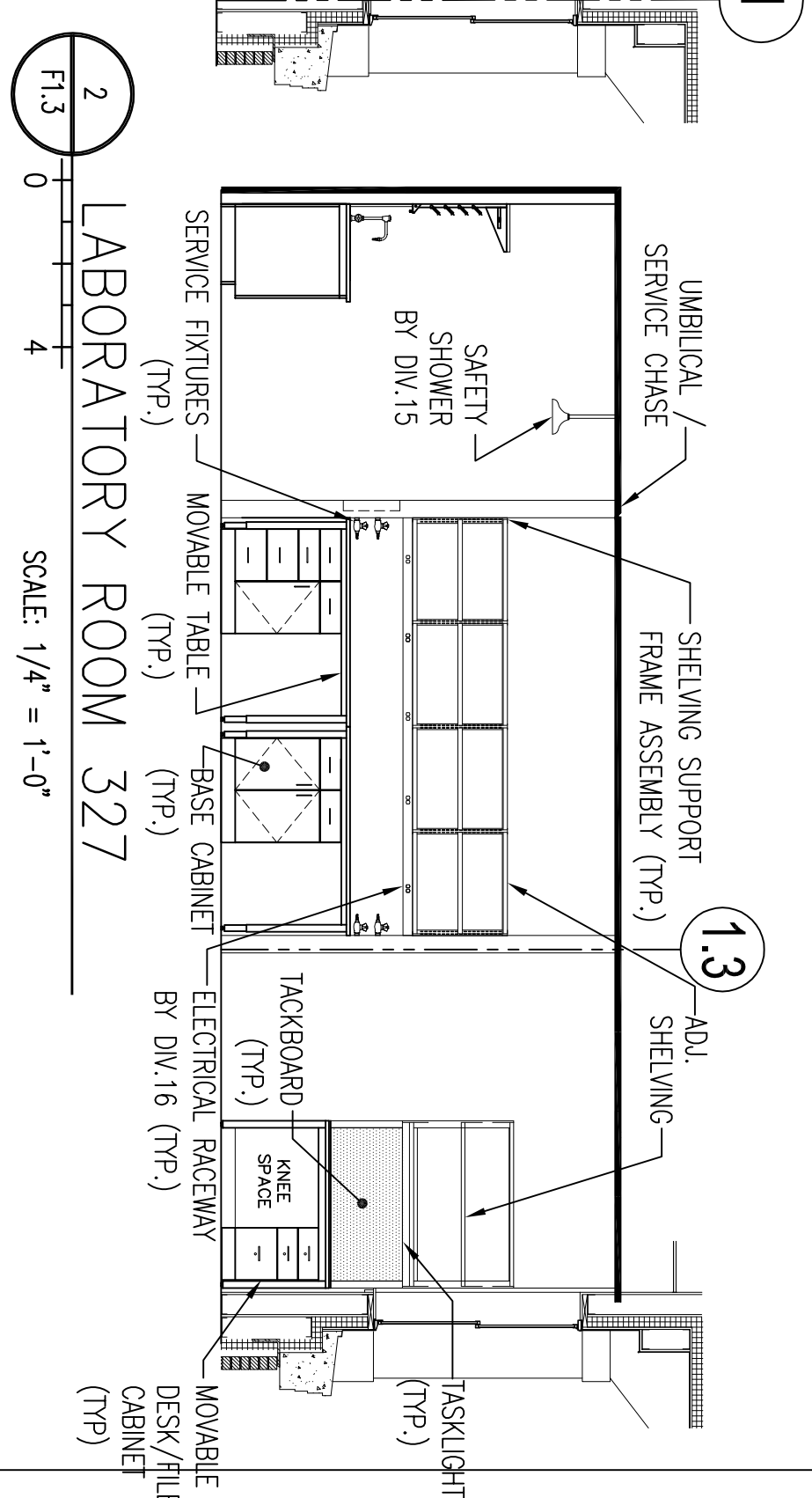

2 LABORATORY ROOM 327
SCALE: 1/4" = 1'-0"

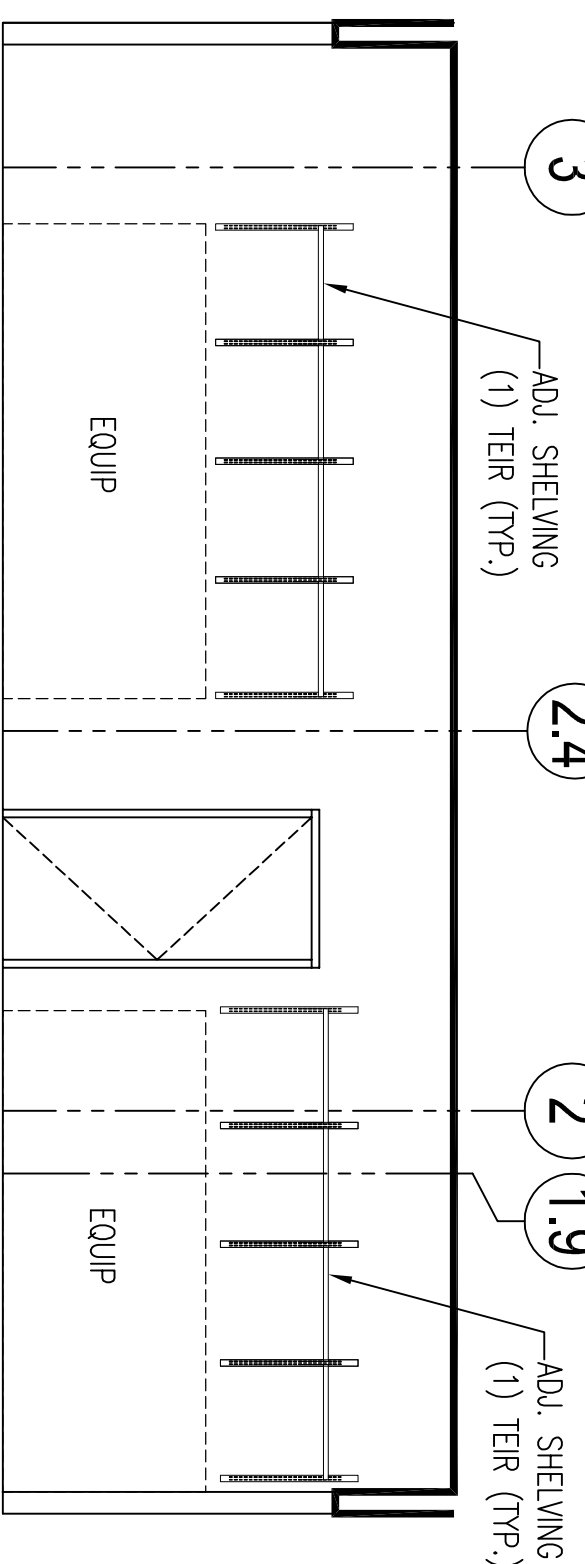

13 LINEAR EQUIPMENT ROOM
SCALE: 1/4" = 1'-0"

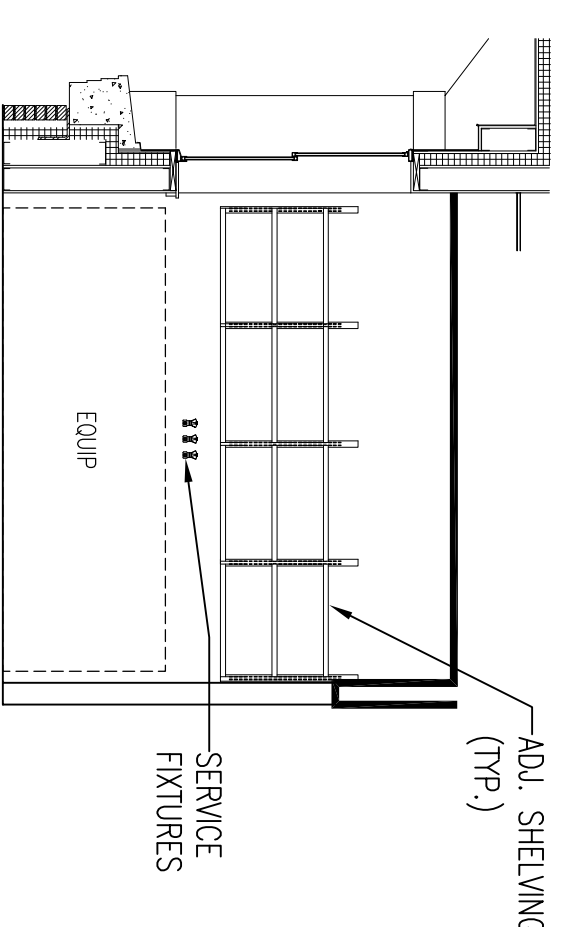

7 NOT IN USE
SCALE: 1/8" = 1'-0"

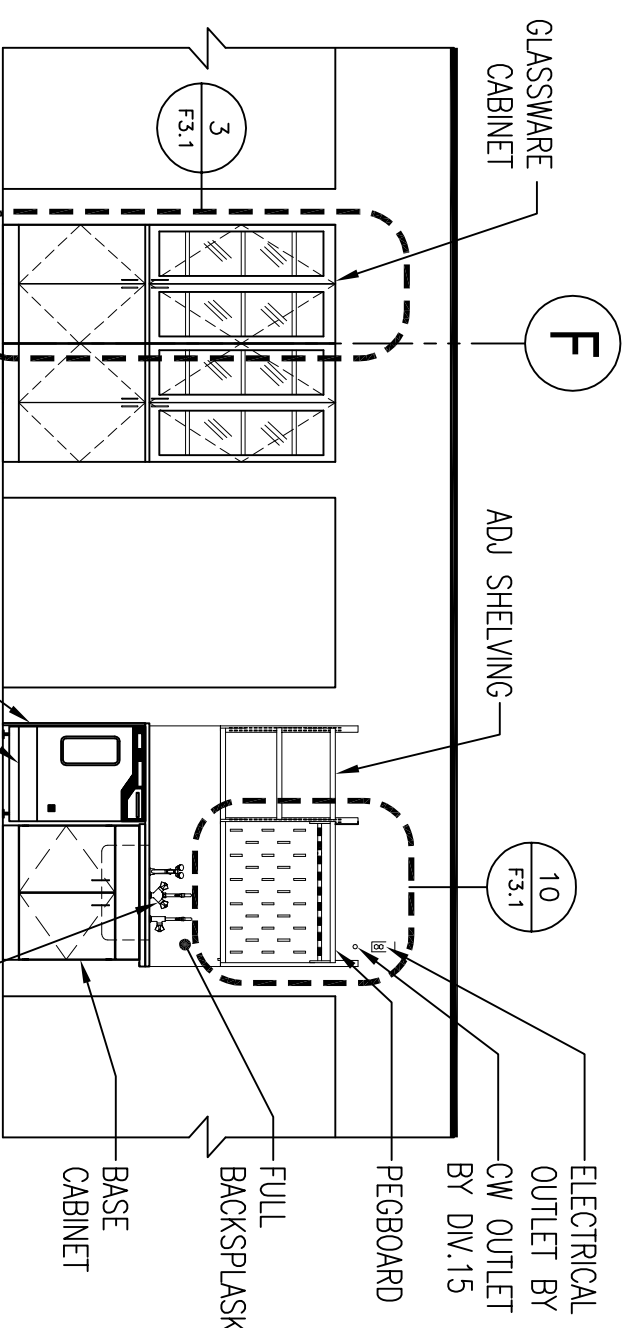

3 LABORATORY ROOM 327
SCALE: 1/4" = 1'-0"

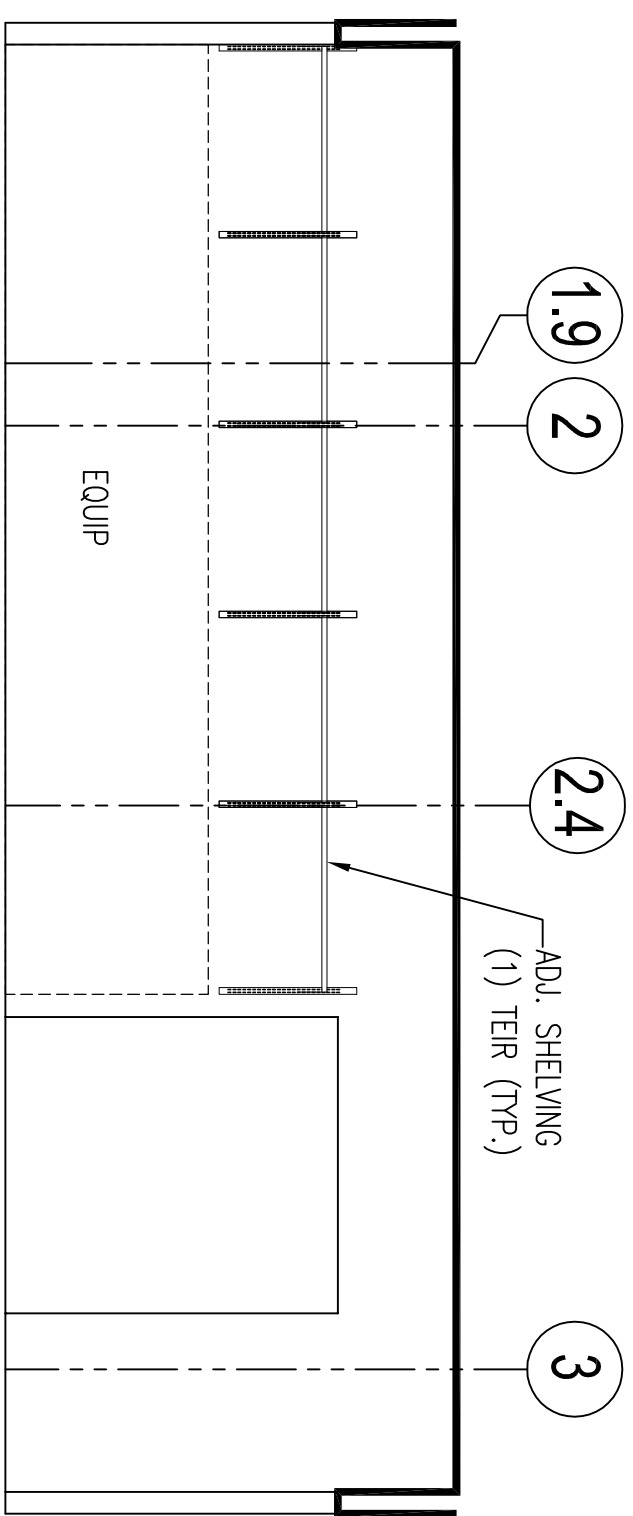

14 LINEAR EQUIPMENT ROOM
SCALE: 1/4" = 1'-0"

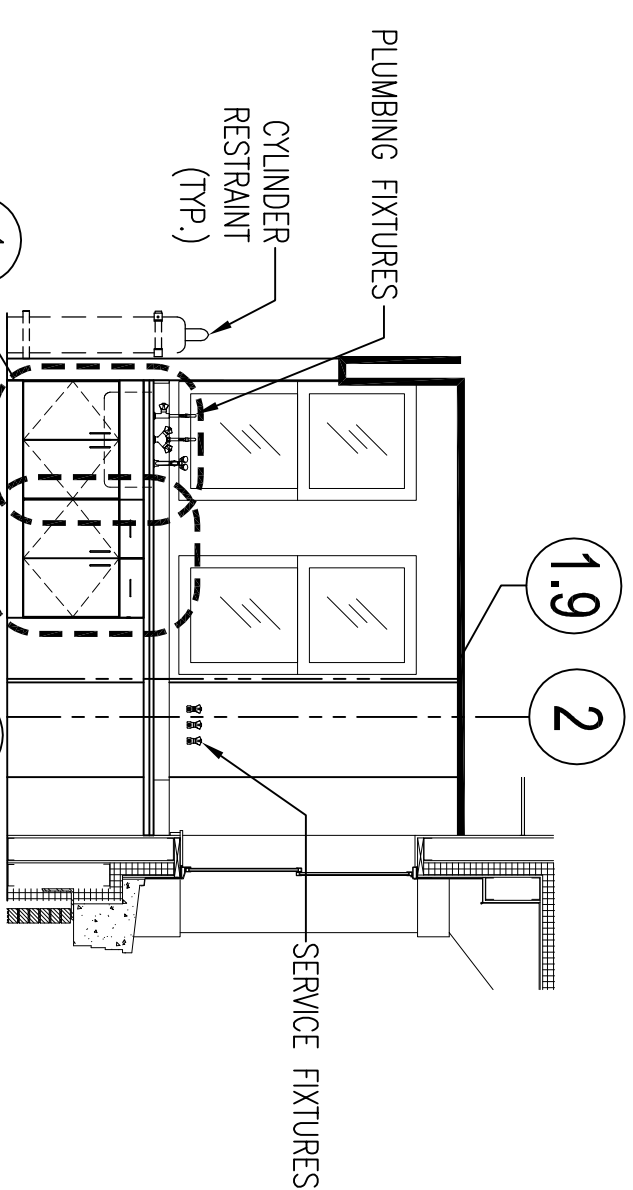

8 TISSUE CULTURE ROOM 328
SCALE: 1/4" = 1'-0"

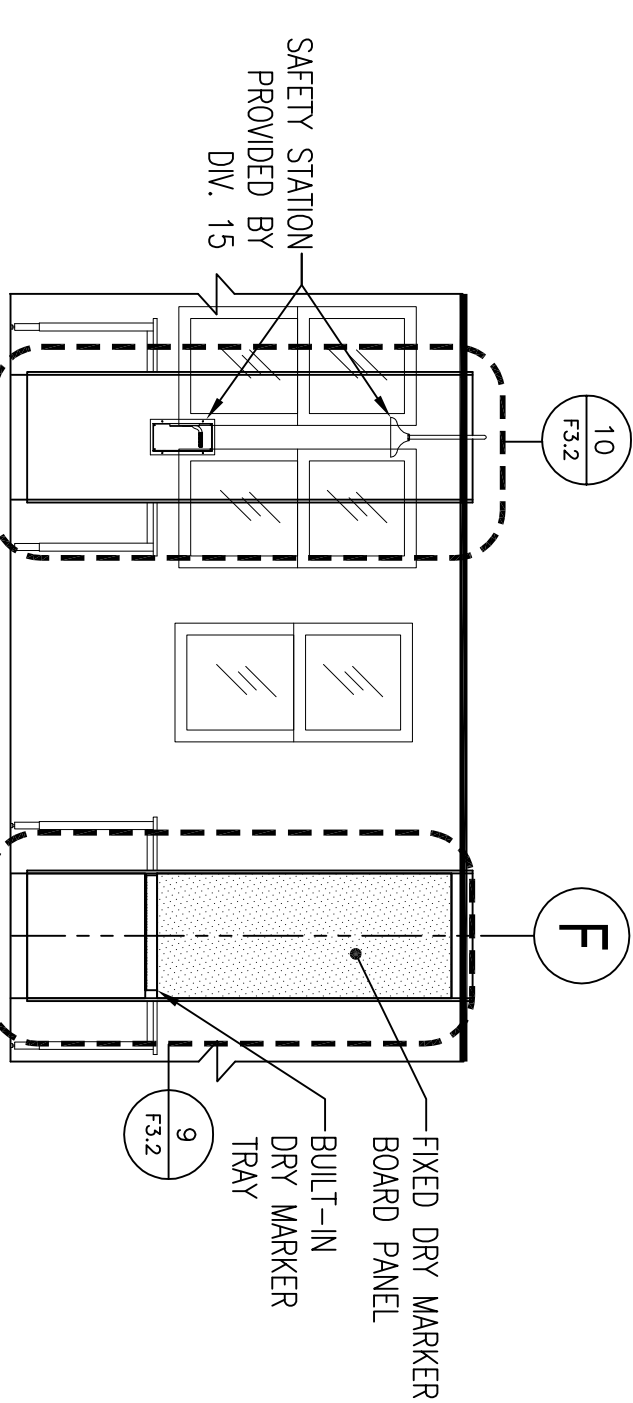

4 LABORATORY ROOM 327
SCALE: 1/4" = 1'-0"

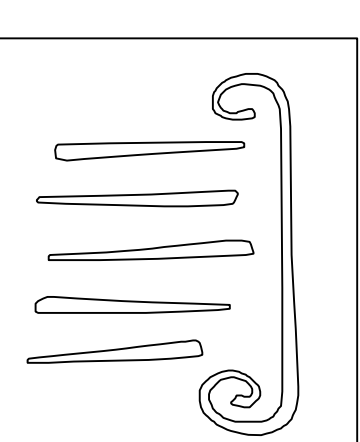

PORT & GUTZ
ARCHITECTURE
65 NEWBURY STREET
PORTLAND, ME 04101
207.761.9000
207.761.2010
it@portcityarch.com

JACOBS CONSULTANCY
ONE Laboratory Building
VAN ZELM
TEL: 207.761.9000
VAN ZELM BERVOORN & SARGENT, INC.
BECKER
STRUCTURAL ENGINEERS, INC.
SYTDesign CONSULTANTS
CONSULTANTS IN ARCHITECTURE, INTERIOR DESIGN, ENGINEERING & CONSTRUCTION

ALLIED/COOK CONSTRUCTION
Zephyrus
Terra Mechanical Inc.
2000 Industrial Park
Portland, ME 04106

UNIVERSITY OF NEW ENGLAND
COLLEGE OF PHARMACY
716 STEVENS AVENUE, PORTLAND, ME

1	102/05/08 BID SET	
#	DATE	DESCRIPTION
		BID SET
	Date Issued	11/21/07
	Project Number	06506

SHEET NAME
3rd FLOOR ELEVATIONS
F2.3