

11 PROCEDURE ROOM 336
SCALE: 1/4" = 1'-0"

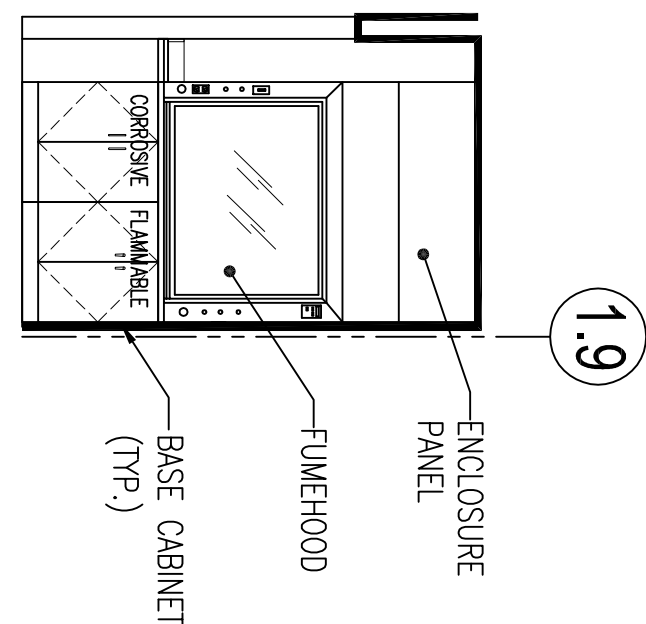

9 FUME HOOD ALCOVE 334
SCALE: 1/4" = 1'-0"

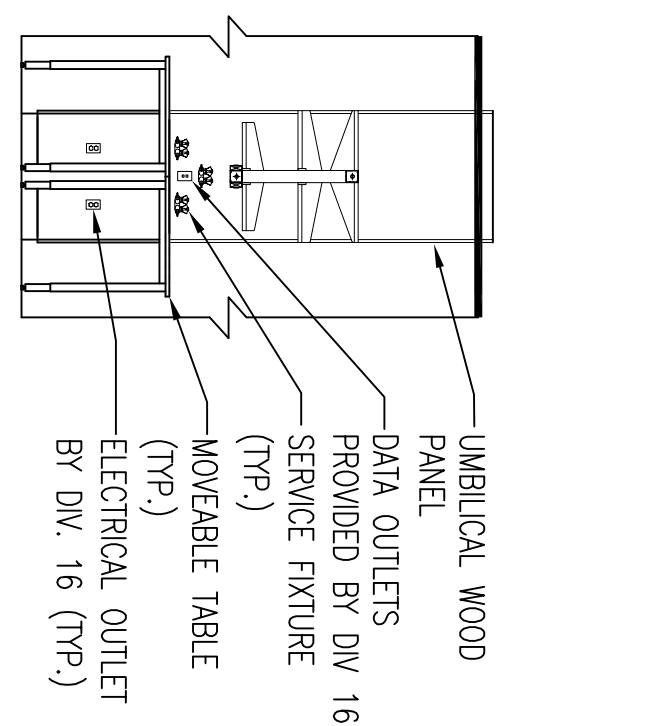

5 LABORATORY ROOM 327
SCALE: 1/4" = 1'-0"

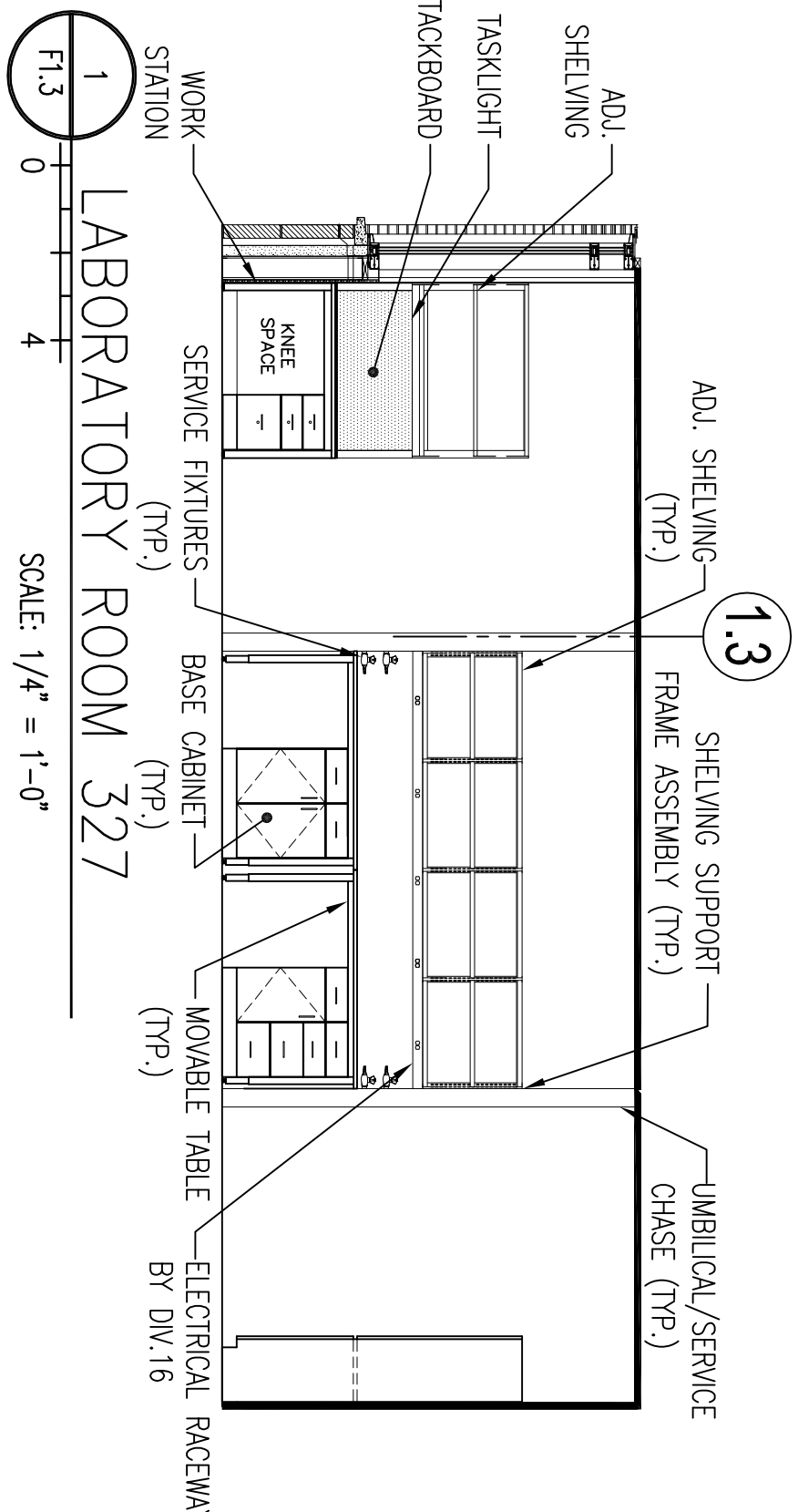

1 LABORATORY ROOM 327
SCALE: 1/4" = 1'-0"

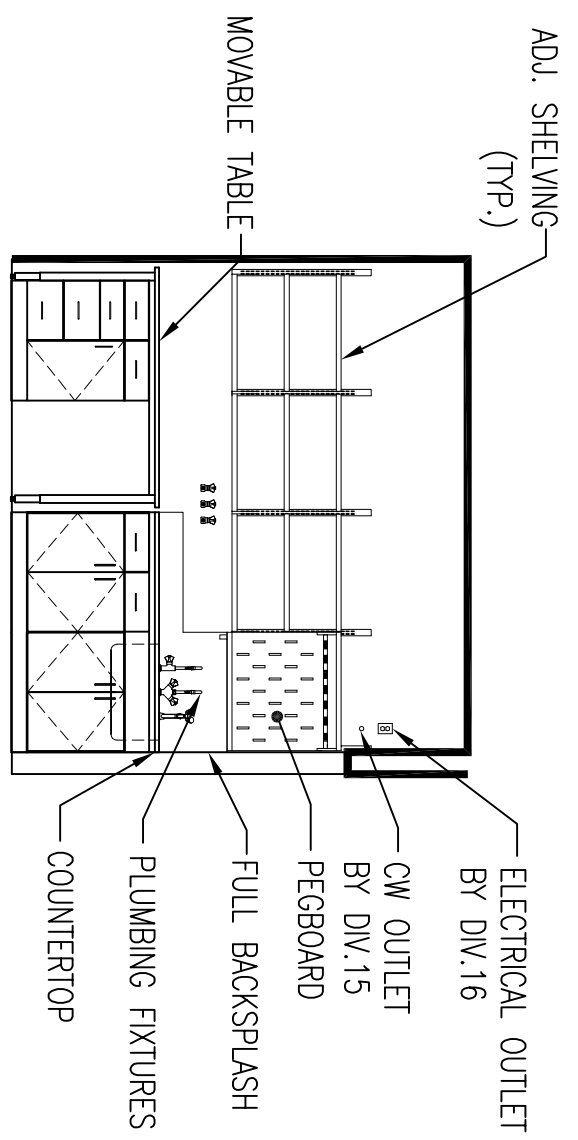

12 PROCEDURE ROOM 336
SCALE: 1/4" = 1'-0"

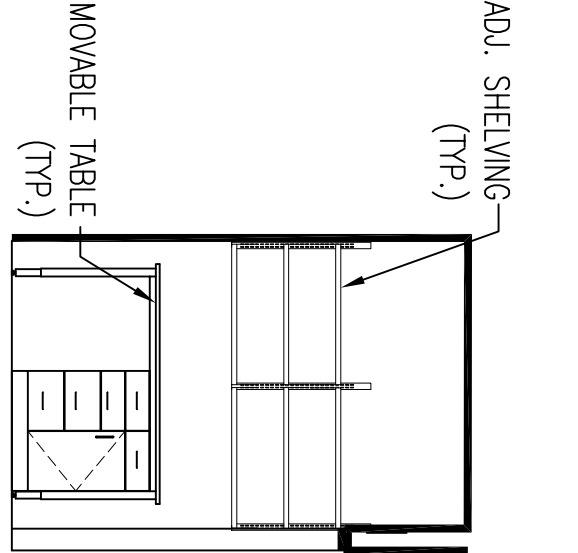

10 FUME HOOD ALCOVE 334
SCALE: 1/4" = 1'-0"

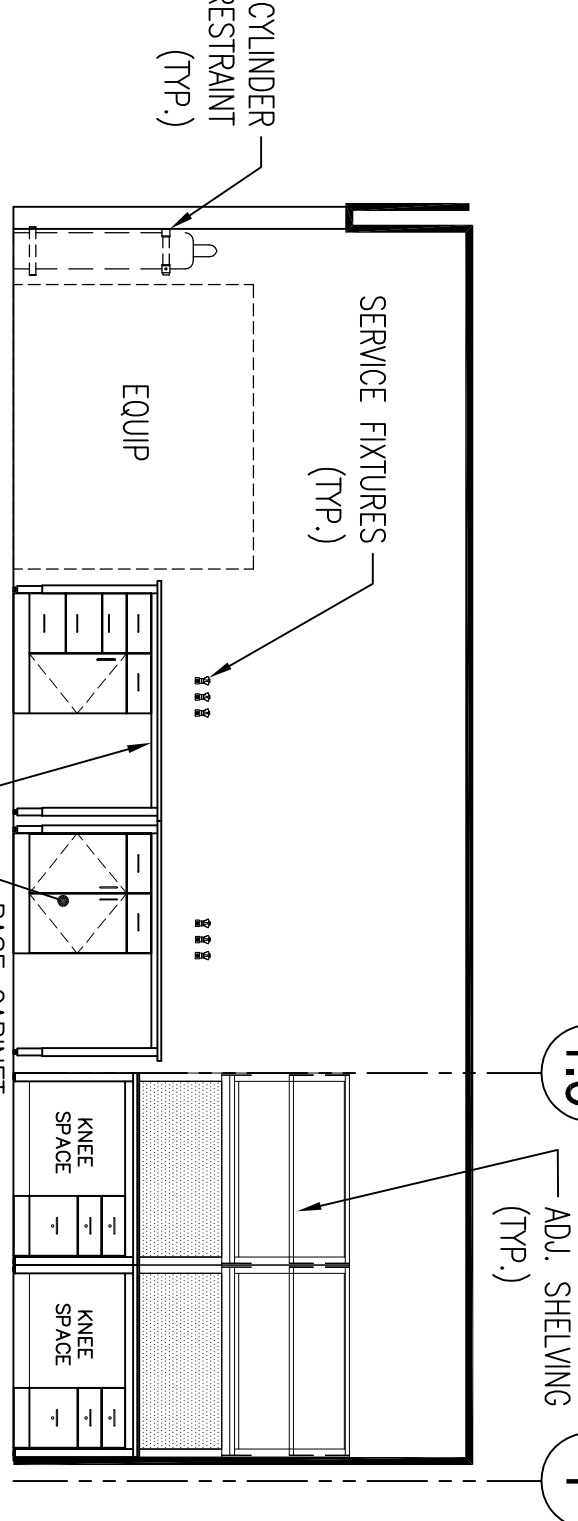

6 LABORATORY ROOM 327
SCALE: 1/8" = 1'-0"

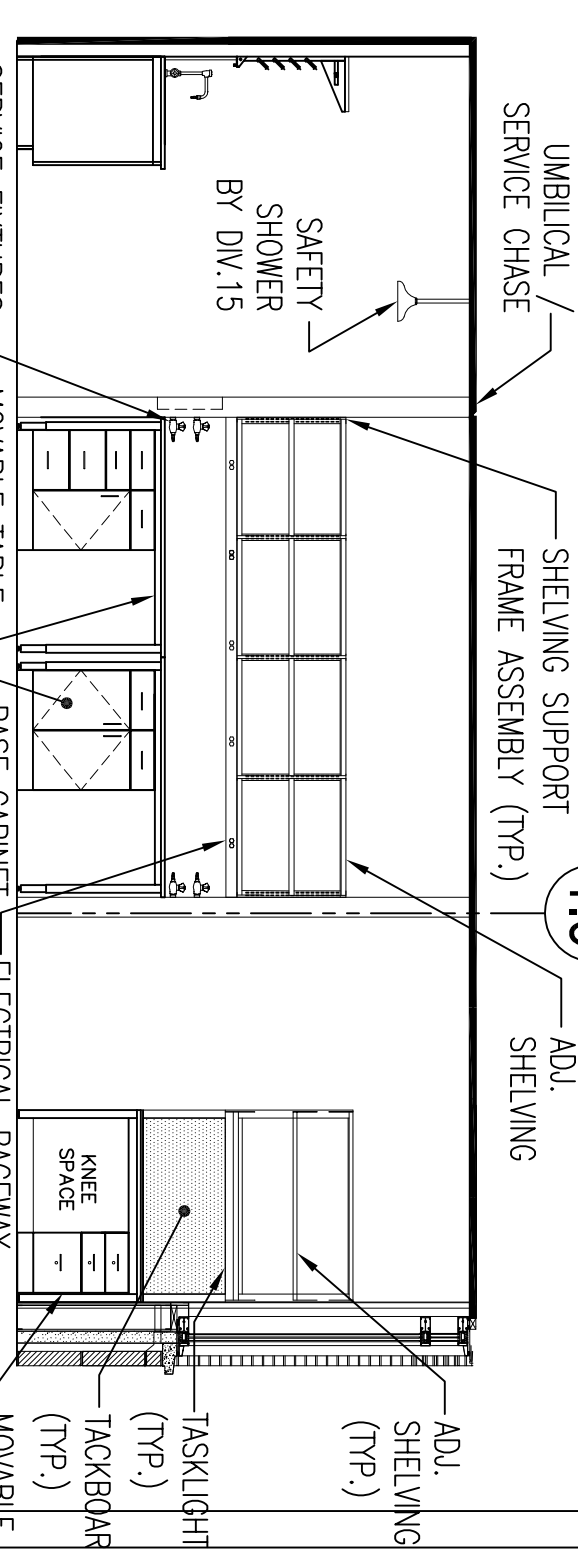

2 LABORATORY ROOM 327
SCALE: 1/4" = 1'-0"

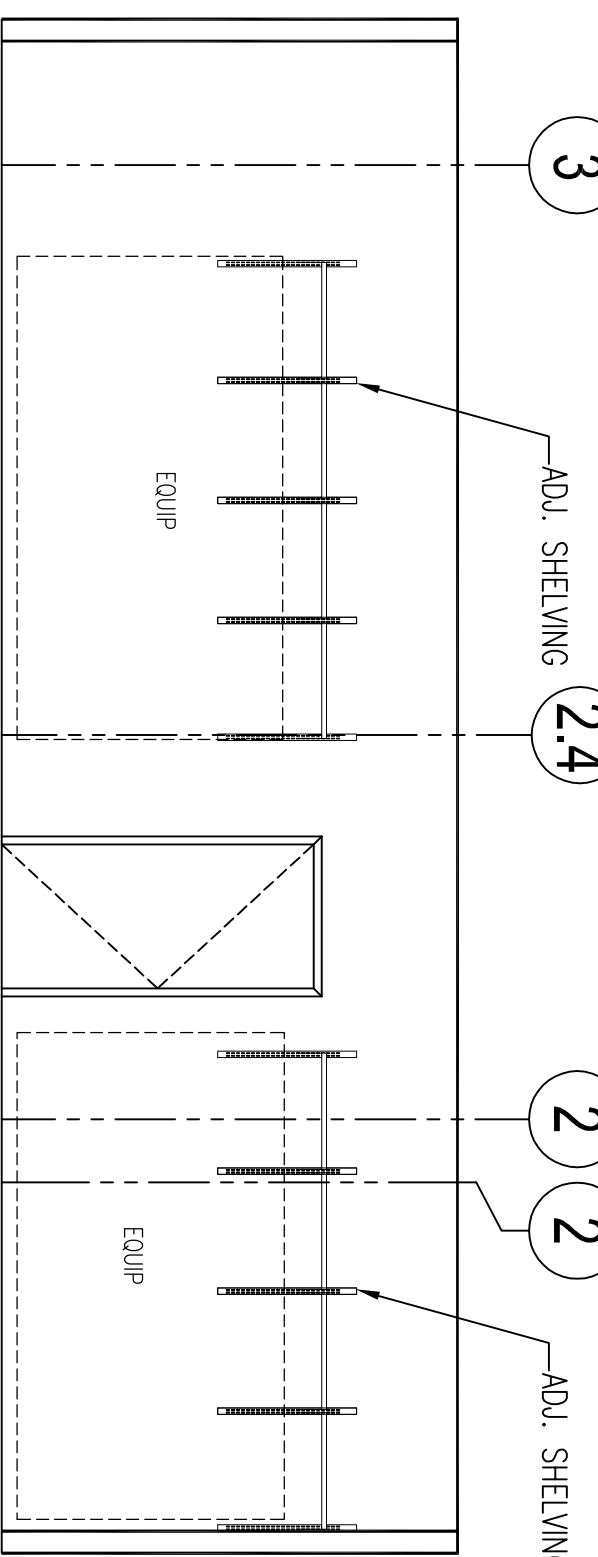

13 LINEAR EQUIPMENT ROOM
SCALE: 1/4" = 1'-0"

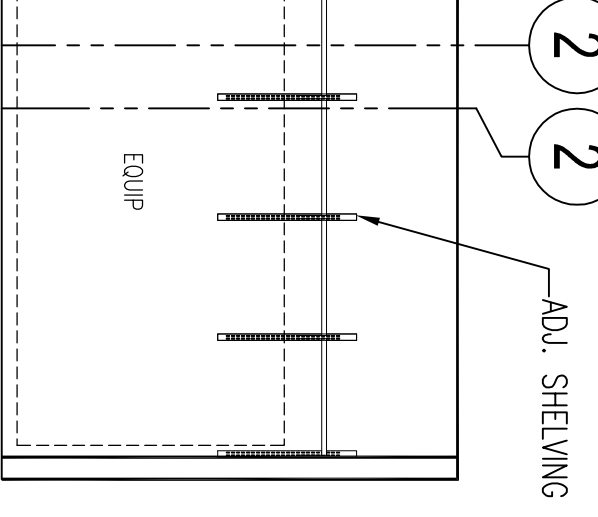

10 FUME HOOD ALCOVE 334
SCALE: 1/4" = 1'-0"

7 NOT IN USE
SCALE: 1/8" = 1'-0"

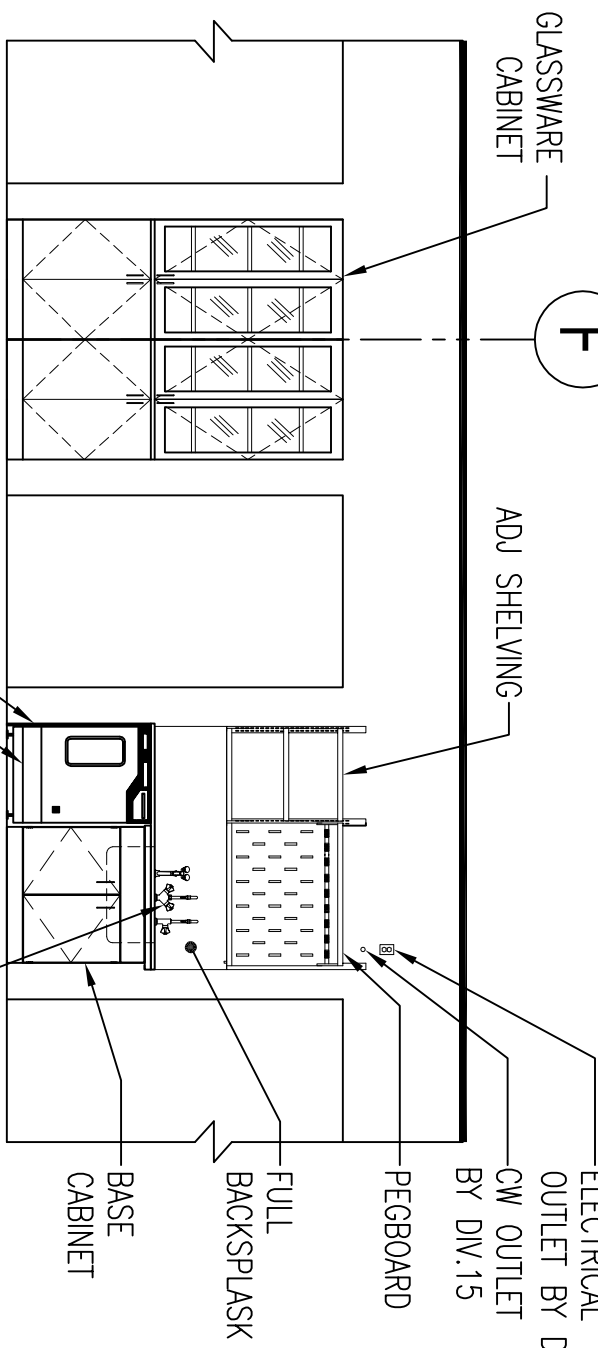

3 LABORATORY ROOM 327
SCALE: 1/4" = 1'-0"

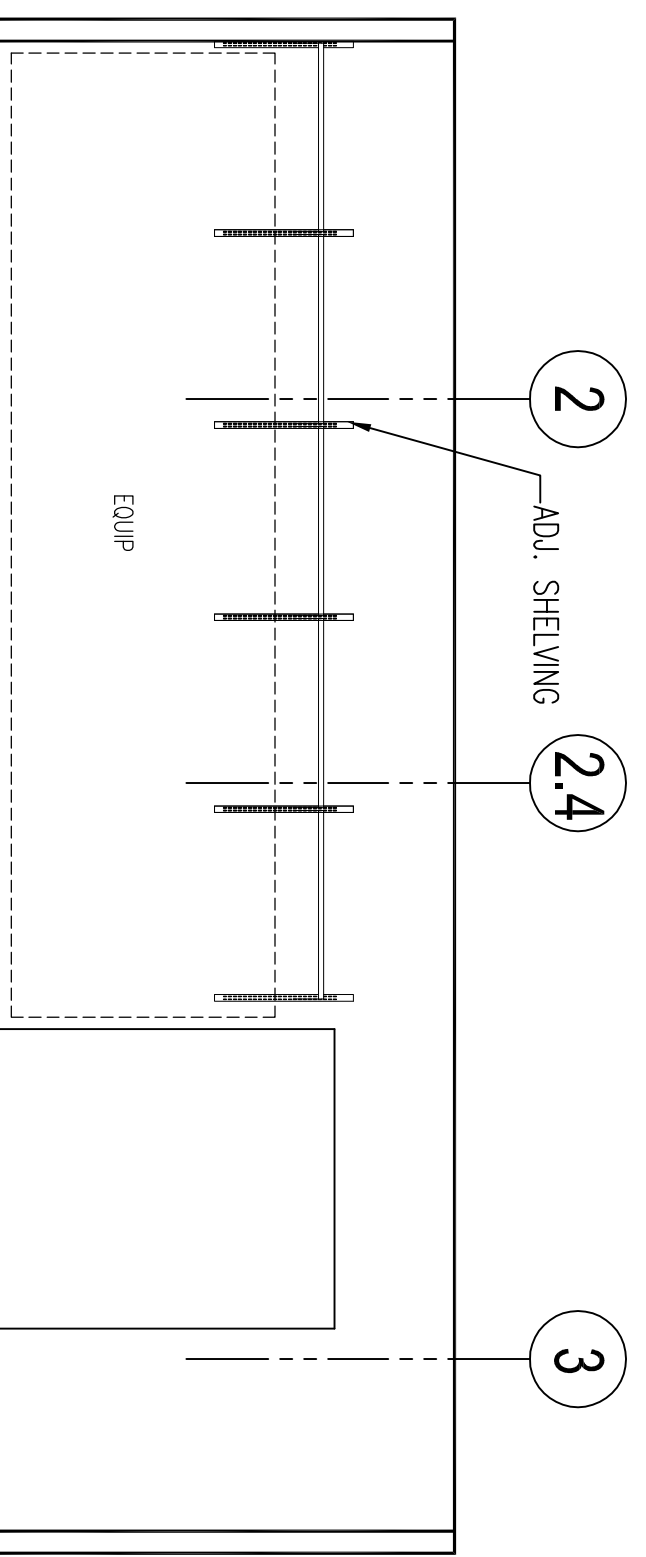

13 LINEAR EQUIPMENT ROOM
SCALE: 1/4" = 1'-0"

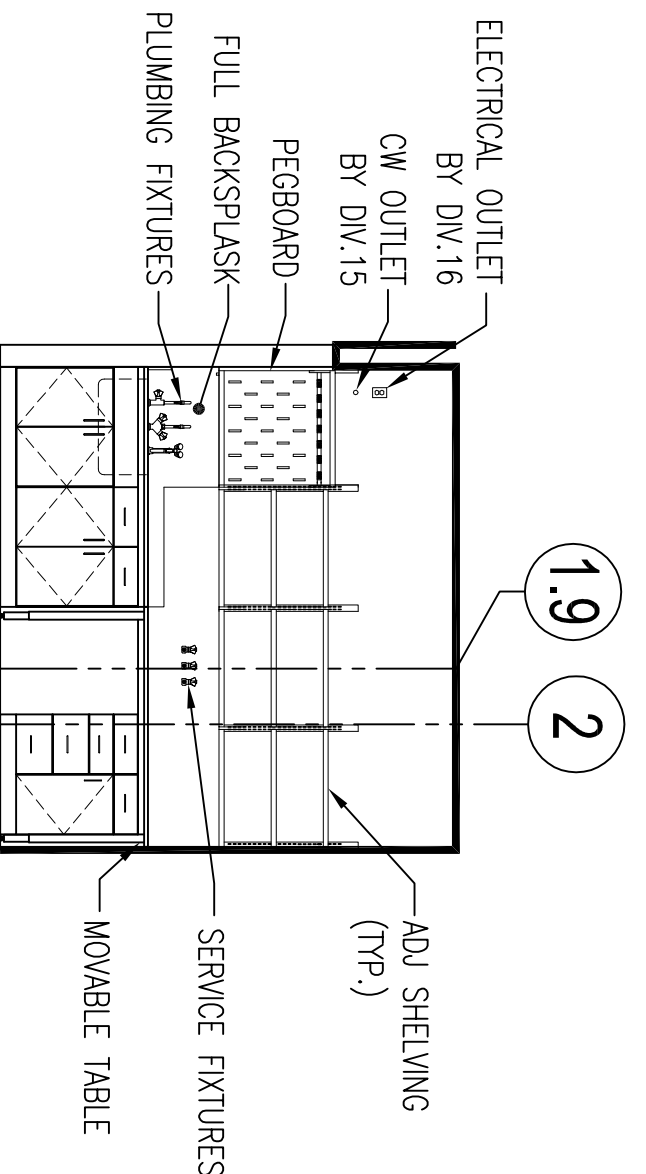

8 TISSUE CULTURE ROOM 335
SCALE: 1/4" = 1'-0"

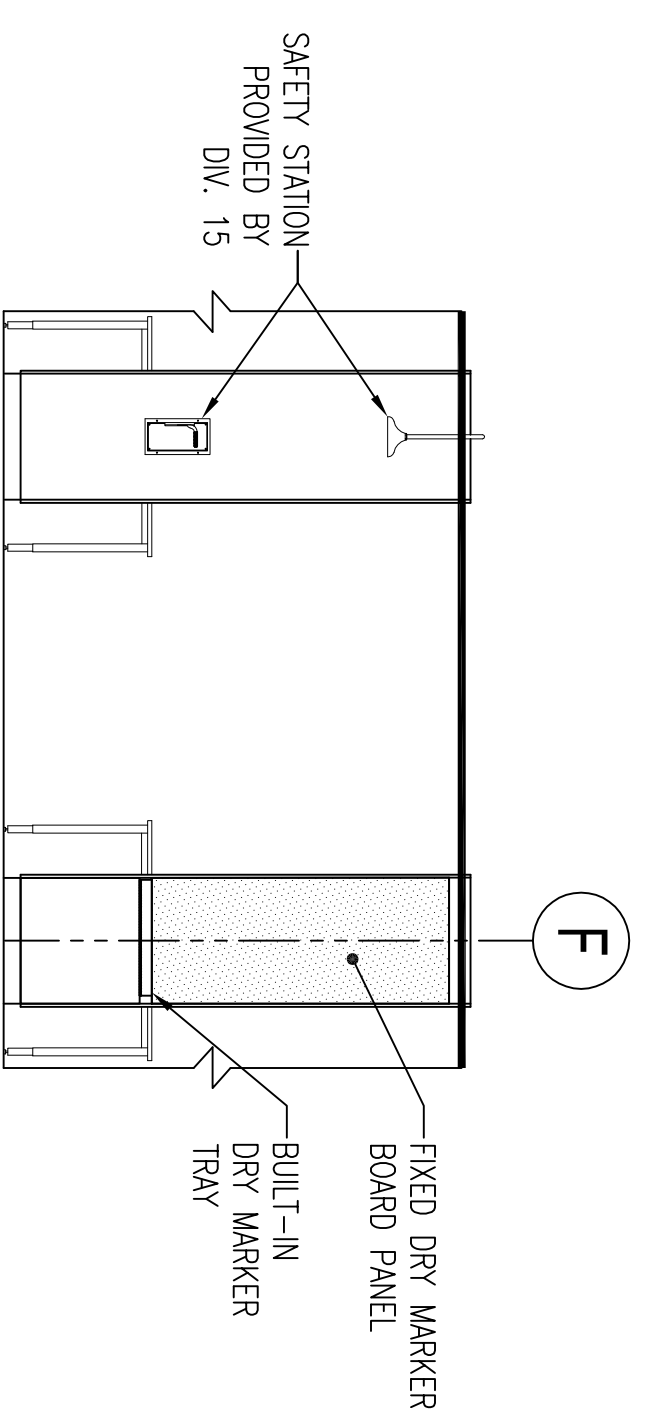

4 LABORATORY ROOM 327
SCALE: 1/4" = 1'-0"

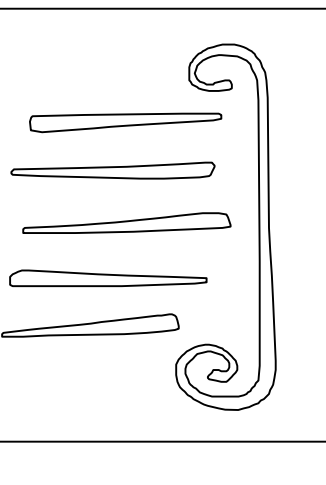

65 NEWBURY STREET
PORTLAND, ME 04101
fax: 207.761.9000
ite@portcityarch.com

JACOBS CONSULTANCY
OUR LABORATORY PLANNING PARTNERS
VANZBELM
VANZBELM INTERIOR & SIGNATURE, INC.
BECKER
SYTDesign CONSULTANTS
CREATIVE BUILDINGS & LABORATORY ARCHITECTURE

UNIVERSITY OF NEW ENGLAND
COLLEGE OF PHARMACY
716 STEVENS AVENUE, PORTLAND, ME

3rd FLOOR ELEVATIONS

Drawn By
Checked By
F2.3

Project Number	06506	
Date Issued	11/21/07	
DESIGN DOCUMENT SET		
#	DATE	DESCRIPTION
A	12/07/07	ISSUED FOR 100% DD SET